

- GENERAL NOTES**
1. FIELD ENGINEER TO TAKE LIES TO ALL IRONS THAT MAY BE DISTURBED DURING CONSTRUCTION AND REPLACE ANY THAT ARE DESTROYED.
 2. WHEN BACKFILLING TRENCH CONTRACTOR IS TO FILL TO AN ELEVATION THAT WILL PROVIDE A MINIMUM OF 30" COVER OVER TOP OF PIPE.
 3. CONTRACTOR TO CONTACT UTILITY COMPANIES FOR LOCATION OF ANY UNDERGROUND LINES.
 4. CONTRACTOR TO MAINTAIN A LEAST ONE LANE OF TRAFFIC AT ALL TIMES WHILE CROSSING GEORGE WASHINGTON BLVD.
 5. FIELD ENGINEER TO SET UP OF MARKERS TO FINISH GRADE AS DETERMINED BY DEVELOPER.

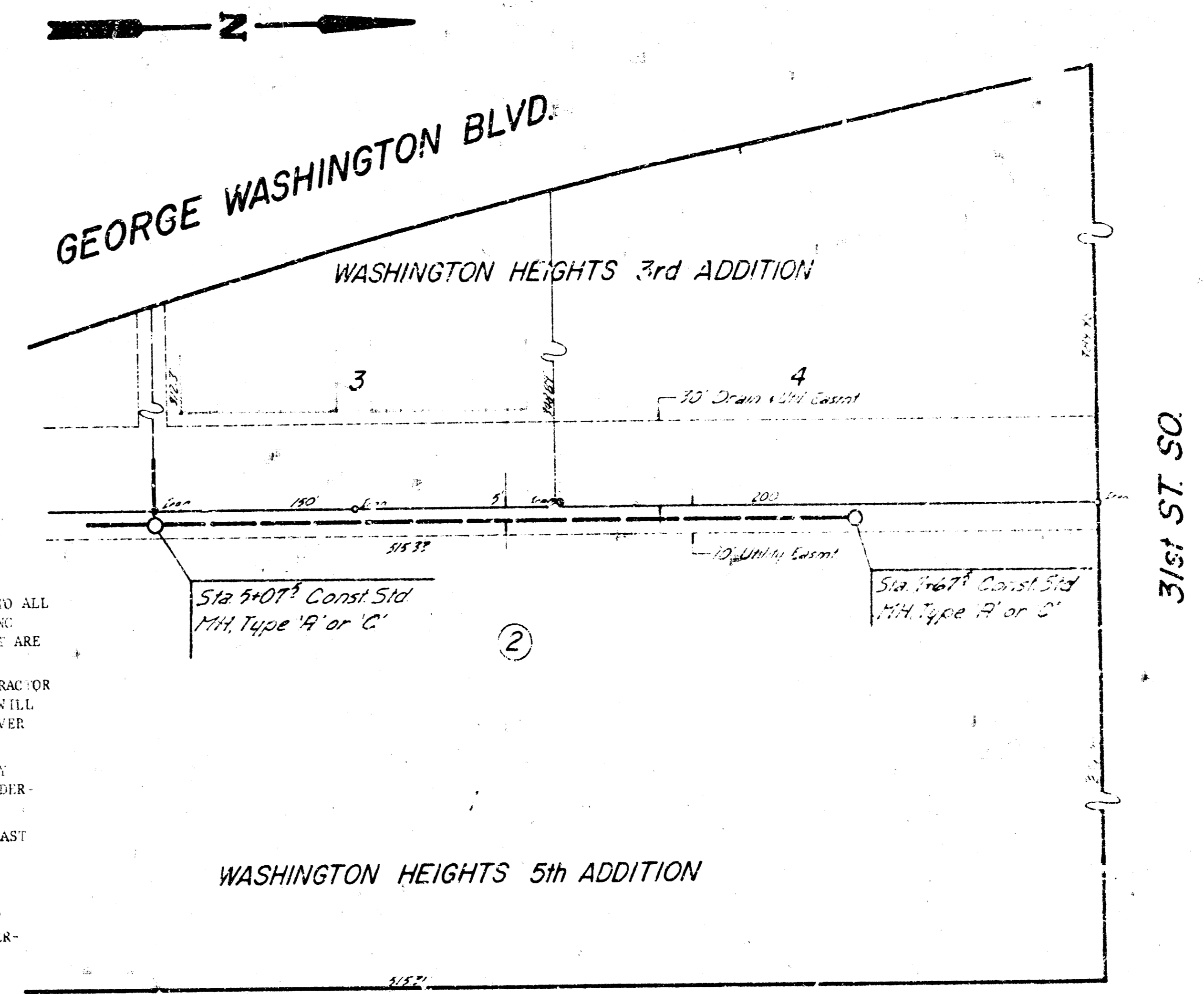

B.M. 172.90 City Sid. Disc. 36.8' N 144.9' ENE @ Both
 3rd St. S. & G.W.B.
 B.M. 39.88 Double 20 Pennu Step Bench, E.S.P. Pole
 S.W. Cor. Lot 2, Washington Heights 3rd Add'n

Scale
 Plan 1"=40'
 Profile Vert 1"=5'

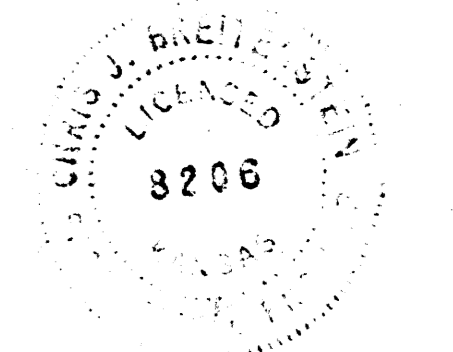

Lat. 17, Main 10, W.I.S.
 468-76-243-80827-007-000-001
 City of Wichita, Kansas
 Dept. of Public Works-Engineering Div
 Dean S. Sellers Acting City Engineer
 Date _____