

NOTE: BENEFIT DISTRICT FOR THIS PROJECT IS ALL OF LOT 1 AND LOT 2, C. ALSEA NORTH, EXCEPT THE SOUTH ONE HUNDRED FIFTY (150) FEET OF SAID LOT 2.

DRAINAGE

DEDICATION

NORTH

ST

21ST

1/2 Mile to Boardman

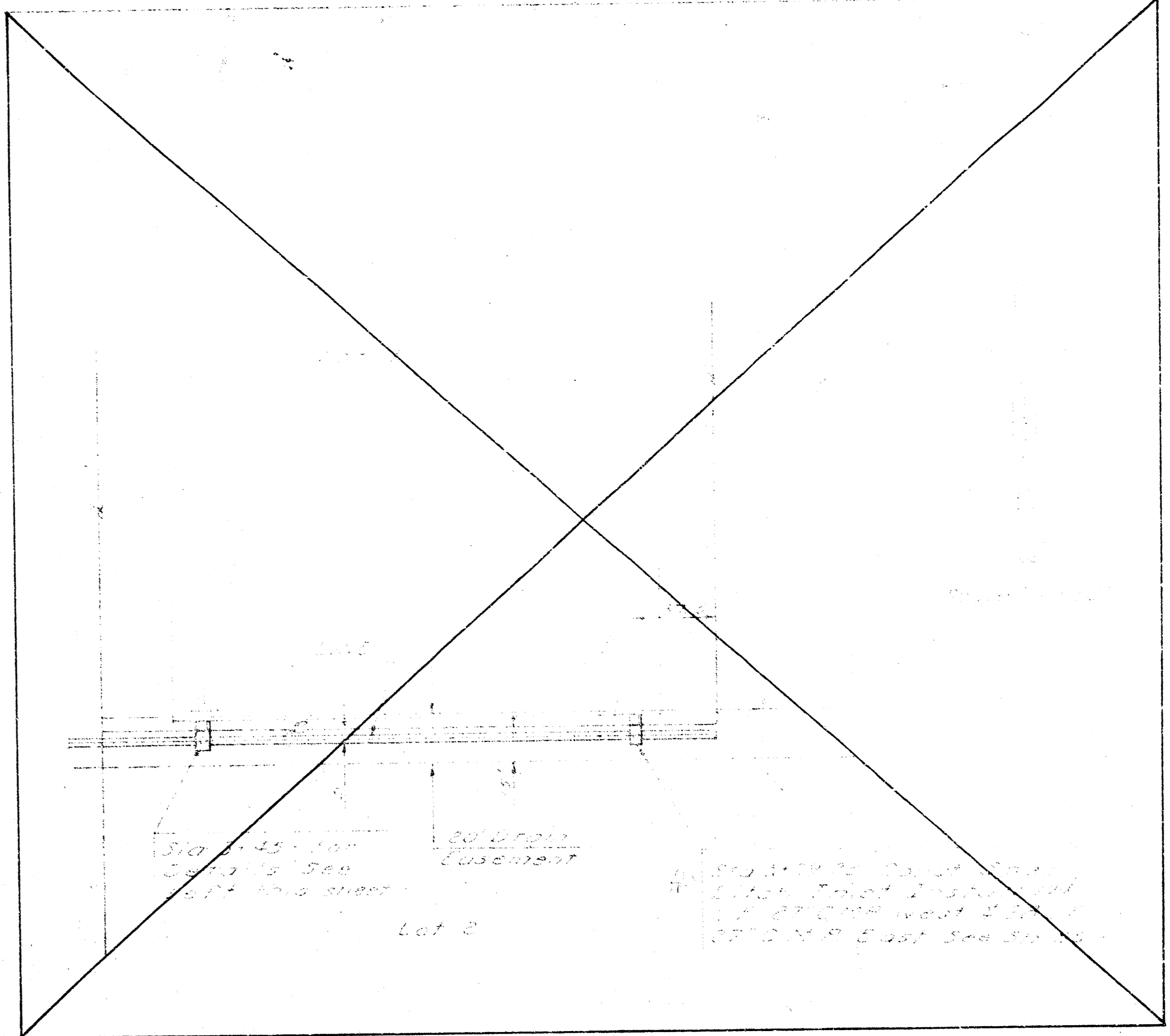

K. G. & E.

EASEMENT

612

3 M. 5 in Bell Tele Md N side 21st & N 1/4 Sec. 51 20981

NOTE TO CONTRACTOR: Before any underground sewer line is installed in K.G. & E. easement K.G. & E. to be constructed prior to any excavation within their easement.

Handwritten: Add Bulk
9/1/61

PROFILE - SANITARY SEWER

PROFILE - STORM SEWER

CHANNEL CROSS SECTIONS

LAT 15, MAIN 20, WAR INDUSTRIES SEWER
CITY OF WICHITA
R.W. BRUGGEMAN
DIRECTOR OF ENGINEERING - CITY ENGINEER
PROJ. NO. 468-76-245-81046-000-001

FILMED FROM THE BEST