

**CITY OF WICHITA, KANSAS**  
**SANITARY SEWER IMPROVEMENTS**  
**SANITARY SEWER NO. 12, DISTRICT E**  
**IN THE ALLEY WEST OF ERIE, FROM 11TH TO 12TH STREETS N.**  
**PROJECT NO.: 468-76-245-81886-000-000-001**

**GENERAL NOTES:**

1. Existing utilities and their locations, as shown on the plans represent best information obtainable for design. The Contractor will be required to work around existing utilities within right-of-way which do not conflict with proposed construction.
2. A saw cut of at least one-half the depth of existing surface course or one-fourth the depth of existing total pavement thickness shall be provided at locations where proposed construction abuts an existing surface course or pavement for which partial removal of that surface or pavement is required. Such saw cuts will not be paid for directly and this cost shall be considered subsidiary to other bid items.
3. Rubble from the removal of miscellaneous structures and excess excavation which is to be wasted shall be disposed of on sites to be provided by the Contractor. These sites shall be approved by the Engineer as to suitability, appearance and site location. Locations that, in the opinion of the Engineer, will leave an unsightly appearance will not be approved.
4. Trees and shrubs in public right-of-way which are in direct conflict with proposed new construction shall be removed by the Contractor with Engineer's approval. Trees and shrubs which are not in direct conflict with proposed new construction shall be saved and protected from damage.
5. The Contractor shall give all property owners and/or tenants of developed property abutting the construction of this project a minimum of ten (10) days advance notice prior to start of construction.
6. Only active building sewer lines which connect actual buildings to the sewer system are to be reconnected with the new sewer construction. Building sewer lines and/or connections which have been abandoned are not to be reconnected to the new sewer construction. It will be the sole responsibility of the Contractor to ascertain which such building sewer lines and/or connections are active and which such sewers and/or connections have been abandoned. All work involved with building sewer line construction and/or building sewer connection shall conform to the applicable section of the standard specifications.
7. The Contractor shall be responsible for maintaining continuous flow of sewage through construction. Contractor's proposed method of maintaining sewage flow shall be approved by the Engineer. Cost of maintaining flow of sewage through construction shall not be paid for directly and this cost shall be considered subsidiary to the other pay items of work.
8. The Contractor shall be responsible for preserving property irons. The Contractor will be required to re-establish any property irons which are damaged or destroyed by his construction operations. Such irons shall be re-established by a licensed land surveyor or a licensed professional engineer in accordance with state law.

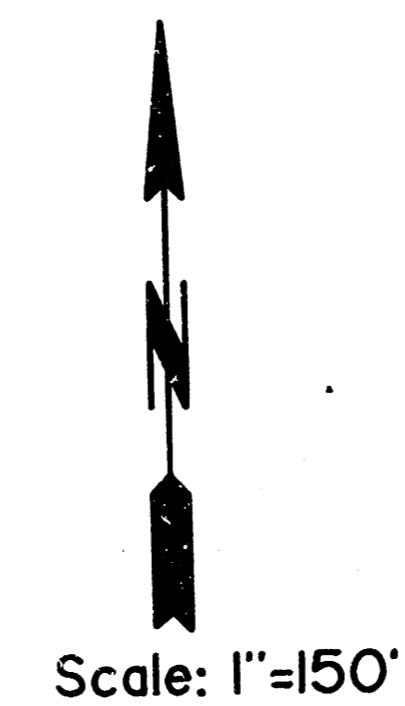
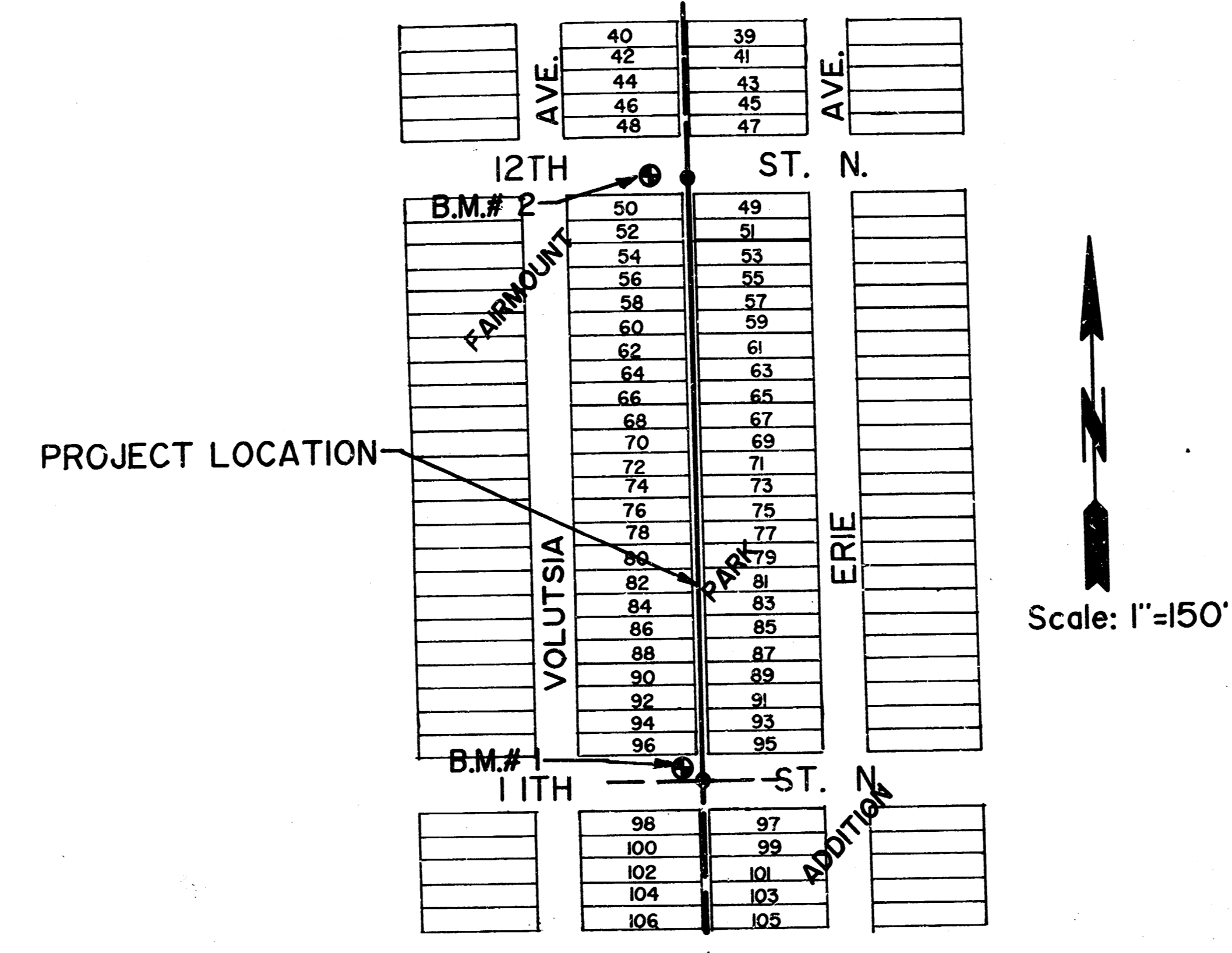

**LOCATION MAP**

**MICHAEL E. LINDEBAK, P.E., CITY ENGINEER**

INDEX NO. : 600817

**INDEX:**

SHEET 1	TITLE SHEET
SHEET 2	PLAN-PROFILE SHEET

**BENCH MARKS:**

B.M. # 1: '12' CHISEL ON TOP OF CURB ON NORTH CURB OF 11TH STREET N.; MIDWAY BETWEEN ERIE AND VOLUTSIA. EL.= 150.86

B.M. # 2: '12' CHISEL ON TOP OF CURB ON SOUTH CURB OF 12TH STREET N.; AT WEST RETURN OF ALLEY BETWEEN ERIE AND VOLUTSIA. EL.= 145.39

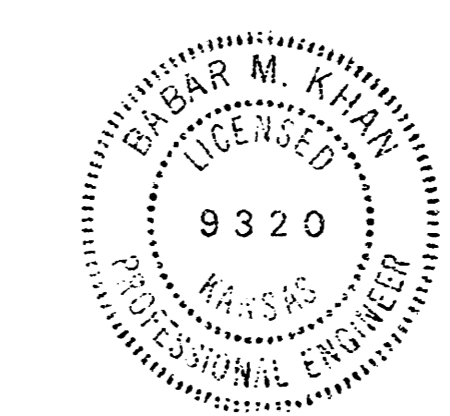

<b>TITLE SHEET</b>		
SCALE:	APPROVED BY: BK	DRAWN BY R.W.
DATE:		REVISED
<b>MUNICIPAL ENGINEERS</b> Civil Engineers & Land Surveyors 204 Laura, Suite 201 Wichita, Kansas 67211		DRAWING NUMBER 1 OF 2

**FILMED FROM THE BEST AVAILABLE COPY**

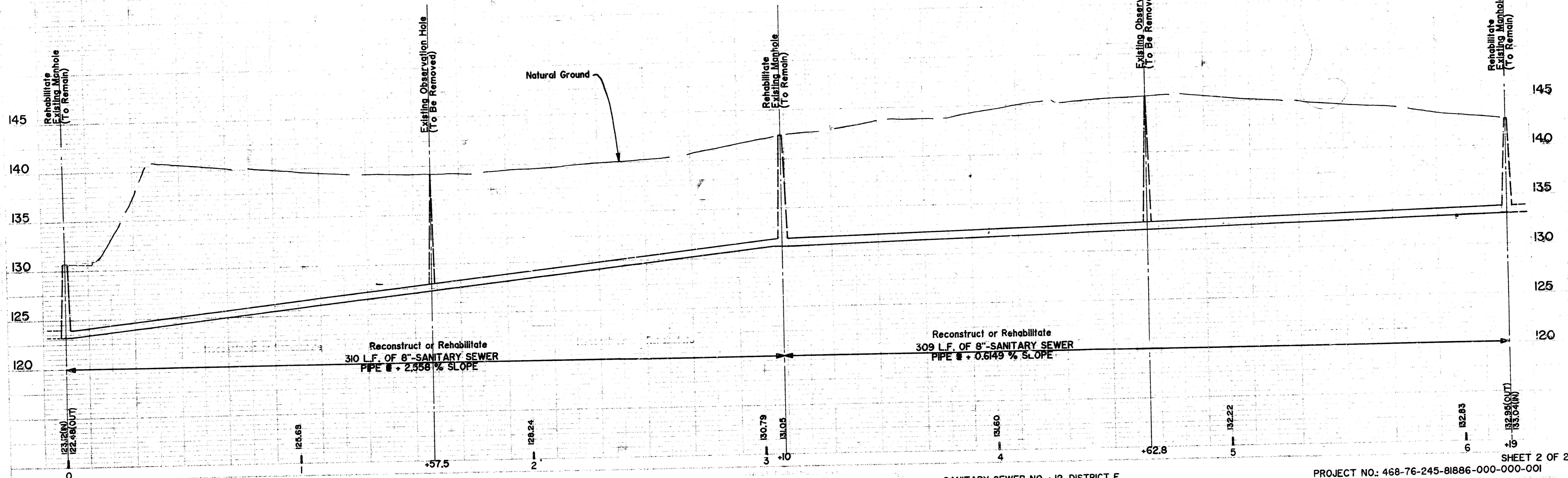
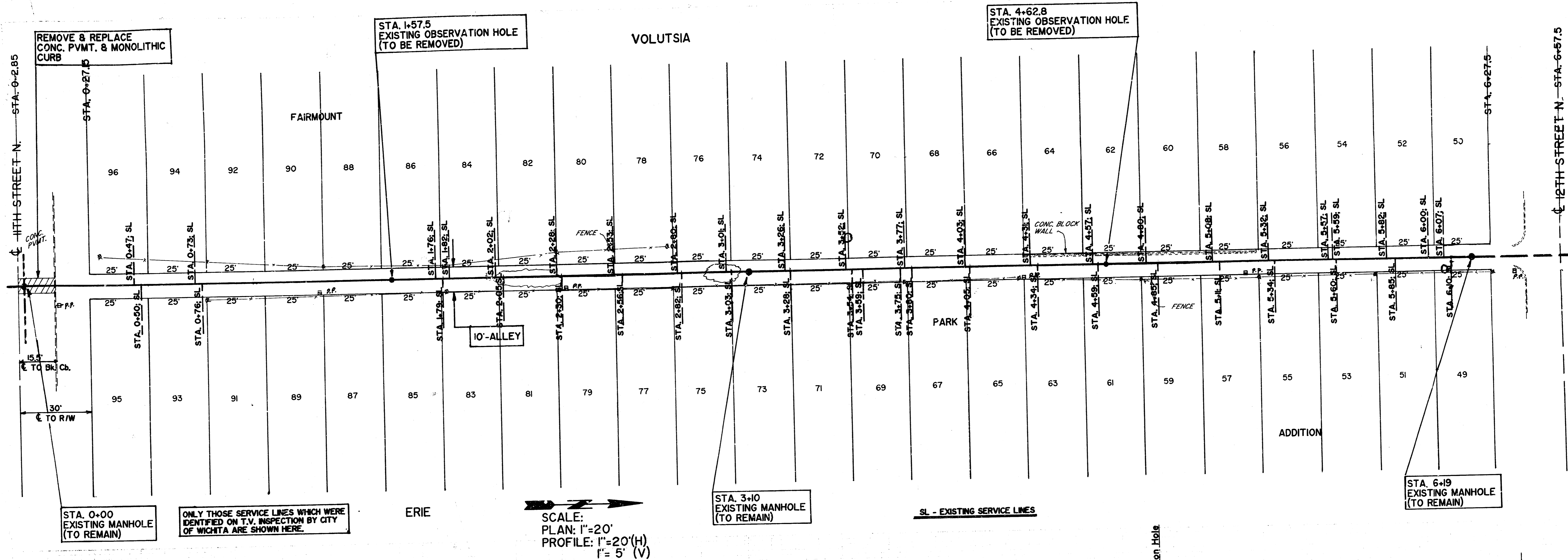

SANITARY SEWER IMPROVEMENTS

SANITARY SEWER NO. : 12, DISTRICT E

PROJECT NO: 468-76-245-81886-000-000-001 SHEET 2 OF 2

FILMED FROM THE BEST AVAILABLE COPY