

ALTER, REPAIR OR RECONSTRUCT SANITARY SEWER IN ALLEY EAST OF MILLWOOD AND SOUTH OF BURTON

PROJECT NO. 468-76-245-81787-000-000-001

CITY OF WICHITA, KANSAS
M. E. LINDEBAK - CITY ENGINEER

GENERAL NOTES

1. ALL CONSTRUCTION AND MATERIALS TO COMPLY WITH CITY OF WICHITA SPECIFICATIONS AND STANDARDS.
2. AT LEAST 48 HOURS PRIOR TO BEGINNING EXCAVATION, IF REQUIRED, (EXCLUDING WEEKENDS AND HOLIDAYS). THE CONTRACTOR SHALL CONTACT THE KANSAS ONE-CALL SYSTEM. A UTILITY LOCATION SERVICE, AT (316) 687-2470 TO REQUEST THE FOLLOWING UTILITY COMPANIES TO LOCATE ANY EXISTING LINES WITHIN THE PROJECT AREA: GAS SERVICE COMPANY, K.G.B.E., THE WICHITA WATER DEPARTMENT, AND AIR CAPITAL CABLEVISION.
3. THE CONTRACTOR MUST ALSO NOTIFY THE TELEPHONE COMPANY AT (316) 571-2115, 48 HOURS PRIOR TO BEGINNING EXCAVATION, IF REQUIRED, AND REQUEST THAT ANY LINES WITHIN THE PROJECT AREA BE FLAGGED.
4. THE BURIED UTILITIES AS LOCATED ON THE PLANS ARE APPROXIMATE LOCATIONS ONLY. IT SHOULD BE NOTED THAT OTHER BURIED LINES AND CABLES MAY EXIST WHICH ARE NOT SHOWN ON THESE PLANS. THE CONTRACTOR SHALL EXERCISE EXTREME CAUTION DURING TRENCHING OPERATIONS TO AVOID DAMAGING THESE LINES. ANY LINES DAMAGED SHALL BE REPLACED OR REPAIRED IMMEDIATELY AS DIRECTED BY THE ENGINEER AT THE CONTRACTOR'S EXPENSE.
5. THE CONTRACTOR SHALL RESTORE ALL DITCHES, SWALES, ROAD SHOULDERS, ENTRANCES, AND BANK LINES TO THEIR ORIGINAL SLOPES AND GRADES EXCEPT AS SHOWN OTHERWISE.
6. THE CONTRACTOR SHALL BE RESPONSIBLE FOR PRESERVING PROPERTY IRONS. THE CONTRACTOR SHALL BE REQUIRED TO RE-ESTABLISH ANY PROPERTY IRONS WHICH ARE DAMAGED OR DESTROYED BY HIS CONSTRUCTION OPERATIONS. SUCH IRONS SHALL BE RE-ESTABLISHED BY A LICENSED LAND SURVEYOR OR A LICENSED PROFESSIONAL ENGINEER IN ACCORDANCE WITH STATE LAWS. ALL COSTS FOR THIS WORK SHALL BE SUBSIDIARY TO THE OTHER ITEMS OF WORK.
7. CONTRACTOR WILL BE REQUIRED TO GIVE ALL PROPERTY OWNERS AND/OR TENANTS DIRECTLY AFFECTED BY THE CONSTRUCTION OF THIS PROJECT A MINIMUM ADVANCE NOTICE OF SEVEN DAYS PRIOR TO STARTING CONSTRUCTION. THE CONTRACTOR SHALL AGAIN NOTIFY RESIDENTS IMMEDIATELY PRIOR TO BEGINNING WORK, THAT SEWER SERVICE WILL BE DISRUPTED.
8. TREES OR SHRUBS LOCATED WITHIN THE UTILITY EASEMENT SHALL NOT BE REMOVED WITHOUT PRIOR APPROVAL BY THE ENGINEER. TREES OR SHRUBS OUTSIDE OF THE UTILITY EASEMENT SHALL NOT BE REMOVED.
9. NO BUILDING SERVICE CONNECTION SHALL BE WITHOUT SANITARY SEWER SERVICE FOR MORE THAN 24 HOURS. ANY SERVICE CONNECTION THAT CANNOT BE REINSTATED SHALL BE REPLACED AT NO EXTRA COST TO THE PROJECT.
10. ONLY ACTIVE BUILDING SEWER LINES WHICH CONNECT ACTUAL BUILDINGS TO THE SEWER SYSTEM ARE TO BE RECONNECTED TO THE NEW SEWER CONSTRUCTION. BUILDING SEWER LINES AND/OR CONNECTIONS WHICH HAVE BEEN ABANDONED ARE NOT TO BE RECONNECTED TO THE NEW SEWER CONSTRUCTION. IT WILL BE THE SOLE RESPONSIBILITY OF THE CONTRACTOR TO ASCERTAIN WHICH BUILDING SEWER LINES AND/OR CONNECTIONS ARE ACTIVE AND WHICH SEWERS AND/OR CONNECTIONS HAVE BEEN ABANDONED. ALL WORK INVOLVED WITH BUILDING SEWER LINE CONSTRUCTION AND/OR BUILDING SEWER CONNECTIONS SHALL CONFORM TO THE APPLICABLE SECTION OF THE STANDARD SPECIFICATIONS.
11. THE CONTRACTOR SHALL BE RESPONSIBLE FOR MAINTAINING CONTINUOUS FLOW OF SEWAGE THROUGH CONSTRUCTION. CONTRACTOR'S PROPOSED METHOD FOR MAINTAINING SEWAGE FLOW SHALL BE APPROVED BY THE ENGINEER. COST OF MAINTAINING FLOW OF SEWAGE THROUGH CONSTRUCTION WILL NOT BE PAID FOR DIRECTLY AND THIS COST SHALL BE CONSIDERED AS SUBSIDIARY TO THE OTHER PAY ITEMS OF WORK.
12. ANY FENCE REMOVED FOR CONSTRUCTION SHALL BE REPAIRED IN A CONDITION EQUAL TO, OR BETTER THAN ORIGINAL, AT NO ADDITIONAL COST TO THE OWNER.
13. THE CONTRACTOR SHALL BE RESPONSIBLE FOR THE ACQUISITION OF ANY ADDITIONAL RIGHTS-OF-WAY OR EASEMENTS NECESSARY TO COMPLETE THE WORK.
14. THE CONTRACTOR SHALL PROVIDE PROPER SIGNING AND BARRICADE TO ROUTE TRAFFIC EITHER THROUGH OR AROUND CONSTRUCTION AS OUTLINED IN THE SPECIFICATIONS. TRAFFIC ROUTING SHALL BE APPROVED BY THE ENGINEER.
15. THE CONTRACTOR MUST EXAMINE THE CONSTRUCTION SITE PRIOR TO BIDDING AND BE SATISFIED AS TO THE WORK SHOWN FOR COMPLETION. AFTER BIDS HAVE BEEN RECEIVED, THE CONTRACTOR SHALL NOT ASSERT THAT THERE WAS A MISUNDERSTANDING OF THE QUANTITIES OF WORK OR OF THE NATURE OF THE WORK TO BE COMPLETED.

0001J/jw(04-88)

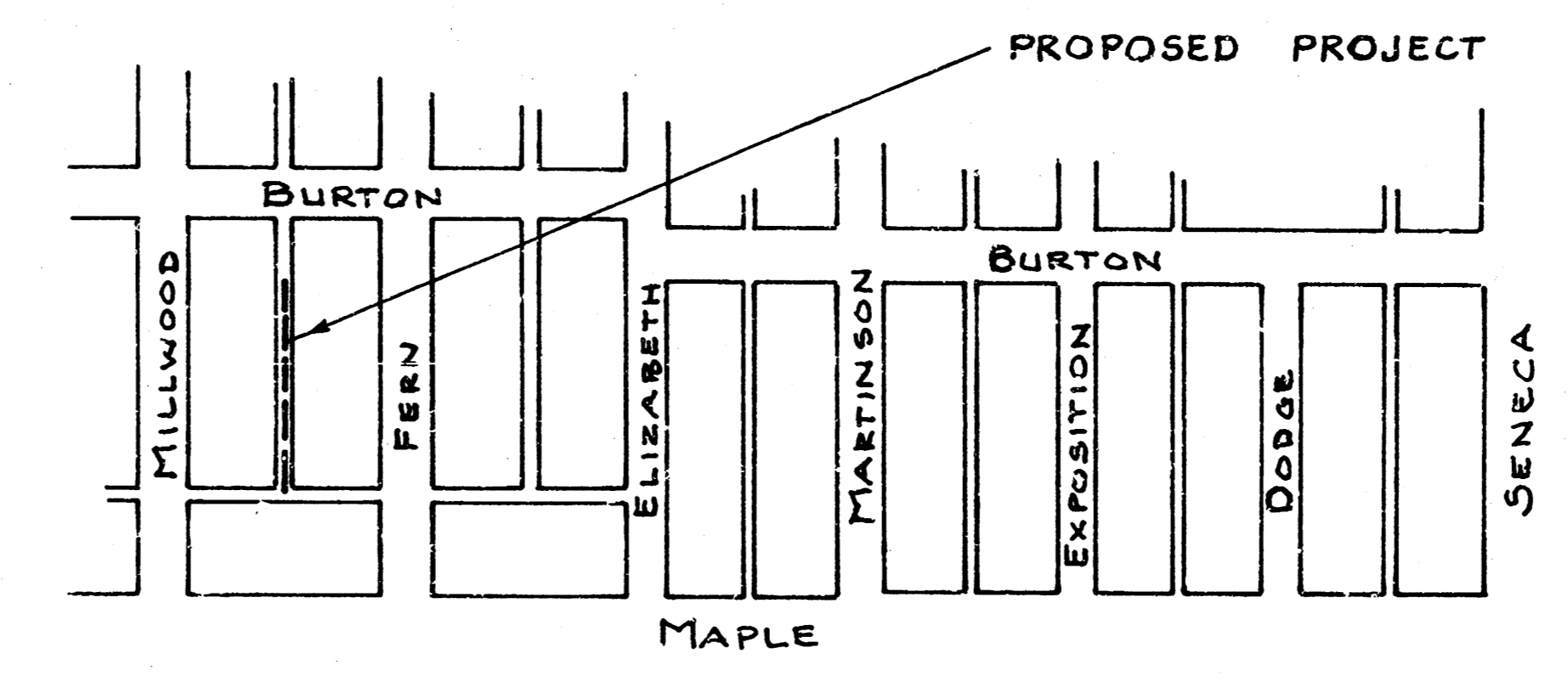

*BUILT PER PLAN
RAL 1-89*

LOCATION MAP

Scale Plan 1" = 40'
 Profile 1" = 40' Horz.
 1" = 5' Vert.

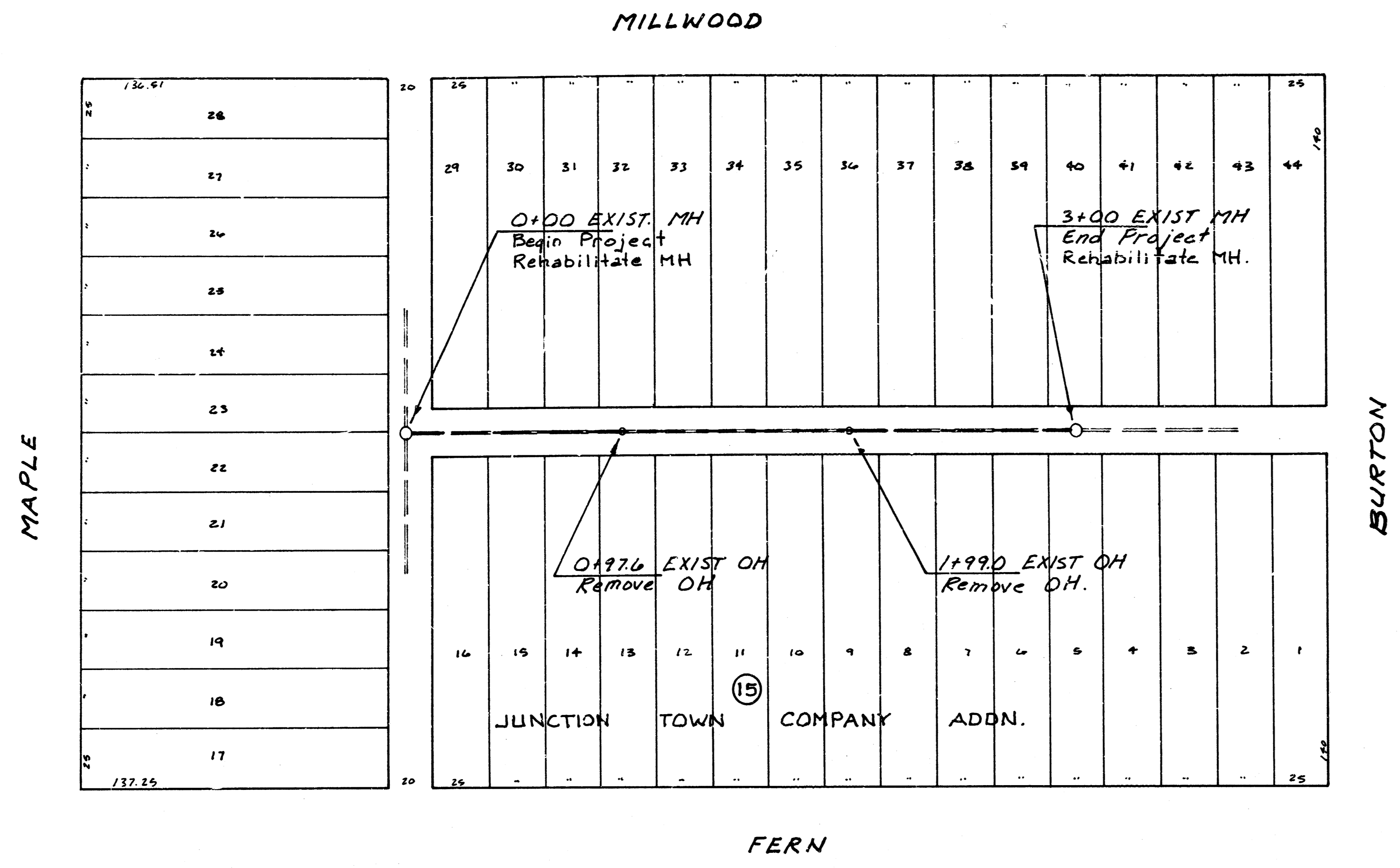
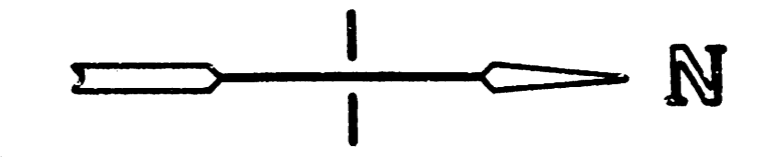

NOTE: Flow line elevations for the new sanitary sewer were established using flow elevations in the existing manholes as shown in the Sewer Record Book and straight graded between manholes.

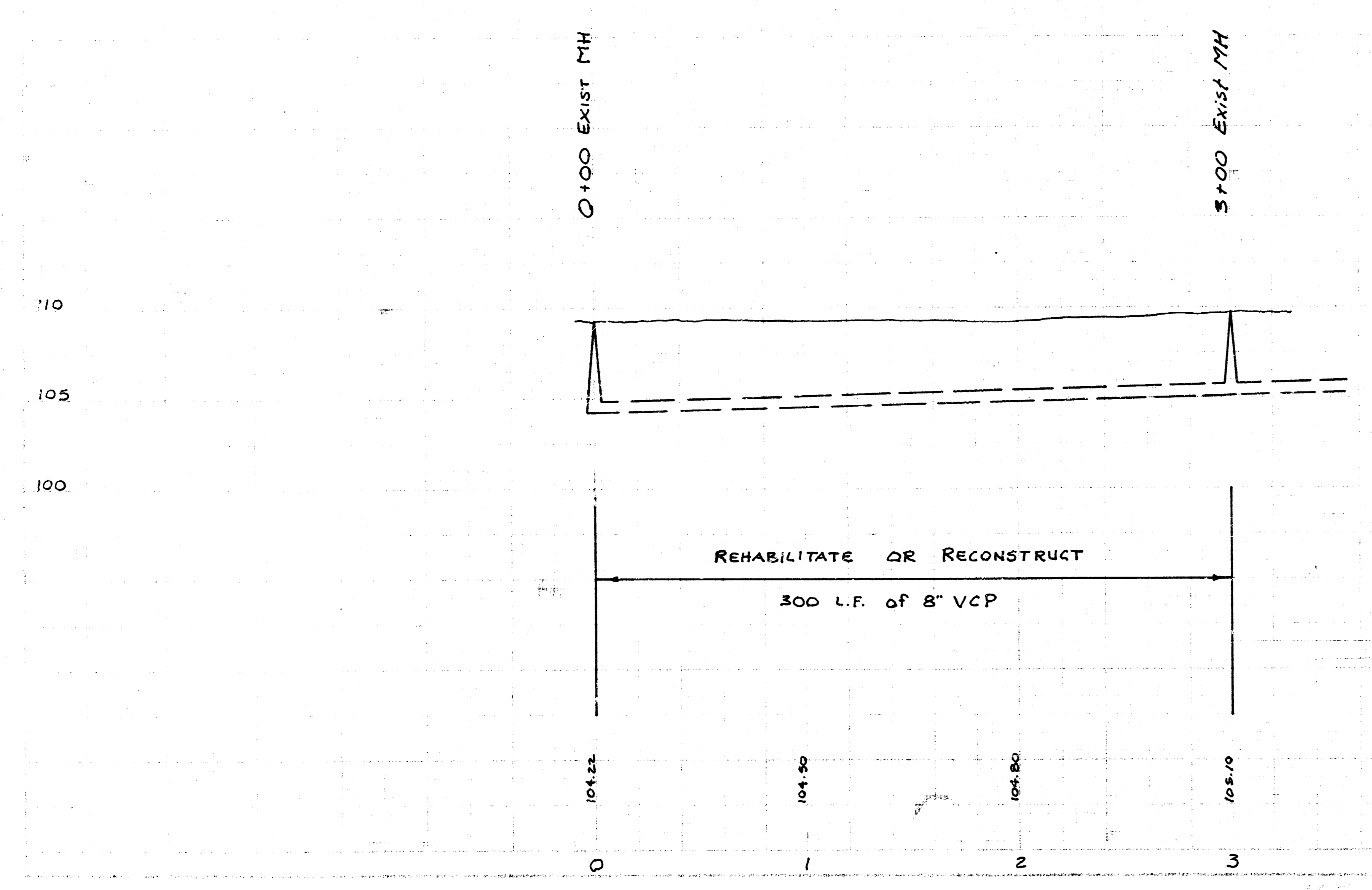

**ALTER, REPAIR OR RECONST. SANITARY SEWER IN
 THE ALLEY EAST OF MILLWOOD AND SOUTH OF BURTON**
 PROJ. NO. 468-76-245-81787-000-000-001
 CITY OF WICHITA, KANSAS
 M. E. LINDEBAK - CITY ENGINEER

14 1 4 3 1/2