

B. M. 144.12 Top of bolt N. E. cor. concoga Sign at S.W. cor. Hillside and Central.
 B. M. 149.64 "a" Top W-cb Hillside @ S.L. Pine extended.
 B. M. 149.19 "a" Top curb S. Ret. S.W. cor. Murdock - Hillside.

NOTE: Bid price of manhole Remove is to include the removal of the top 1/2 of manhole. Plugging of pipes and filling of sand.

NOTE: Remove top 1/2 exist. manhole. Plug Pipes. Fill with sand.

NOTE: Exist. K.G.E. Underground Conduit.

NOTE: Remove top 1/2 exist. manhole. Plug Pipes. Fill with sand.

NOTE: Plug Pipe South

NOTE: Remove Pavement. Replace with Asphalt.

NOTE: Replace pavement where manholes are abandoned.

NOTE: THIS PROJECT SHALL BE COORDINATED WITH CONSTRUCTION OF WESLEY MEDICAL CENTER PARKING GARAGE SUCH THAT PINE AND MURDOCK WILL NOT BE CLOSED AT THE SAME TIME AND SUCH THAT CONSTRUCTION OF THE SEWER ACROSS PINE WILL NOT OCCUR WHILE PINE IS CLOSED FOR CONSTRUCTION OF TUNNEL IN CONNECTION WITH PARKING GARAGE.

Plan Scale 1" = 40' Horiz.
 Profile Scale 1" = 5' Vert.

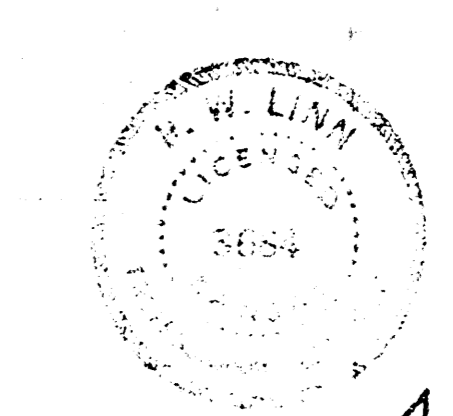
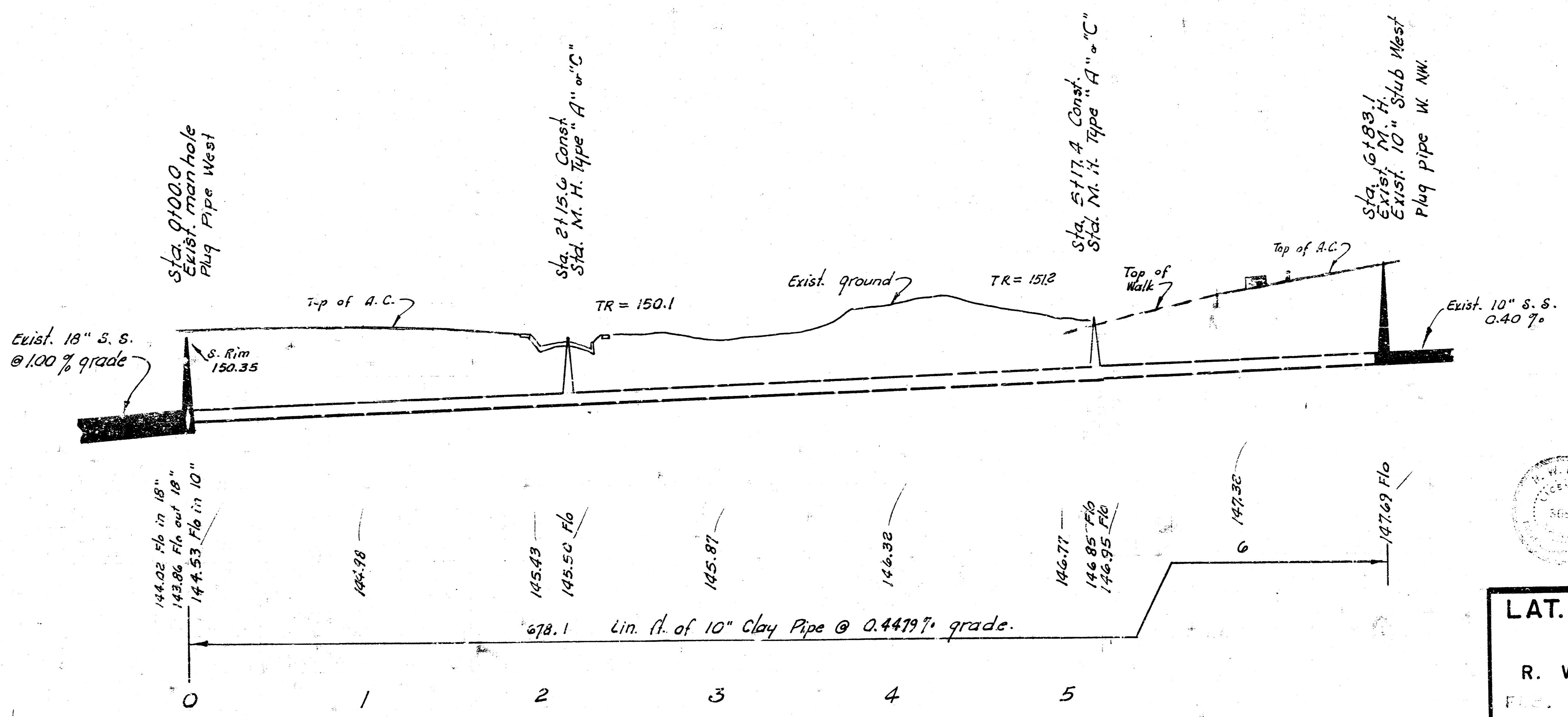
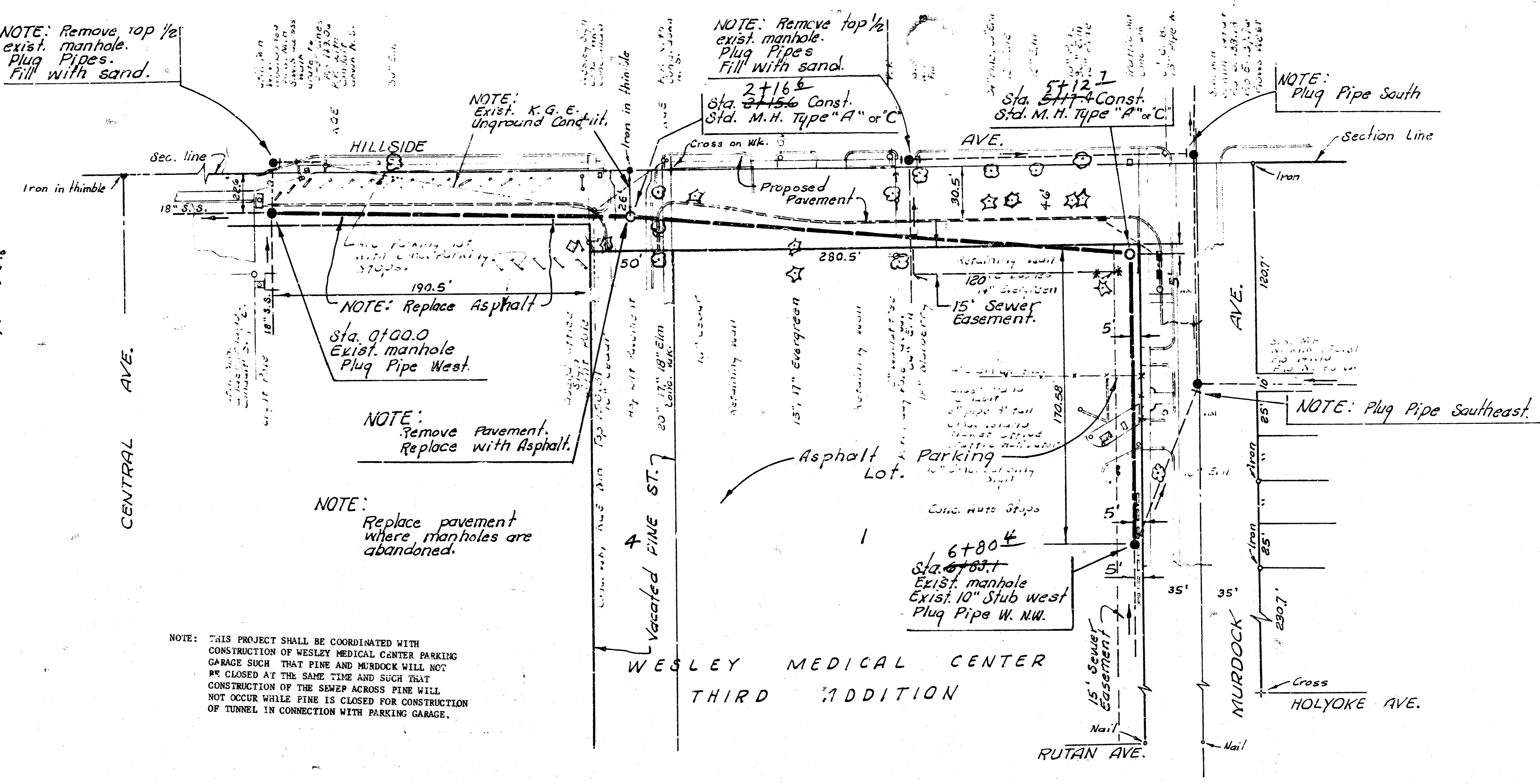

As Built 10-15-75
LAT. 2, WESLEY INTERCEPTER SEWER
 CITY OF WICHITA, KANSAS
 R. W. LINN — CITY ENGINEER
 1975 PROJECT NO. DBKL 5740 82