

B.M. R.R. Spike N.S. P.P. 50' E. of Westfield & 100' N. of Rolling Hills Dr.

Plan Scale 1"=40'
Profile Scale 1"=40' Hor.
1"=4' Vert.

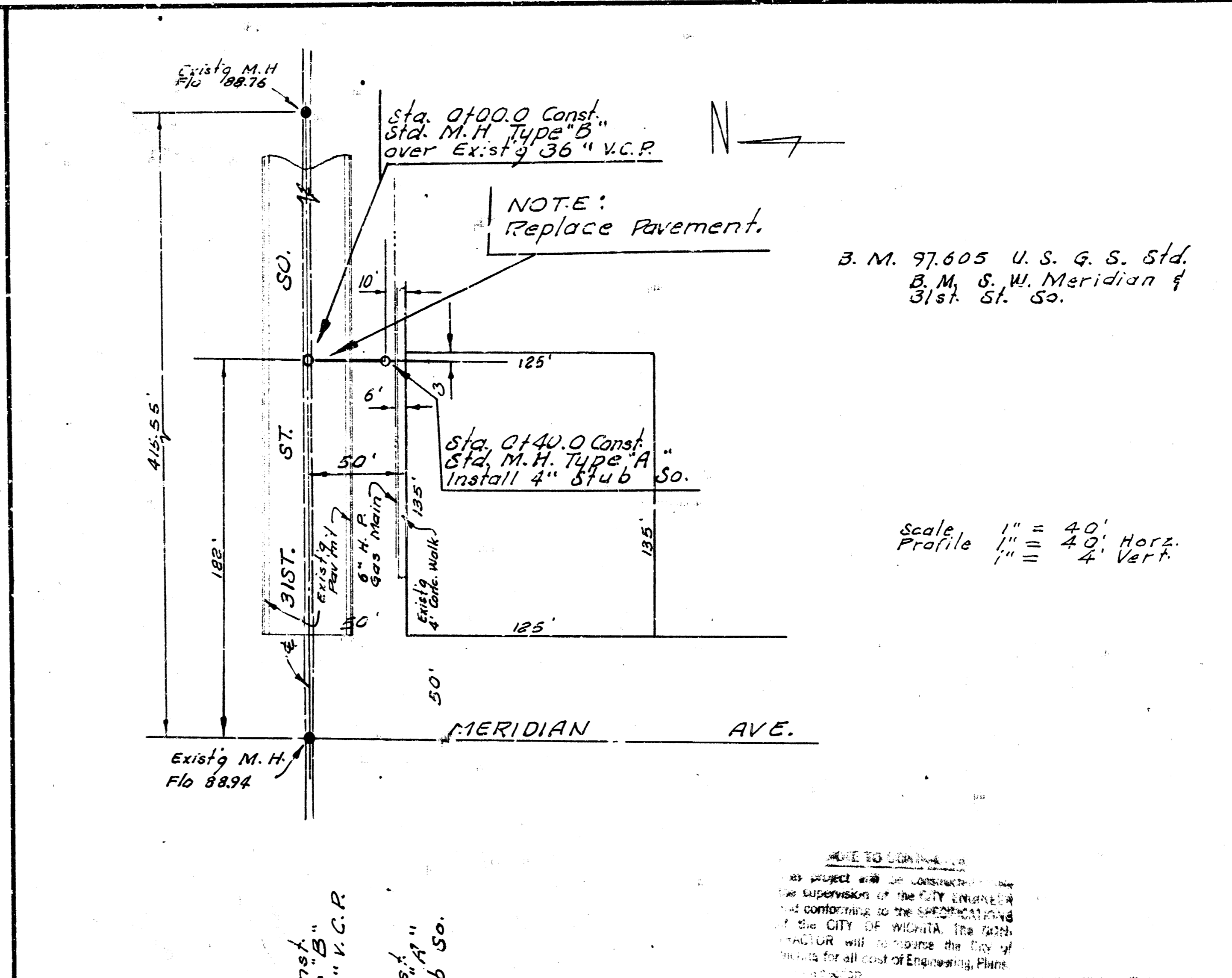

B.M. 97605 U.S.G.S. Std.
B.M. S.W. Meridian &
31st St. So.

Scale 1" = 40' Hor.
1" = 4' Vert.

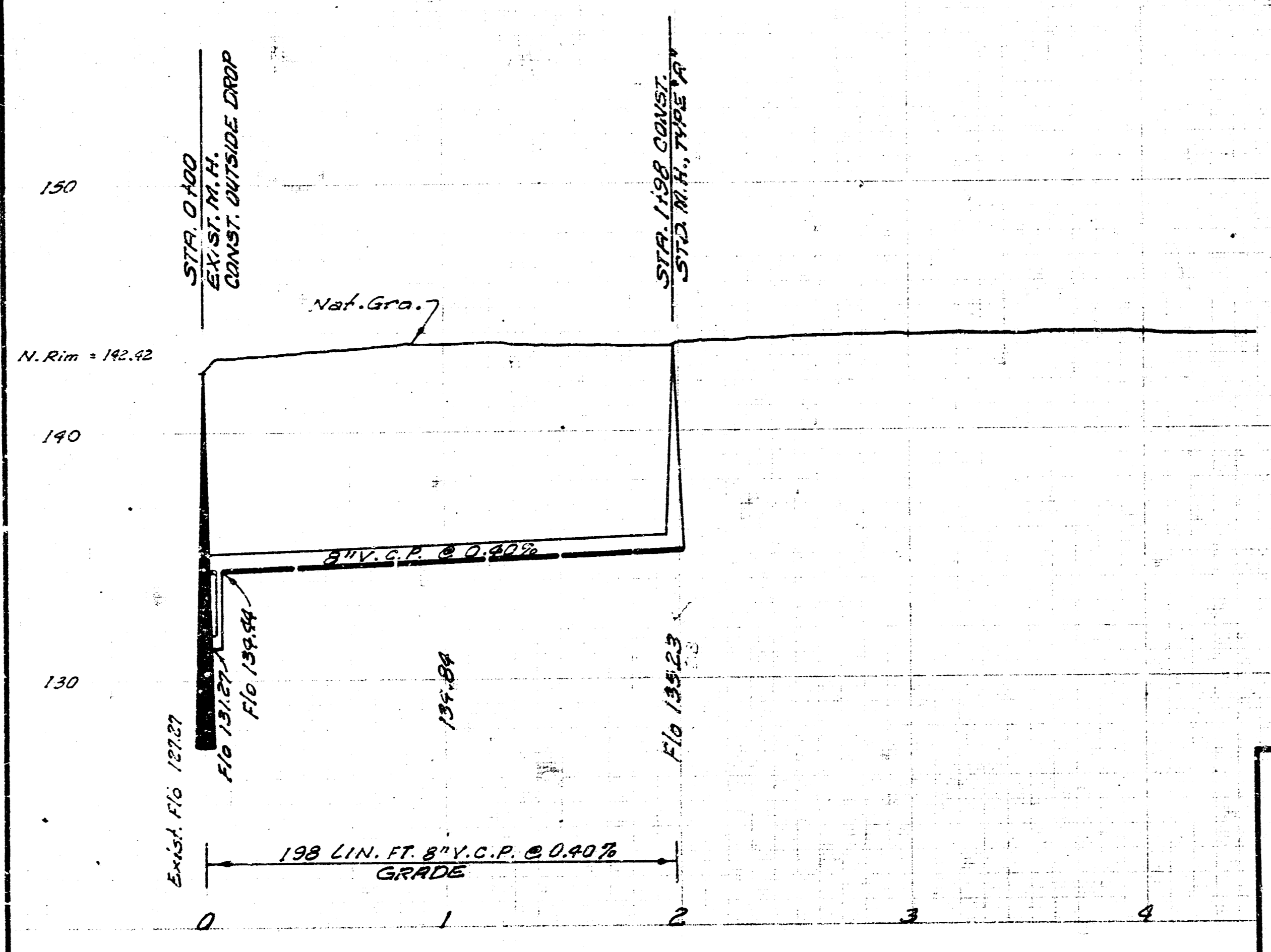

LAT. 32, WESTLINK S.S.
CITY OF WICHITA, KANS.
B. E. SMITH, CITY ENGINEER
PROJECT NO. C27-59
DATE: APRIL 1928

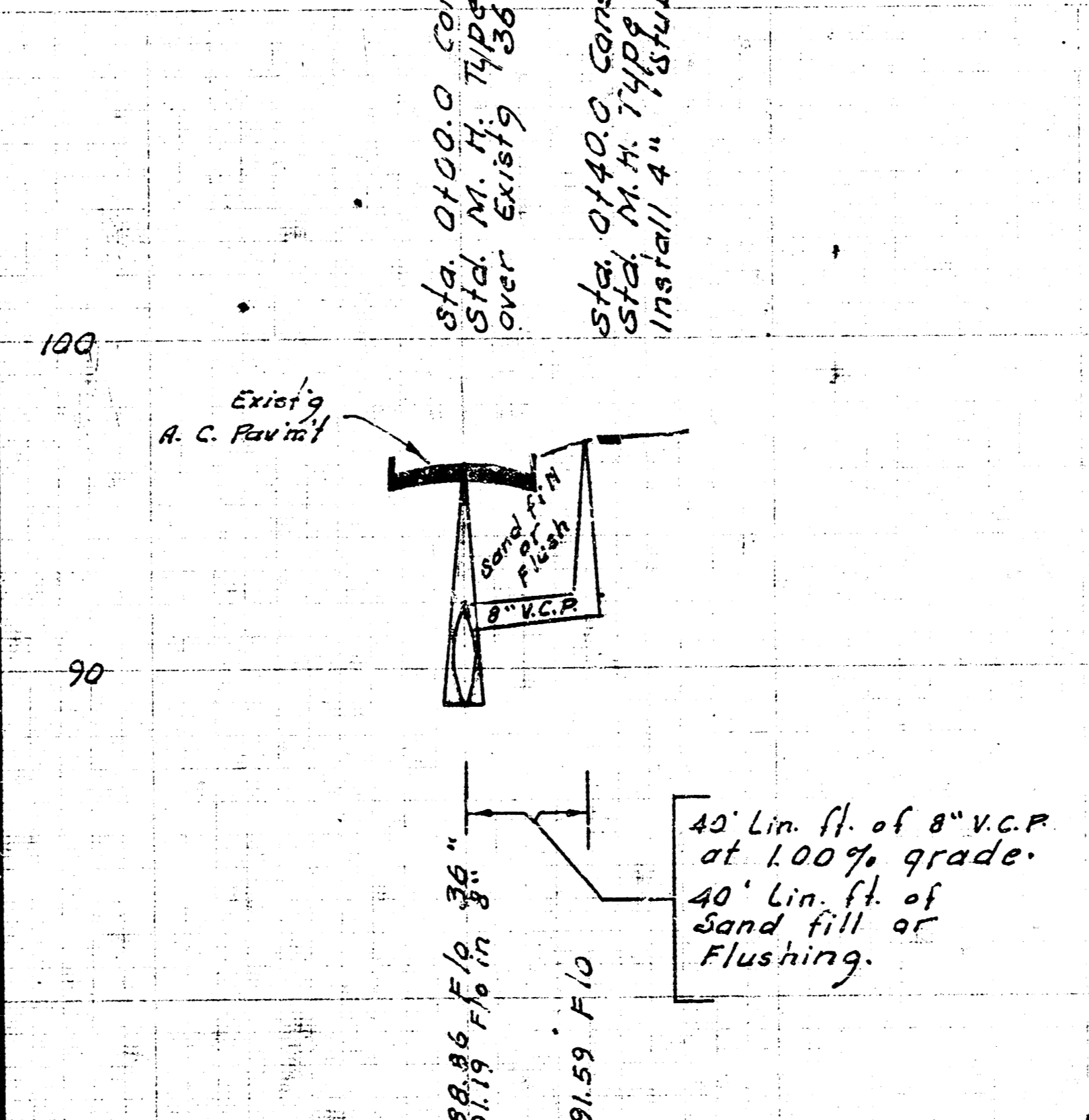

MOBIL OIL COMPANY
SANITARY SEWER
31ST ST. SO. & MERIDIAN
CITY OF WICHITA KANSAS
B. E. SMITH CITY ENGINEER
APRIL 1928 PRIVATE CONTRACT