

B.M. 146-11 TOP S. MIT. W. HUBBARD S.S. CROSS  
ON EASTERLY APPROX. 300' S. OF KELLUM

LATERAL 26 W.I.S.  
CITY OF WICHITA KANSAS  
B.E. SMITH, CITY ENGINEER  
PROJ. NO. C 23-76 DATE: Sept. 1950

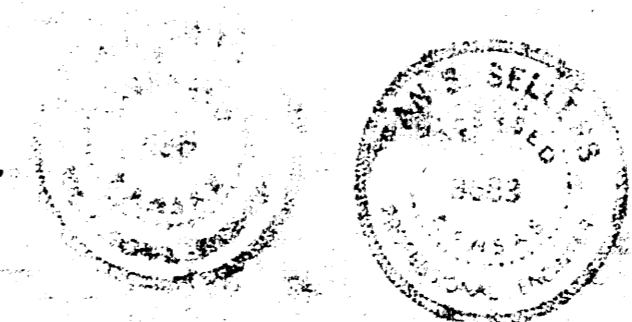

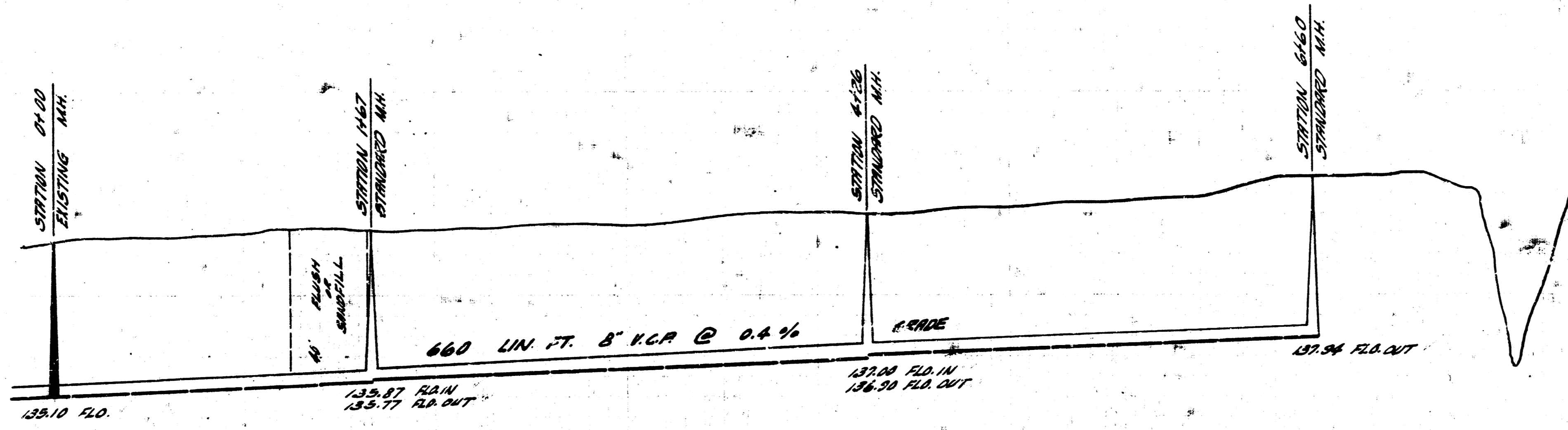

660 LIN. FT. 8" KCR @ 0.4% GRADE

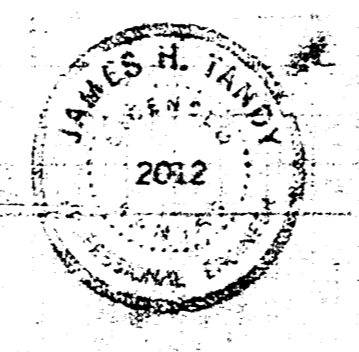
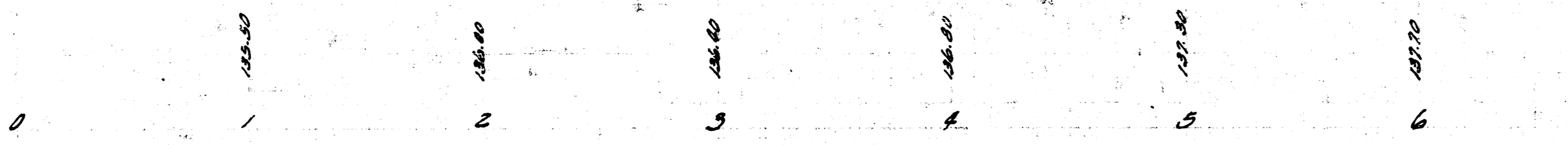

LAT. 20 W. 1.5  
 PROJ. C-29-708

