

B. M. 51.86 R.R. Spk. SW face Street light Pole SW cor Spruce & 47th St. So.
 B. M. 86.52 City Sid. west end North Hubbard to River Bridge 1/2 Mile E. of Hydraulic on 47th St. So.
 B. M. 85.00 NW cor conc. porch # 4732 So. Madison.

Plan Scale 1"=40'
 Profile Scale 1"=5' Vert.

NOTE: Replace all asphalt pavement.

CAUTION UNDERGROUND UTILITIES
 Please check with K G & E or Southwestern Bell Telephone Co. for Location

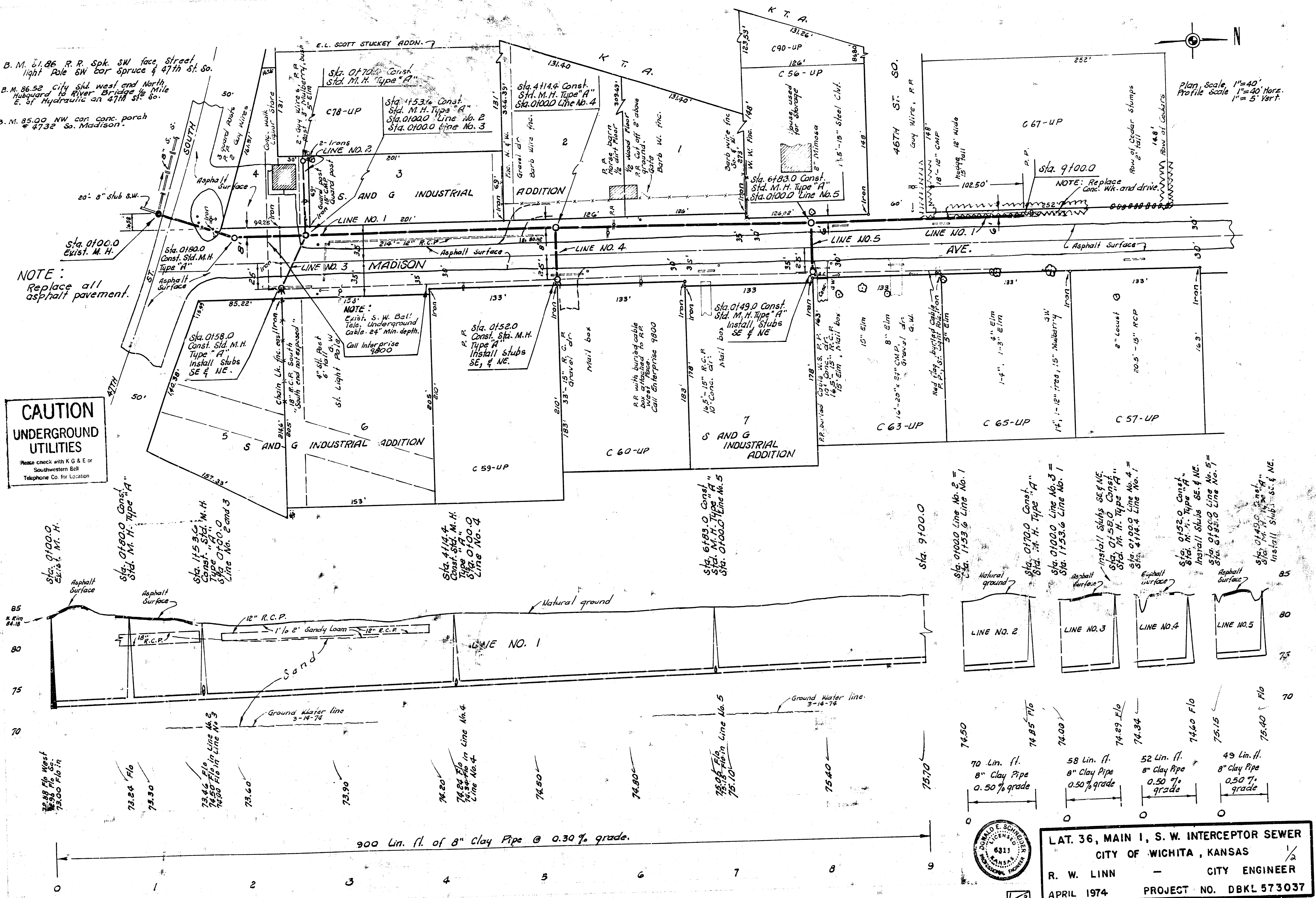

Station	Line No.	Length (Lin. ft.)	Pipe Size	Grade
74.50	LINE NO. 2	70	8" Clay Pipe	0.50% grade
74.85	LINE NO. 3	58	8" Clay Pipe	0.50% grade
74.00	LINE NO. 4	52	8" Clay Pipe	0.50% grade
74.29	LINE NO. 5	49	8" Clay Pipe	0.50% grade

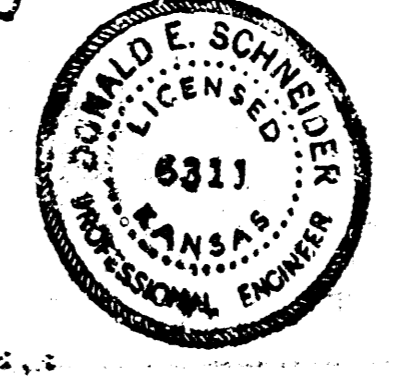

LAT. 36, MAIN I, S. W. INTERCEPTOR SEWER
 CITY OF WICHITA, KANSAS
 R. W. LINN - CITY ENGINEER
 APRIL 1974 PROJECT NO. DBKL 573037

CAUTION
UNDERGROUND UTILITIES
 Please check with K G & E or
 Southern Bell
 Telephone Co. for Location

NOTE:
 Exist. S.W. Bell
 Telephone underground
 Cable, 24" min. depth,
 Call Enterprise
 4800

NOTE:
 Replace all asphalt
 Pavement.

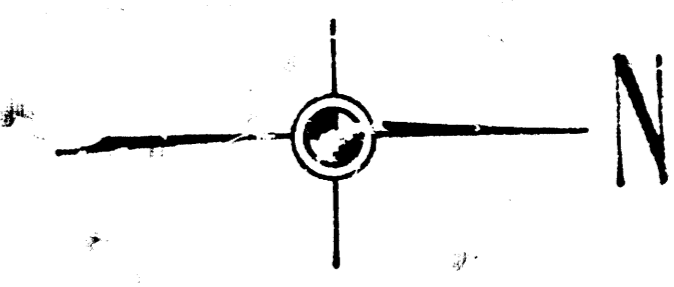
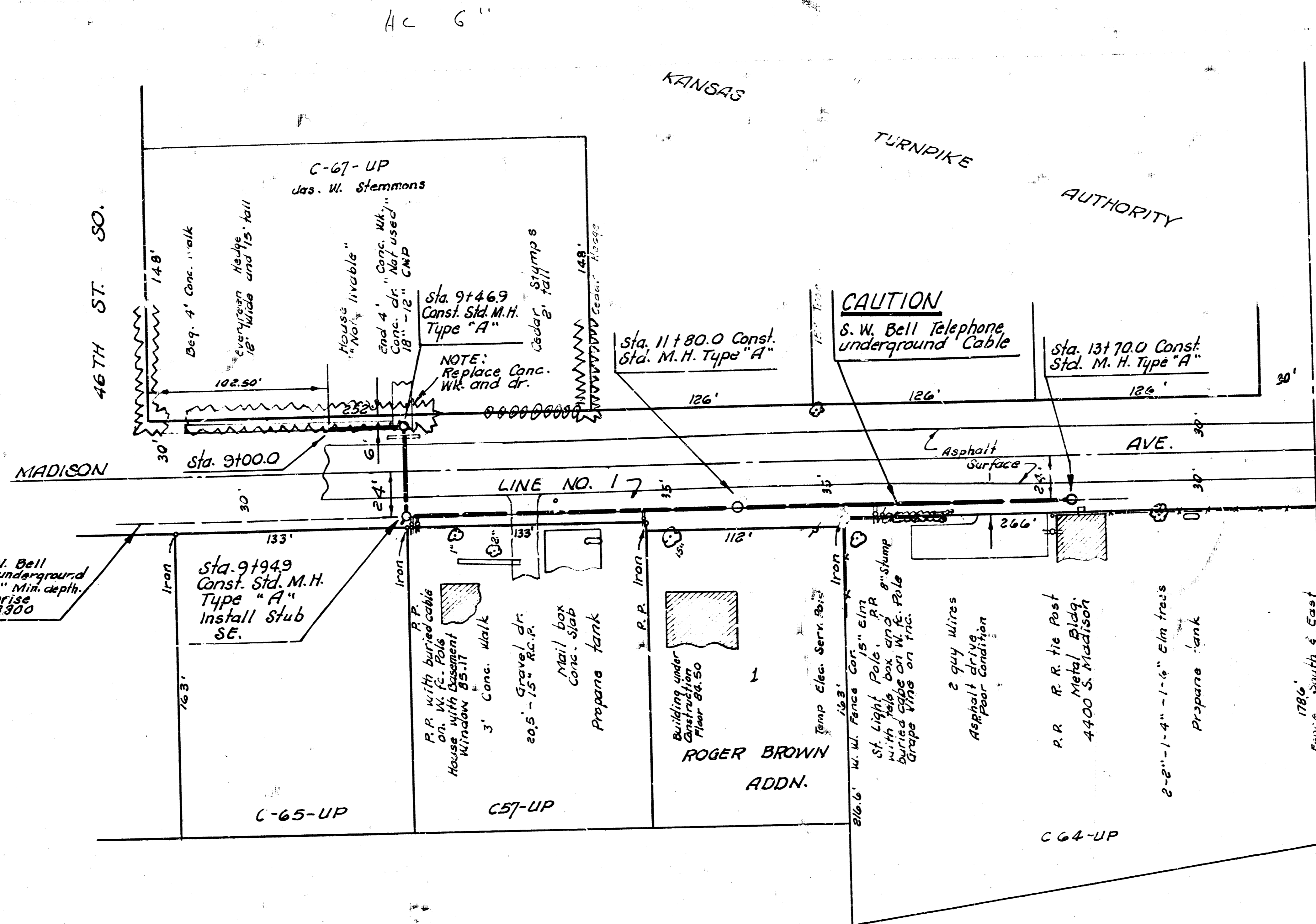

B. M. 85.50 4W cor. bot. conc.
 Step 4644 So. Madison.

85
80
75
70

85
80
75
70

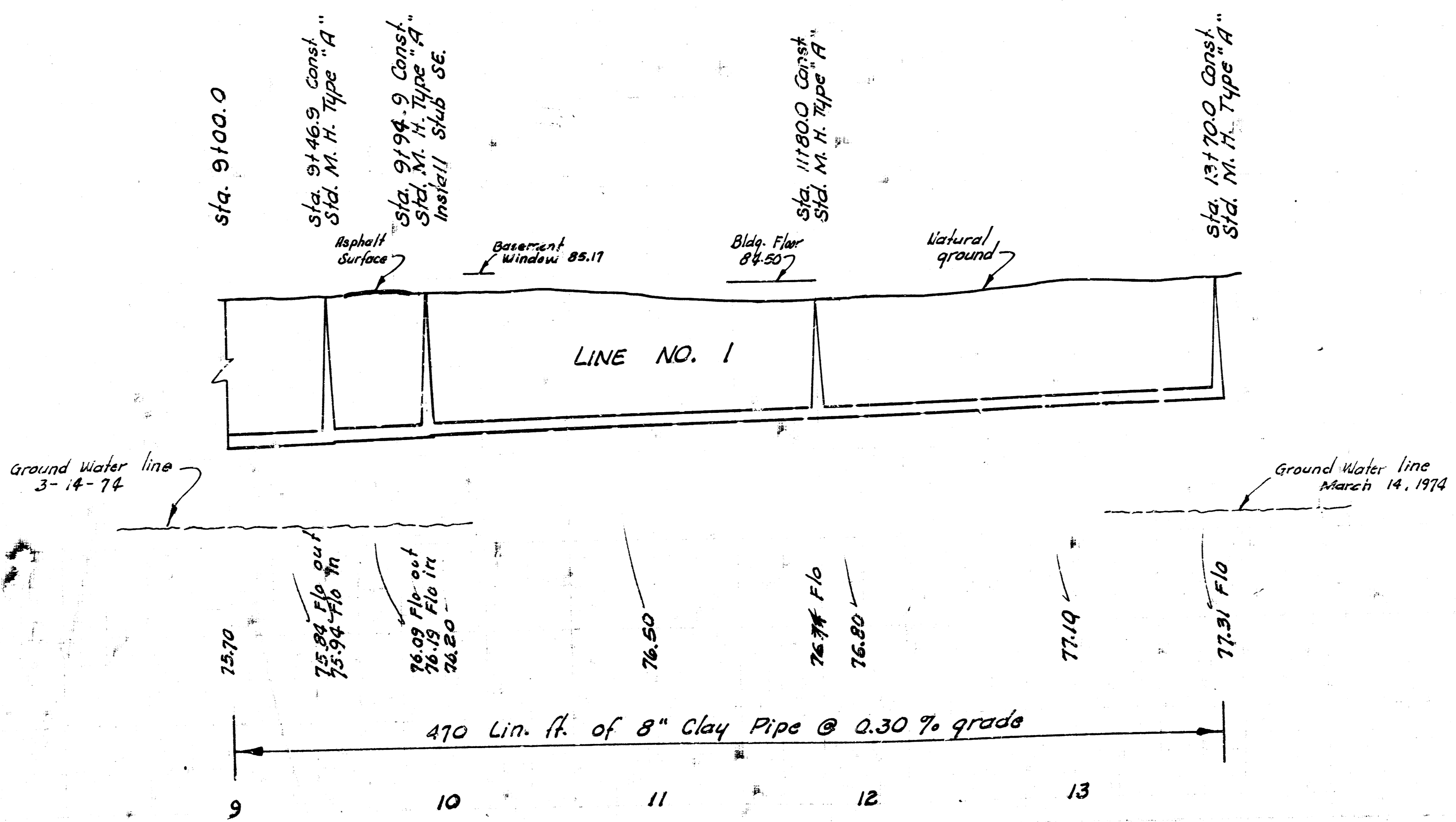

LAT. 36, MAIN I S. W. INTERCEPTOR SEWER
 PROJECT NO. DBKL57 3037

266-7432