

Scale: 1" = 40' Plan
 1" = 40' Profile
 Vert. 1" = 5'

Bench Marks: 88.11 - City Std. Disc. 44' W and 42' N. of E. of 43rd St. S. and Hydraulic.
 84.79 - "D" Top of Curb, East side of Washington Ave. @ South end of South return on 44th St. S.

THE CONTRACTOR SHALL BE RESPONSIBLE FOR OBTAINING ALL NECESSARY PERMITS AND RESERVING ALL RIGHTS. THE CONTRACTOR SHALL BE RESPONSIBLE TO RE-ESTABLISH ANY PROPERTY LINES WHICH ARE DAMAGED OR DESTROYED BY HIS CONSTRUCTION OPERATIONS SUCH AS DIPS SHALL BE RE-ESTABLISHED BY A LICENSED LAND SURVEYOR OR A LICENSED PROFESSIONAL ENGINEER IN ACCORDANCE WITH STATE LAWS.

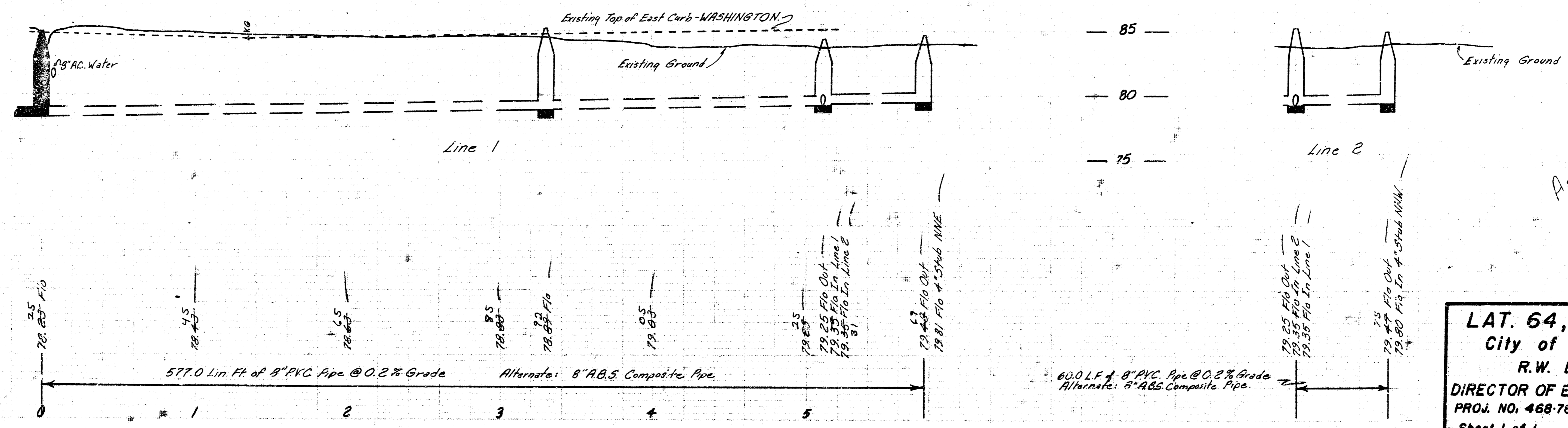
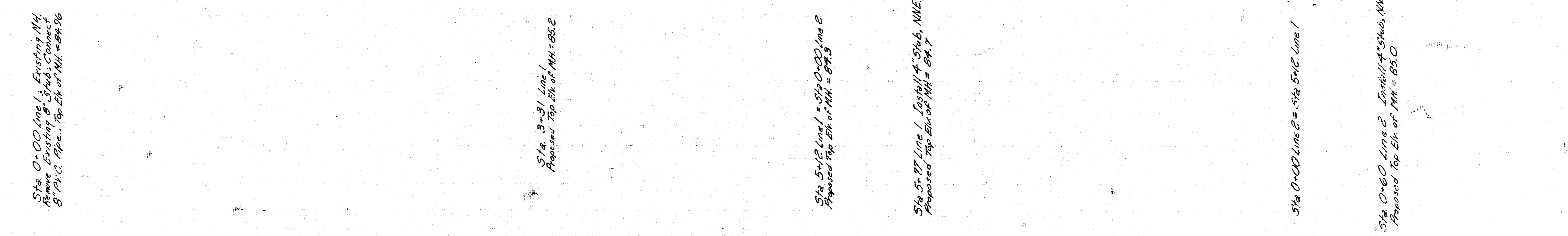

LAT. 64, MAIN 1, S.W.1.
 City of Wichita, Kansas
 R.W. BRUGGEMAN
 DIRECTOR OF ENGINEERING/CITY ENGR.
 PROJ. NO. 468-76-243-81139-000-000-001
 Sheet 1 of 1 Date

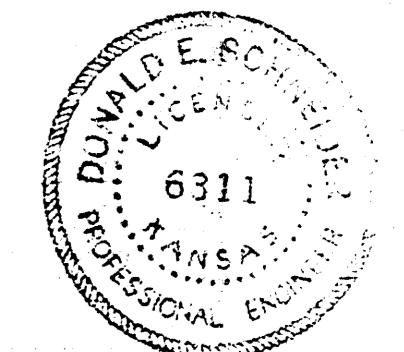

A.S. Built
 J.L.L.
 6-85