

LATERAL 42, MAIN 3, SOUTHWEST INTERCEPTOR SEWER

PROJECT NO. 468-76-245-81620-000-000-001

CITY OF WICHITA, KANSAS

MICHAEL E. LINDEBAK, CITY ENGINEER

FEBRUARY, 1987

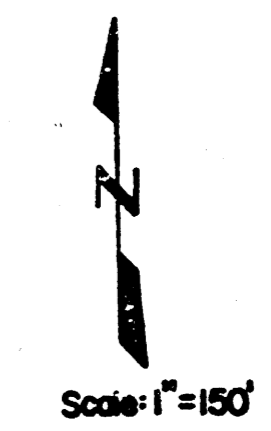
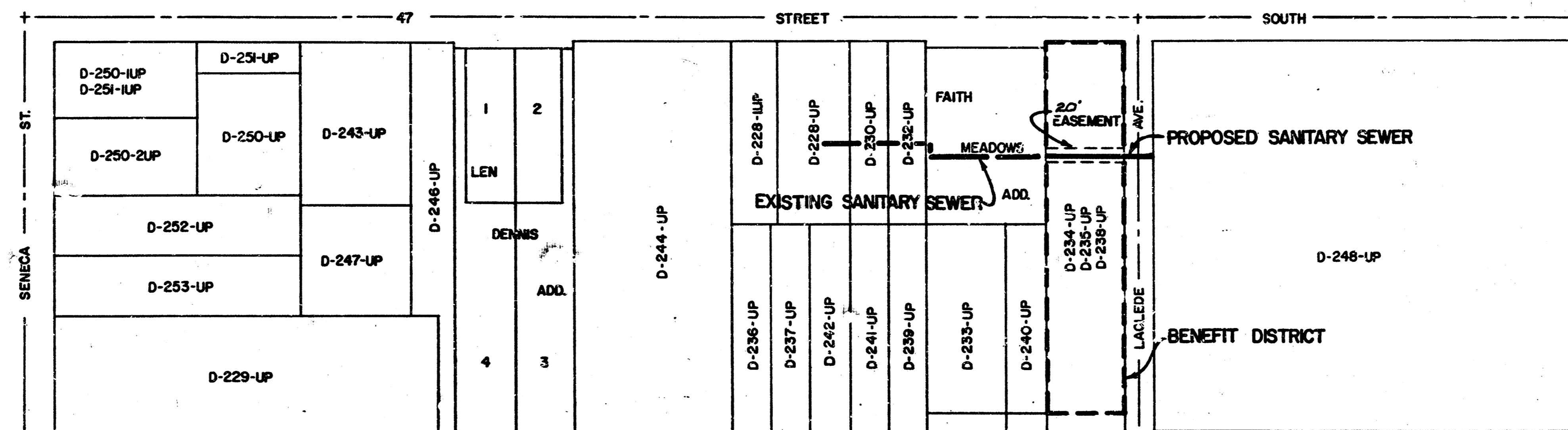

*AS BUILT  
RAL  
5-26-87*

NOTE:  
The City of Wichita will air test and release the new line prior to acceptance.

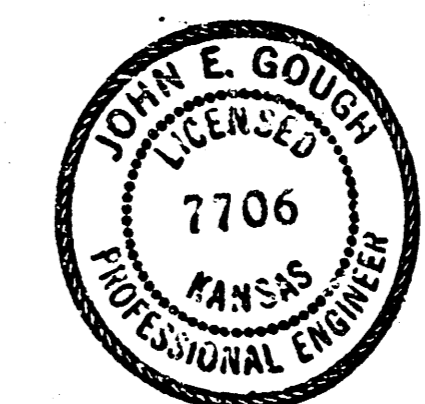

WICHITA, KANSAS SANITARY SEWER EXTENSIONS			
LAT. 42, MAIN 3, SOUTHWEST INTERCEPTOR SEWER MAP AND BENEFIT DISTRICT			
CASTLE & ASSOCIATES ENGINEERS WICHITA, KANSAS	DR JMK CH	DWG FILE NO 8653-D-60,037	REV
DATE February 1987	APP	SHEET NO 1 OF 2	1/2

FILMED FROM THE BEST AVAILABLE COPY.....

