

B.M. 13016 City Sid E and N curb of bridge, Maple Flood Control ditch
 B.M. 12185 City Sid Dugan & Maple, 337 N. E. 343' S. of E both
 B.M. 12084 RR spike W side power pole SW cor Annapolis & Maple
 B.M. 11944 RR spike W side power pole 78' E of C.C. Brunmetts S side Maple
 B.M. 12987 SW cor Neura Wend Flood Control Bridge, Maple E ditch

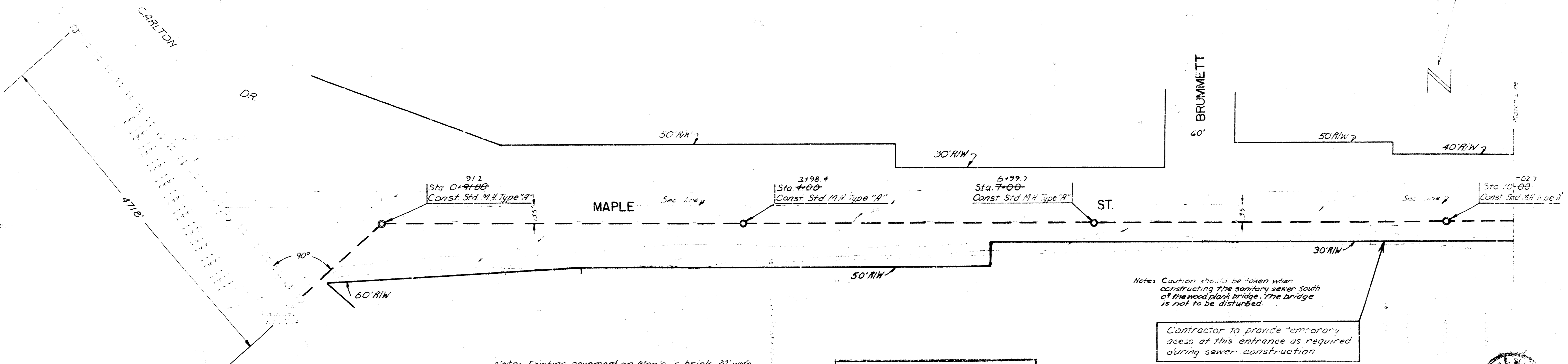

Note: Existing pavement on Maple is brick 20' wide with asphalt overlay and widening. Contractor to construct sewer by removing and replacing asphalt widening along north side only. Any brick surfaced pavement adjacent to and south of the asphalt widening that is damaged during construction shall be replaced with equal thickness of concrete pavement without additional compensation.

ALL FLO ELEVATIONS WERE RAISED ONE FOOT.

Note: Caution should be taken when constructing the sanitary sewer south of the flood plain bridge. The bridge is not to be disturbed.

Contractor to provide temporary access at this entrance as required during sewer construction.



Plan Scale 1"=40'
 Profile Scale Hor. 1"=40'
 Profile Scale Ver. 1"=5'

"AS BUILT" FINAL MEASUREMENTS JAK10

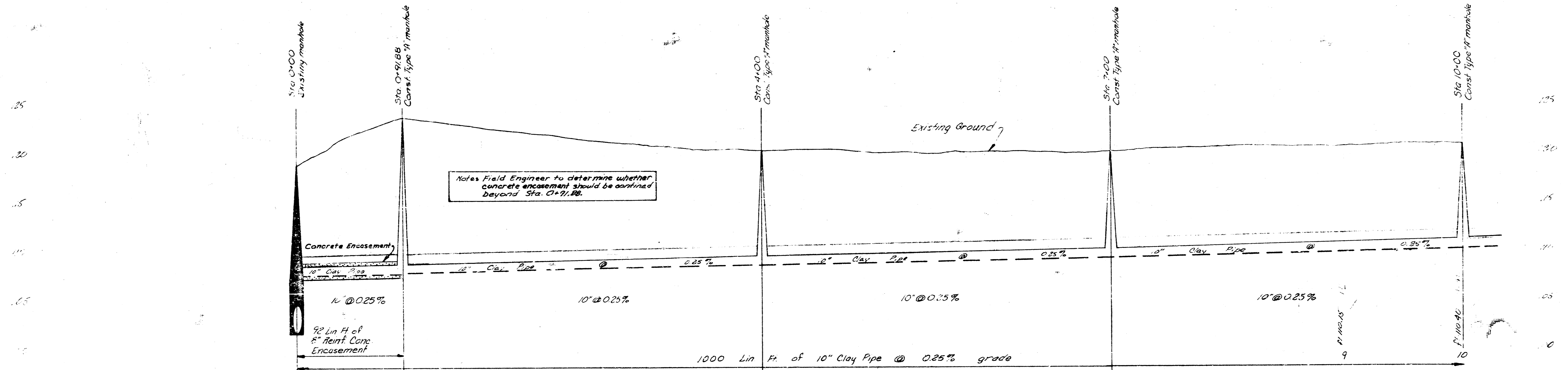

Note: Field Engineer to determine whether concrete encasement should be continued beyond Sta. 0+91.88.

R. W. LINN CITY ENGINEER
 CITY of WICHITA, KS
 MAIN 6, S W INTERCEPTOR
 PROJECT NO DBKM572032
 SHEET 1 of 3 DATE 7-72

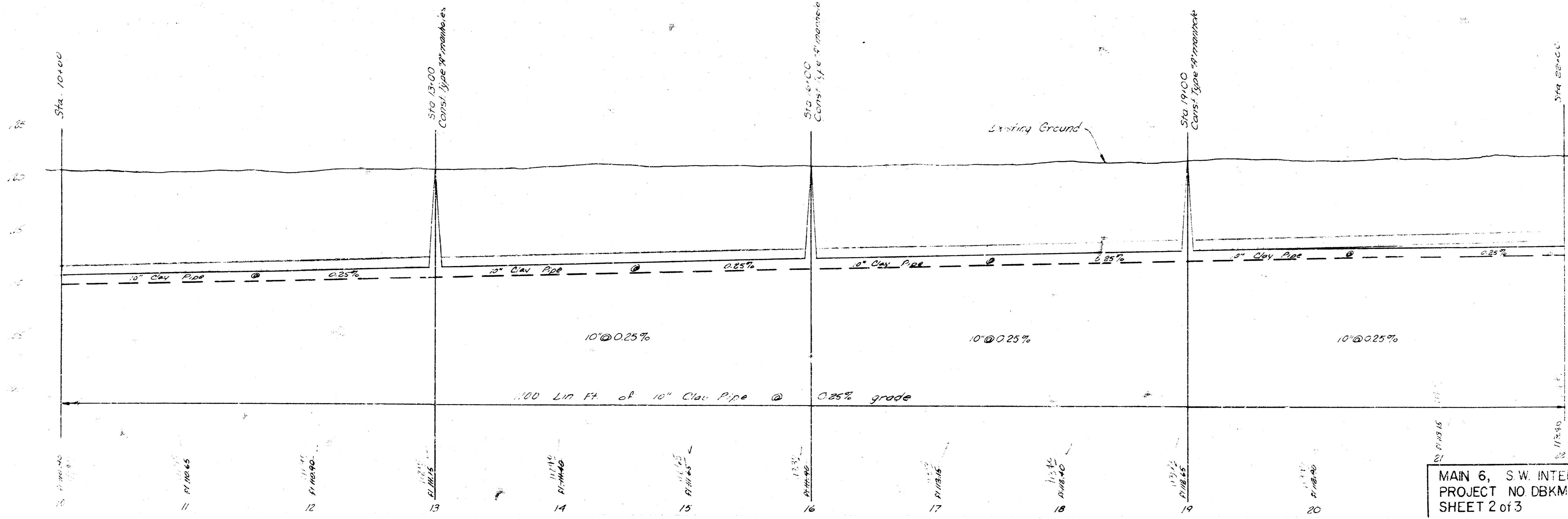
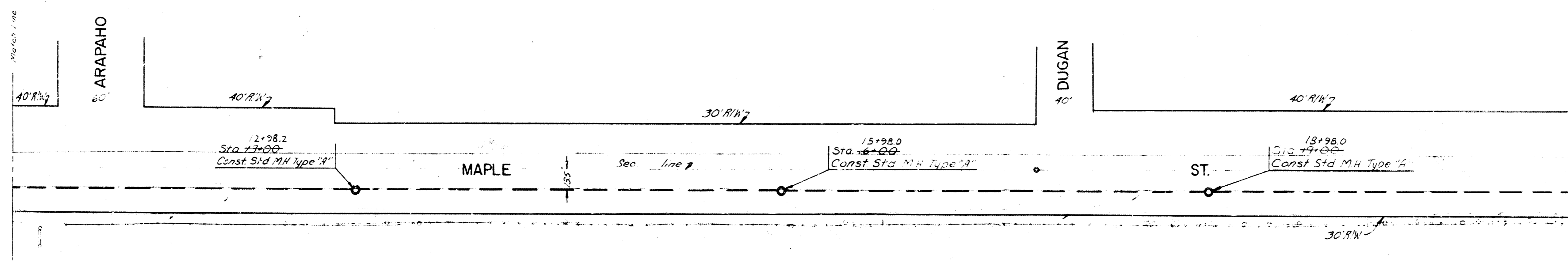

Plan Scale 1"=40'
 Profile Scale 1"=40'
 Profile Scale Ver 1"=5'

MAIN 6, S.W. INTERCEPTOR
 PROJECT NO DBKM 572032
 SHEET 2 of 3 DATE 7-72

3.M 2581 00E of E. Ceymarie 57 ft spike N side power pole 3 side Maple

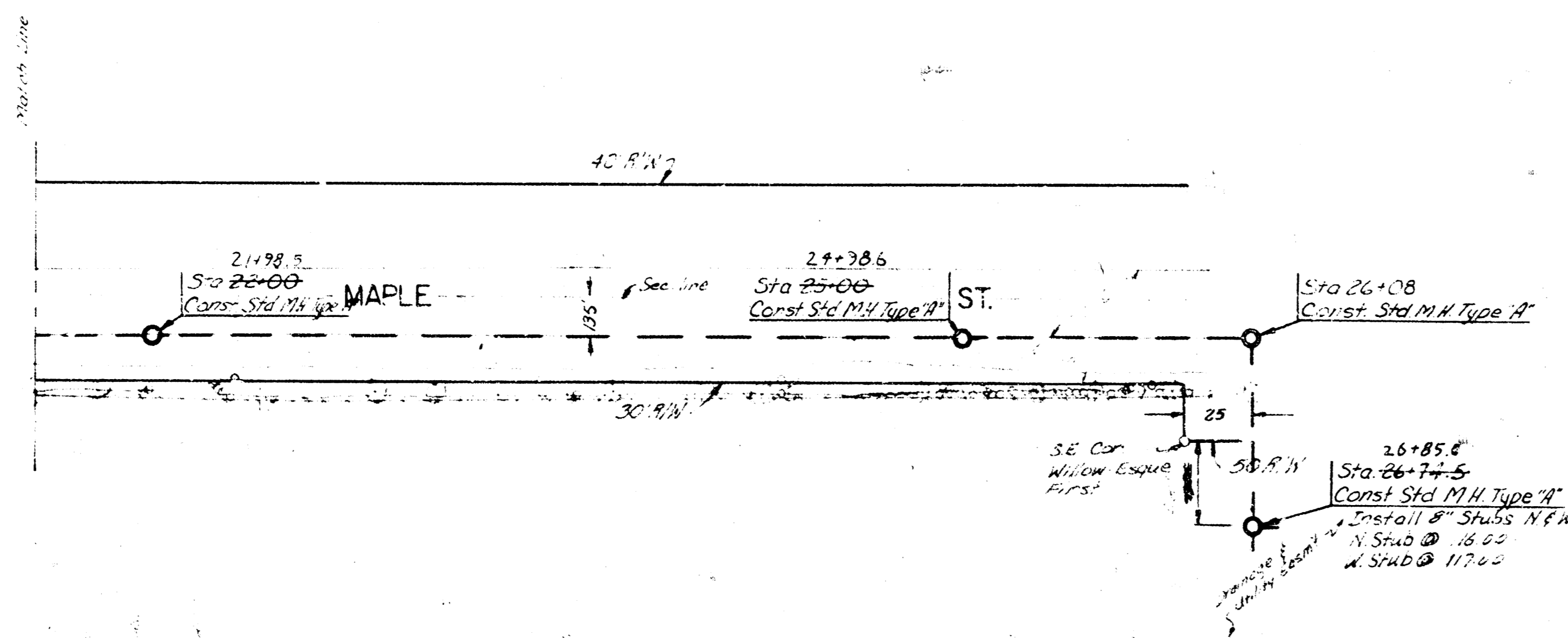

GENERAL NOTES:

1. The Contractor shall be responsible for all settlement of backfill which may occur within one year after final completion of the project. The contractor shall make all repairs, be made, all necessary backfill, replacement, repairs within thirty days after notice from the Engineer.
2. Cost of removing & replacing mailboxes, road signs, etc. shall be incidental to the project.
3. No direct payment will be made for the removal of any asphalt paving encountered on this project.
4. The Contractor shall replace all asphalt roadway removed during sewer construction. The roadway shall be 8' from E. side Maple and 3' from S. side shoulder constructed extending from the West edge of Maple. The pavement replacement shall be on a properly compacted subgrade with 4" of asphalt base course and 2" of asphalt surface course (Type SR) as specified in the City of Wichita asphalt pavement specifications. The bid sum shall include the removal & replacement of any other material necessary to complete the work.
5. All road ditches shall be graded for proper drainage & restored to their original condition.
6. Sawing of existing pavement shall not be paid for directly and shall be included in the bid price for Asphalt widening Removed and Replace.

Plan Scale 1" = 40'
Profile Scale Hor. 1" = 40'
Profile Scale Ver. 1" = 5'

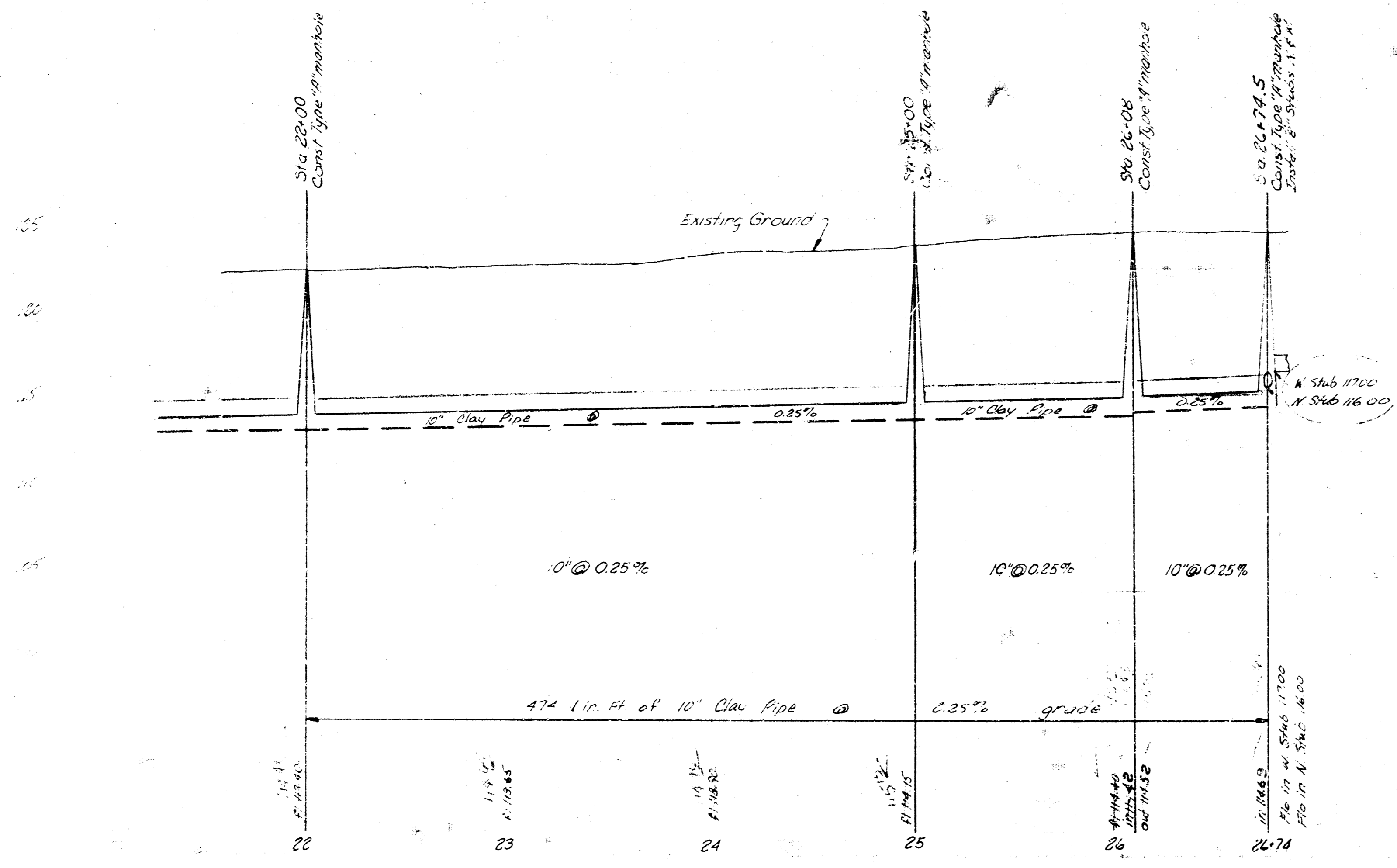

MAIN 6, S.W. INTERCEPTOR
PROJECT NO DBKM 572032
SHEET 3 of 3 DATE 7-72

14 4 5 2