

Note:
 0+0 M.H. is in alley & due E. of
 M.H. in 17th St.

0+0 M.H. Elev 106.79 OUT
 Elev 110.00 IN

1+83 M.H.
 Elev 110.16

1+4
 Elev 110.54

2+5
 Elev 110.17

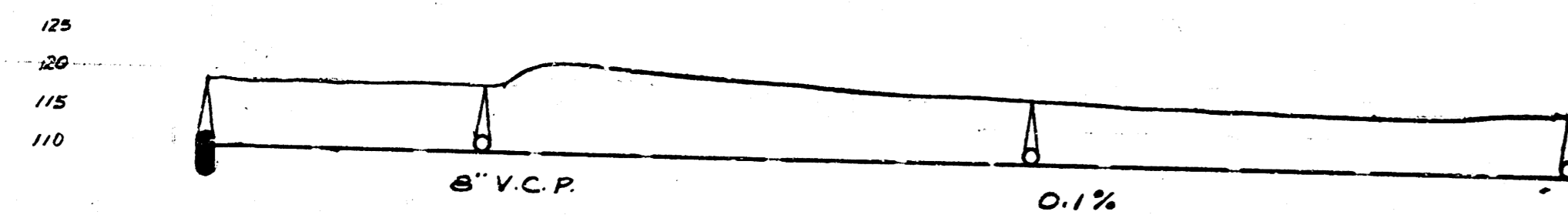

BM 118.23 K in Kester Ct. NW Co. NE Cor. 17th & Mosley
 BM 119.50 Step bench in P.R. N.S. 18th & E.S. Alley W. Mosley

LAT. 29, S.S. #20

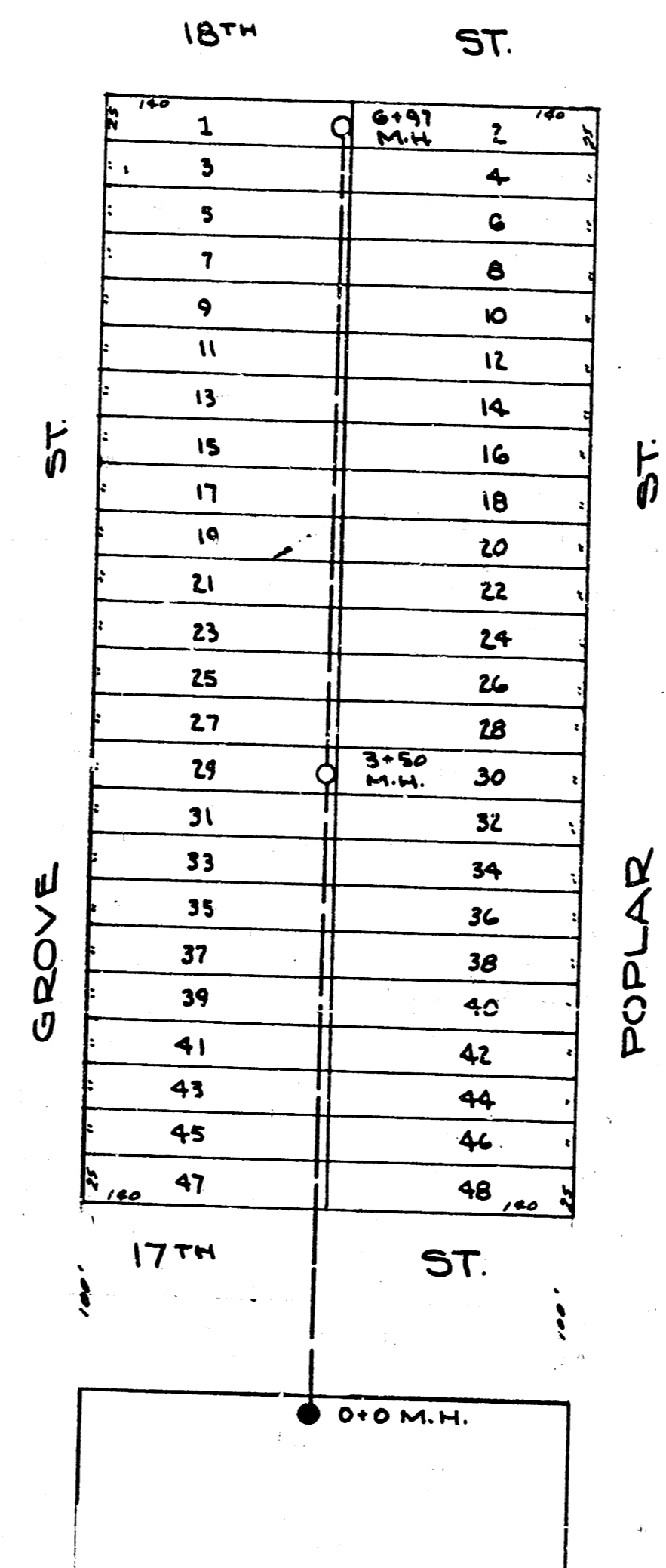

0+0 M.H.
 Elev 117.89 OUT
 Elev 118.00 IN

1+83 M.H.
 Elev 117.18

2+5 M.H.
 Elev 118.00

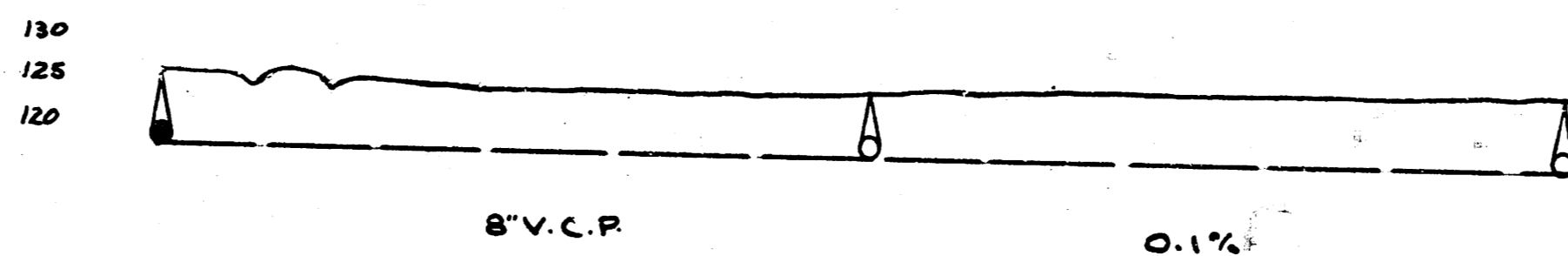

BM 126.00 R.R. Spike W.S. P.R. S.S. 17th bet. Grove & Poplar
 BM 128.40 S.W. Cor. Conc. Headwall Cave Entrance Rear No. 1856 Grove

LAT. 5, DIST. T, S.S. #12

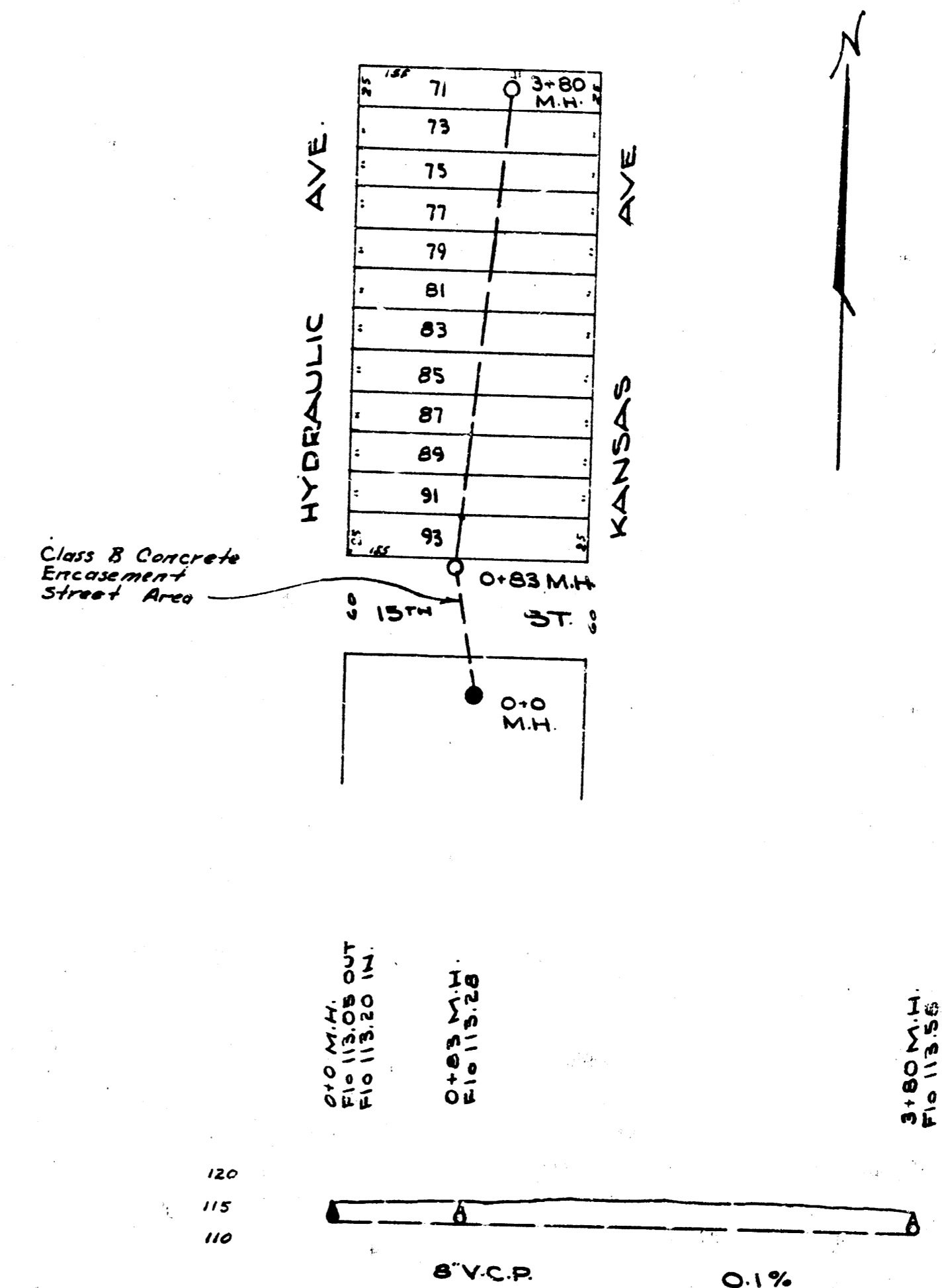

0+0 M.H.
 Elev 115.00 OUT
 Elev 115.00 IN

1+83 M.H.
 Elev 115.44

2+5 M.H.
 Elev 115.44

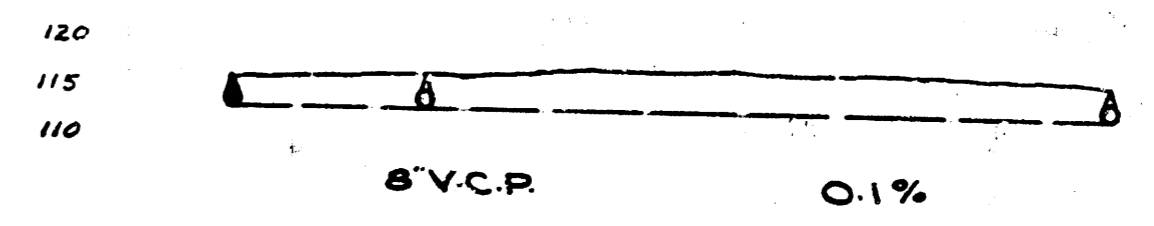

BM 115.44 Top Thim C Hyd. & 15th

LAT. E, DIST. R, S.S. #12

DEPARTMENT of SERVICE
 CITY OF WICHITA, KANSAS
 ENGINEERING DIVISION
 L.K. WHITE - CITY ENGINEER
 SANITARY SEWER
 SCALE 1"=80' APRIL 1941
 LAT. 29, S.S. #20
 LAT. E, DIST. R, S.S. #12
 LAT. 5, DIST. T, S.S. #12