

- GENERAL NOTES
1. ALL CLAY PIPE SHALL BE EXTRA STRENGTH.
 2. SAND FILL AND FLASHING WILL NOT BE PAID FOR SEPARATELY AND THESE COSTS ARE TO BE INCLUDED IN THE UNIT PRICE BID FOR EACH PIPE.
 3. CONTRACTOR'S CONSTRUCTION METHODS SHALL BE SUCH THAT WILL PROVIDE CONTINUOUS FLOW OF SEWAGE DURING CONSTRUCTION OF THIS PROJECT. CONTRACTOR'S METHOD OF HANDLING EROSION SHALL BE LEFT WITH THE APPROVAL OF THE ENGINEER.
 4. MANHOLES TO BE ABANDONED SHALL HAVE THE TOP FOUR FEET REMOVED WITH THE REMAINING PORTION FILLED WITH SAND.
 5. ALL AREAS DISTURBED DURING CONSTRUCTION SHALL BE LEVISED AND GRADED TO MATCH ADJACENT GROUND ELEVATIONS WITHOUT DEPRESSIONS WHICH WOULD POOD WATER.
 6. CONTRACTOR'S GRASS RESTORATION METHODS SHALL BE SUCH THAT WILL PREVENT ANY DAMAGE TO GOLF GREENS. ANY DAMAGE TO GOLF GREENS BY CONTRACTOR'S OPERATIONS SHALL BE REPAIRED BY THE CONTRACTOR TO THE SATISFACTION OF THE PARK DEPARTMENT WITHOUT ANY ADDITIONAL COMPENSATION.

NOTE: ALL WORK INDICATED ON THIS SHEET IS NOT A PART OF THIS PROJECT. THIS SHEET IS FURNISHED FOR INFORMATION ONLY.

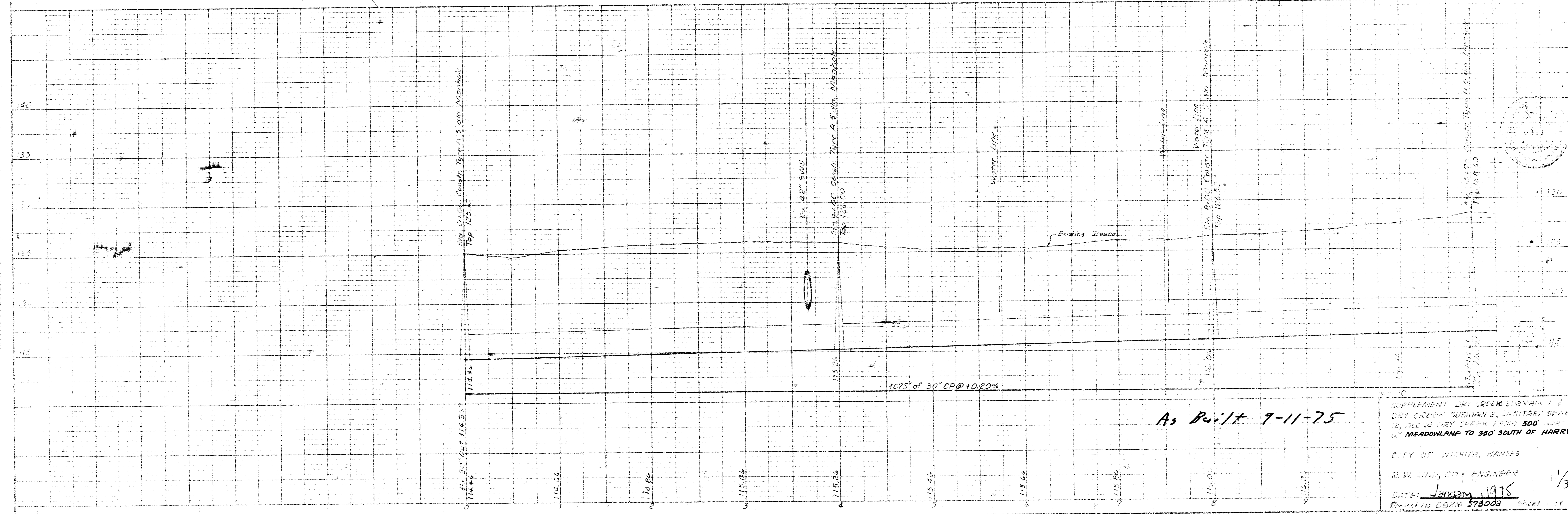

As Built 7-11-75

SUPPLEMENT DRY CREEK SEWER MAIN & DRY CREEK SEWER & SANITARY SEWER TO DRY CREEK FROM 300' NORTH OF MEADOWLAND TO 350' SOUTH OF HARRY.
 CITY OF WICHITA, KANSAS
 R. W. LIND, CITY ENGINEER
 DATE: January 1978
 Project No. LBPM 574003 Sheet 1 of 3

FILMED FROM THE BEST AVAILABLE COPY.....

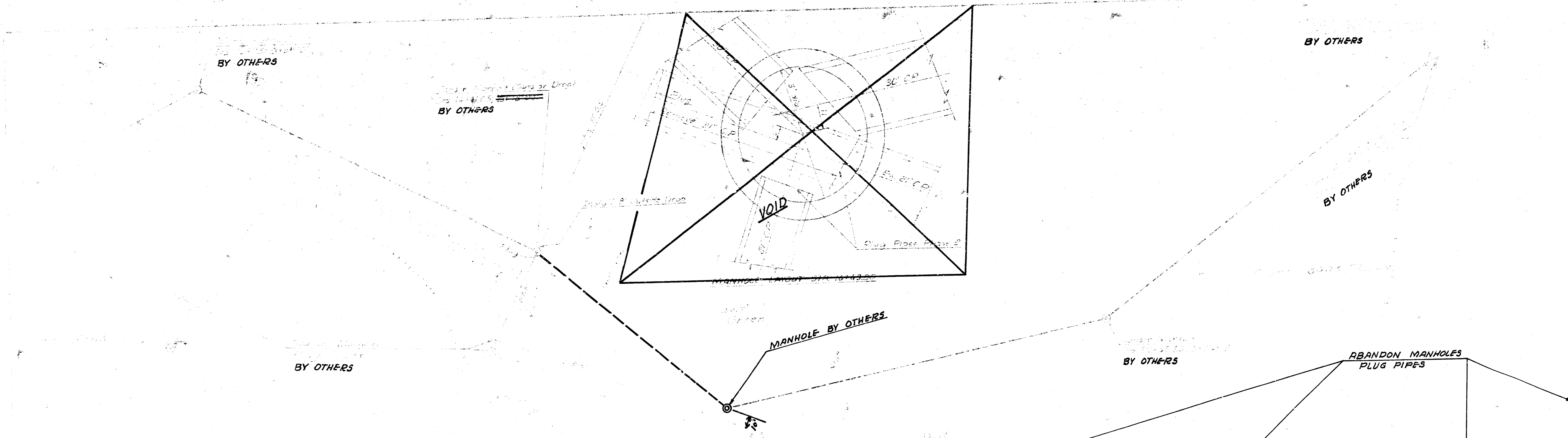

NOTE: ALL WORK INDICATED ON THIS SHEET IS NOT A PART OF THIS PROJECT EXCEPT FOR THE ABANDONMENT OF FIVE MANHOLES AND THE PLUGGING OF PIPES THEREIN.

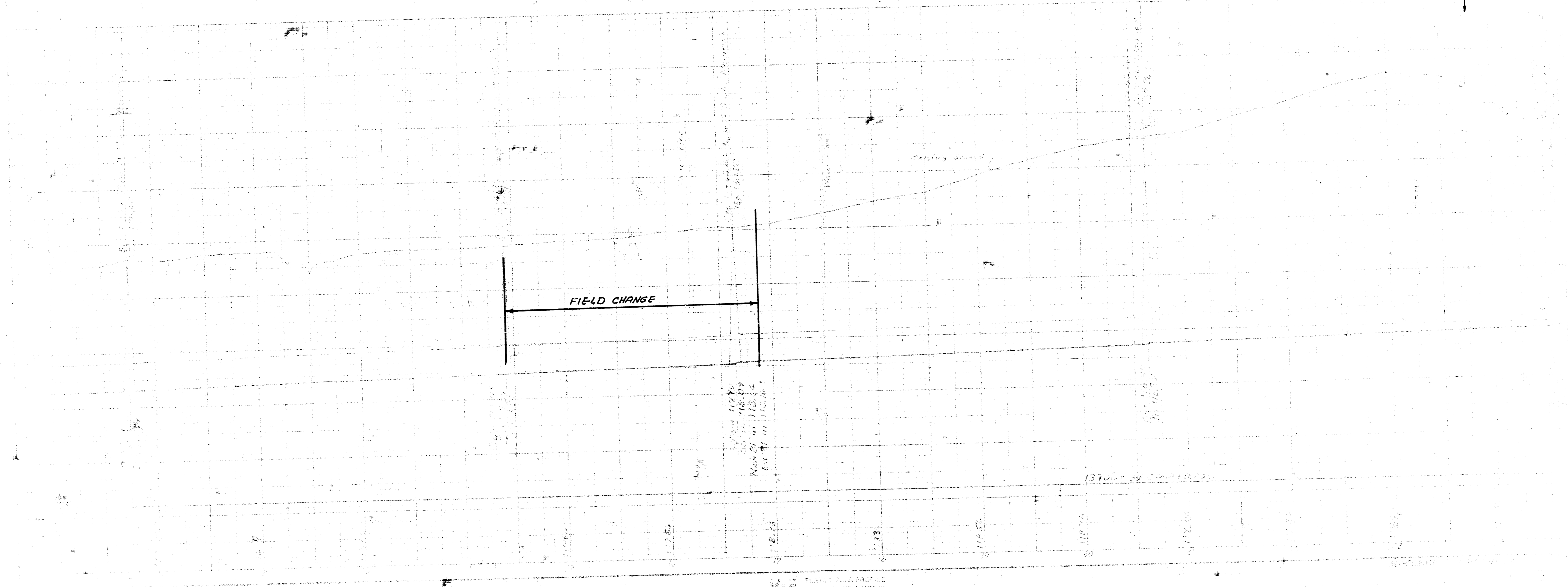

FILMED FROM THE BEST AVAILABLE COPY

PLAN 183,433 City Sid on W. 1/2 1/4 to road on N. 1/2 1/4 of D.P. on Harry

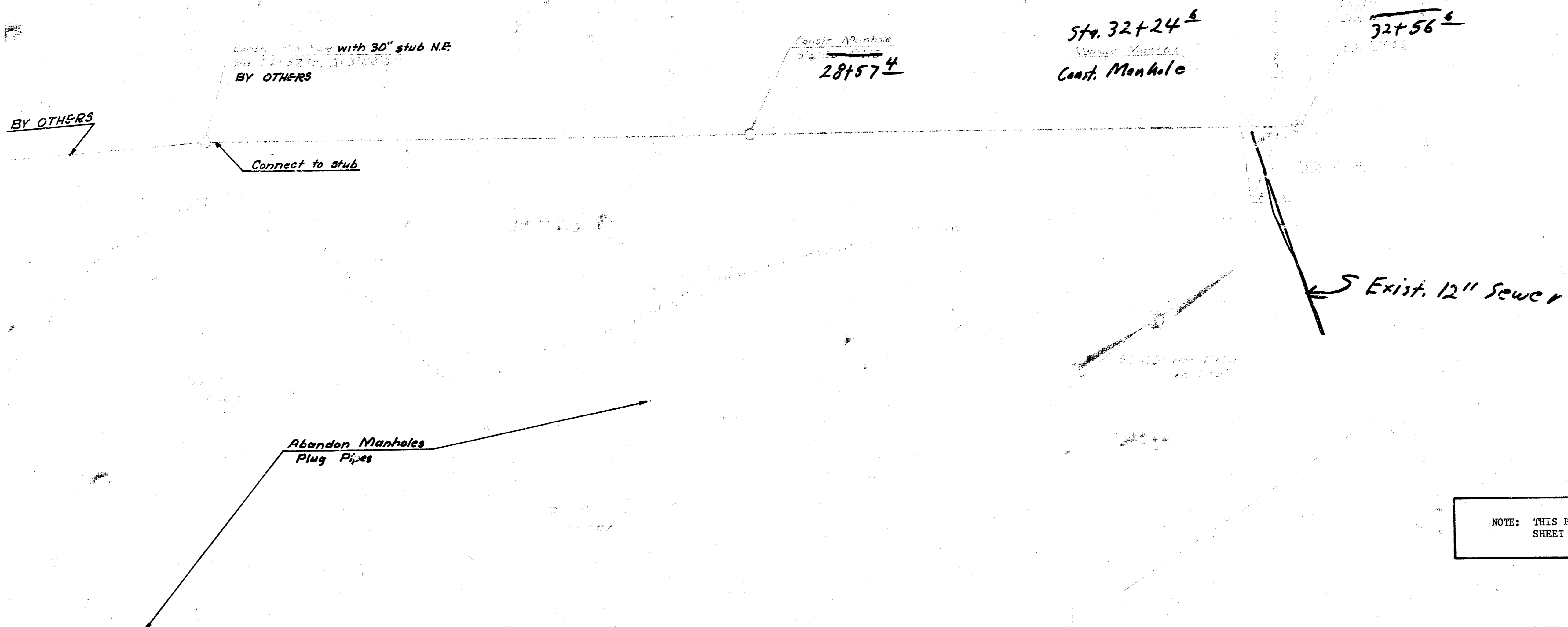

Const. Manhole with 30" stub N.E. BY OTHERS

Const. Manhole 28+57 4

Sta. 32+24 6 Const. Manhole

32+56 6

BY OTHERS

Connect to stub

Exist. 12" Sewer

Abandon Manholes Plug Pipes

NOTE: THIS PROJECT INCLUDES ALL WORK ON THIS SHEET EXCEPT AS OTHERWISE NOTED.

CONNECT TO STUB

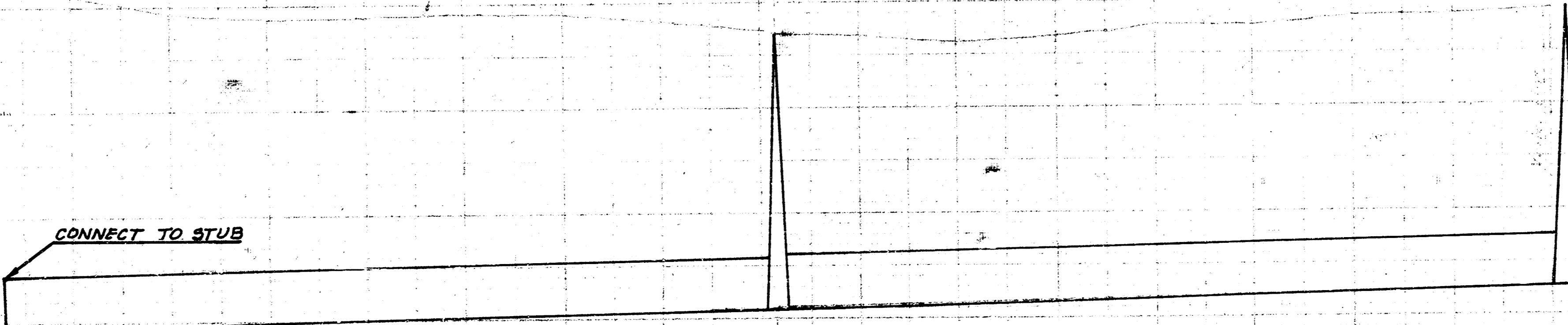

FILMED FROM THE BEST AVAILABLE COPY