

FIELD NOTES - James Tandy memo, 11/5 7-16-51
 Drawn by - Sump Seal 4-27-51
 Checked by -

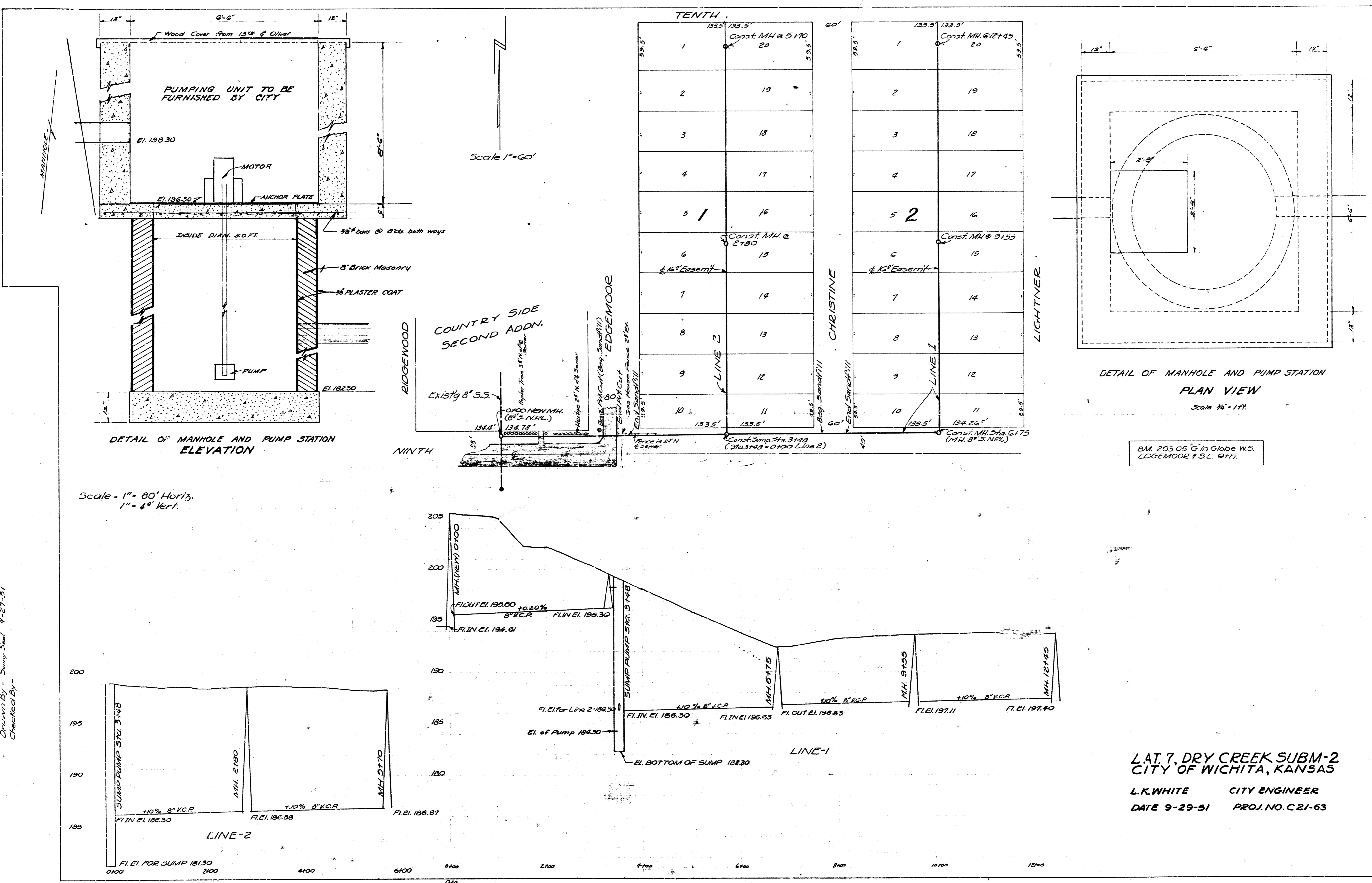

Scale = 1" = 80' Horiz.
 1" = 4' Vert.

B.M. 203.05 G in Globe W.S.
 EDGEMOOR E.S.L. 917.

LAT. 7, DRY CREEK SUBM-2
 CITY OF WICHITA, KANSAS
 L.K. WHITE CITY ENGINEER
 DATE 9-29-51 PROJ. NO. C21-53