

LAT. G., DIST. C  
S.S. No. 20

B.M. 10180 "K" in Kerker bk. of walk SE cor Fannie & Harry  
104.53 Top of 15" Mason step on Tel. pole (a side)  
N.W. cor alley & Levy.

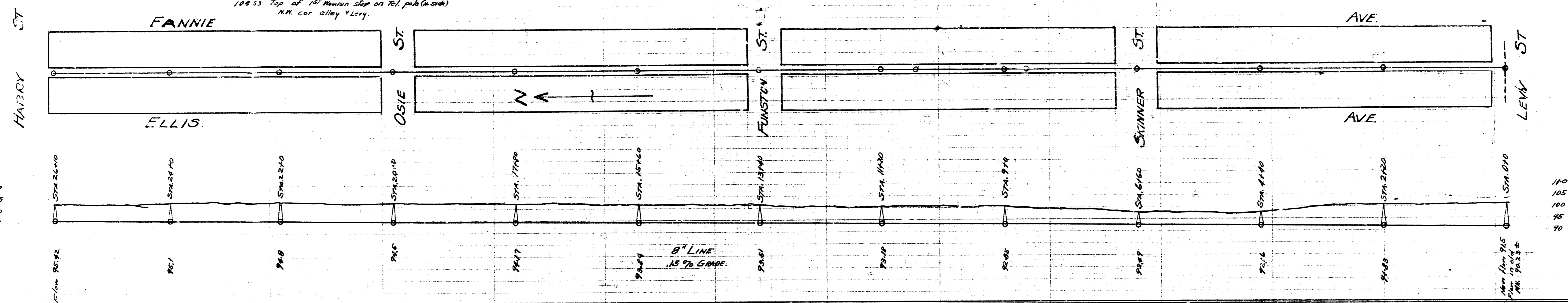

LAT. 7 - DIST. C  
S.S. No. 20

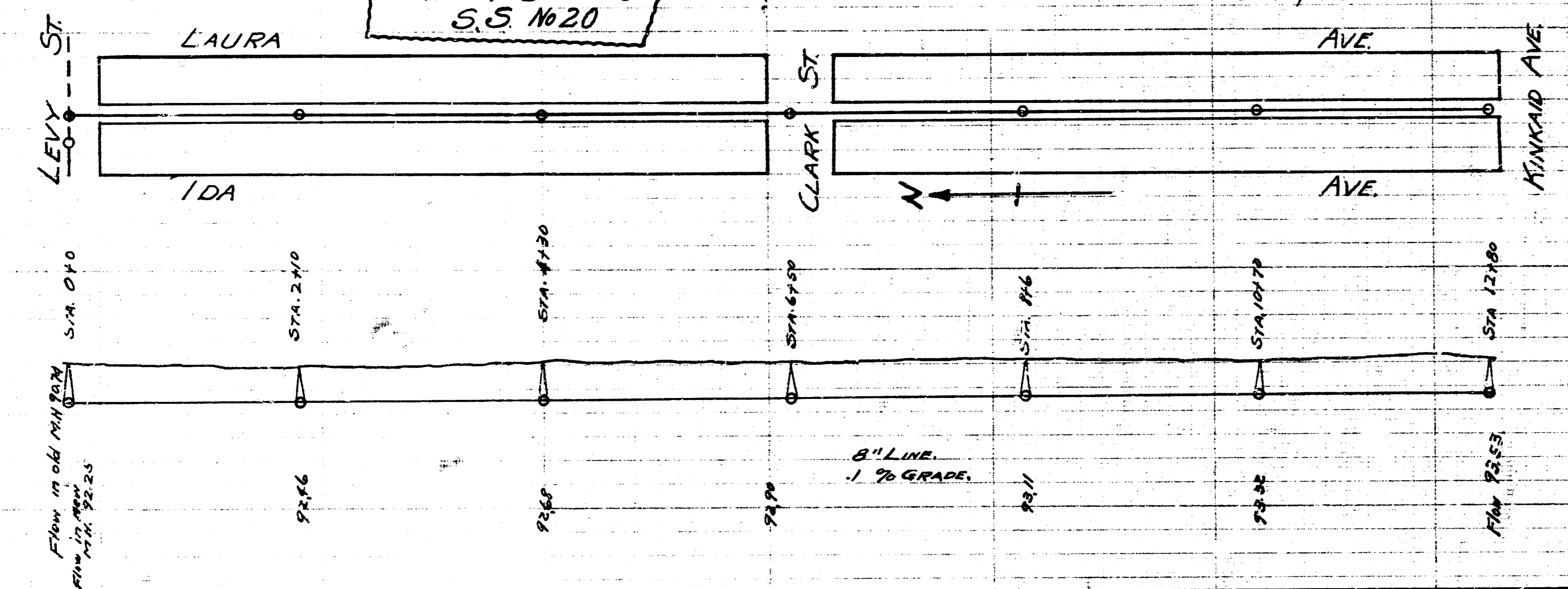

LAT. 4 - S.S. No. 1  
See Plat at left

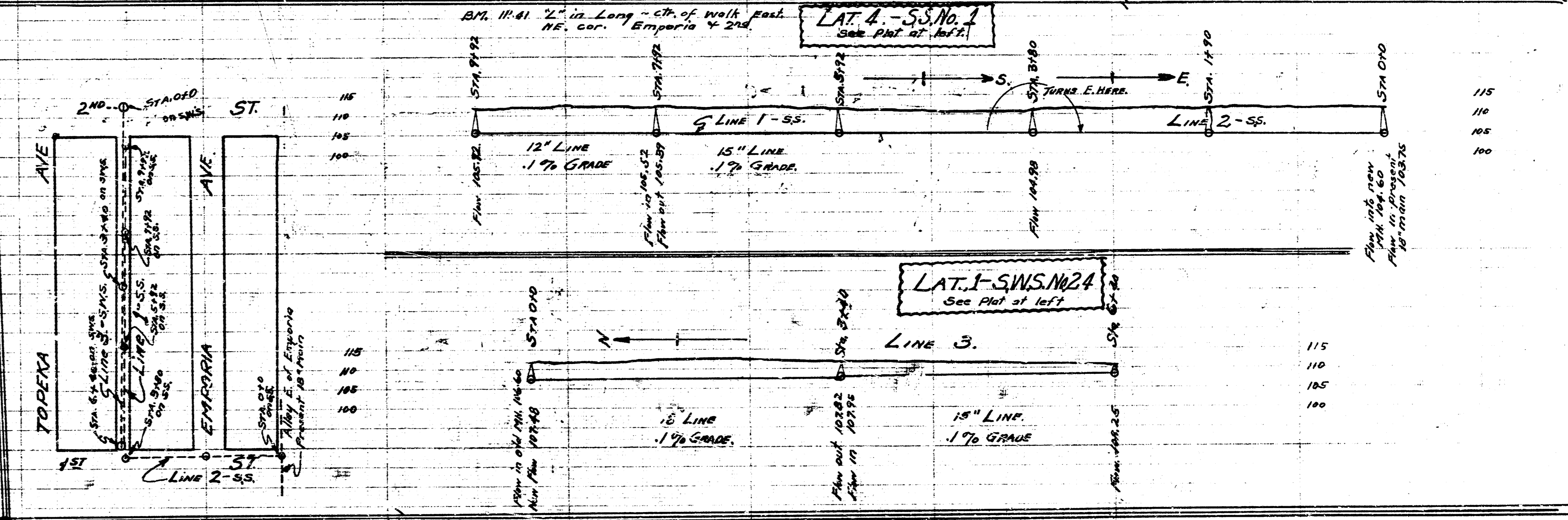

LAT. 1 - S.S. No. 24  
See Plat at left

B.M. 10224  
L. in Kerker - ch. of wh. E.  
NE. cor. Hydraulic & Central.

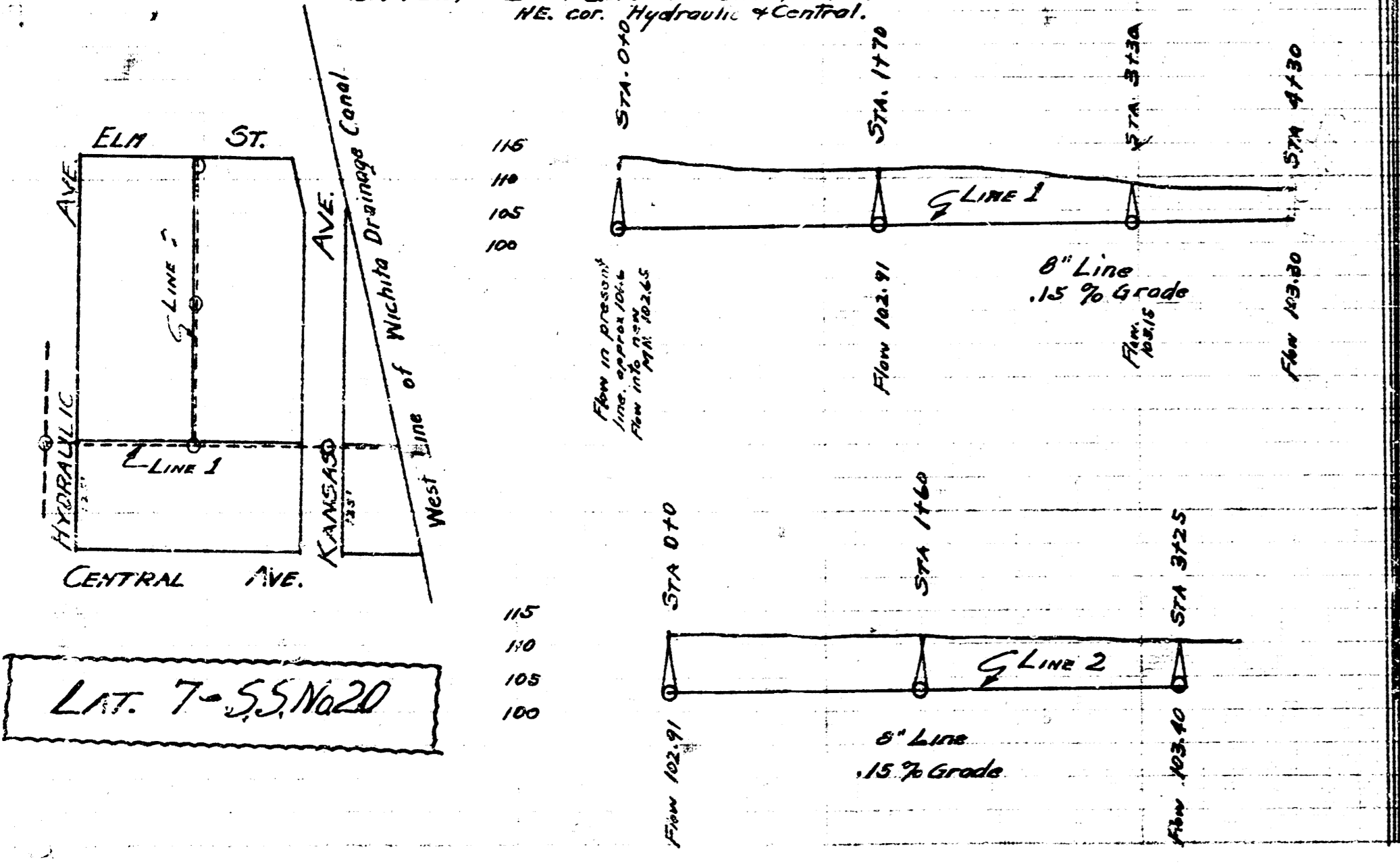

LAT. 7 - S.S. No. 20

B.M. 12044 S. Bolt on NW front  
NW cor. Rutan & Kellogg.

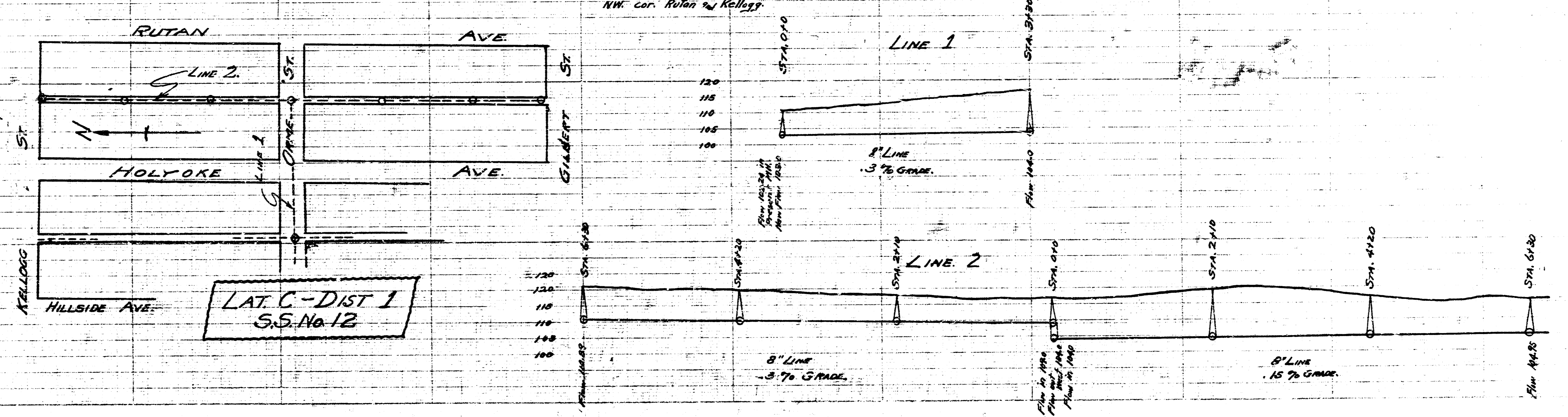

LAT. C - DIST. 1  
S.S. No. 12