

LAT. K. DIST. T. S.S. # 20 - WICHITA, KANSAS

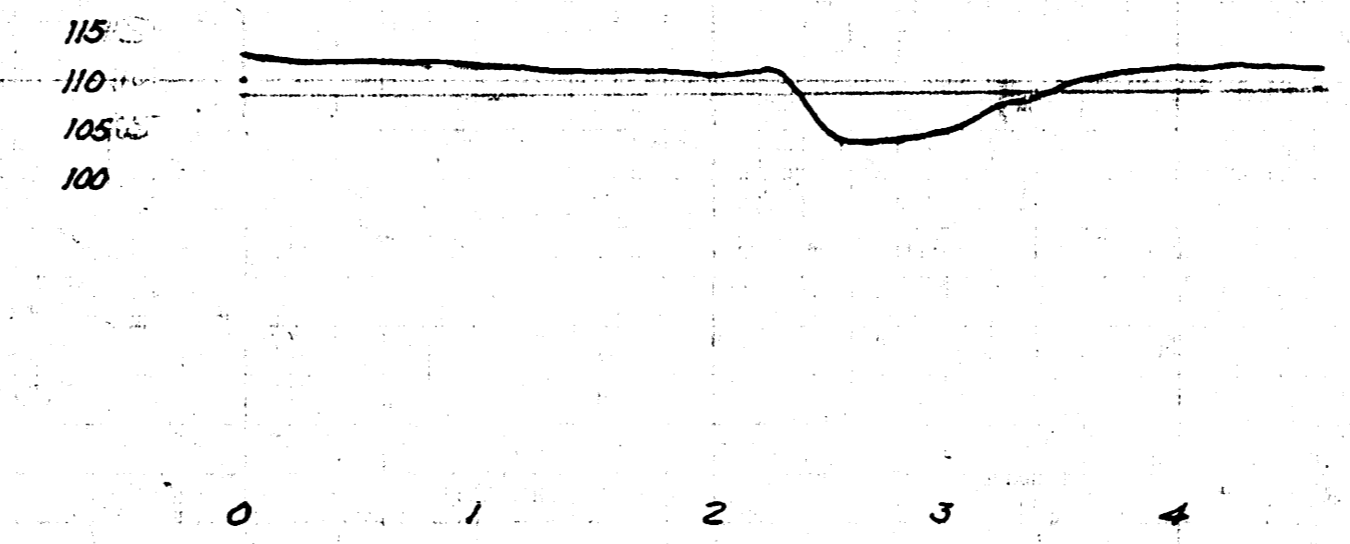

LAT. 17, DRY CREEK SUBMAIN
SANITARY SEWER No. 12
WICHITA, KANSAS

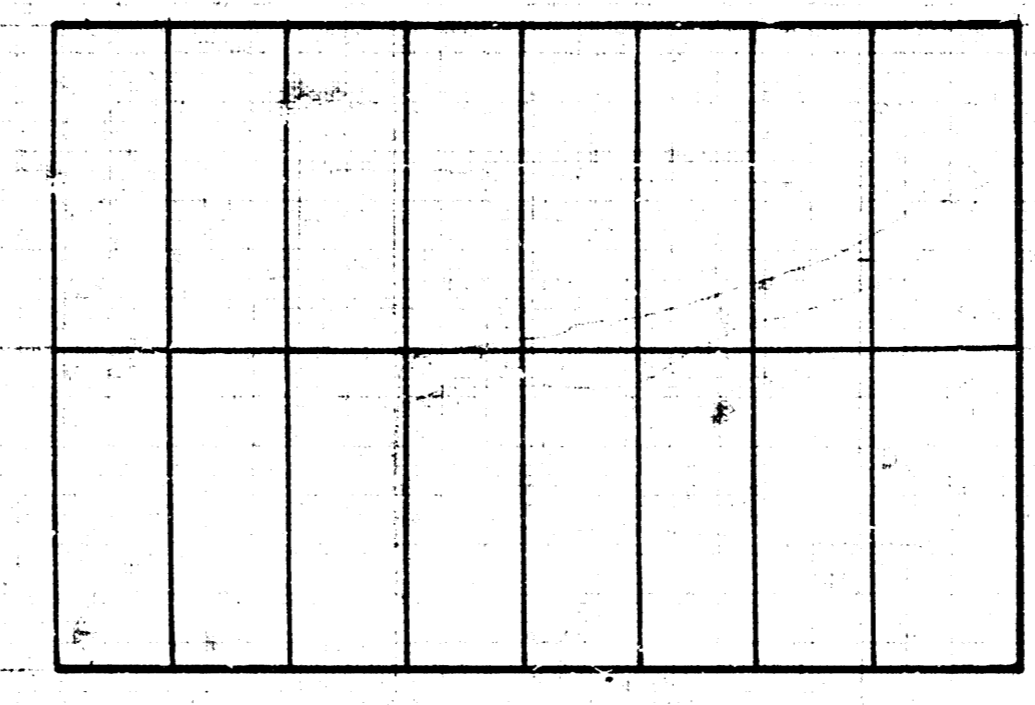
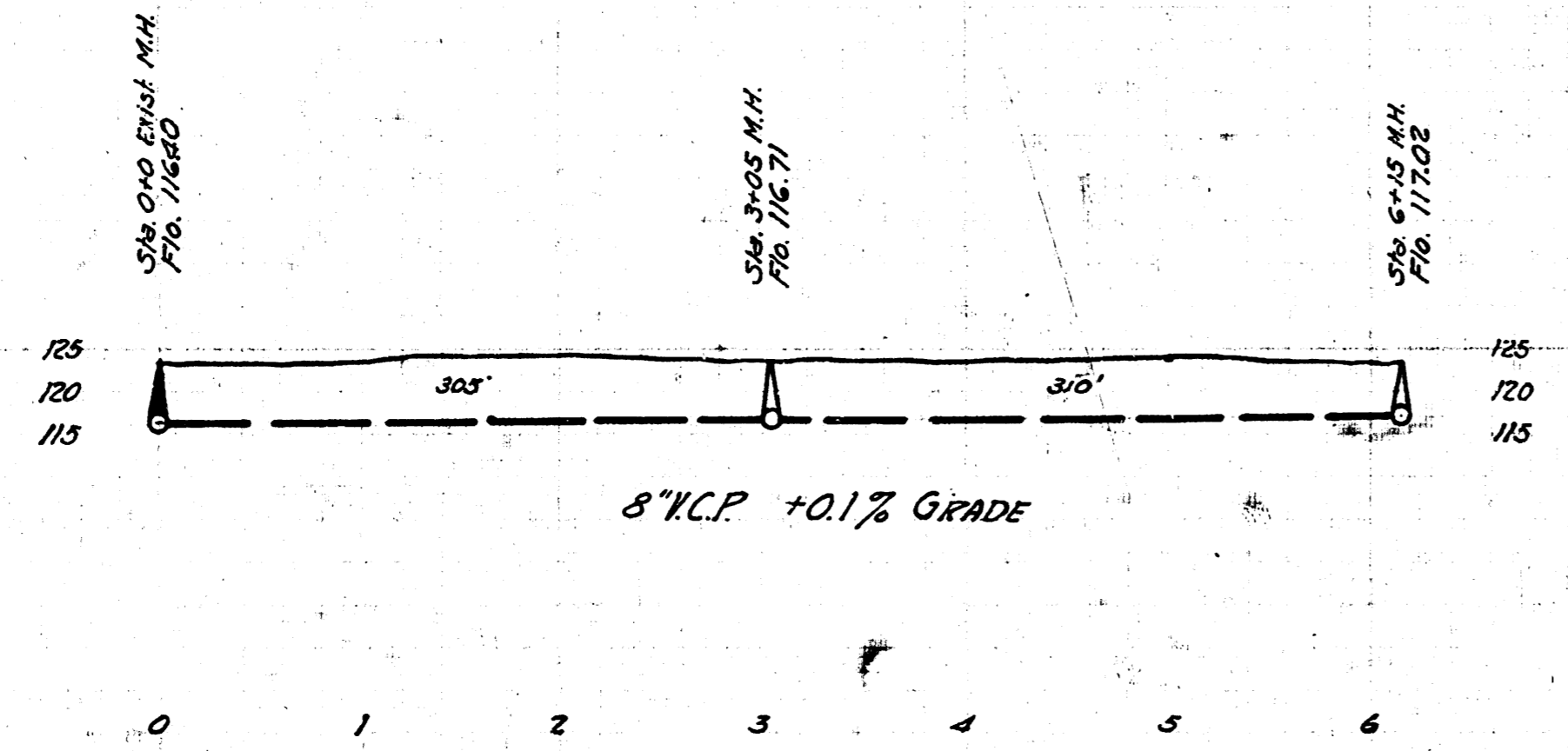
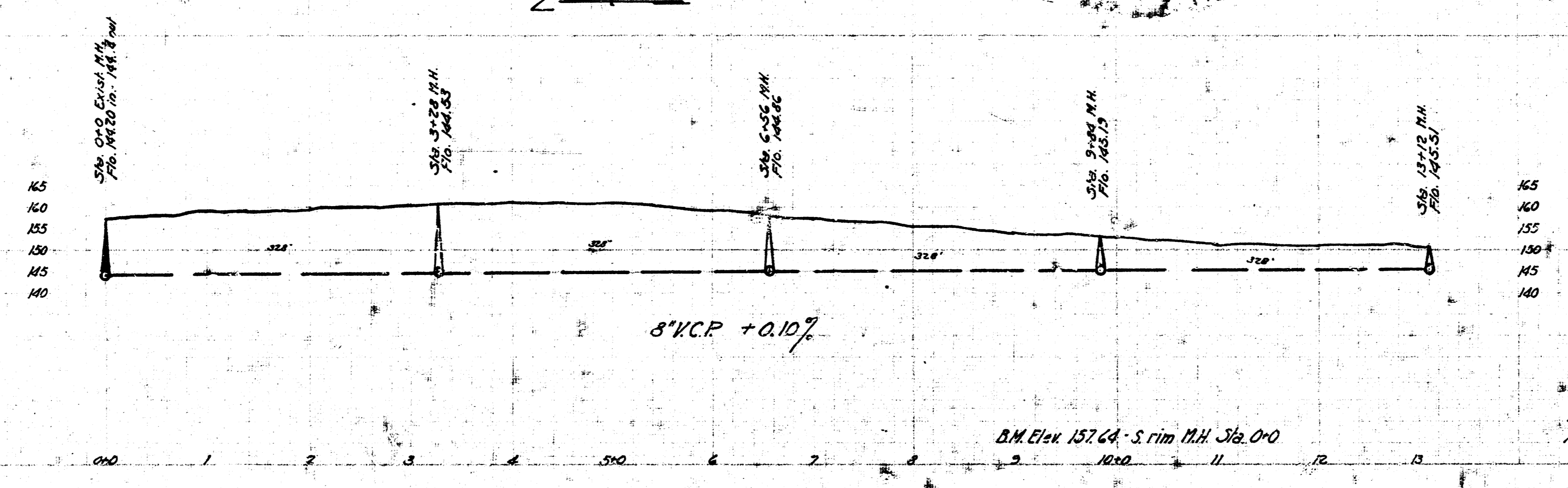
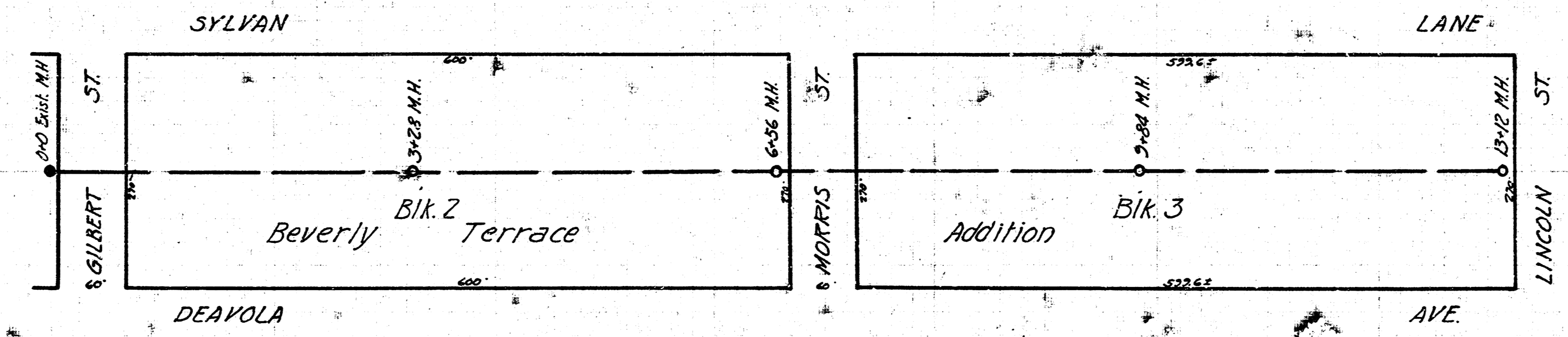

Engineering Department
City of Wichita, Kansas
P.L. Brockway, Engineer
August 1943 - Scale 1"=40'