

SCALE  
 PLAN 1" = 20'  
 PROFILE 1" = 20' HORIZ.  
 1" = 5' VERT.

NOTE: CONTRACTOR'S METHOD FOR HANDLING SEWAGE FLOWS DURING CONSTRUCTION OF THIS PROJECT SHALL BE APPROVED BY THE ENGINEER. CONTRACTOR WILL BE REQUIRED TO OBTAIN PERMITS FROM PUBLIC WORKS ADMINISTRATION BEFORE RECONNECTING BUILDING SERVICE LINES. PERMIT FEE WILL BE WAIVED. BID ITEM FOR SERVICE CONNECTIONS SHALL COVER ALL COSTS FOR FURNISHING AND INSTALLING SADDLE INCLUDING TAPPING FEE. PIPE TAPS ARE TO BE MADE BY CITY MAINTENANCE DEPARTMENT PERSONNEL UNLESS APPROVED OTHERWISE BY THE ENGINEER. ONLY ACTIVE BUILDING SANITARY SEWER LINES ARE TO BE RECONNECTED TO THE NEW SEWER. CONTRACTOR SHALL VERIFY WHICH LINES ARE ACTIVE.

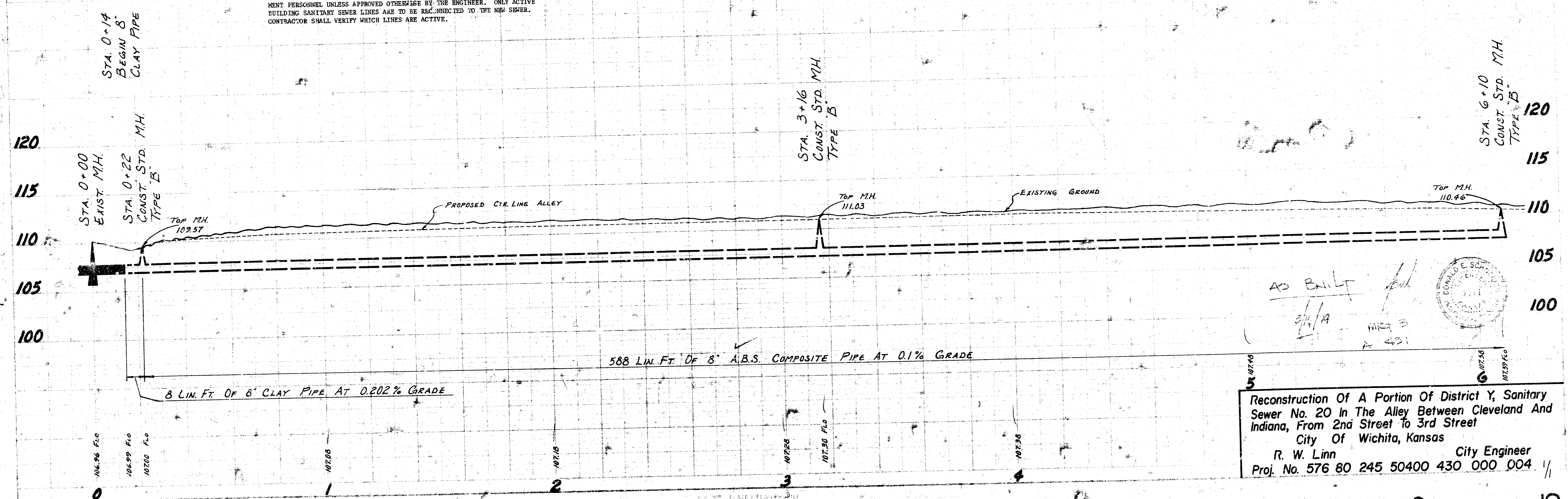

Reconstruction Of A Portion Of District Y, Sanitary Sewer No. 20 In The Alley Between Cleveland And Indiana, From 2nd Street To 3rd Street  
 City Of Wichita, Kansas  
 R. W. Linn City Engineer  
 Proj. No. 576 80 245 50400 430 000 004

AD Built  
 3/11/19  
 MET 3  
 A 431

