

BL 105.44 R.R. Spike N. side P.P. S. side of Lewis, midway between Lulu + Ellis

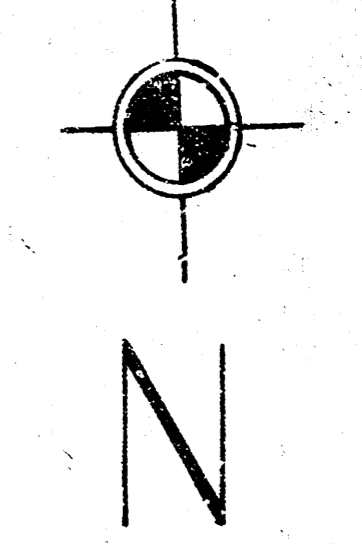

Plan Scale 1" = 20'
 Profile Scale 1" = 20' Horiz
 1" = 5' Vert

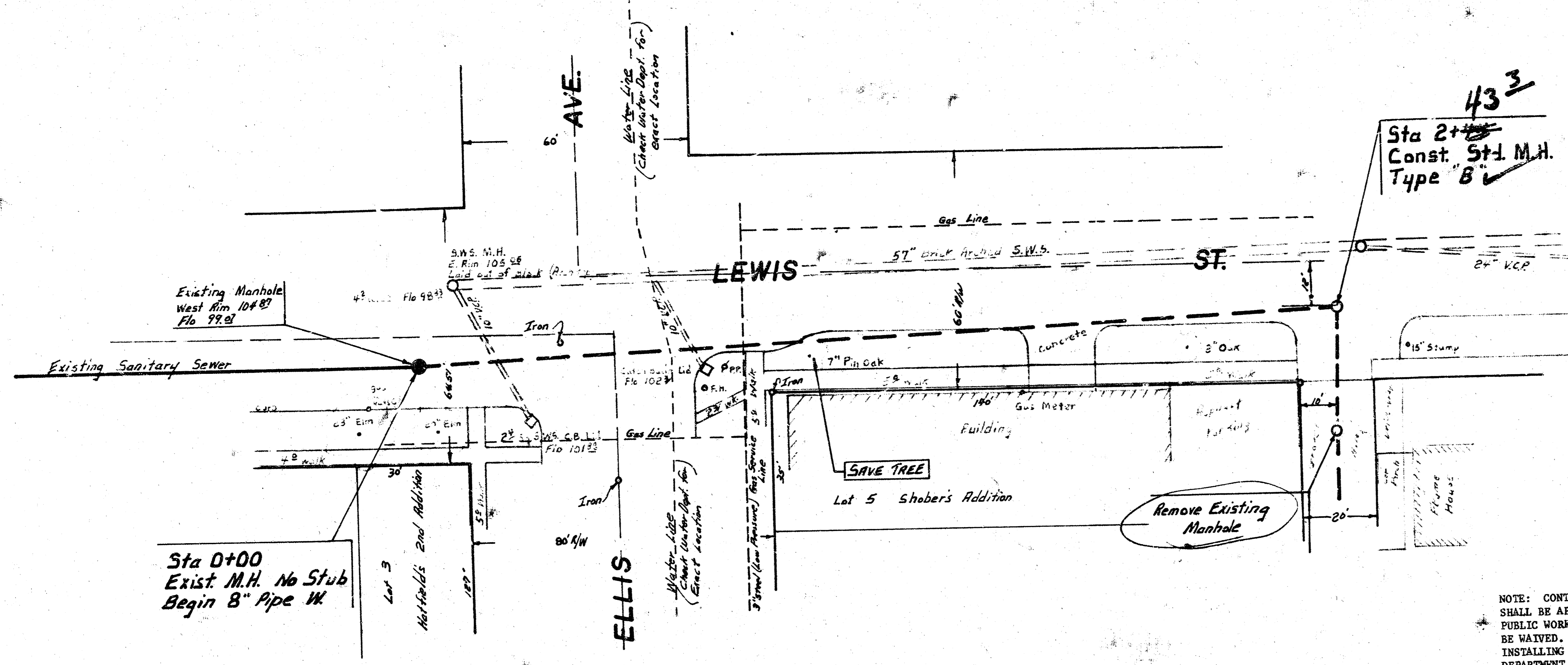

NOTE: CONTRACTOR'S METHOD FOR HANDLING SEWAGE FLOWS DURING CONSTRUCTION OF THIS PROJECT SHALL BE APPROVED BY THE ENGINEER. CONTRACTOR WILL BE REQUIRED TO OBTAIN PERMITS FROM PUBLIC WORKS ADMINISTRATION BEFORE RECONNECTING BUILDING SERVICE LINES. PERMIT FEE WILL BE WAIVED. BID ITEM FOR SERVICE CONNECTIONS SHALL COVER ALL COSTS FOR FURNISHING AND INSTALLING SADDLE INCLUDING TAPPING FEE. FIRE TAPS ARE TO BE MADE BY CITY MAINTENANCE DEPARTMENT PERSONNEL UNLESS APPROVED OTHERWISE BY THE ENGINEER. ONLY ACTIVE BUILDING SANITARY SEWER LINES ARE TO BE RECONNECTED TO THE NEW SEWER. CONTRACTOR SHALL VERIFY WHICH LINES ARE ACTIVE.

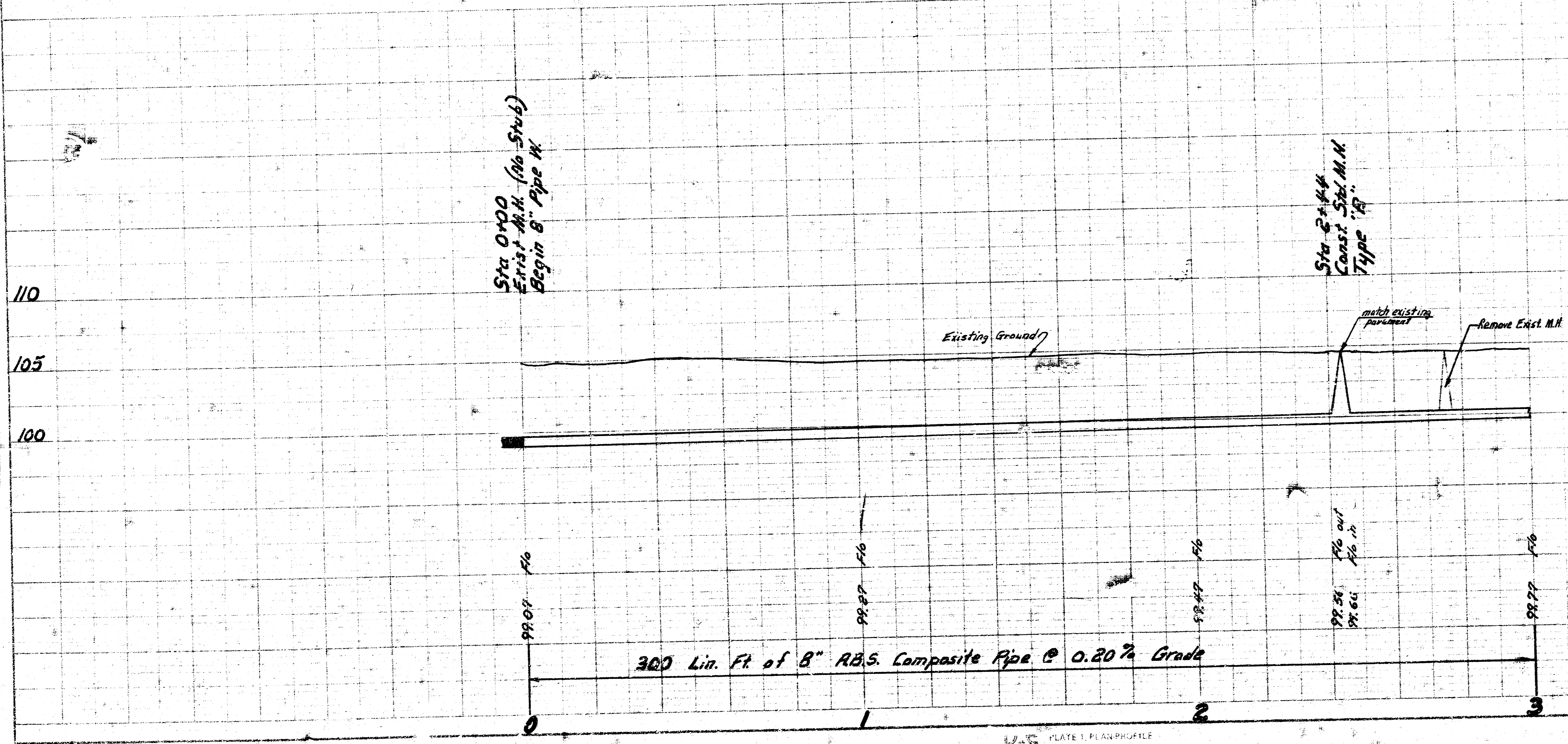

As Built
6/81

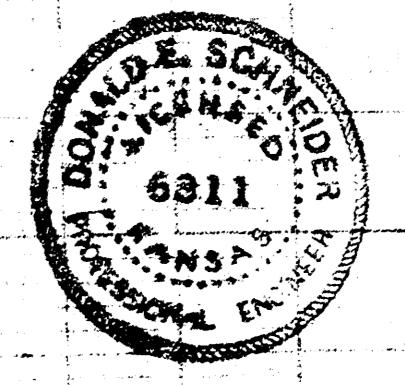

Reconstruction of a portion of Lateral 12, District Y,
 Sanitary Sewer No. 20 in the Alley between Lulu and
 Ellis from Lewis to Waterman.
 City of Wichita, Ks.
 R. W. Linn City Engineer
 Project No. 576-80-245-50400-430-000-008

Sheet 1 of 3 1/3

FILMED FROM THE BEST AVAILABLE COPY

B.M. 107.66 R.R. Spike West Side of RR E.L. Alley South;
and S.L. of Hill East & West South of
Waterman between Ellis & Lulu

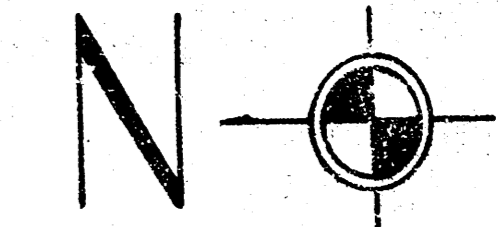

Plan Scale 1" = 20'
Profile Scale 1" = 20' Horiz.
1" = 5' Vert.

PLAN
NOTE BOOK
NO.

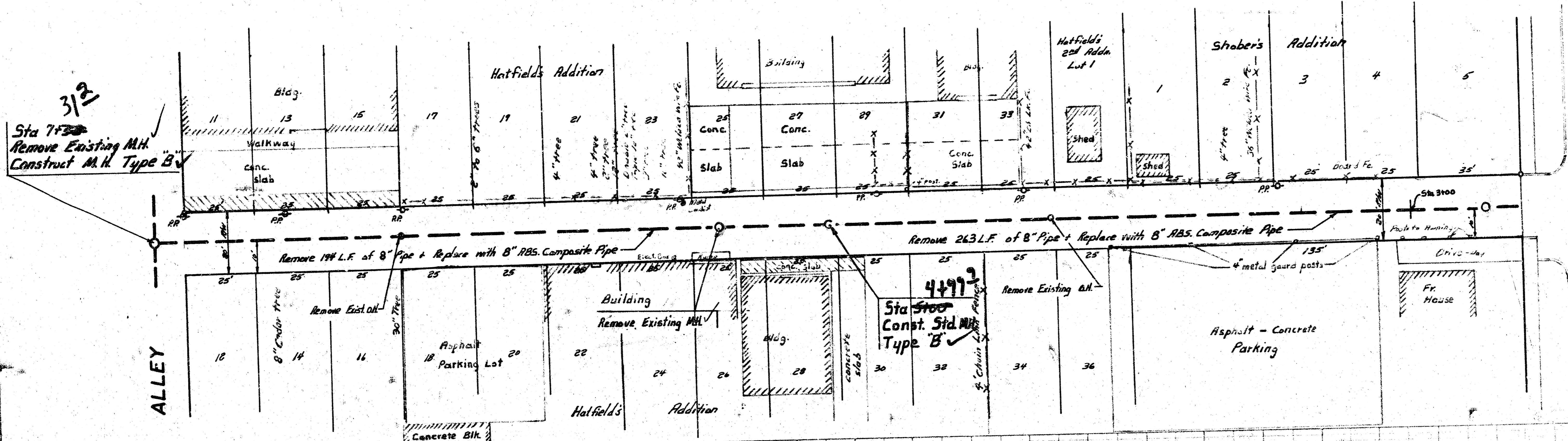

PROFILE
NOTE BOOK
NO.

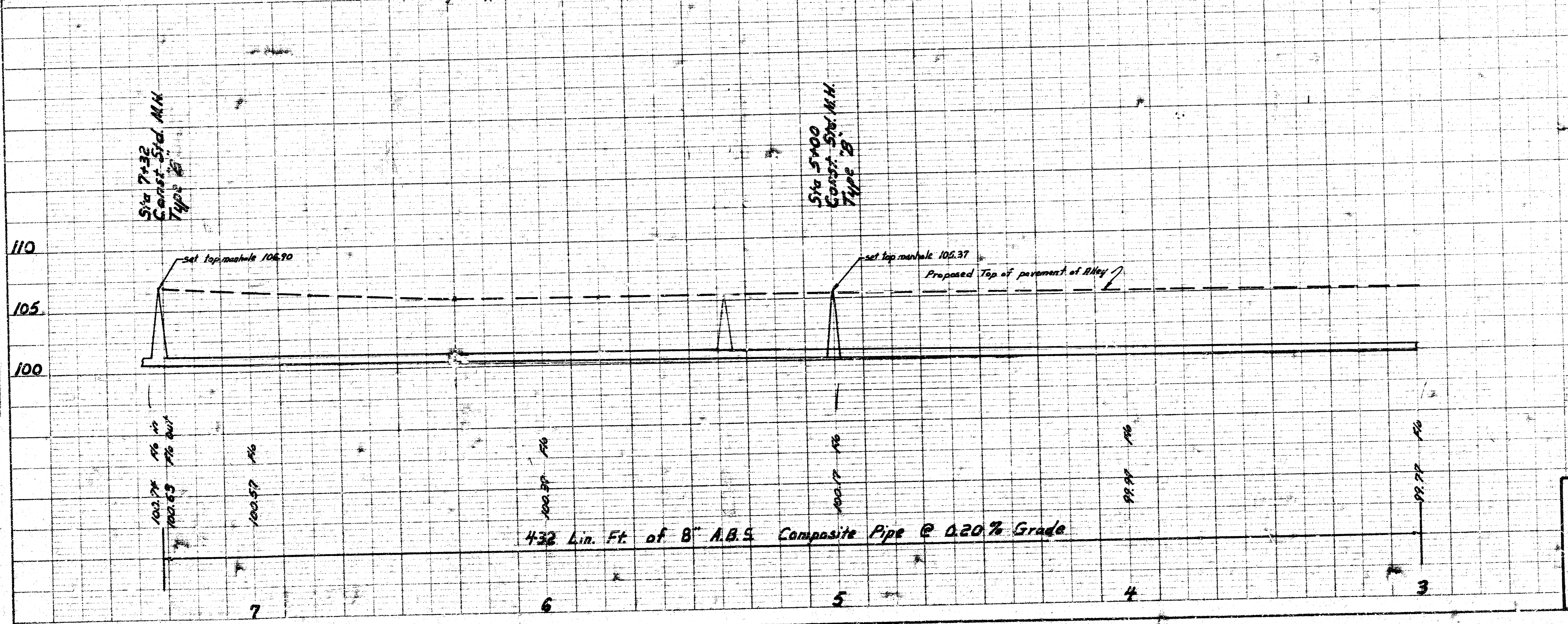

As Built
6/81
J.S.S.

Reconstruction of a portion of Lateral 12, District Y,
Sanitary Sewer No. 20 in the Alley between Lulu and
Ellis from Lewis to Waterman.
City of Wichita, Ks.
R. W. Linn City Engineer
Project No. 576-80-245 - 50400 - 430-000-002

B.M. 107.65 R.R. Spike West Side of RR E.L. Alley South,
and S.L. of Alley East + West South of
Waterman between Ellis + Lulu.

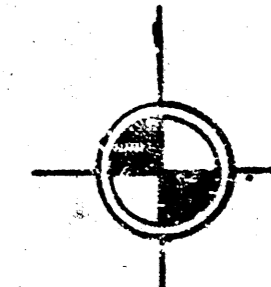
N

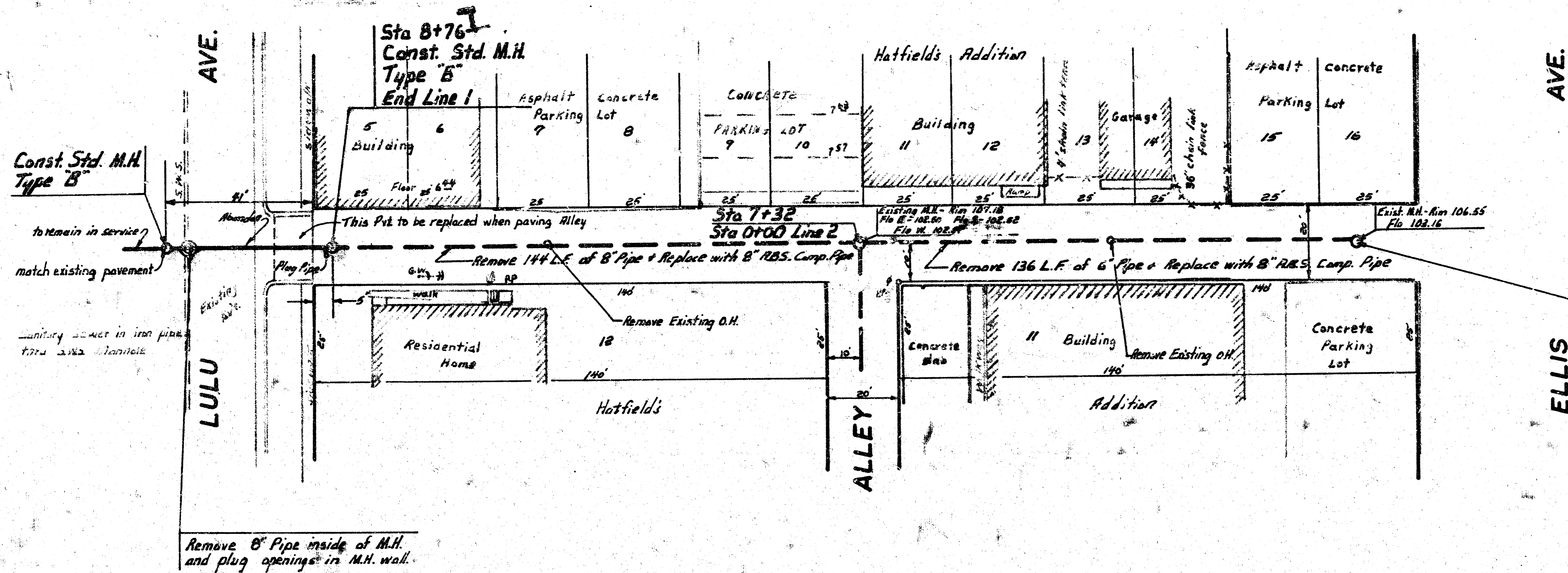
 Plan Scale 1" = 20'
 Profile Scale 1" = 20' Horiz.
 1" = 5' Vert.



Reconstruction of a portion of Lateral 12, District Y,
Sanitary Sewer No. 20 in the Alley between Lulu and
Ellis from Lewis to Waterman.
City of Wichita, Kas.
R. W. Linn City Engineer
Project No. 576-80-295-50400-430-000-002

PLAN
 NOTE BOOK
 No.

PROFILE
 NOTE BOOK
 No.