

INTERCEPTING SEWER
FOR
SANITARY SEWER NO. 20

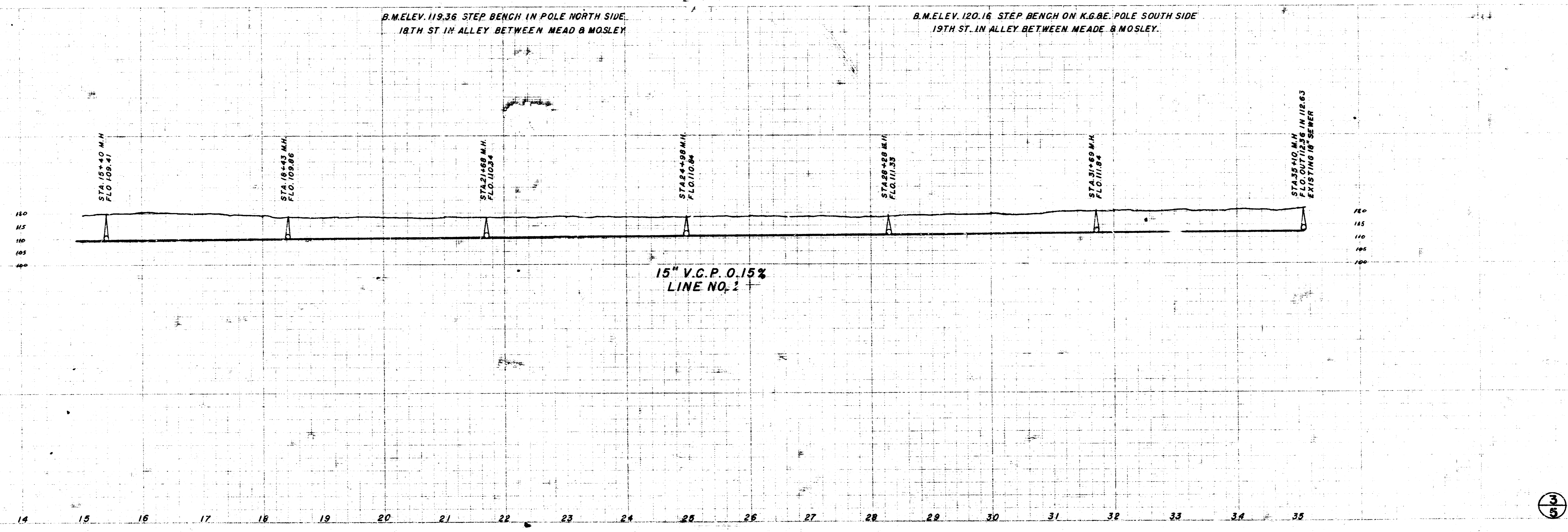

INTERCEPTING SEWER
FOR
SANITARY SEWER NO.20

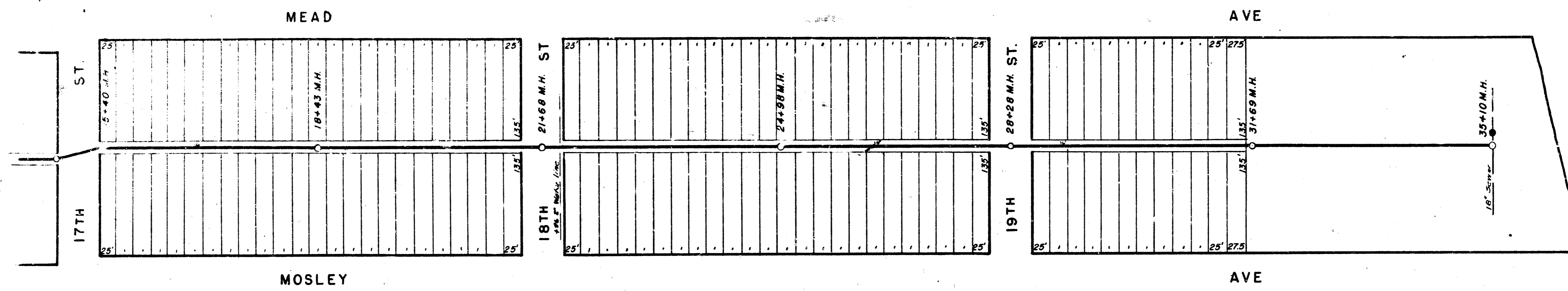
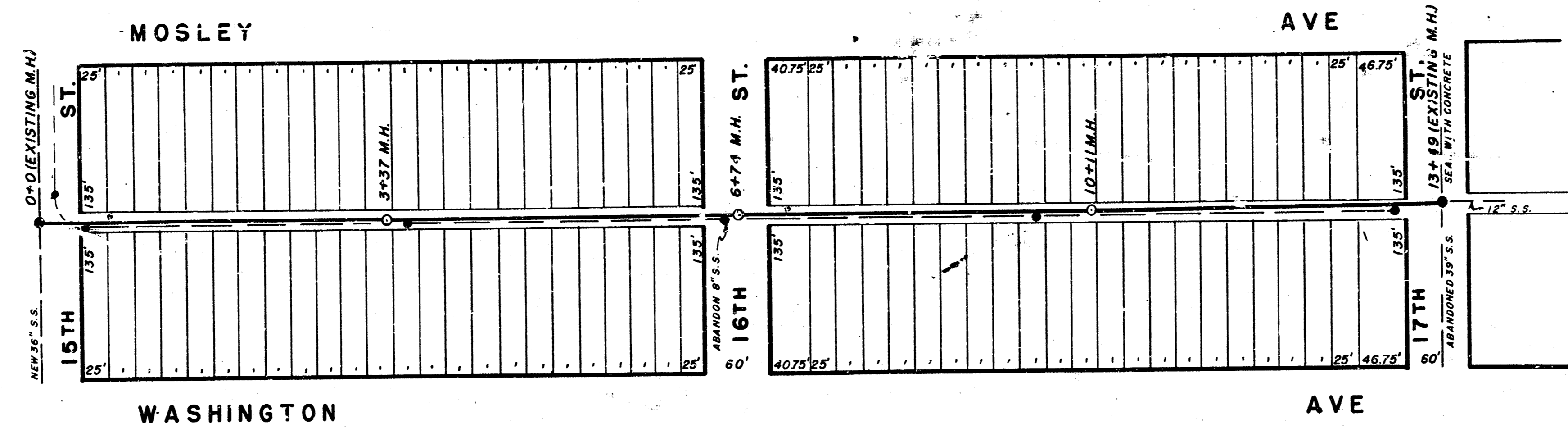

INSTALL 4" WYE OPENING FOR EACH LOT AND RECONNECT ANY EXISTING HOUSE CONNECTIONS

NOTE: SALVAGE ALL M.H. FRAMES AND COVERS ON
ABANDONED LINE TO BE USED ON NEW 12" SEWER

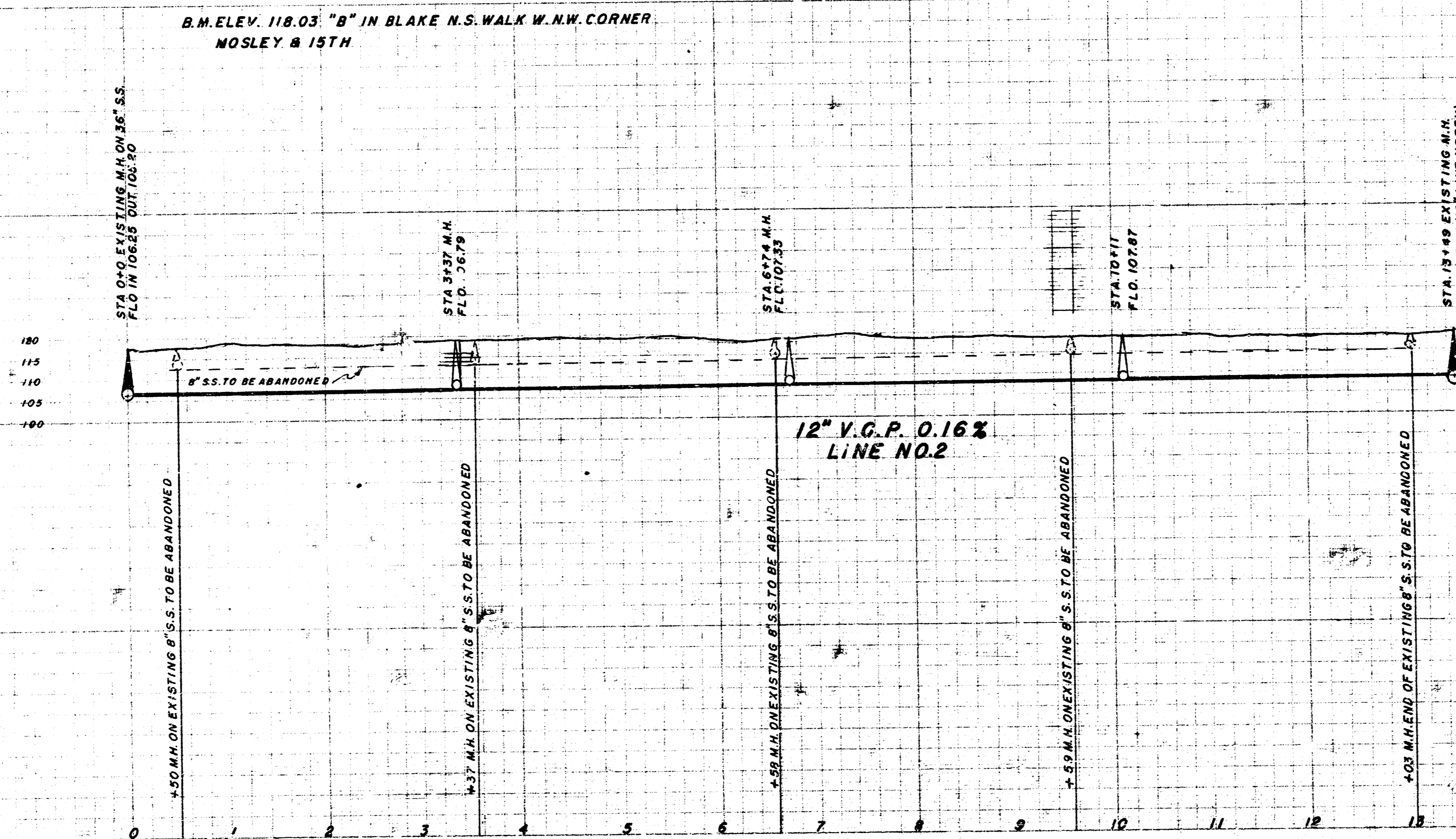

B.M. ELEV. 118.03 "B" IN BLAKE N.S. WALK W. N.W. CORNER
MOSLEY & 15TH

120
115
110
105
100

0
1
2
3
4
5
6
7
8
9
10
11
12
13
14

12" V.G.P. 0.16%
LINE NO.2

15

INTERCEPTING SEWER
FOR
SANITARY SEWER NO.20

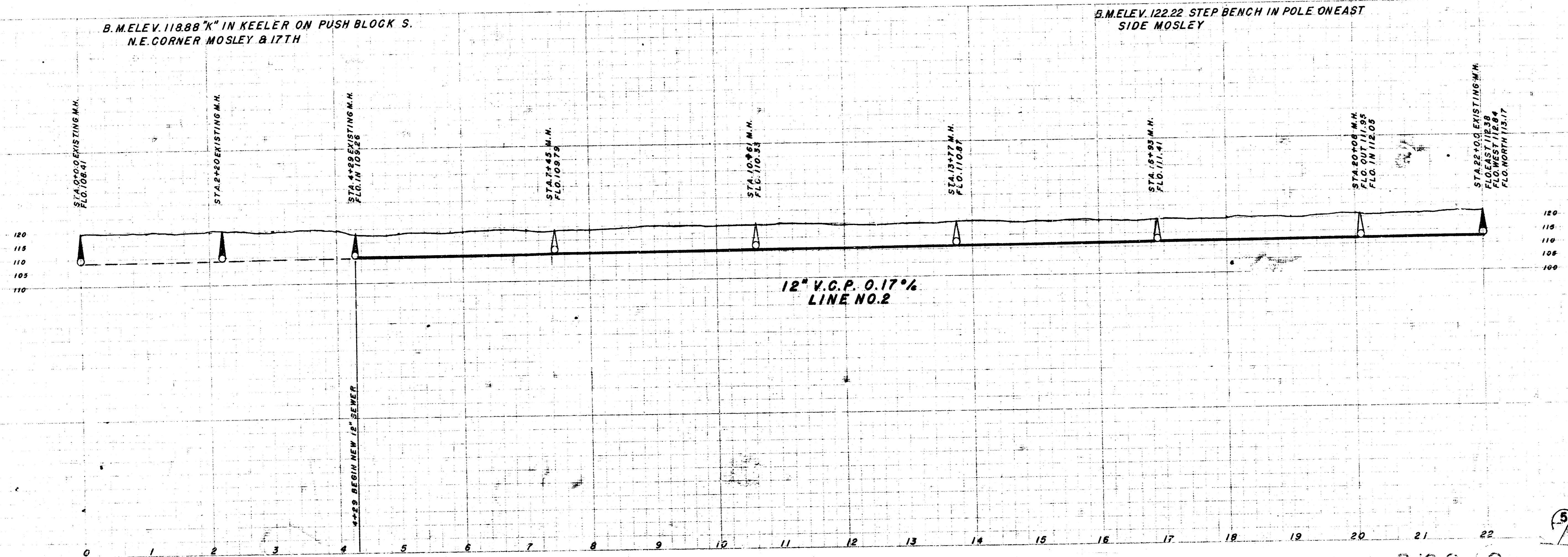
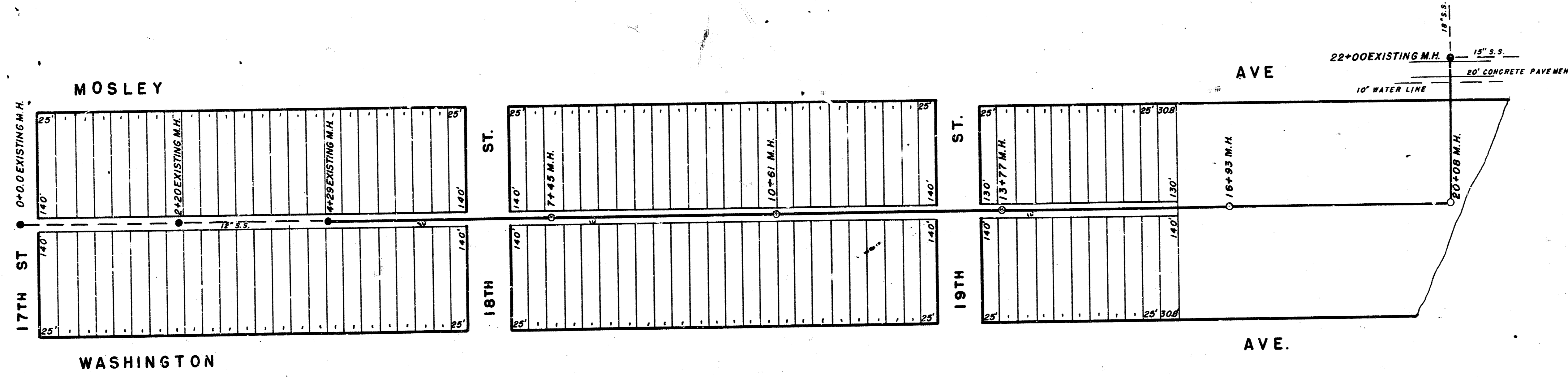

810310