

LEGEND
 --- Rain Leader. See Sh. No. C104

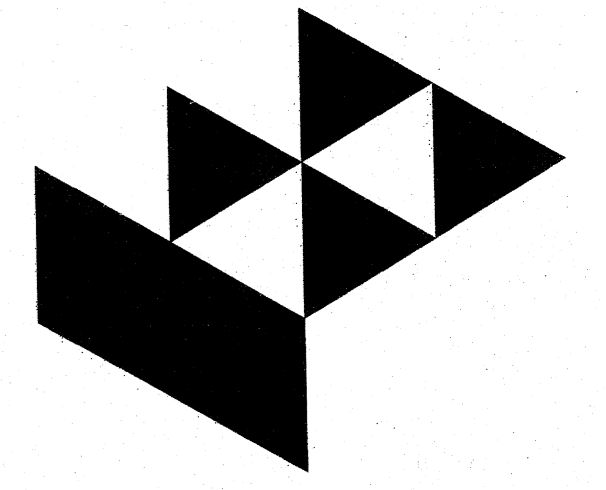

Gossen Livingston
 Architecture
 420 South Emporia
 Wichita, KS 67202
 Tel: (316) 265-9367
 Fax: (316) 265-5646
 Email: architect@gossenlivingston.com

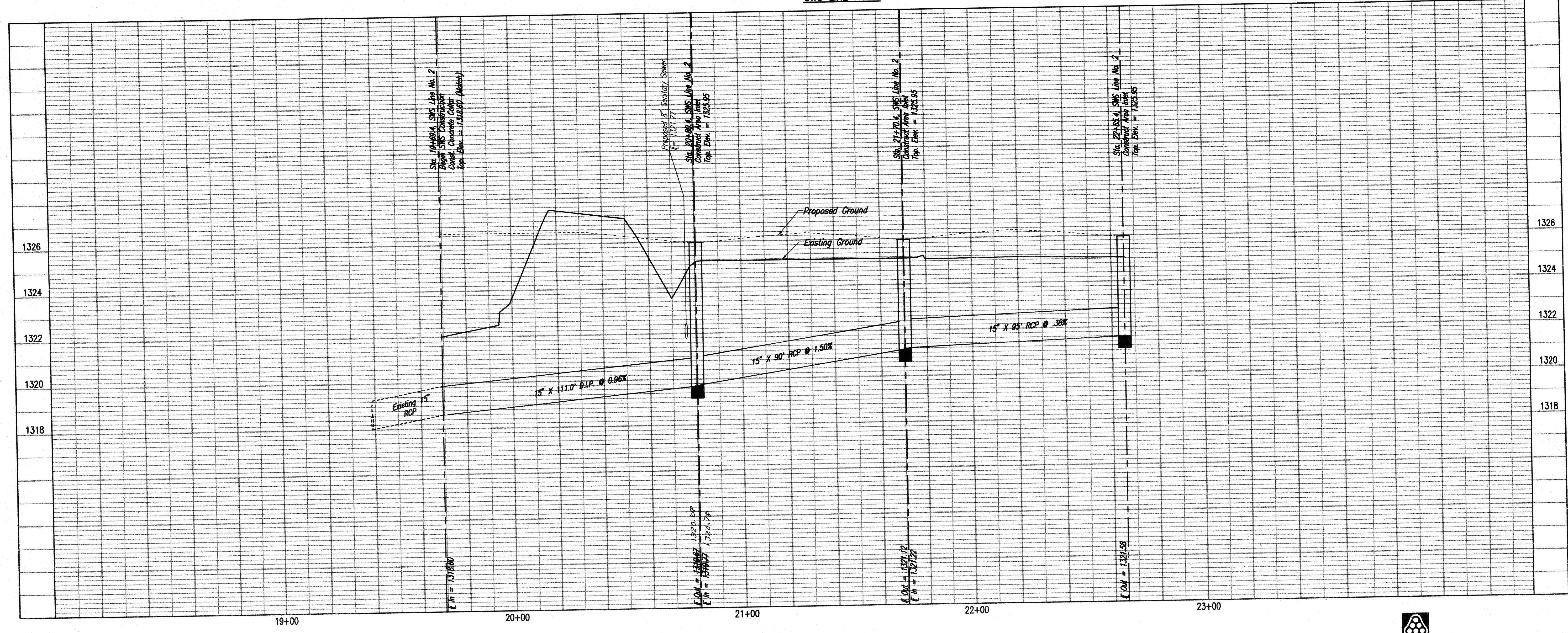
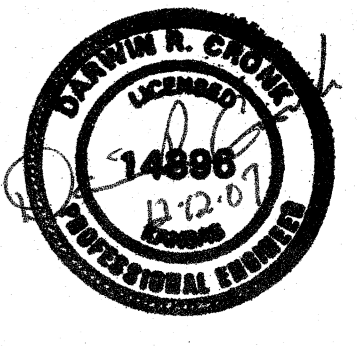

2007 Gossen Livingston Associates, Inc.
 All work herein is the exclusive property of Gossen Livingston Associates, Inc. and is not to be copied or used in any way without the express written consent of Gossen Livingston Associates, Inc. All drawings, specifications, sheets, designs and arrangements appearing herein constitute the original and unpublished work of:
 Gossen Livingston Associates, Inc.

**NORTH AIR CARGO FACILITY
 MID-CONTINENT AIRPORT
 Wichita, Ks.**

Mark	Date	Description

**SWS LINE 2
 PLAN/PROFILE**

Job No.	1049.200	C205
Date	12/12/07	
Drawn	DRC	
Checked	DAR	

Professional Engineering Consultants, P.A.
 303 S. TOPEKA • WICHITA, KANSAS 67202 • 316-262-2691 • FAX 316-262-3003
 www.pec1.com

Scale: 1/4" = 1'-0" (PLAN) 1/8" = 1'-0" (PROFILE)
 Date: 12/12/07
 Drawn: DRC
 Checked: DAR
 Job No.: 1049.200
 Date: 12/12/07
 Title: SWS LINE 2
 Project: NORTH AIR CARGO FACILITY
 Location: MID-CONTINENT AIRPORT
 City: WICHITA, KANSAS