

**PAVING AND INCIDENTAL DRAINAGE PLANS FOR
FOLIAGE CENTER ADDITION
WEBB ROAD LEFT TURN LANES**

PAVEMENT MARKING PLAN
SHEET TITLE
04274
PROJECT NUMBER

DESIGN BY: **SRS**
DRAWN BY: **TKL**
CHECKED BY: **DFL**

ISSUED: **May 2008**
REVISED:

SHEET NO.
9 of 26

FOLIAGE CENTER ADDITION

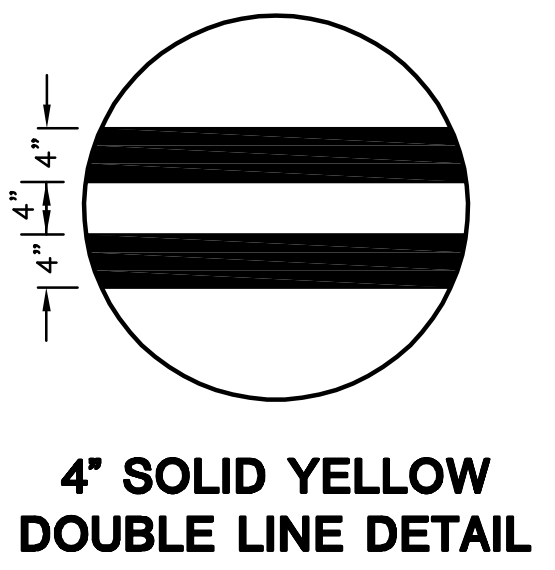
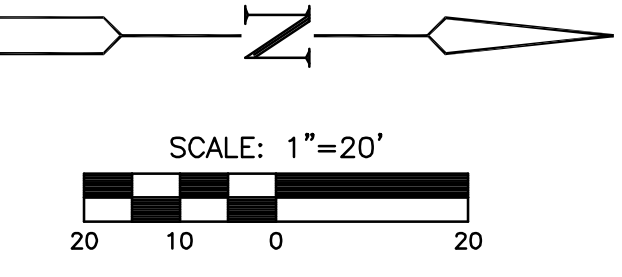
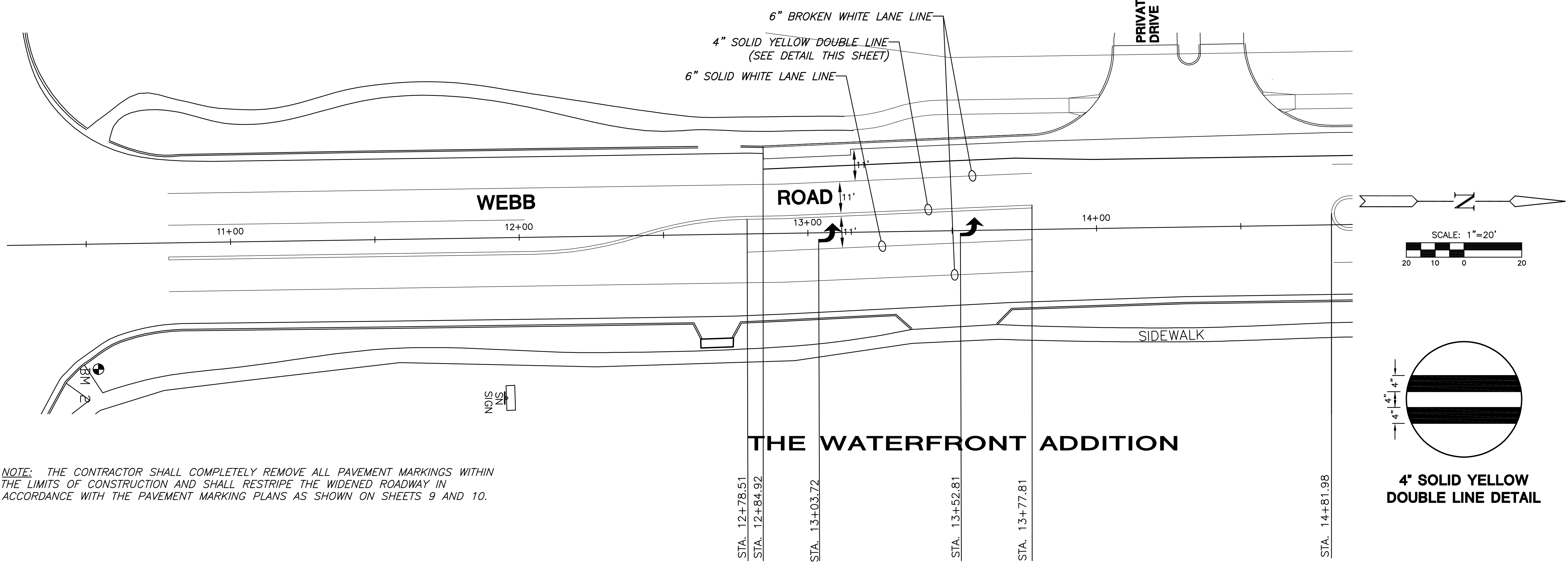

NOTE: THE CONTRACTOR SHALL COMPLETELY REMOVE ALL PAVEMENT MARKINGS WITHIN THE LIMITS OF CONSTRUCTION AND SHALL RESTRIPE THE WIDENED ROADWAY IN ACCORDANCE WITH THE PAVEMENT MARKING PLANS AS SHOWN ON SHEETS 9 AND 10.

FOLIAGE CENTER ADDITION

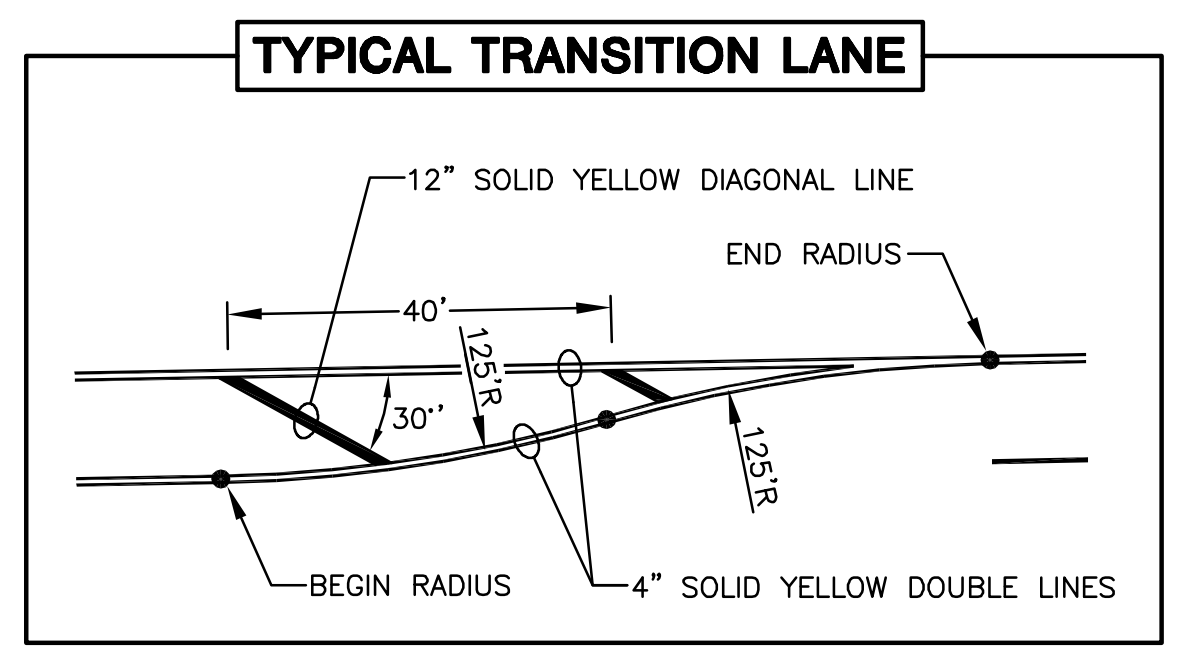
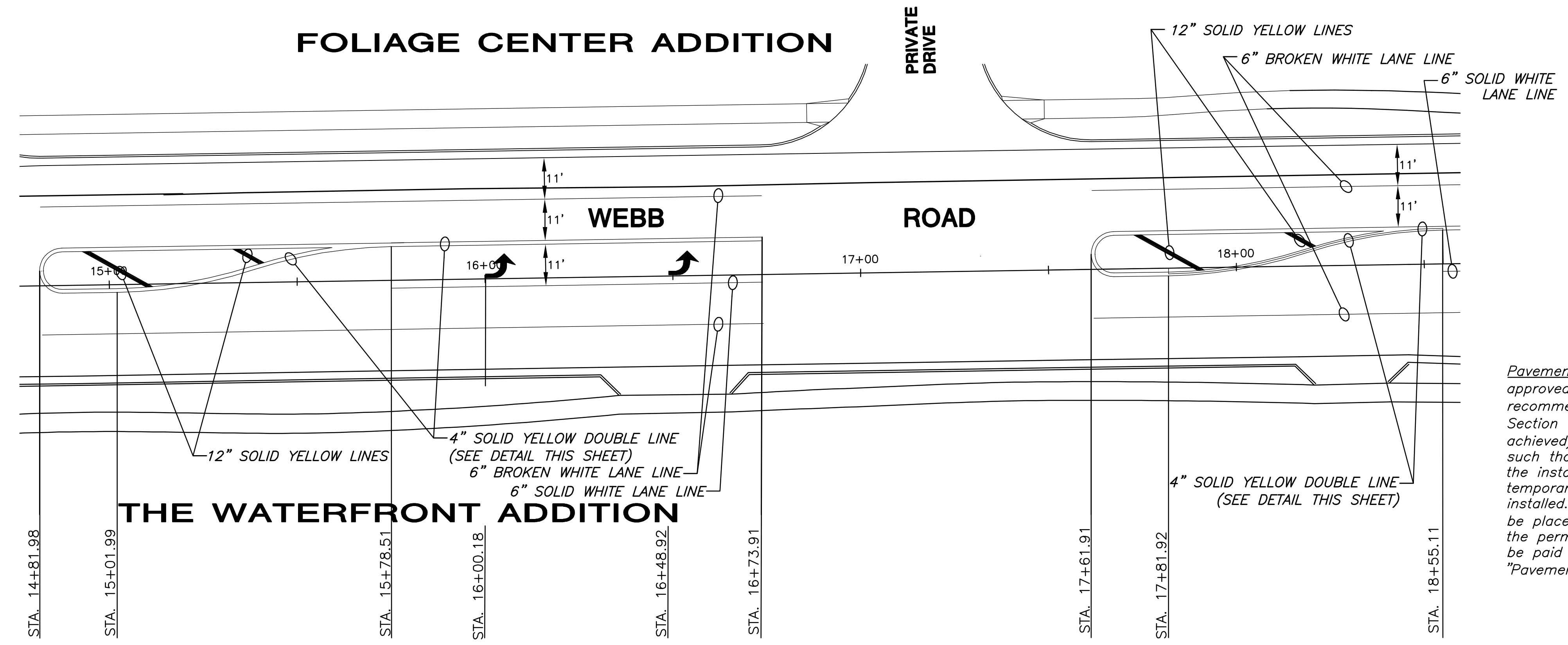

Pavement Markings – All pavement markings shall be thermoplastic, unless otherwise approved by the Engineer. Pavement markings shall be installed per manufacturer's recommendations and shall meet KDOT's 2007 Edition of the Standard Specification Section 806. Full traffic may not be restored (and substantial project completion achieved) until all pavement markings are in place. Should construction timing be such that restoration of traffic becomes necessary during temperatures prohibiting the installation of thermoplastic markings, the contractor shall install and maintain temporary markings until such time that thermoplastic markings may be properly installed. Except for the material requirement, temporary pavement markings shall be placed equivalent, in every manner (i.e. dimension, frequency, spacing, etc.), to the permanent marking layout. The cost for temporary pavement markings will not be paid for directly, but shall be considered subsidiary to the bid item for "Pavement Markings."