

**MT VERNON STREET AND  
DRAINAGE IMPROVEMENTS  
FROM GREENWAY TO BROADWAY**

**STORM SEWER  
BUBBLE MAP**  
SHEET TITLE 472-84289  
448-90385  
468-84514  
PROJECT NUMBER

DESIGN BY JRA  
DRAWN BY JSB  
CHECKED BY JRA

ISSUED  
May 27, 2008

SHEET NO.  
42 of 120

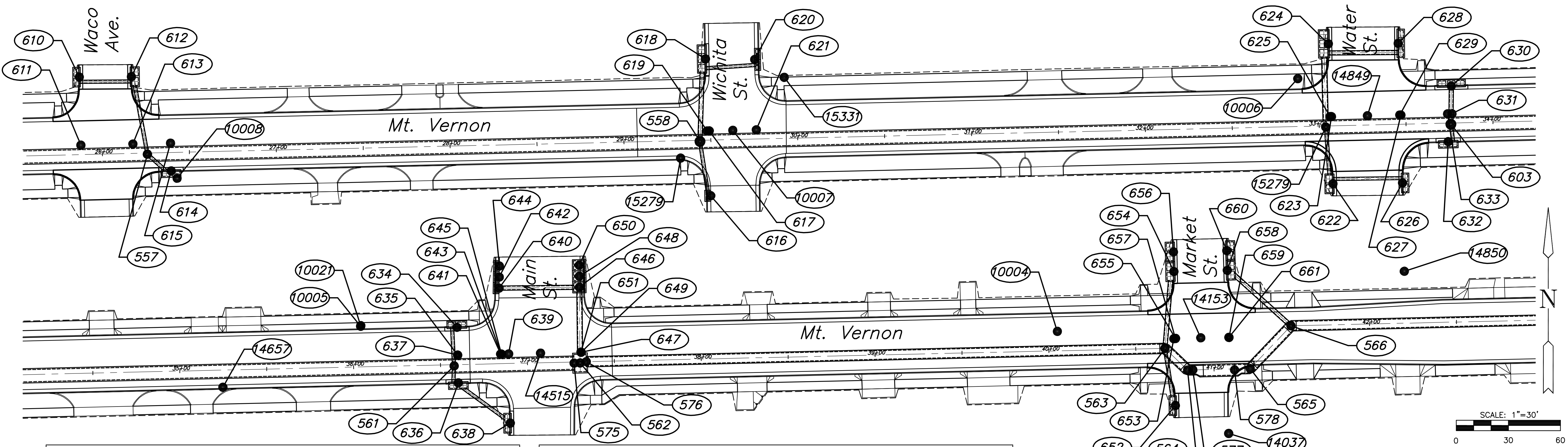

POINT TABLE					
POINT NUMBER	STATION	OFFSET	NORTHING	EASTING	DESC
557			1675200.1498	1647794.6391	MH
558			1675207.4752	1648112.5547	MH
559			1675215.7681	1648472.4591	MH
560			1675217.4267	1648544.4400	MH
561			1675223.9227	1648826.3652	MH
562			1675225.5984	1648898.8458	Rein.MH
563			1675234.0164	1649235.2412	45Bend/MH
564			1675221.5850	1649248.2589	45Bend
565			1675222.4143	1649284.2494	45Bend
566			1675247.0034	1649307.7308	45Bend/MH
575			1675225.5122	1648895.3469	EndRCB
576			1675226.3455	1648902.3296	BeginRCB
577			1675221.6541	1649251.2581	Trans
578			1675221.6238	1649275.2652	Trans
610			1675244.5560	1647755.4373	INLET
611			1675205.3507	1647756.3301	BL-INLETOFFSET
612			1675244.7587	1647785.3930	INLET
613			1675206.0326	1647786.2748	BL-INLETOFFSET
614			1675190.5294	1647808.2727	INLET
615			1675206.5252	1647807.9085	BL-INLETOFFSET
616			1675176.2573	1648118.6609	INLET
617			1675213.5822	1648117.8110	BL-INLETOFFSET
618			1675254.9817	1648115.6279	INLET
619			1675213.5539	1648116.5712	BL-INLETOFFSET
620			1675254.7216	1648143.9442	INLET
621			1675214.2021	1648144.8776	BL-INLETOFFSET
622			1675183.1634	1648476.6039	INLET
623			1675221.8225	1648475.7134	BL-INLETOFFSET
624			1675263.7263	1648473.8990	INLET
625			1675221.8030	1648474.8646	BL-INLETOFFSET
626			1675183.6225	1648516.5769	INLET
627			1675222.7541	1648515.6520	BL-INLETOFFSET
628			1675263.9808	1648514.0679	INLET
629			1675222.7397	1648515.0427	BL-INLETOFFSET
630			1675239.4434	1648544.6277	INLET
631			1675223.4479	1648545.0057	BL-INLETOFFSET
632			1675207.3933	1648542.8845	INLET
633			1675223.3888	1648542.5064	BL-INLETOFFSET
634			1675246.1407	1648827.9728	INLET
635			1675230.1451	1648828.3509	BL-INLETOFFSET
636			1675214.1496	1648828.7290	INLET
637			1675230.1451	1648828.3509	BL-INLETOFFSET
638			1675190.9722	1648858.6468	INLET
639			1675230.8389	1648857.7044	BL-INLETOFFSET

POINT TABLE					
POINT NUMBER	STATION	OFFSET	NORTHING	EASTING	DESC
640			1675268.7049	1648852.1982	INLET
641			1675230.7300	1648853.0958	BL-INLETOFFSET
642			1675275.0643	1648852.2874	INLET
643			1675230.7357	1648853.3352	BL-INLETOFFSET
644			1675281.4236	1648852.3766	INLET
645			1675230.7413	1648853.5746	BL-INLETOFFSET
646			1675269.2058	1648898.4216	INLET
647			1675231.8123	1648899.2900	BL-INLETOFFSET
648			1675275.5654	1648898.3529	INLET
649			1675231.8141	1648899.3690	BL-INLETOFFSET
650			1675281.9250	1648898.2842	INLET
651			1675231.8160	1648899.4480	BL-INLETOFFSET
652			1675201.1162	1649241.2346	INLET
653			1675239.5726	1649240.3098	BL-INLETOFFSET
654			1675278.2393	1649240.3756	INLET
655			1675239.7546	1649241.2694	BL-INLETOFFSET
656			1675289.5662	1649240.1125	INLET
657			1675239.7546	1649241.2694	BL-INLETOFFSET
658			1675278.9659	1649271.0885	INLET
659			1675240.3352	1649272.0175	BL-INLETOFFSET
660			1675290.2926	1649270.8161	INLET
661			1675240.3352	1649272.0175	BL-INLETOFFSET

POINT TABLE					
POINT NUMBER	STATION	OFFSET	NORTHING	EASTING	DESC
2000			1674561.8411	1649665.5065	SD
2001			1674611.9171	1649664.6144	SD
2002			1675221.6323	1649656.9505	SD
2004			1675918.7969	1649648.9996	SD
3004			1675295.7597	1650385.2486	SD
10001			1675239.4100	1649967.1500	SDMD
10002			1675272.6400	1649754.3800	SDMD
10003			1675226.9200	1649453.8000	SDMD
10004			1675243.8000	1649173.3300	+CUT
10005			1675246.7600	1648772.5600	SDMD
10006			1675243.6700	1648456.3500	SDMD
10007			1675213.8900	1648131.3300	SD 3/4"PIPE
10008			1675186.3200	1647811.7000	SDMD
10009			1675196.9000	1647385.2200	SD 1/2"BAR
10010			1675202.5100	1646756.8200	SDMD
10011			1675196.8600	1646364.7500	SDMD
10012			1675106.9500	1646084.1000	SDMD
10021			1675247.1090	1648772.6290	SDMD
11000			1675192.7800	1646425.8490	BM 2
13001			1675273.0940	1649770.0810	BM 11
13077			1675229.4540	1650004.6210	THIMBLE 3/4"PIPE
13505			1675278.9990	1649657.6180	SD 1"PIPE
13579			1675273.0830	1649770.1340	BM 11
13717			1675271.0640	1649590.1160	+CUT
13805			1675232.6910	1649587.2410	BM 10
14037			1675185.0100	1649271.8990	BM 9
14153			1675240.0920	1649255.8160	THIMBLE 1"PIPE
14515			1675231.2720	1648876.0180	THIMBLE 1"PIPE
14657			1675211.6230	1648693.3180	BM 8
14849			1675222.2990	1648496.3970	THIMBLE 1/2"PIPE
14850			1675132.7490	1648517.6190	BM 7
15279			1675197.8980	1648101.3140	BM 6
15331			1675244.4130	1648160.9040	+CUT
15658			1675353.4360	1647784.5960	BM 5
15805			1675185.6070	1647561.6010	BM 4
16206			1675171.9960	1647066.0120	BM 3
16358			1675188.5980	1647025.4880	SD 3/4"PIPE
16767			1675182.5530	1646665.5810	SPIKE
16921			1675193.0110	1646425.7320	BM 2
17229			1675320.5930	1646103.4710	BM 1

PLOT DATE: Tuesday, May 27, 2008 @ 08:44PM

J:\CIVIL\05620\DWG\SWS\05620-BUBBLESW2.DWG