

**MT VERNON STREET AND  
DRAINAGE IMPROVEMENTS  
FROM GREENWAY TO BROADWAY**

**STORM SEWER  
BUBBLE MAP**

SHEET TITLE 472-84289  
448-90385  
468-84514  
PROJECT NUMBER

DESIGN BY JRA  
DRAWN BY JSB  
CHECKED BY JRA

ISSUED  
May 27, 2008

REVISED

SHEET NO.  
43 of 120

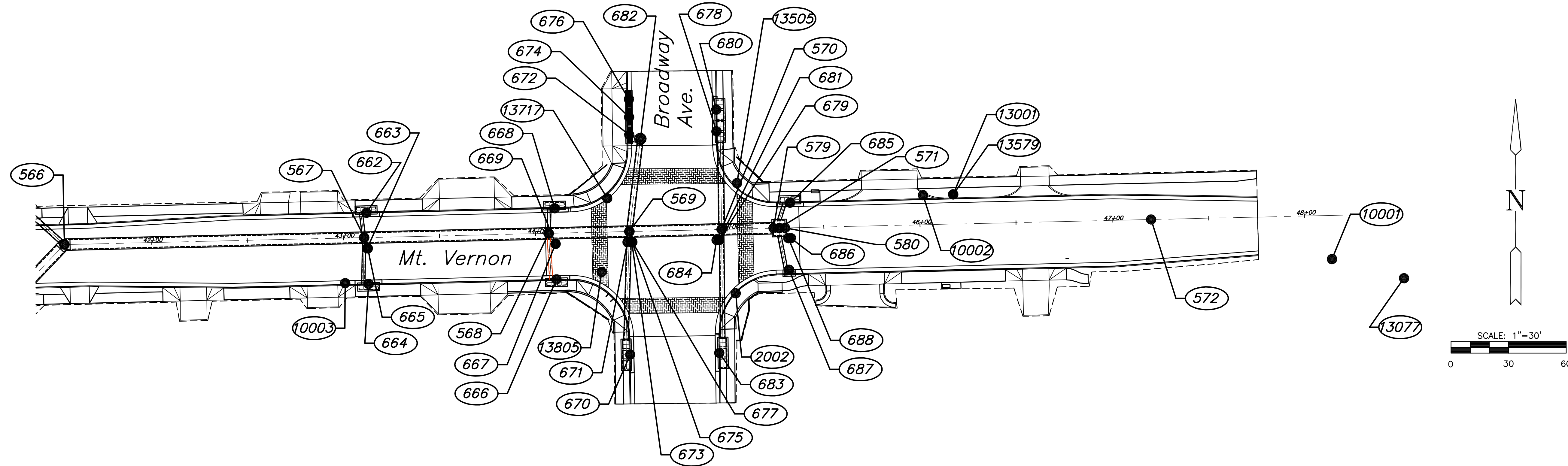

POINT TABLE					
POINT NUMBER	STATION	OFFSET	NORTHING	EASTING	DESC
2000			1674561.8411	1649665.5065	SD
2001			1674611.9171	1649664.6144	SD
2002			1675221.6323	1649656.9505	SD
2004			1675918.7969	1649648.9996	SD
3004			1675295.7597	1650385.2486	SD
10001			1675239.4100	1649967.1500	SDMD
10002			1675272.6400	1649754.3800	SDMD
10003			1675226.9200	1649453.8000	SDMD
10004			1675243.8000	1649173.3300	+CUT
10005			1675246.7600	1648772.5600	SDMD
10006			1675243.6700	1648456.3500	SDMD
10007			1675213.8900	1648131.3300	SD 3/4"PIPE
10008			1675186.3200	1647811.7000	SDMD
10009			1675196.9000	1647385.2200	SD 1/2"BAR
10010			1675202.5100	1646756.8200	SDMD
10011			1675196.8600	1646364.7500	SDMD
10012			1675106.9500	1646084.1000	SDMD
10021			1675247.1090	1648772.6290	SDMD
11000			1675192.7800	1646425.8490	BM 2
13001			1675273.0940	1649770.0810	BM 11
13077			1675229.4540	1650004.6210	THIMBLE 3/4"PIPE
13505			1675278.9990	1649657.6180	SD 1"PIPE
13579			1675273.0830	1649770.1340	BM 11
13717			1675271.0640	1649590.1160	+CUT
13805			1675232.6910	1649587.2410	BM 10
14037			1675185.0100	1649271.8990	BM 9
14153			1675240.0920	1649255.8160	THIMBLE 1"PIPE
14515			1675231.2720	1648876.0180	THIMBLE 1"PIPE
14657			1675211.6230	1648693.3180	BM 8
14849			1675222.2990	1648496.3970	THIMBLE 1/2"PIPE
14850			1675132.7490	1648517.6190	BM 7
15279			1675197.8980	1648101.3140	BM 6
15331			1675244.4130	1648160.9040	+CUT
15658			1675353.4360	1647784.5960	BM 5
15805			1675185.6070	1647561.6010	BM 4
16206			1675171.9960	1647066.0120	BM 3
16358			1675188.5980	1647025.4880	SD 3/4"PIPE
16767			1675182.5530	1646665.5810	SPIKE
16921			1675193.0110	1646425.7320	BM 2
17229			1675320.5930	1646103.4710	BM 1

POINT TABLE					
POINT NUMBER	STATION	OFFSET	NORTHING	EASTING	DESC
566			1675247.0034	1649307.7308	45Bend/MH
567			1675250.5970	1649463.6894	MH
568			1675252.8084	1649559.6639	MH
569			1675253.7759	1649601.6528	MH
570			1675254.8816	1649649.6401	MH
571			1675255.5727	1649679.6321	Rein.MH
572			1675260.0286	1649873.0162	Plug
579			1675255.5036	1649676.6329	EndRCB
580			1675255.6418	1649682.6312	BeginRCB
662			1675263.4735	1649464.7735	INLET
663			1675244.9813	1649465.2182	BL-INLETOFFSET
664			1675226.4924	1649466.0023	INLET
665			1675244.9895	1649465.5575	BL-INLETOFFSET
666			1675228.8421	1649563.6967	INLET
667			1675247.3389	1649563.2519	BL-INLETOFFSET
668			1675265.8314	1649562.8071	INLET
669			1675247.3389	1649563.2518	BL-INLETOFFSET
670			1675189.7311	1649602.0624	INLET
671			1675248.2442	1649600.6713	BL-INLETOFFSET
672			1675304.0545	1649601.5704	INLET
673			1675248.2926	1649602.9113	BL-INLETOFFSET
674			1675313.3141	1649601.4902	INLET
675			1675248.2960	1649603.0538	BL-INLETOFFSET
676			1675322.5738	1649601.4100	INLET
677			1675248.2994	1649603.1962	BL-INLETOFFSET
678			1675305.8737	1649646.9440	INLET
679			1675249.3762	1649648.2872	BL-INLETOFFSET
680			1675317.2031	1649646.8228	INLET
681			1675249.3797	1649648.4353	BL-INLETOFFSET
682			1675301.9574	1649607.4079	MH
683			1675190.5812	1649648.3902	INLET
684			1675249.3454	1649646.9931	BL-INLETOFFSET
685			1675268.7596	1649685.2239	INLET
686			1675250.2648	1649685.6636	BL-INLETOFFSET
687			1675233.8539	1649684.7196	INLET
688			1675250.2331	1649684.3302	BL-INLETOFFSET