

NOTE:
 8" CIP TO BE PLACED UNDER U.S. 54 SLABS BY
 LIFTING AND SLIDING PIPE INTO PLACE. ROUGHED
 HOLE TO BE LINED WITH STEEL PIPE IF NECESSARY.
 2" SAND LIME TO BE USED TO FILL ROUGHED HOLE
 AROUND 8" CIP. (IN THE JUDGMENT OF THE
 ENGINEER) USED STEEL PIPE WILL BE ACCEPTABLE
 FOR INSTALL. OF 8" CIP TO INCLUDE PASSING
 OVER 4" EMBLEMMENT.

NOTE:
 REPAIR DRIVES WITH 4" ASPHALTIC CONCRETE.
 ALSO, RESTORE FENCES TO ORIGINAL CONDITION OR
 BETTER.

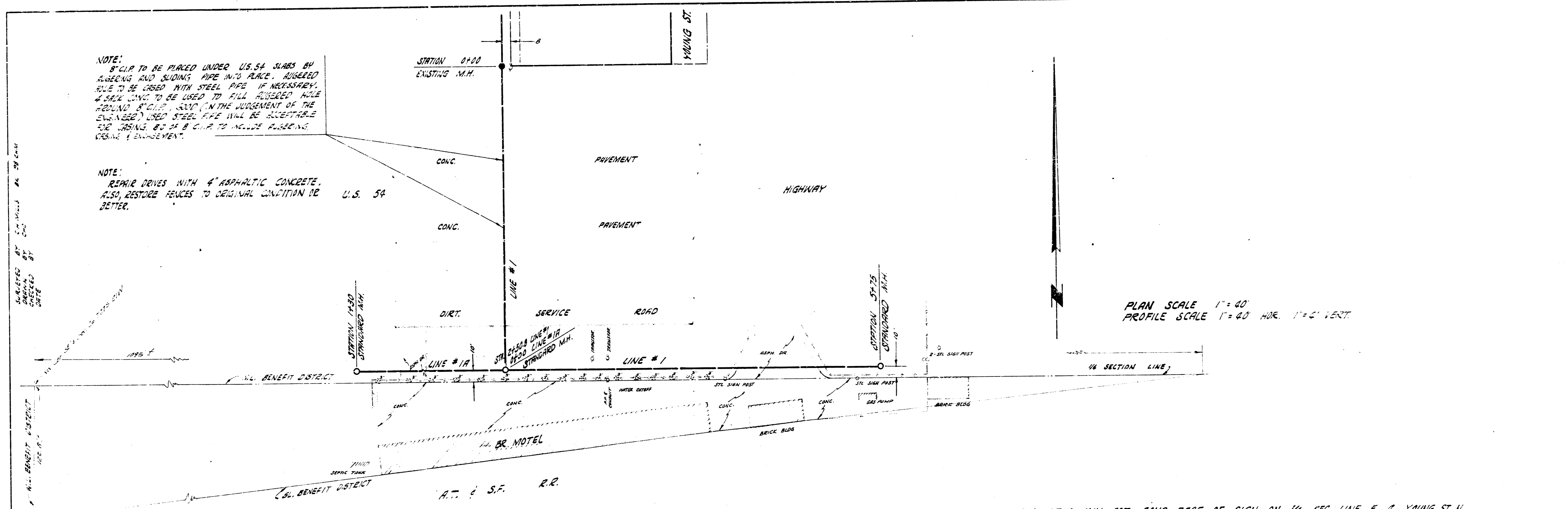

B.M. 117.14 N.W. COR. CONC. BASE OF SIGN ON 1/4 SEC. LINE E & YOUNG ST. N.
 B.M. 117.846 STANDARD @ ANNA & S.S. OF U.S. 54

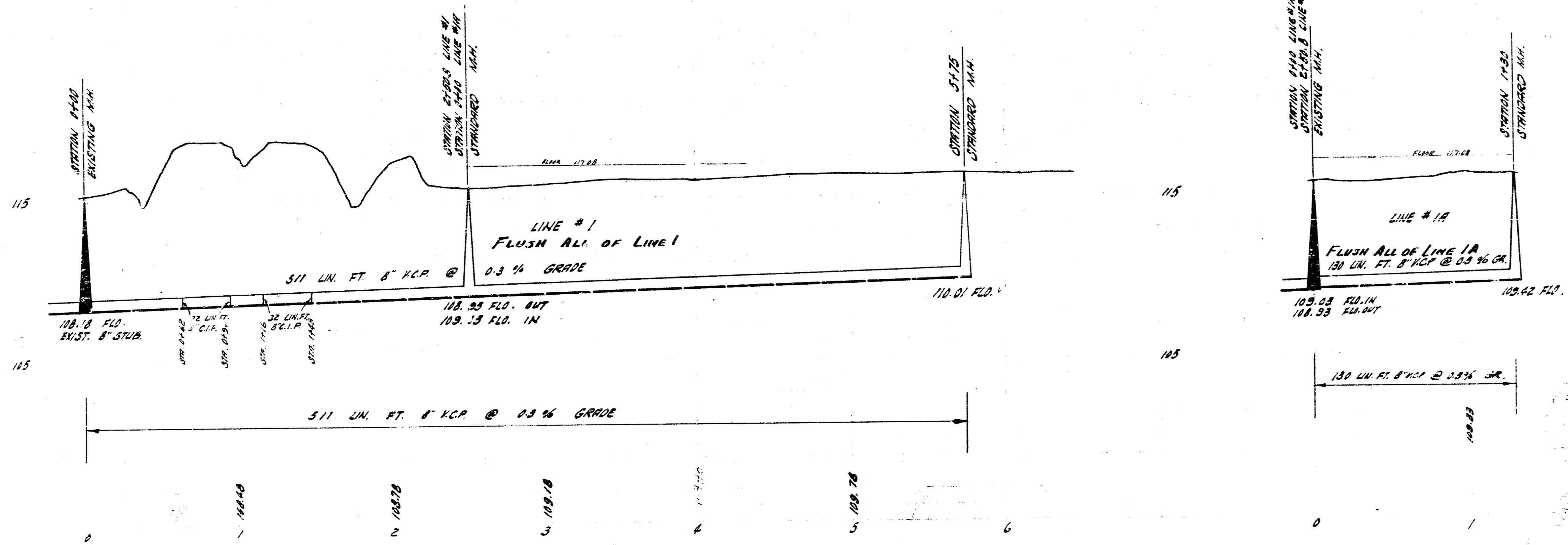

LATERAL 37 SUB 5 S.S. 22
 CITY OF WICHITA, KANSAS
 B.E. SMITH, CITY ENGINEER
 PROJ. NO. C28-3 DATE NOV. 1958