

Plan Scale 1" = 40' Horiz.
 Profile Scale 1" = 4' Vert.

B. M. 117.90 "a" on N.E. cor. W. 2nd. Culvert on Anna at N.W. Maple.

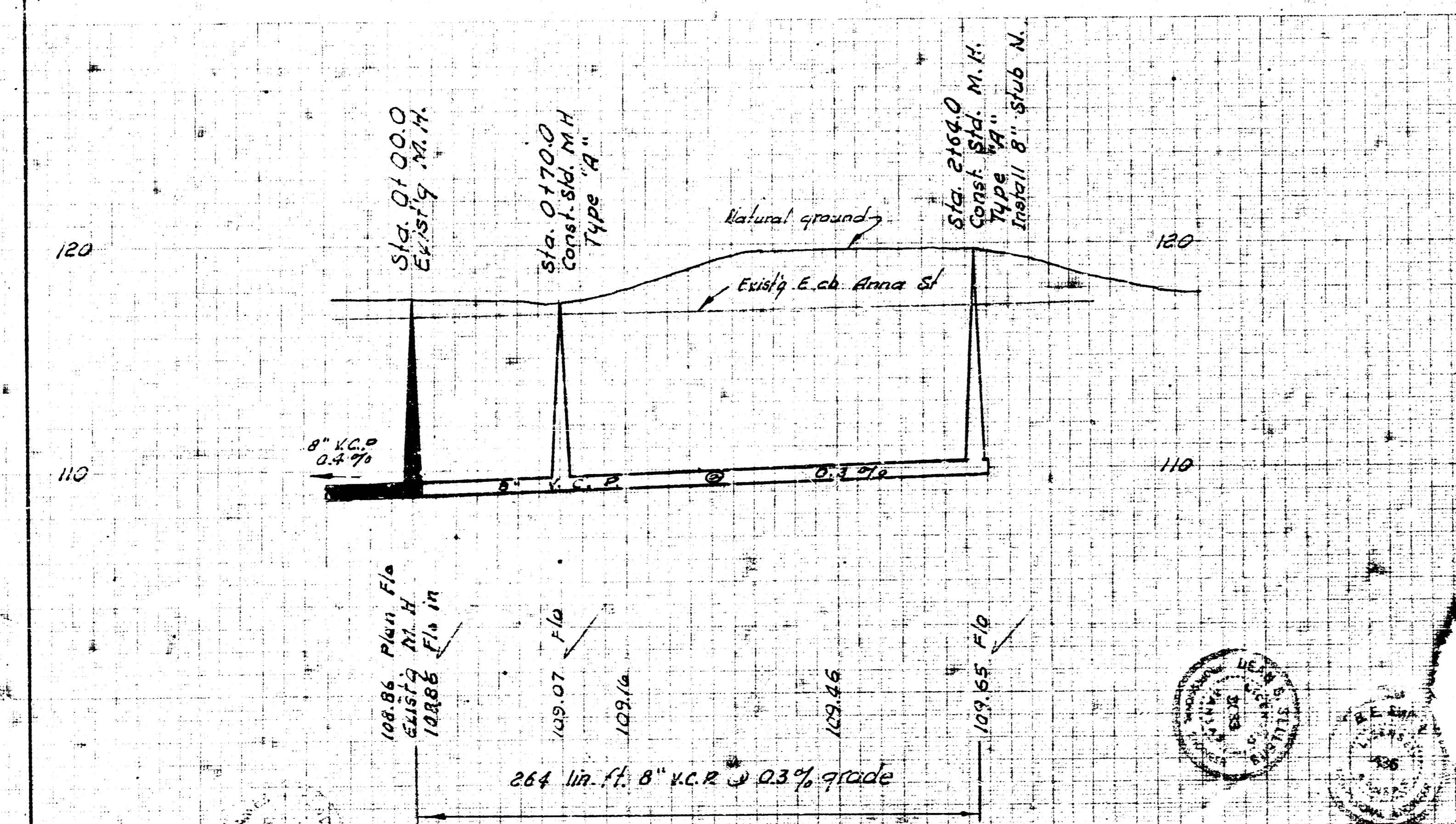

LAT. 189, SUBMAIN 5, S. S. NO. 22
 CITY OF WICHITA, KANSAS
 B. E. SMITH CITY ENGINEER
 MAR. 1966 PROJECT NO. C25-46

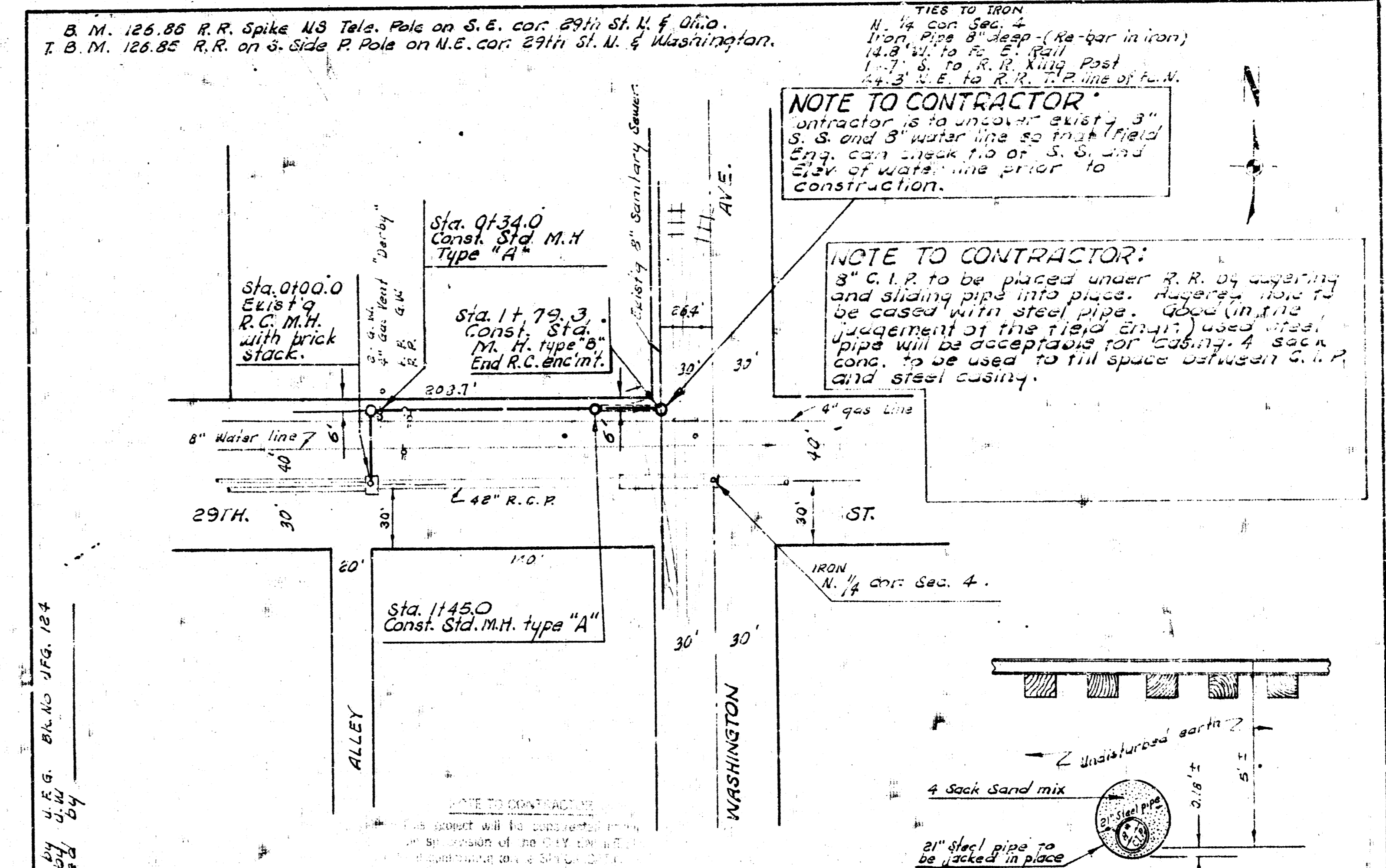

NOTE TO CONTRACTOR:
 Contractor is to uncover existing 3" S. S. and 8" water line so that field City can locate line of S. S. and 8" water line prior to construction.

NOTE TO CONTRACTOR:
 3" C.I.P. to be placed under R.R. by digging and sliding pipe into place. Pipes to be cased with steel pipe. Good (in situ) judgement of the field engineer is to be used. Pipe will be acceptable for casing. 4 sack concrete to be used to fill space between C.I.P. and steel casing.

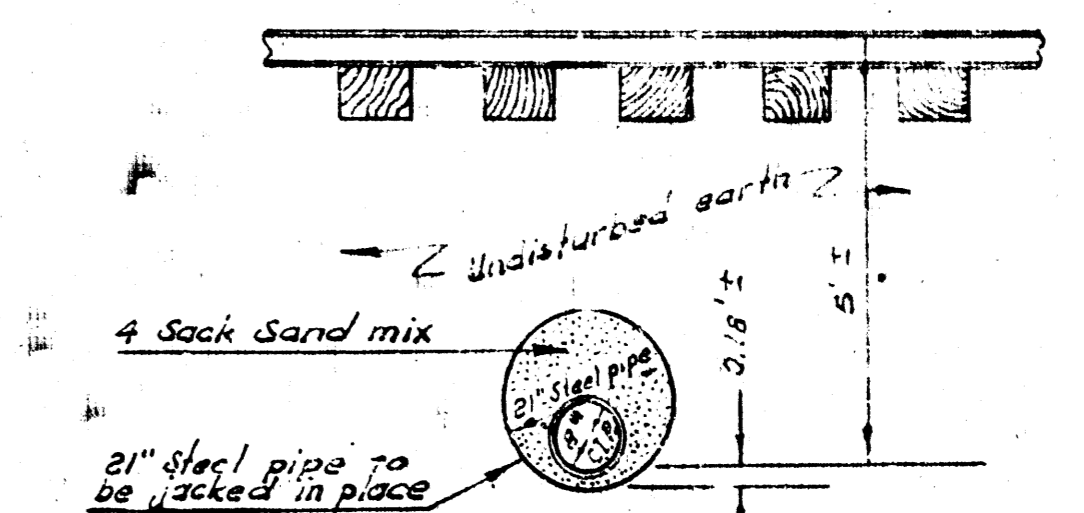

TYPICAL SECTION
 RAILROAD CROSSING DETAIL UNDER R.R. TRACKS
 STA. 1148.0 TO STA. 1793.0

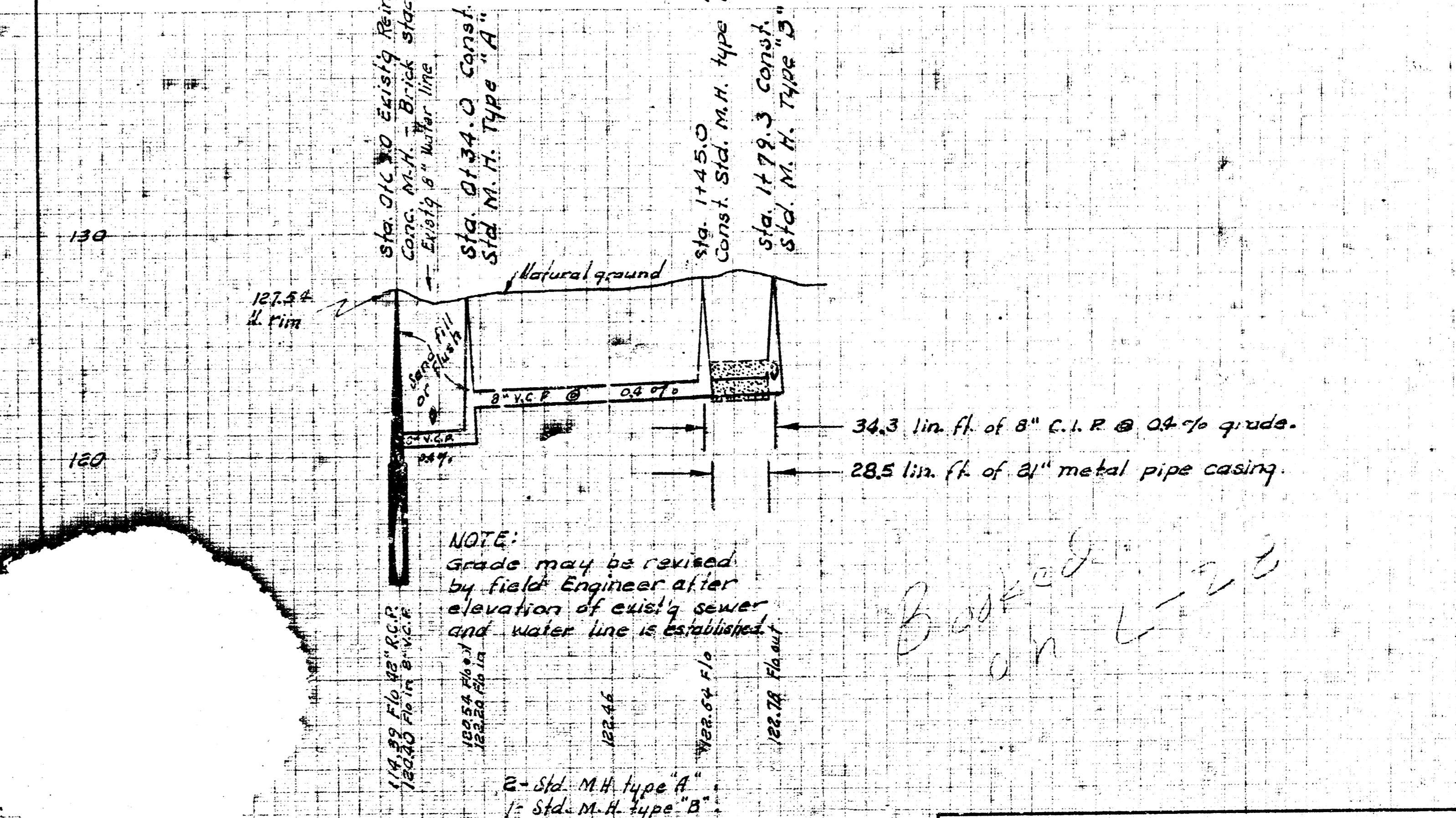

NOTE:
 Grade may be revised by field engineer after elevation of existing sewer and water line is established.

Backed on 1-22

LAT. 52, SUBMAIN 4, S. S. NO. 23
 CITY OF WICHITA, KANSAS
 B. E. SMITH CITY ENGINEER
 DEC. 1965 PRIVATE CONTRACT