

\* B.M. 125.18 "X" cut on conc. ret. wall 10' E. of E.L. Mt. Carmel @ N.L. 18th St.  
 B.M. 124.62 R.R. Spike N.S.P.P. S. of S.W. cor. Custer S. & 18th St.  
 \* Note: Use this B.M. from Paving Plan to Set culvert pipe & top of M.H. in 18th St.

Plan Scale 1" = 40'  
 Profile Scale 1" = 40' Hor.  
 1" = 4' Vert.

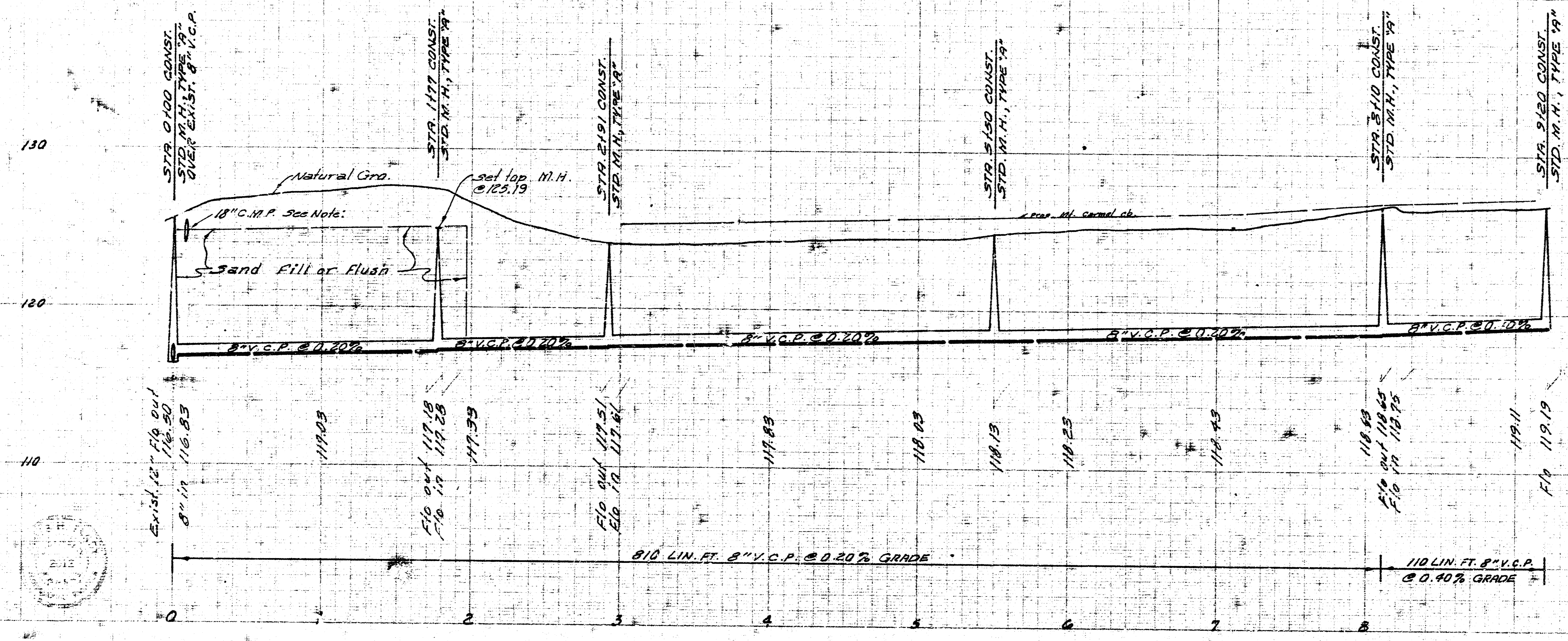

LAT. 28, SUB. 10, S.S. 22  
 CITY OF WICHITA, KANS.  
 B. E. SMITH, CITY ENGINEER  
 PROJ. NO. C-26-54 DATE: OCT. 1947