

Survey by G. W. Bk 2374
 Plan by J. W. Bk 2374
 Checked by J. W. Bk 2374

B. M. 127.86 SW cor 1st. Conc. step Ho.
 NE 27th & Coolidge.
 126.34
 B. M. 126.07 60# nail S.S. R.P.N.S. 27th
 325' W. of Porter.
 B. M. 128.58 X on SE cor. conc. sign base
 SE 27th St. 155' E of EL Coolidge.

Begin Project
 Sta 1150
 Const. M.H. Type "A"
 Leg. 8" V.C.P. East
 Stub North

Sta 3185 Const. Std. M.H.
 Type "A" = 56 0400 Line #2

NOTE:
 Underground
 Cable.

NOTE:
 2" gas line.
 5' W of E. 12'.

Sta. 0100
 Std. M.H. Type "A"
 over existing
 Beg. 8" V.C.P. North

Sta. 0100
 Std. M.H. Type "A"
 over existing 10' S.

Begin Project Const.
 Std. M.H. Type "A"
 Sta. 1150

Sta 3185 Const. Std.
 M.H. Type "A" = 56 0400
 Line #2

Sta 6125 Const. Std.
 M.H. Type "A" = 56 0400
 Line #3

Sta 0100 Const. Std.
 M.H. Type "A" = 56 0400
 Line #1

635 L.F. 8" V.C.P. This Sheet

195 L.F. 8" V.C.P.
 In Place - Built Under Private
 Contract

635 L.F. 8" V.C.P.
 @ 0.25% Grade

70 L.F. 8" V.C.P.
 @ 0.25%
 Grade

Plan Scale 1" = 40'
 Profile Scale 1" = 40' Vert.

Note: The contractor shall replace
 all fences as directed by the engineer.
 The contractor shall be held responsible for
 damage to existing laterals. Cost to
 be included in price bid for V.C.P.

LAT. 45, SUBMAIN I7, S. S. NO. 22
 CITY OF WICHITA, KANSAS
 R. E. SMITH CITY ENGINEER
 JAN 1968 PROJECT NO. C26-14
 SHEET NO. 1 OF 2

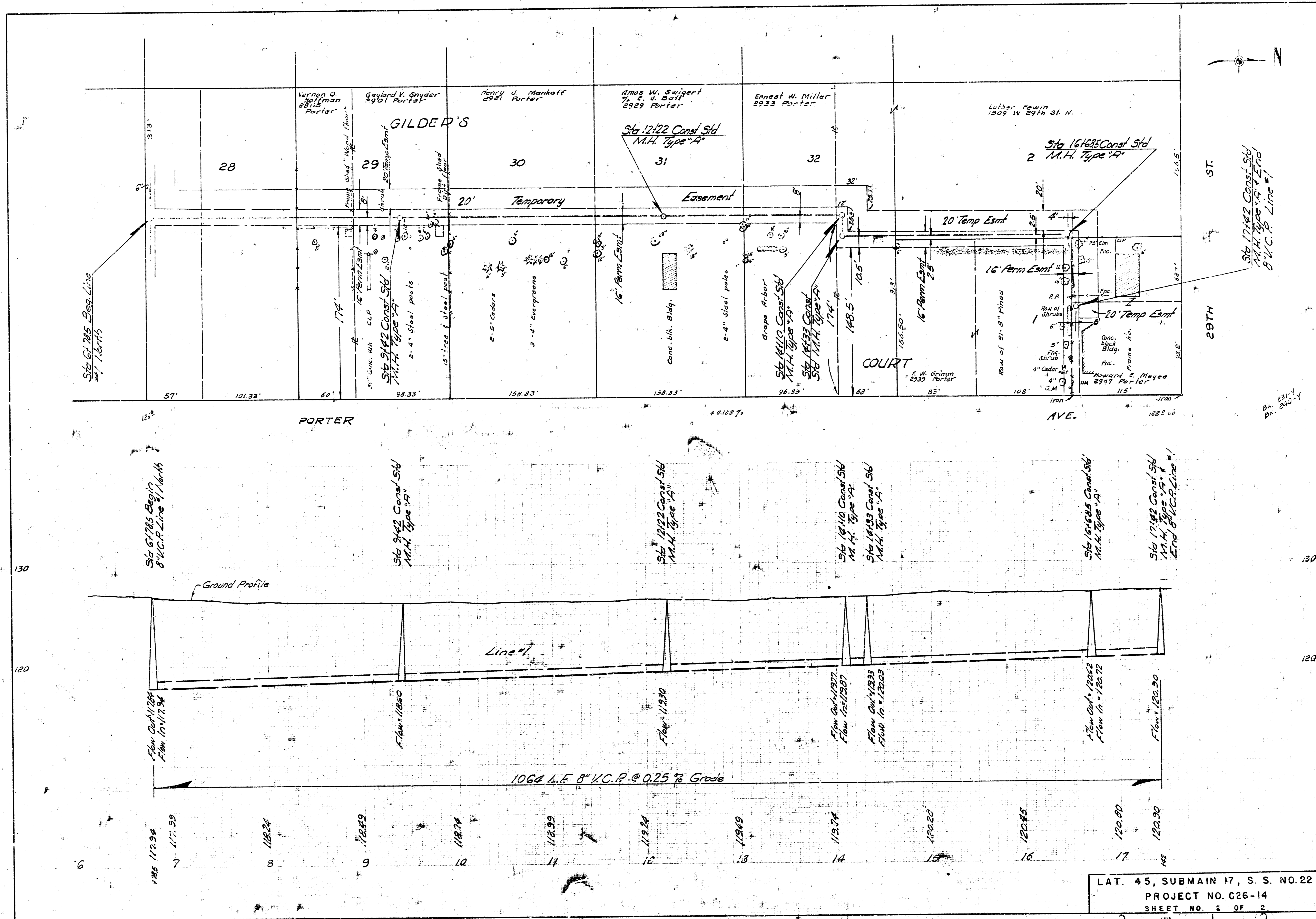

LAT. 45, SUBMAIN 17, S. S. NO. 22
 PROJECT NO. C26-14
 SHEET NO. 2 OF 2