

Note: Field engineer to take ties to top and stave of 29th St. & Woodland and replace them if necessary.

Sta. 0+00 Const. Std. Brick Manhole Type A on exist. 15" San. Sewer.

NOTE: Replace A.C. mat.

Sta. 2+24 Const. Std. Brick Manhole Type A.

Sta. 3+83 Const. Std. Brick Manhole Type A.

Sta. 5+30 Const. Std. Brick Manhole Type A.

Sta. 6+80 Const. Std. Brick Manhole Type A.

Sta. 9+80 Const. Std. Brick Manhole Type A.

NOTE TO CONTRACTOR:
 The contractor to replace all manholes removed on this project.
 Contractor is to replace one cut-off pole for Wm. W. McDowell Res. 2938 N. Woodland Ave.
 Contractor is to replace all fence removed, Septic tank laterals under ground water lines and power pole for Melvin E. Meyer Res. 2900 N. Woodland Ave.
 Contractor to replace all septic tank laterals on the A. U. Pruitt property.
 The removal and replacing of all septic tank laterals and underground water lines is to be incidental to the project.

Plan Scale 1"=40'
 Profile Scale 1"=40' Hor.
 1"=4' Vert.

0+00 Flow Out = 120.24
 Flow In = 120.82

1+00 Flow = 120.97

2+00 Flow = 121.12

2+24 Flow = 121.15

3+00 Flow = 121.27

3+83 Flow = 121.39

4+00 Flow = 121.42

5+00 Flow = 121.57

5+30 Flow = 121.62

6+00 Flow = 121.72

6+80 Flow = 121.84

7+00 Flow = 121.87

8+00 Flow = 122.02

9+00 Flow = 122.17

9+80 Flow = 122.27

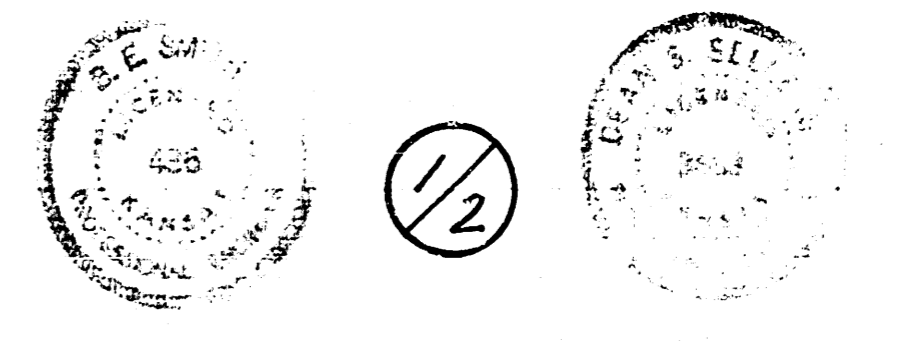

LAT. 39, SUB. 4, S. S. 23
 CITY OF WICHITA, KANSAS
 B.E. SMITH, CITY ENGINEER
 PROJECT NO. C23-91
 DATE: JUNE 1939

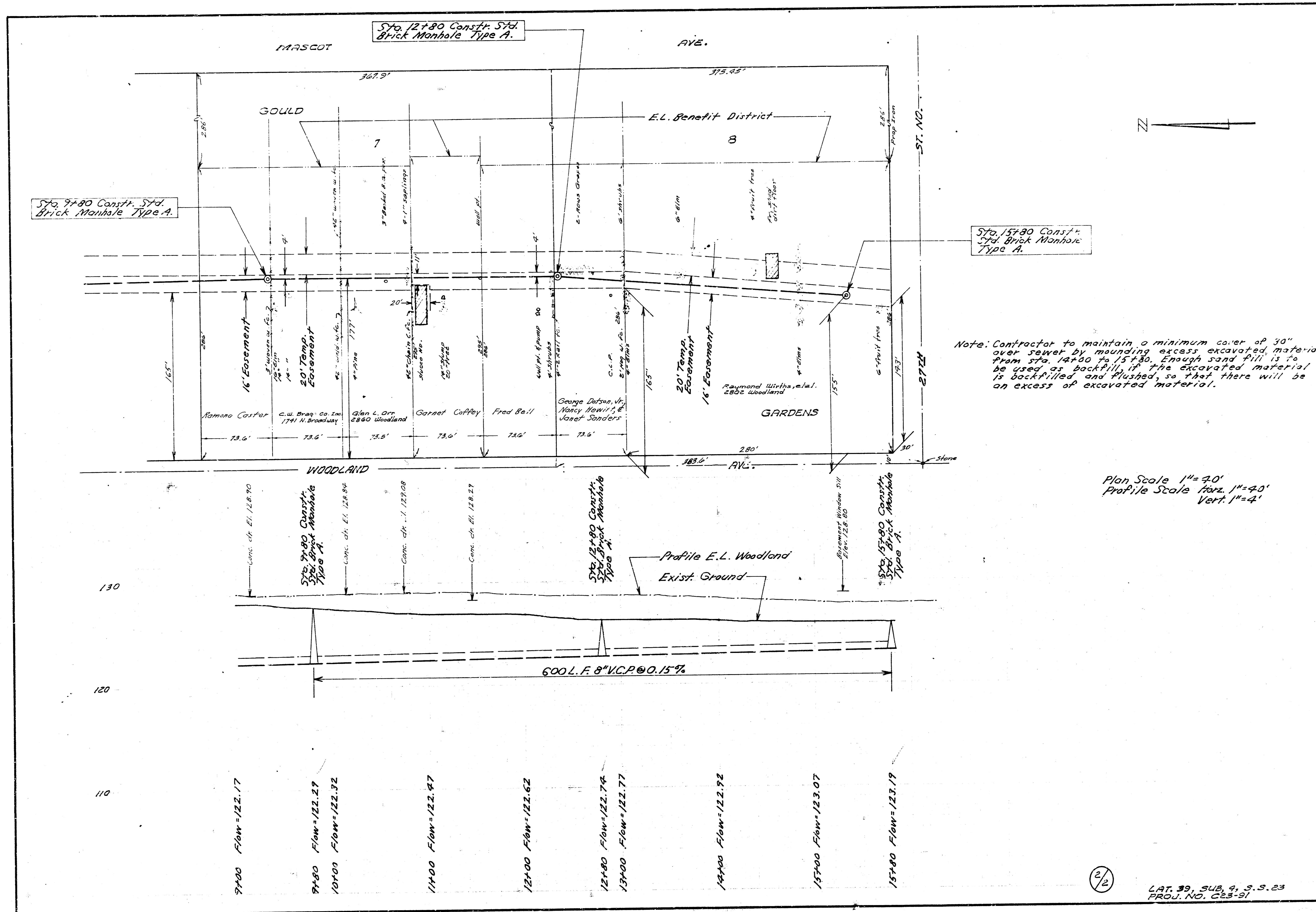

Note: Contractor to maintain a minimum cover of 30" over sewer by mounding excess excavated material from sta. 14+00 to 15+80. Enough sand fill is to be used as backfill, if the excavated material is backfilled and flushed, so that there will be an excess of excavated material.

Plan Scale 1" = 40'
Profile Scale Horiz. 1" = 40'
Vert. 1" = 4'

(2)

LAT. 33, SUB. 4, S.S. 23
PROJ. NO. C23-91