

LOCATION MAP

WICHITA - VALLEY CENTER FLOOD CONTROL R/W

BM: "D" CUT IN NW COR. BRIDGE
SO. FACE OF WALK. EL. 129.87

Booked
J-232

APPROVED AS NOTED

By: CITY ENGINEER OF WICHITA

Sanitary Sewers *[Signature]*

Storm Sewers

Driveway Approaches

Water Mains

Paving

NOTE TO CONTRACTOR

This project will be constructed under the supervision of the CITY ENGINEER and conforming to the SPECIFICATIONS of the CITY OF WICHITA. The CONTRACTOR will pay the City of Wichita for all cases of plan review, inspection and booking per contract.

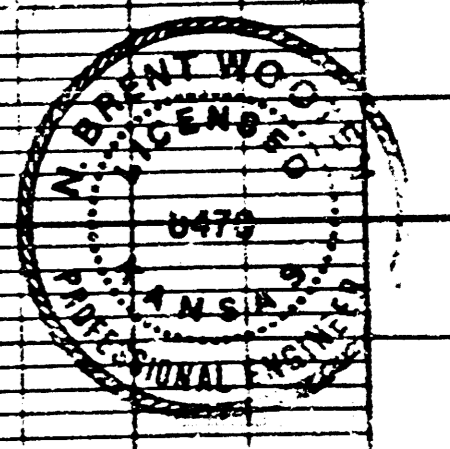

PRIVATE SANITARY SEWER EXTENSION TO SERVE LOT II, ANDRIA ADDITION
PRIVATE PROJ. 448-76-245-00001-000-000-130

BAUGHMAN COMPANY, P.A.
SURVEYING & ENGINEERING
316263-2271 • 3001 JARA • WICHITA, KANSAS 67211

REVISED APR. 15, 1988
REVISED MAR. 31, 1990
REVISED MAR. 26, 1993

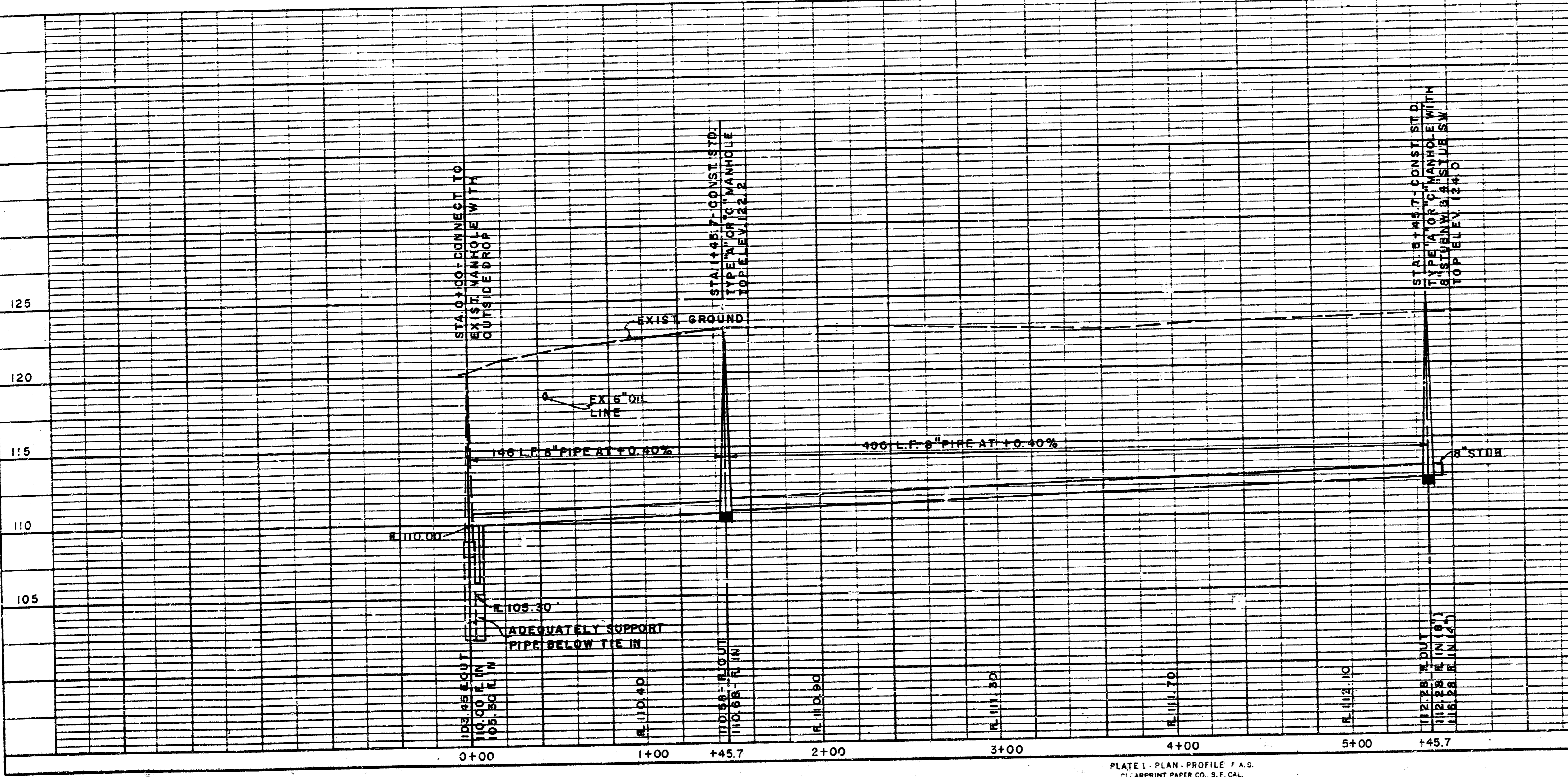
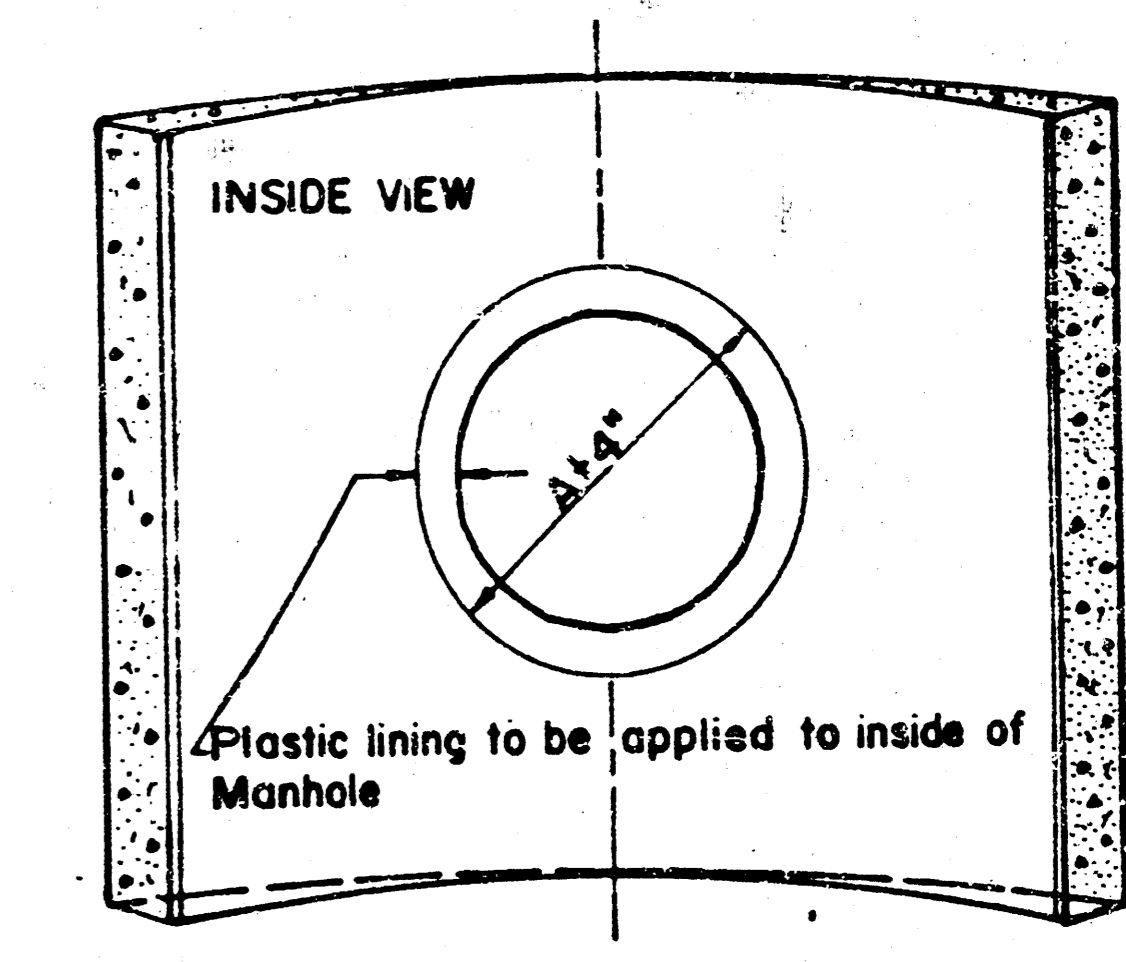
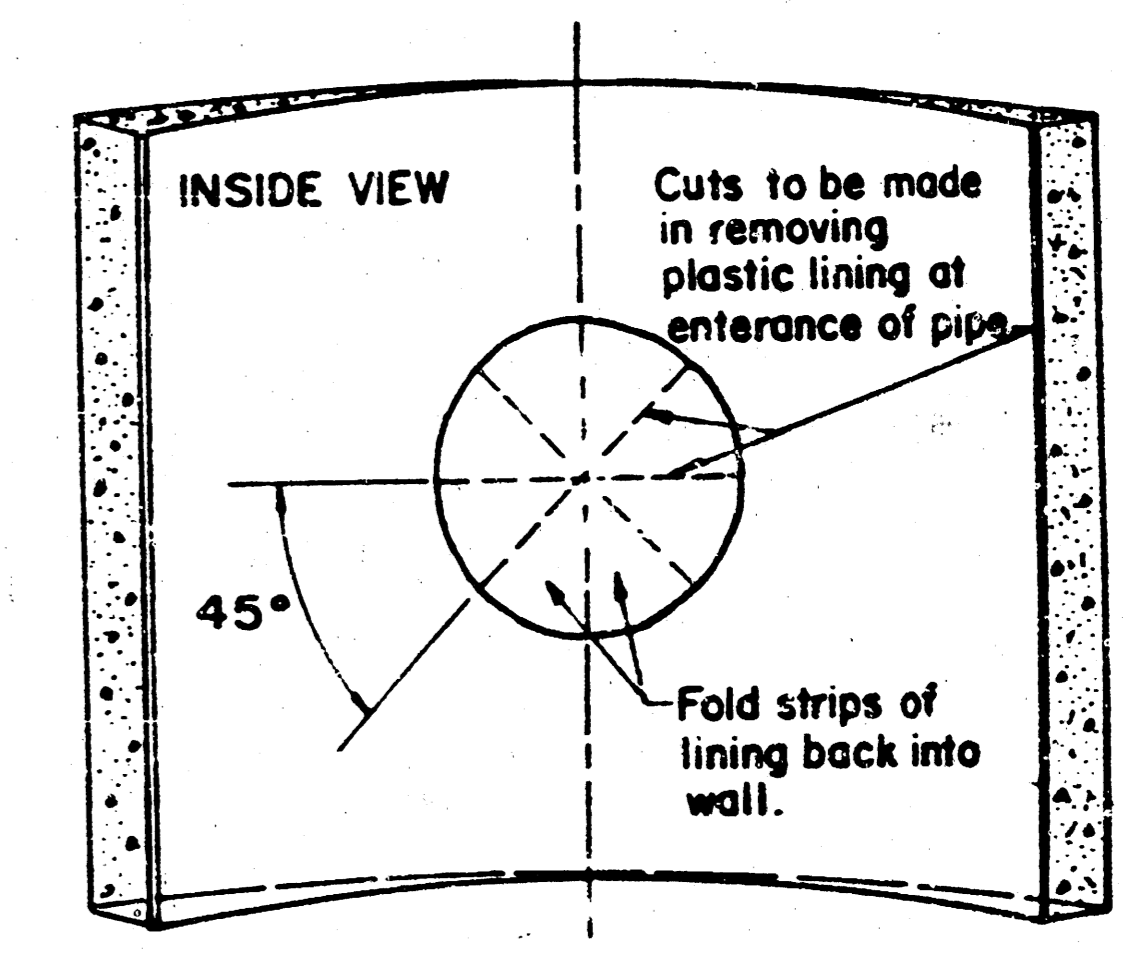
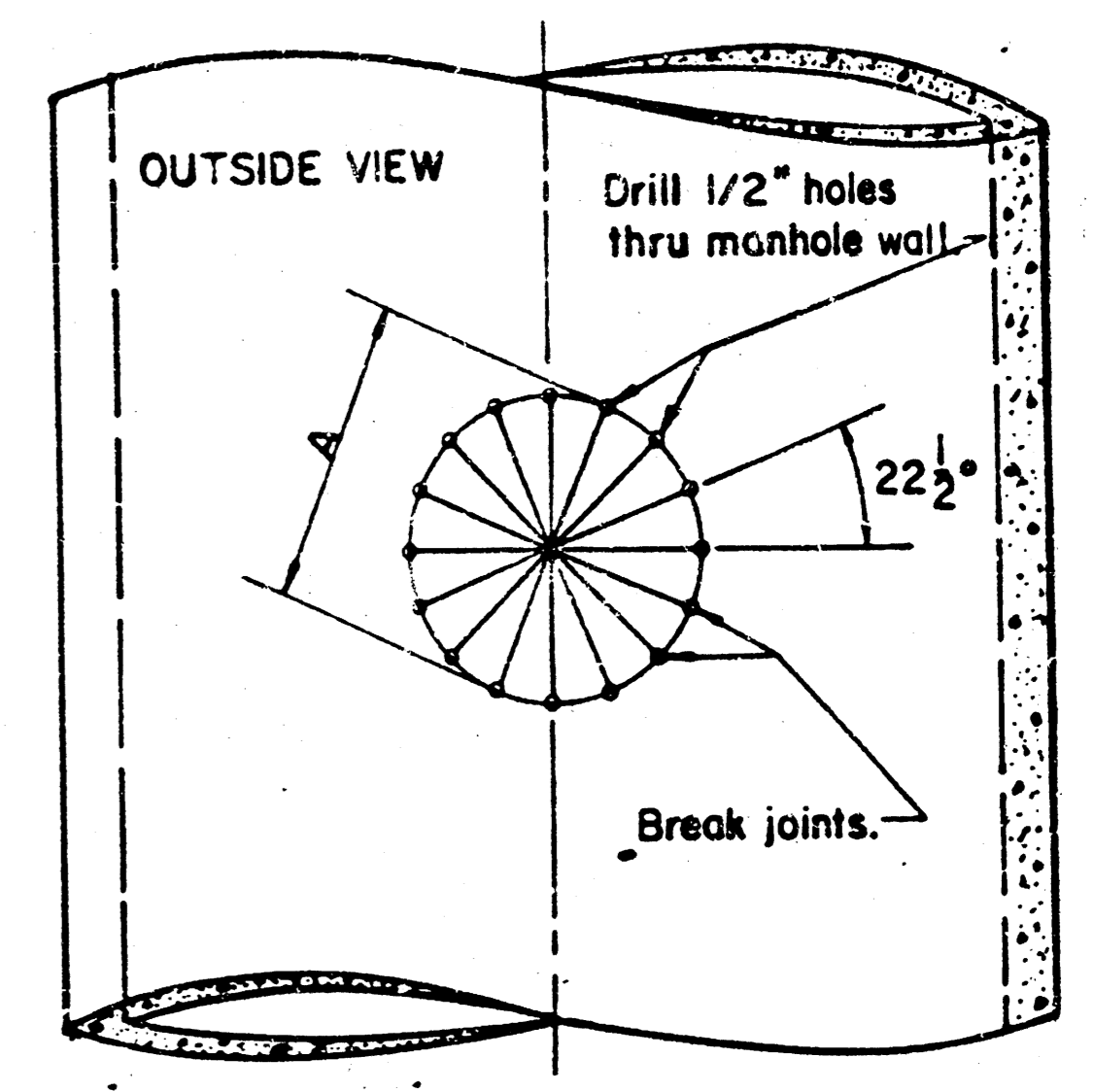
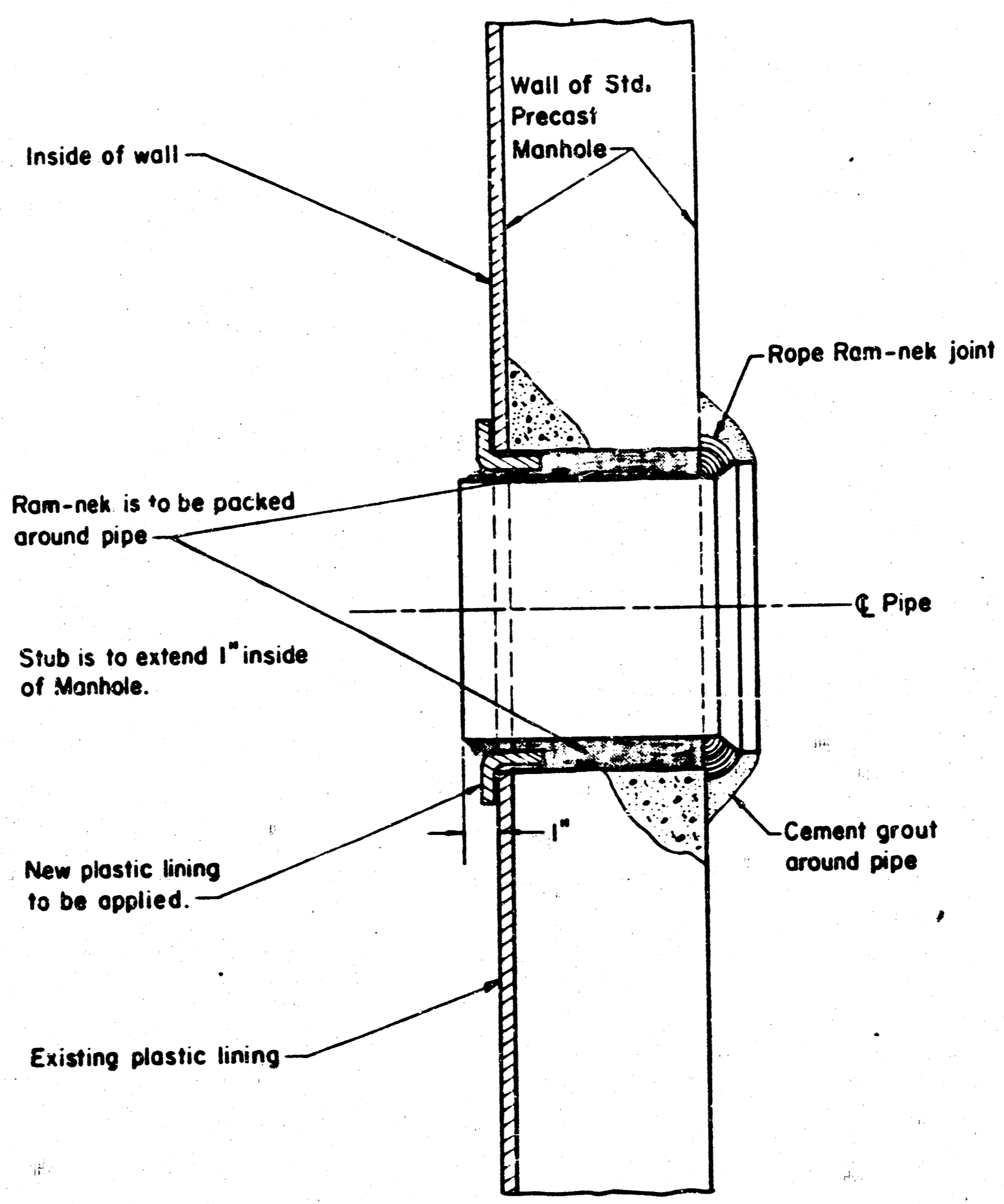

PLATE 1 - PLAN - PROFILE F.A.S.
CLARIPRINT PAPER CO., S.F. CAL.
10 102M1

FILMED FROM THE BEST AVAILABLE COPY



A = OUTSIDE DIAMETER OF PIPE + 2"

WITH CONTRACTOR
 THE CITY ENGINEER'S OFFICE
 SUPERVISION OF THE CITY ENGINEER'S OFFICE
 CITY OF WICHITA, KANSAS

DRAWN: Oct. 1978
 DETAIL OF PIPE CONNECTION
 TO STRUCTURAL TEE MANHOLE
 CITY OF WICHITA, KANSAS
 PROJECT NUMBER: 14 3 1 1
 DATE:

FILMED FROM THE BEST AVAILABLE COPY