

- GENERAL NOTES
- THE CONTRACTOR SHALL COMPLY WITH BEECH AIRCRAFT CORPORATION, PLANT ENGINEERING DEPARTMENT.
  - ALL CONSTRUCTION AND MATERIALS TO COMPLY WITH CITY OF WICHITA SPECIFICATIONS AND STANDARDS.
  - THE CONTRACTOR SHALL LIMIT THE EXTENT OF TRENCH TO REMAIN OPEN OVERNIGHT AND MEASURING TO LESS THAN 50 FEET.
  - AT LEAST 48 HOURS PRIOR TO BEGINNING EXCAVATION (INCLUDING WEEDS AND HOLES), THE CONTRACTOR SHALL CONTACT THE KANSAS ONE-CALL SYSTEM, A UTILITY LOCATION SERVICE, BY CALLING 800-455-4545 TO REQUEST THE FOLLOWING UTILITY COMPANIES TO LOCATE ANY EXISTING LINES WITHIN THE PROJECT AREA: GAS SERVICE COMPANY, I.R. & E., THE WICHITA WATER DEPARTMENT, AND AIR CAPITAL CABLEVISION.
  - PERL MARSHALL, BEECH AIRCRAFT CORP. 681-7700 L.A. FLUSCIE 681-7009 DISPATCHER
  - THE CONTRACTOR SHALL BE RESPONSIBLE FOR PROTECTING PROPERTY ITEMS. THE CONTRACTOR SHALL BE REQUIRED TO RE-ESTABLISH ANY PROPERTY ITEMS WHICH ARE DAMAGED OR DESTROYED BY HIS CONSTRUCTION OPERATIONS. SUCH ITEMS SHALL BE RE-ESTABLISHED BY A LICENSED LAND SURVEYOR OR A LICENSED PROFESSIONAL ENGINEER IN ACCORDANCE WITH STATE LAWS. ALL COSTS FOR THIS WORK SHALL BE NECESSARY TO THE OTHER ITEMS OF WORK.
  - THE BURIED UTILITIES AS LOCATED ON THE PLANS ARE APPROXIMATE LOCATIONS ONLY. IT SHOULD BE NOTED THAT OTHER BURIED PIPELINES AND CABLES MAY EXIST WHICH ARE NOT SHOWN ON THE PLANS. THE CONTRACTOR SHALL EXERCISE EXTREME CAUTION DURING TRENCHING OPERATIONS TO AVOID DAMAGING ALL LINES. ANY LINES DAMAGED SHALL BE REPAIRED OR REPLACED IMMEDIATELY AS DETERMINED BY THE ENGINEER AT THE CONTRACTOR'S EXPENSE.
  - WHERE CONNECTION TO THE EXISTING SEWER IS REQUIRED, THE CONTRACTOR SHALL BE RESPONSIBLE FOR MAINTAINING CONTINUOUS FLOW OF SANITARY SEWAGE THROUGH CONSTRUCTION. CONTRACTOR'S PROPOSED NOTING FOR MAINTAINING FLOW SHALL BE APPROVED BY THE ENGINEER. COSTS OF MAINTAINING FLOW THROUGH CONSTRUCTION SHALL NOT BE PAID FOR DIRECTLY AND THIS COST SHALL BE CONSIDERED AS SUBSIDIARY TO THE OTHER ITEMS OF WORK.
  - ALL FENCE DAMAGED DURING CONSTRUCTION SHALL BE REPAIRED AND REPLACED TO EXISTING CONDITION.
  - ALL EXCESS EXCAVATION AND DEBRIS, SHALL BE REMOVED FROM THE JOB SITE BY THE CONTRACTOR AND DISPOSED OF AS DIRECTED BY THE OWNER.
  - SAND BACKFILL SHALL COMPLY WITH CITY OF WICHITA STANDARD SPECIFICATIONS AND SHALL BE PLACED TO TOP OF ASTM D695.
  - CONTRACTOR SHALL PROVIDE POSITIVE DRAINAGE AWAY FROM ALL MANHOLE COVERS.
  - ALL BACKFILL FOR MANHOLES SHALL BE EQUIVALENT TO THAT SPECIFIED FOR THE ADJACENT SEWER LINES UNLESS OTHERWISE NOTED AND SHALL BE CONSIDERED SUBSIDIARY TO THE PRICE BID FOR MANHOLES.
  - CONCRETE SHALL HAVE A 28-DAY COMPRESSIVE STRENGTH OF 4,000 PSI. 6-8 BAGS CEMENT/CY. 3-5 GAL. WATER/BAG. CONCRETE SHALL BE AIR ENTRAINED 5% TO 8%. ABRASIVE SAND. WET TENSILE TEST WITH A TOTAL LOSS NOT GREATER THAN 10% BY WEIGHT WHEN TESTED IN ACCORDANCE WITH ASTM C99. PERCENTAGE OF NEAR BY A 48 IMPACT TEST. ASTM C137 SHALL BE LESS THAN 40%. COURSE AGGREGATE TO FINE (COARSE AGGREGATE RETAINED ON 3/8" FINE 40-75% RETAINED ON NO. 10 SIEVE) SHALL BE SUCH THAT NOT MORE THAN 70% OR LESS THAN 40% WILL PASS THE #4 SIEVE, SLUMP 7" TO 9" INCHES.
  - ALL MANHOLES SHALL BE BRICK.
  - INSPECTION SHALL BE PROVIDED BY BEECH AIRCRAFT CORPORATION.
  - THE CONTRACTOR SHALL ARRANGE FOR THE CITY OF WICHITA TO DO AIR TESTING AND TELEVISION INSPECTION OF THE COMPLETED SEWER LINE. TESTING AND TELEVISION SHALL BE PAID FOR BY THE CONTRACTOR IN ACCORDANCE WITH CITY OF WICHITA SPECIFICATIONS.
  - THE CONTRACTOR SHALL RESTORE ALL DITCHES AND SHOULDS, TO THEIR ORIGINAL SLOPES AND GRADES EXCEPT AS SHOWN OTHERWISE.

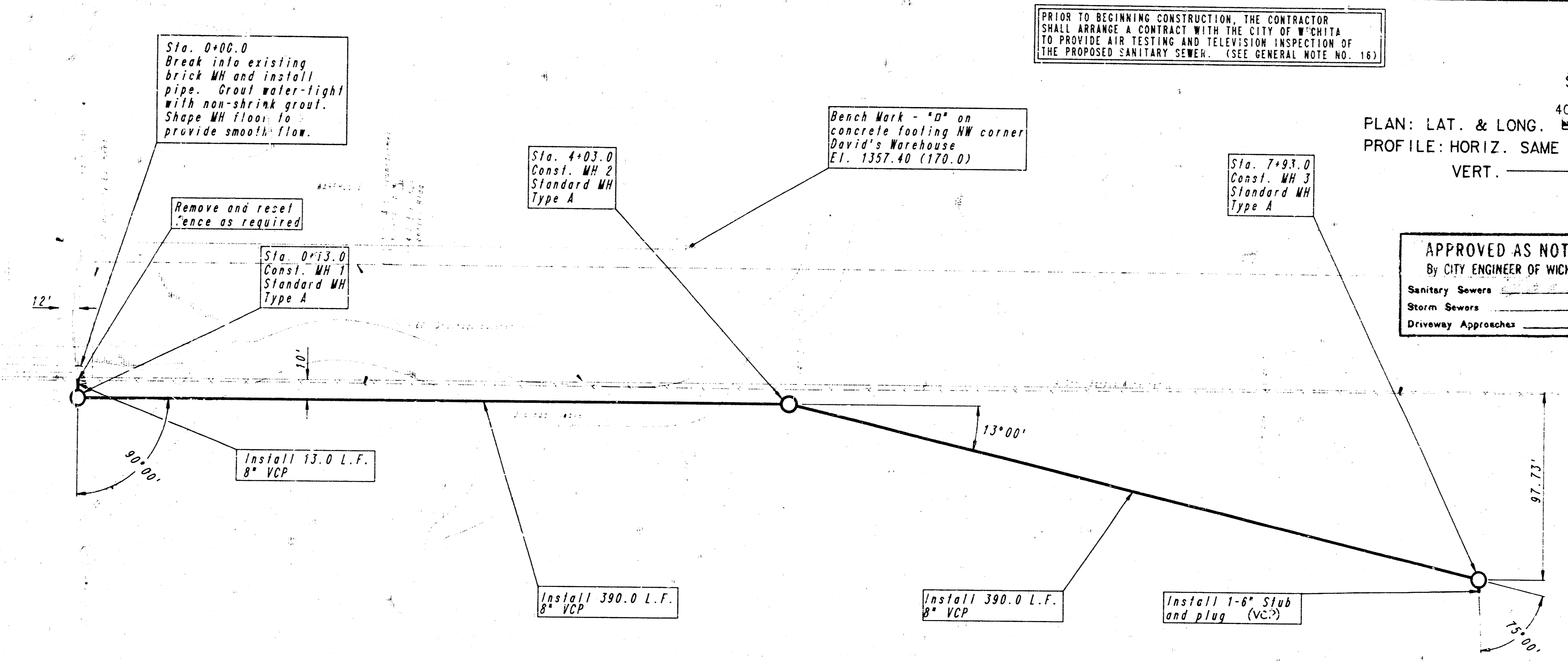

PRIOR TO BEGINNING CONSTRUCTION, THE CONTRACTOR SHALL ARRANGE A CONTRACT WITH THE CITY OF WICHITA TO PROVIDE AIR TESTING AND TELEVISION INSPECTION OF THE PROPOSED SANITARY SEWER. (SEE GENERAL NOTE NO. 16)

SCALE: 40 0 40 80  
 PLAN: LAT. & LONG.  
 PROFILE: HORIZ. SAME AS ABOVE  
 VERT. \_\_\_\_\_

APPROVED AS NOTED  
 By CITY ENGINEER OF WICHITA  
 Sanitary Sewers \_\_\_\_\_  
 Storm Sewers \_\_\_\_\_  
 Driveway Approaches \_\_\_\_\_

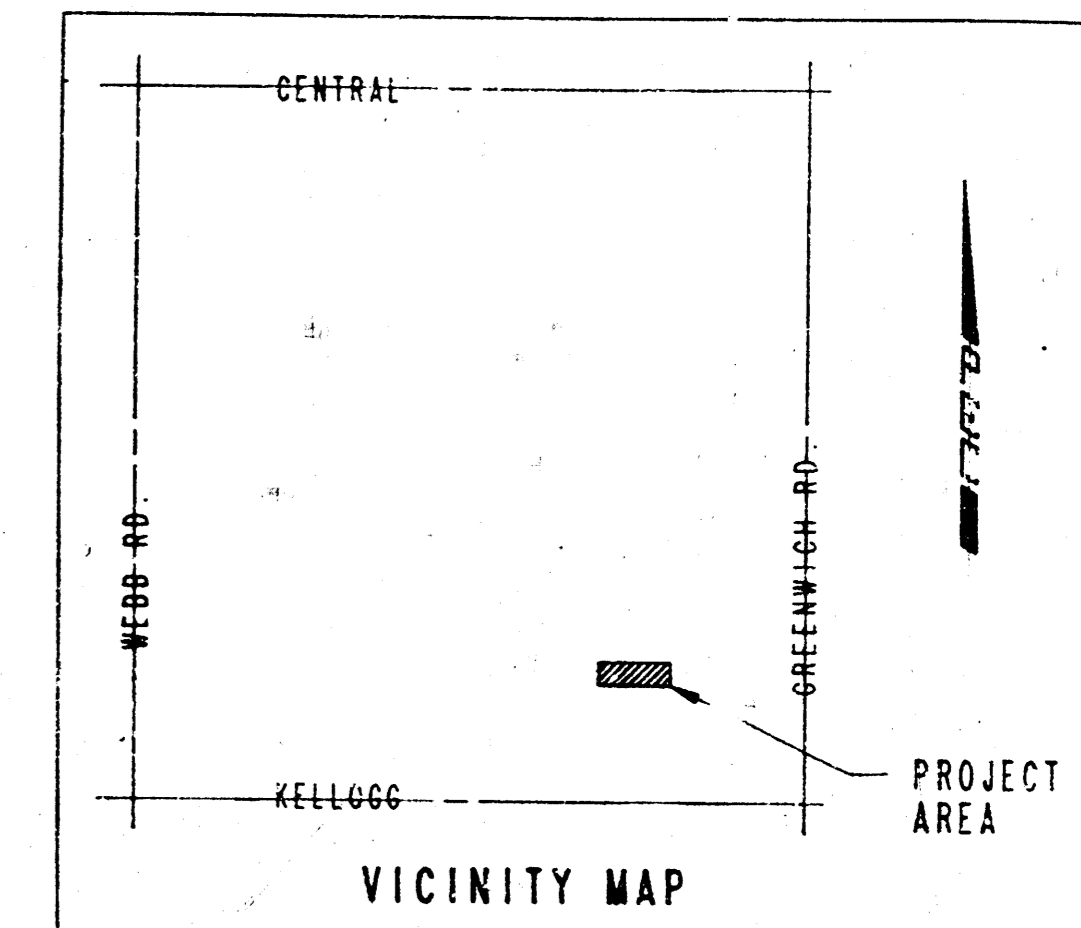
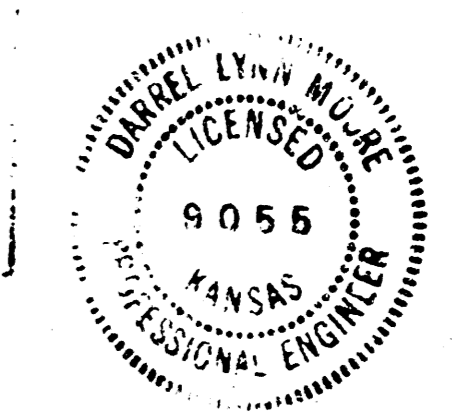

NOTE: ALL ELEVATIONS SHOWN IN PARENTHESES ARE CITY DATUM. ALL OTHERS ARE USGS DATUM (USGS-1187.4 = CITY DATUM)

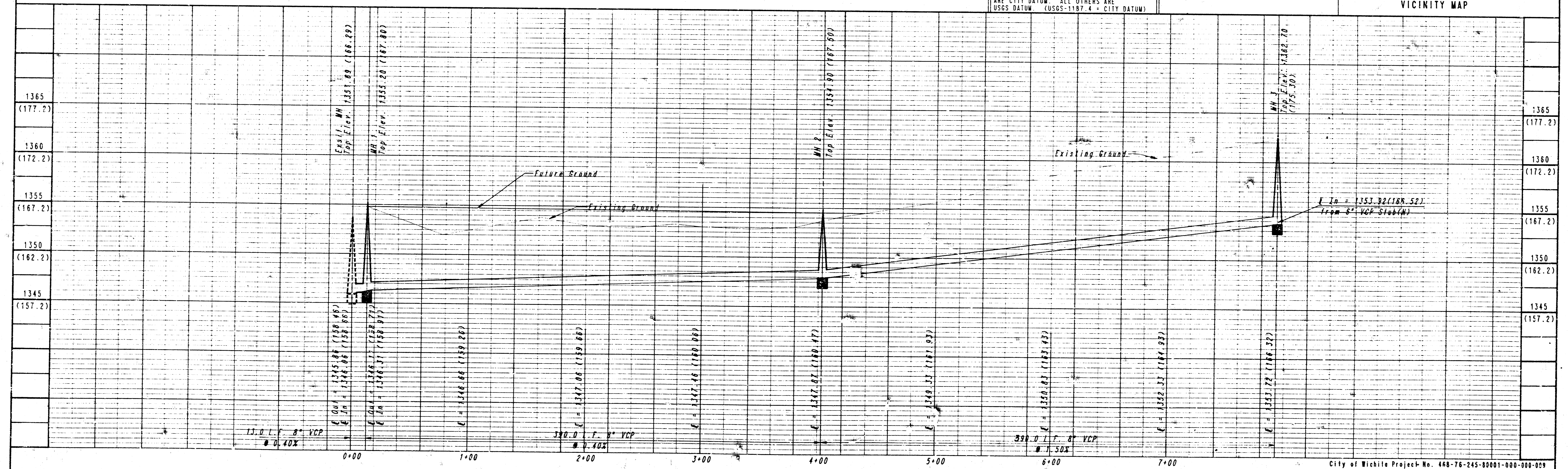

DATE	NATURE OF REVISION	BY	CK'D	APPR.



BEECH AIRCRAFT CORP.  
 PLANT ENGINEERING DEPARTMENT  
**BEECH RADAR TEST FACILITIES**  
 DESIGNED BY: J.S.  
 DRAWN BY: J.S.  
 CHECKED: \_\_\_\_\_  
 APPROVED: \_\_\_\_\_  
 No. \_\_\_\_\_

DO NOT TRIM THIS BORDER IF PRINTS ARE TO BE BOUND

14 8 5 5