

DATE: _____ BY: _____
 PLAN SHEET NO. _____
 SHEET NO. _____
 PROJECT NO. _____

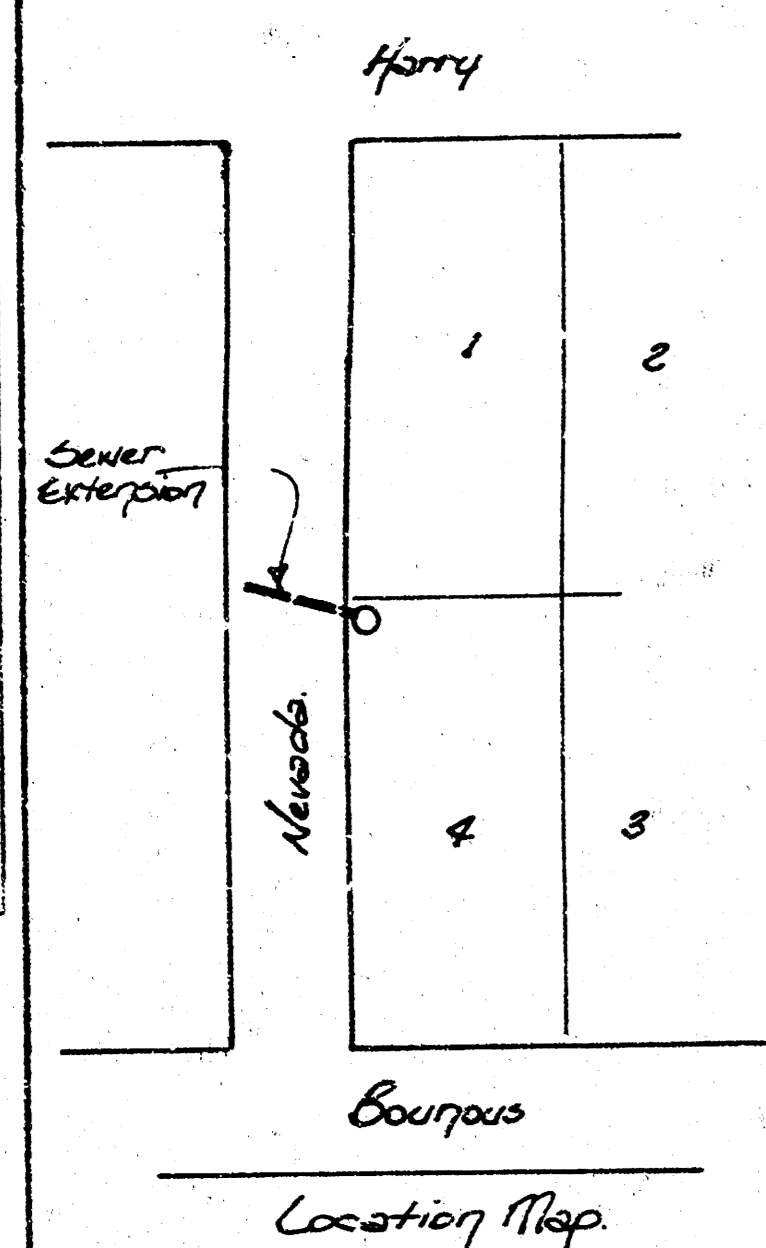

BT 112 RR S&W LP NE Corner of Nevada & Bourne.

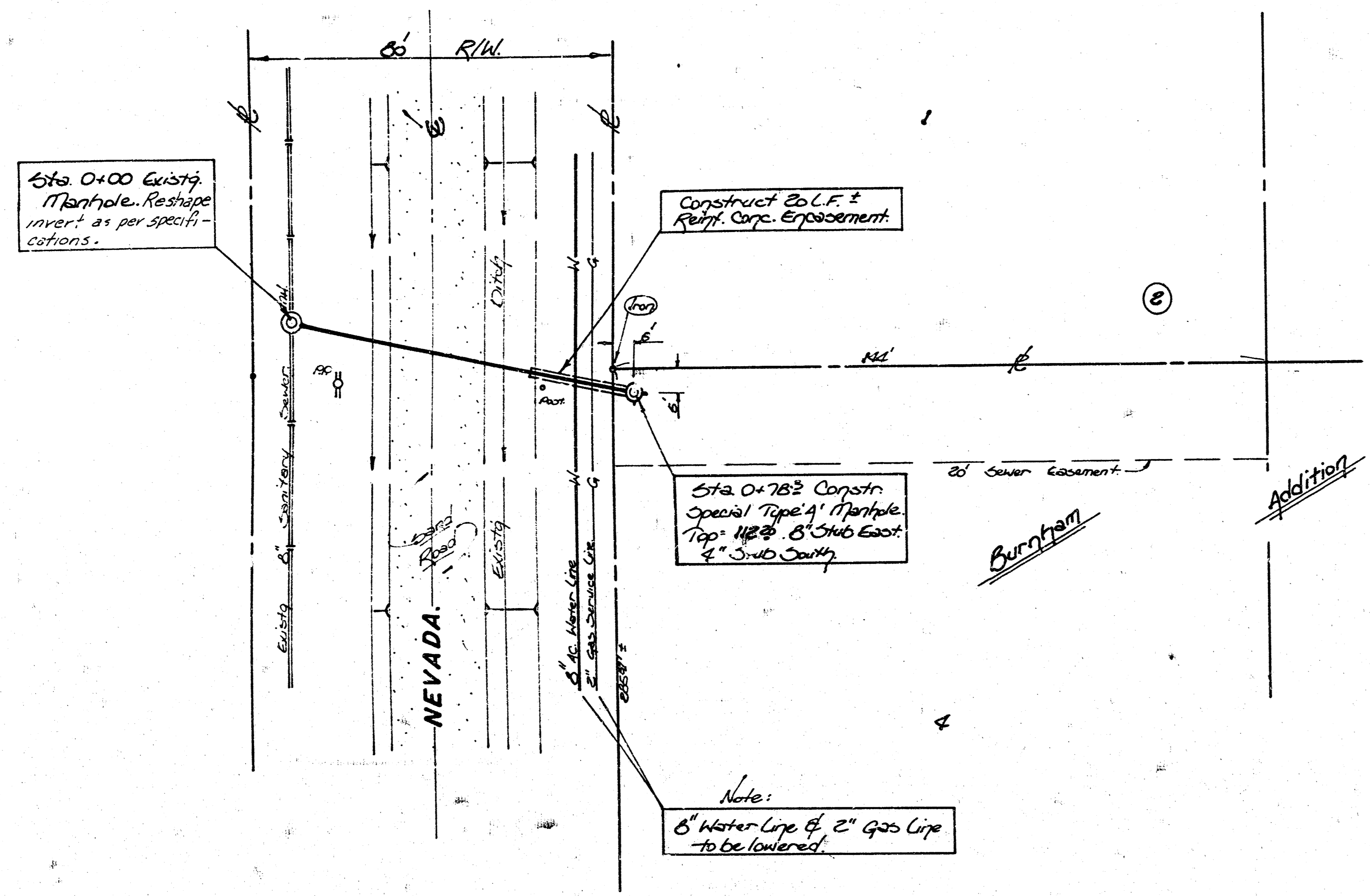

Sta. 0+00 Existing Manhole. Reshape invert as per specifications.

Construct 20' L.F. ± Reinf. Conc. Encasement

Sta. 0+75.3 Construct Special Type 'A' Manhole Top: 1#2@ 8" Stub East, 4" Stub South

Note: 8" Water Line & 2" Gas Line to be lowered

NOTE TO CONTRACTOR
 This project will be constructed under the supervision of the CITY ENGINEER and conforming to the SPECIFICATIONS of the CITY OF WICHITA. The CONTRACTOR will prepay the City of Wichita for all costs of inspection.

THE CONTRACTOR SHALL BE RESPONSIBLE FOR PRESERVING PROPERTY IRONS. THE CONTRACTOR SHALL BE REQUIRED TO RE-ESTABLISH ANY PROPERTY IRONS WHICH ARE DAMAGED OR DESTROYED BY HIS CONSTRUCTION OPERATIONS. SUCH IRONS SHALL BE RE-ESTABLISHED BY A LICENSED LAND SURVEYOR OR A LICENSED PROFESSIONAL ENGINEER IN ACCORDANCE WITH STATE LAWS.

APPROVED AS NOTED
 By CITY ENGINEER OF WICHITA
 Sanitary Sewers: _____
 Storm Sewers: _____
 Driveway Approaches: _____

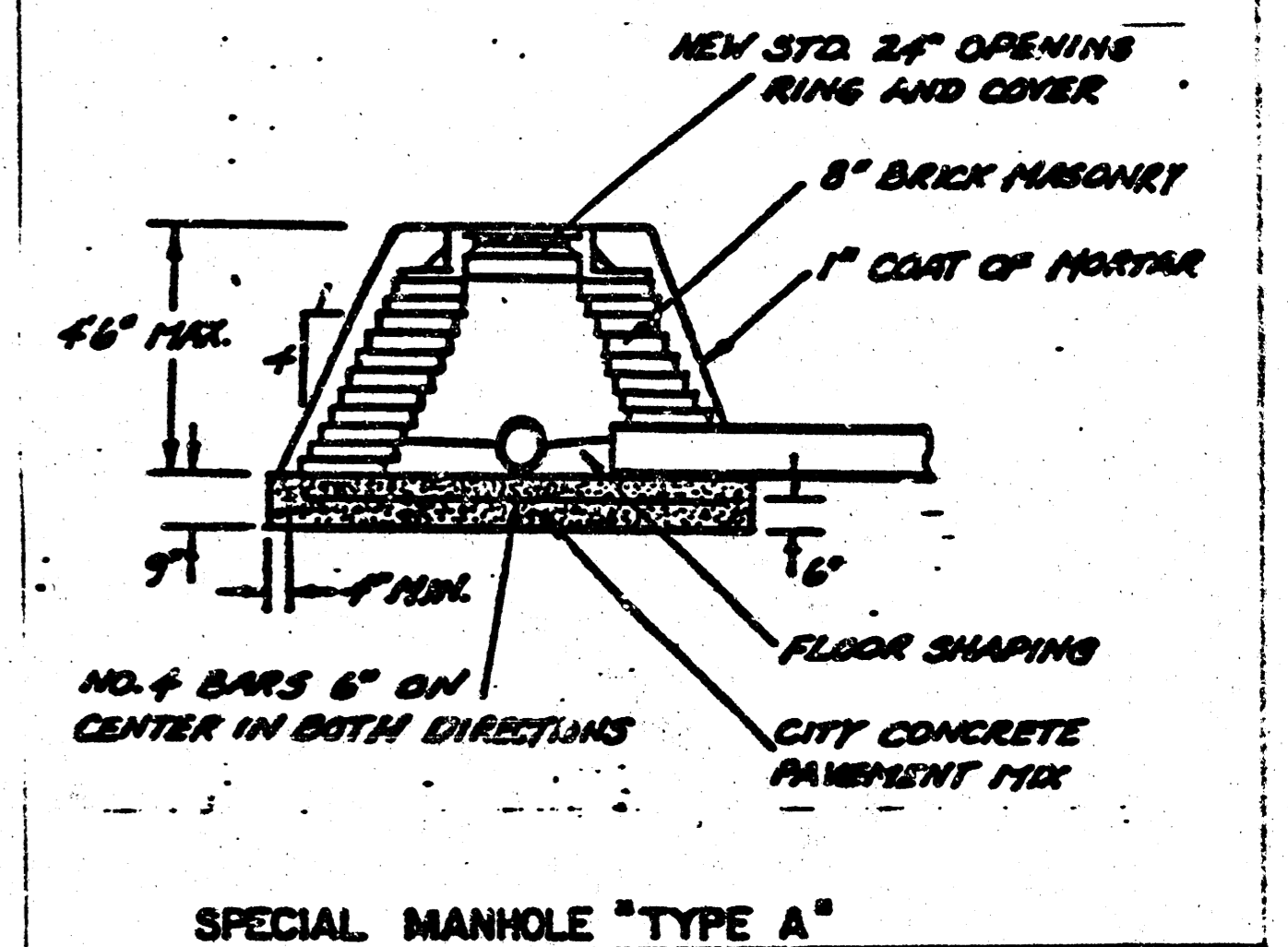
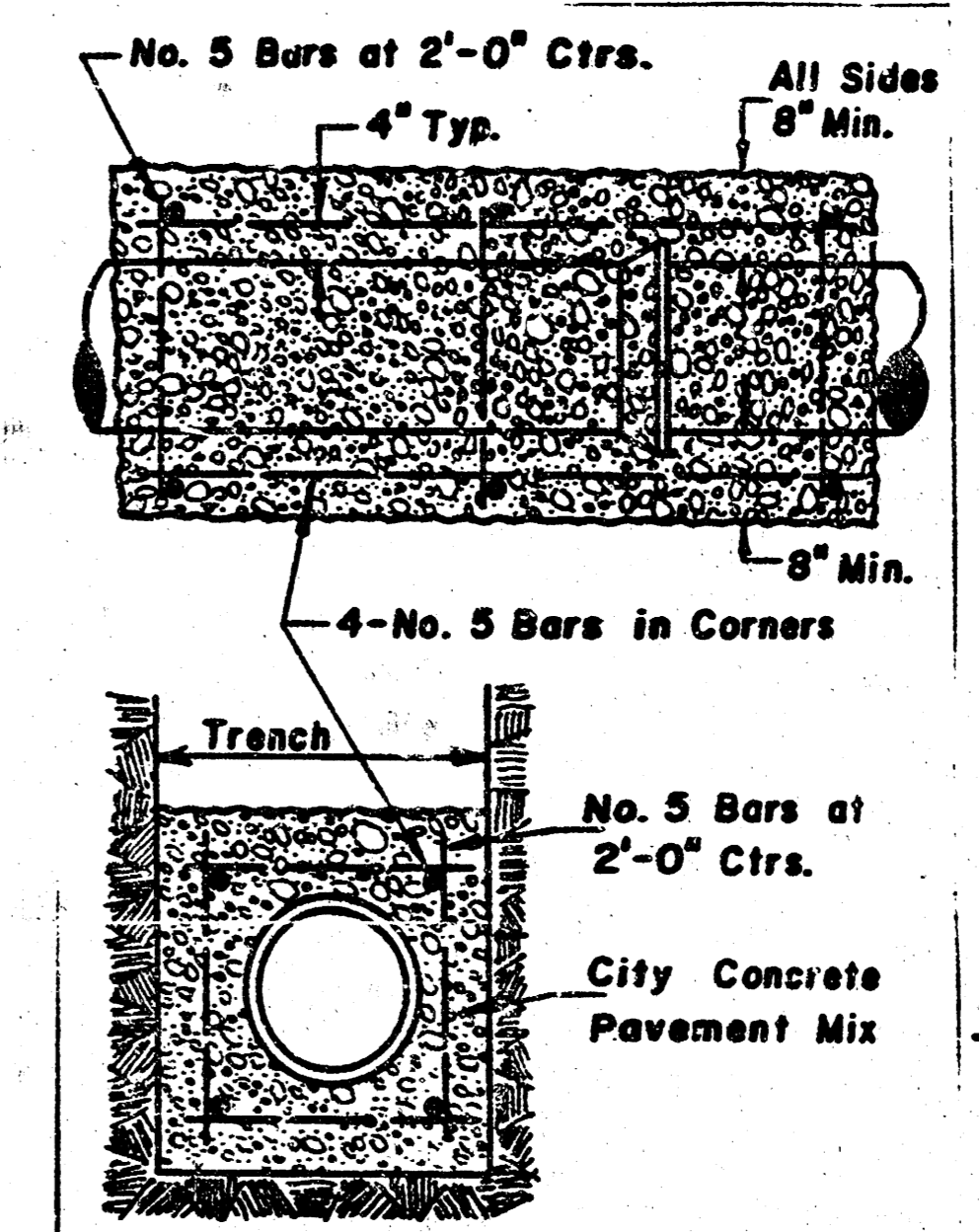
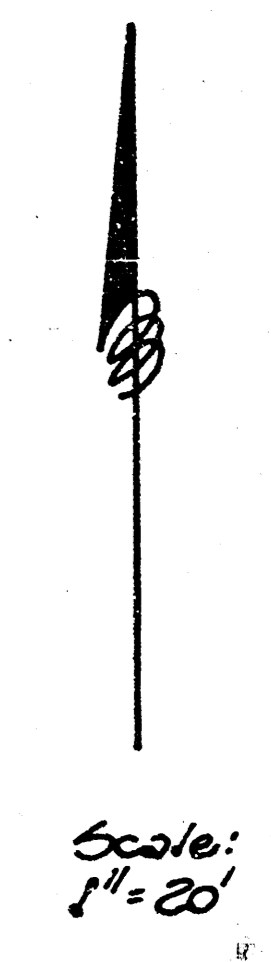

DATE: _____ BY: _____
 PROFILE SHEET NO. _____
 SHEET NO. _____
 PROJECT NO. _____

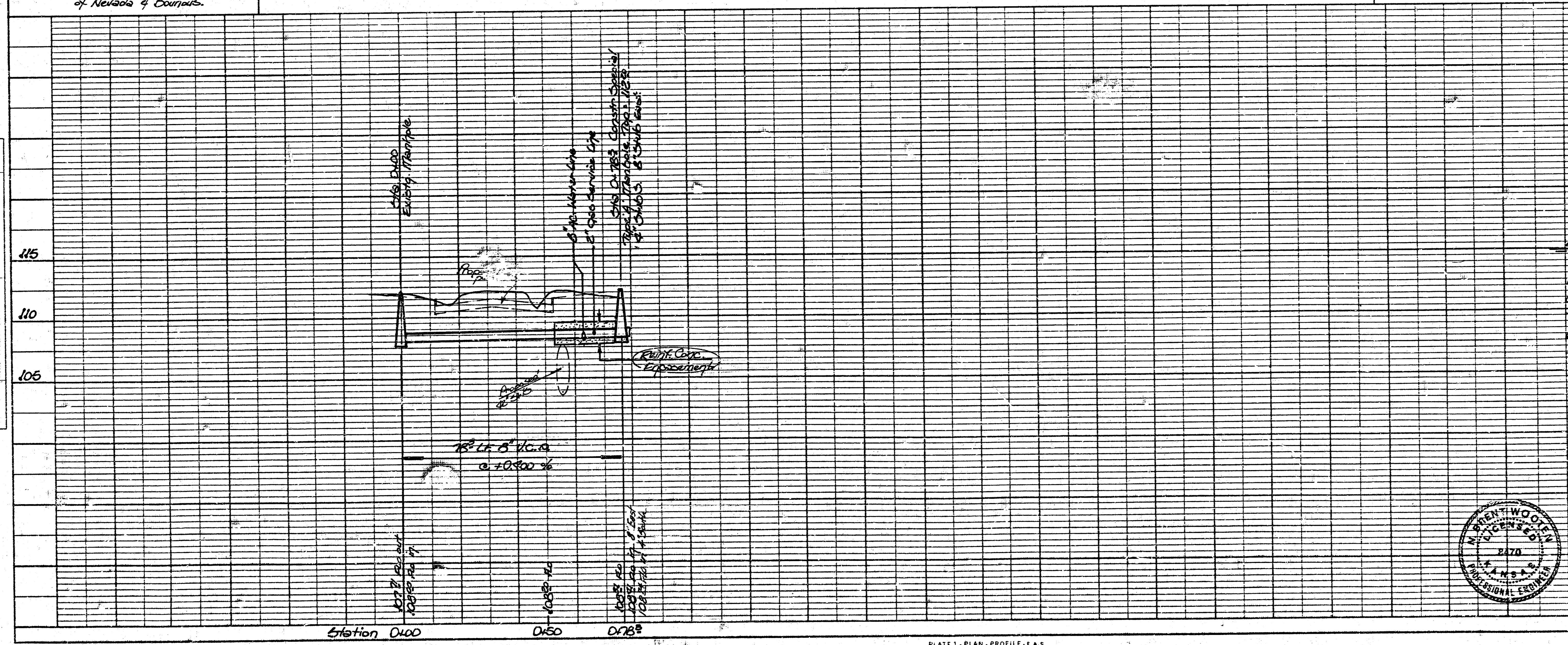

Note: Contractor to contact Benny Gaspard, Dist. 11 Clerk in City Water Dept. for lowering of 8" water line. Contractor to contact Chris O'Leary in Gas Service Co. for lowering of 2" gas line. 8" R.C.C. to be installed on this project. 8" Reinforced Concrete Encasement to be constructed 10' L.F. in each direction from the water line crossing. See details for both the encasement and the manhole.

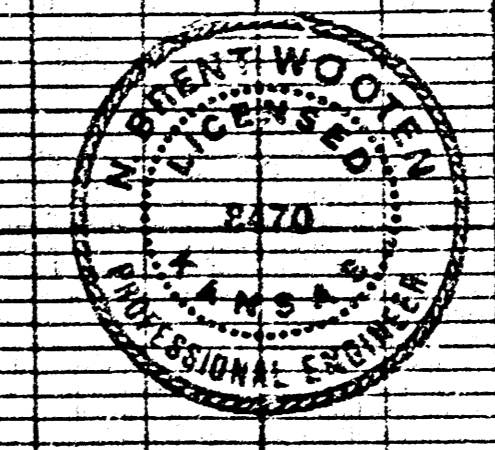

PRIVATE SANITARY SEWER EXTENSION TO SERVE LOT 4, BLK 2, BURNHAM IND. ADDN.
 CITY OF WICHITA, KS.
 PROJ. NO. 468-76-245-80000-000-000-008
BAUGHMAN COMPANY, P.A.
 SURVEYING & ENGINEERING
 314/245-7271 • 28 LAURA • WICHITA, KANSAS 67211