

PLAN
 SHOWING
 ALIGNED CHASE
 BY CITY ENGINEER

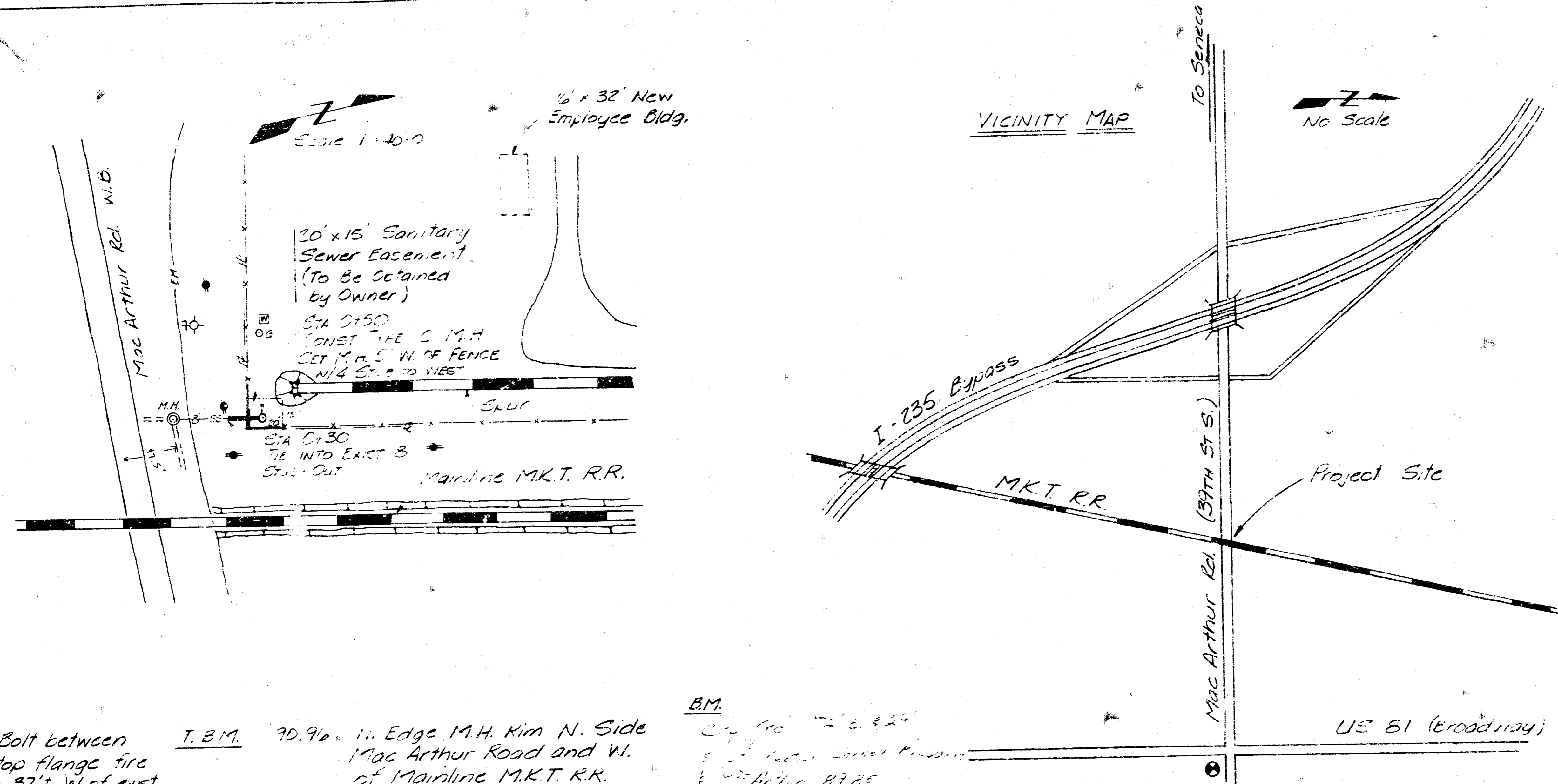

T.B.M. 92.62 Bolt between
 E & L" top flange fire
 hydrant 37' W of exist.
 M.H. & N. side MacArthur

T.B.M. 90.96 in Edge M.H. Rim N. Side
 MacArthur Road and W.
 of Mainline M.K.T. R.R.
 (Assumed)

B.M.
 87.85

PROFILE
 SHOWING
 ALIGNED CHASE
 BY CITY ENGINEER

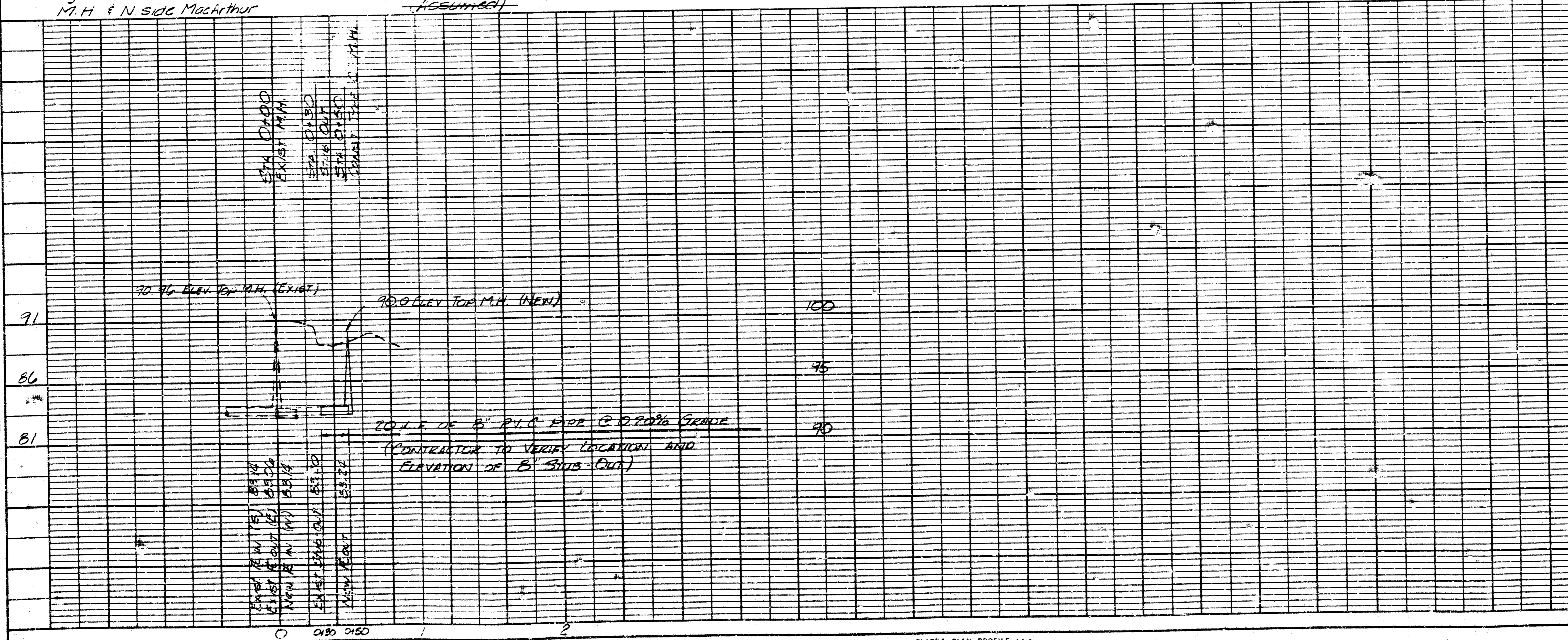

APPROVED AS NOTED
 BY CITY ENGINEER OF WICHITA
 SANITARY SEWER
 SEWER APPROXIMATIONS

NOT TO SCALE
 THIS PROJECT
 THE CITY OF WICHITA
 TRUCKS WILL BE
 FOR ALL TYPES OF TRUCKS

REVIS 000 3/10/80 ADD 12" x 500' SANITARY SEWER
 REVIS 000 3/10/80 ADD CITY OF WICHITA RECORD DRAWING

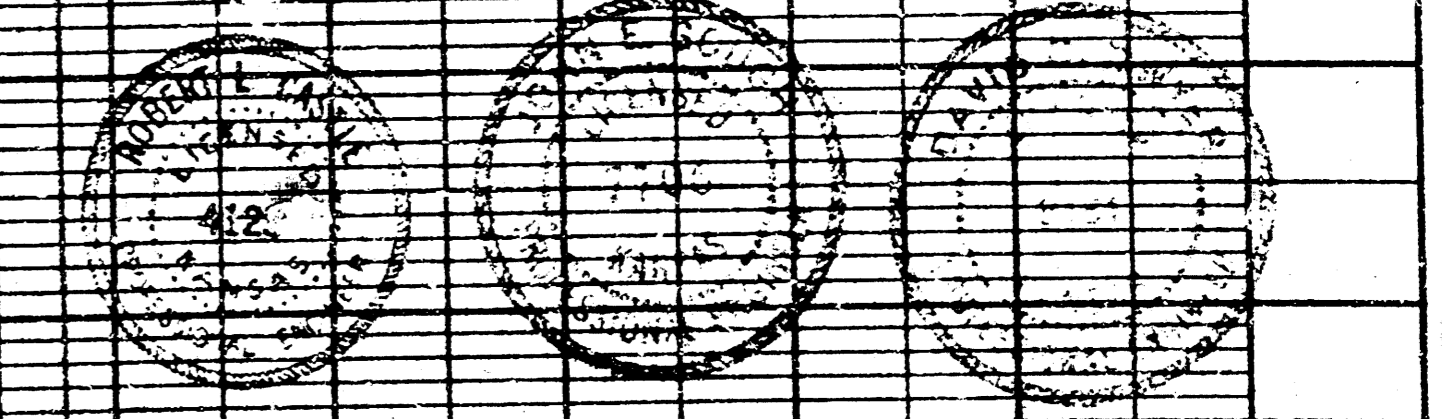

WICHITA, KANSAS
 SANITARY SEWER EXTENSIONS
 PLAN AND PROFILE
 DALLAS NEAR ROBBINS PLANT
 PROJ. NO. 465 WICHITA 8850-000-000-000
 GAMBRELL & CASTLE
 ENGINEERS
 WICHITA, KANSAS
 DATE: SEPTEMBER 1984
 SHEET NO. 1 OF 1