

BENCH MARK: Square Cut in Curb, East End of Drive to House # 1403, Selma Street. Elevation: 87.11

Station 0+52.2 Excavate Existing 8" Sanitary Sewer, Clean and Connect to the Nearest Joint.

CAUTION! U.G. Bell Cable. Use Extreme Caution in This Area.

Remove and Replace Existing Cedar Fence As Necessary For Sewer Construction.

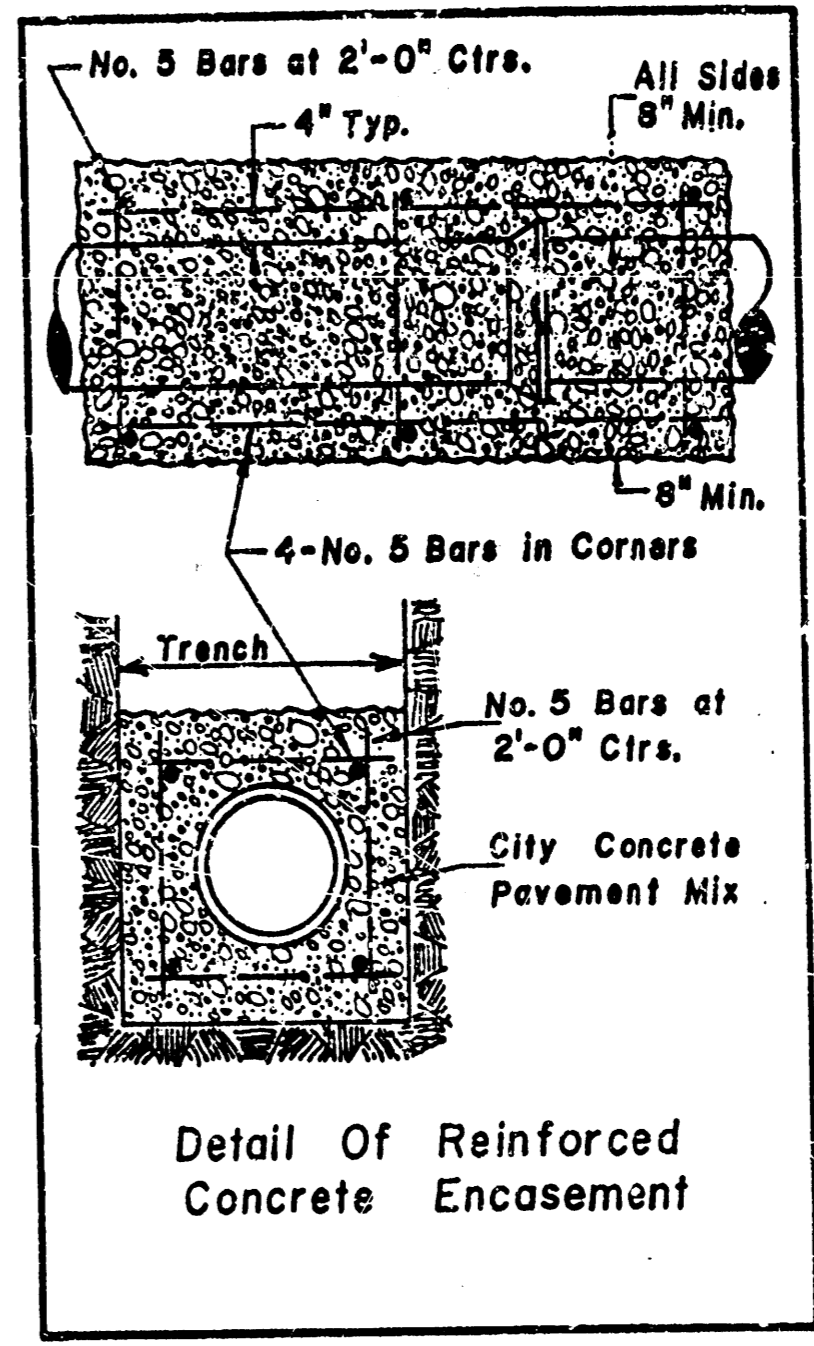
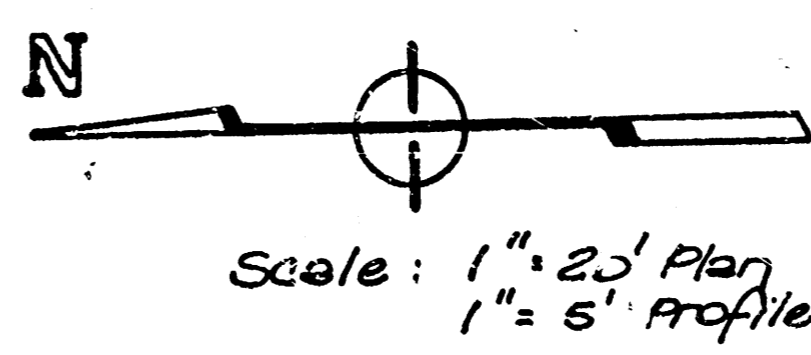

**GENERAL NOTES**

- Underground utility service lines and overhead utility pole lines are to be adjusted as necessary by others prior to construction unless the plans specifically call for their adjustment by the contractor or unless the plans specifically identify a utility to be adjusted by its owner during construction. Existing utilities and their location, as shown on the plans, represent the best information obtainable for design. The contractor will be required to work around existing utilities within the right-of-way which do not conflict with proposed construction.
- The Contractor shall give all property owners and/or tenants of developed property abutting the construction of this project a minimum of two (2) days advance notice prior to start of construction.
- The Contractor shall be responsible for maintaining continuous flow of sewage through construction. Contractor's proposed method for maintaining sewage flow shall be approved by the Engineer. Cost of maintaining flow of sewage through construction will not be paid for directly and this cost shall be considered as subsidiary to the other pay items of work.
- The Contractor shall be responsible for preserving property irons. The Contractor will be required to re-establish any property irons which are damaged or destroyed by his construction operations. Such irons shall be re-established by a licensed land surveyor in accordance with state laws.

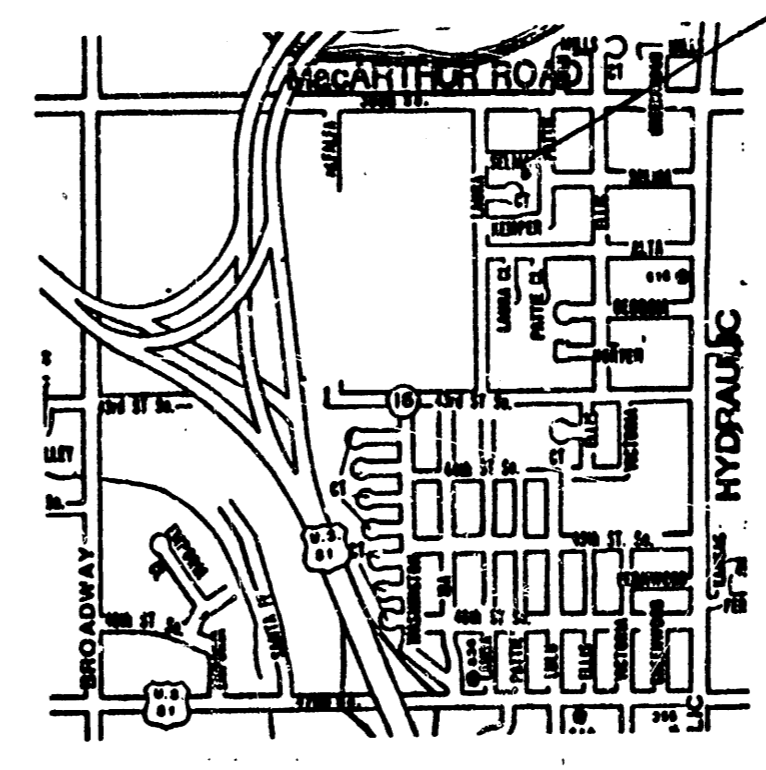
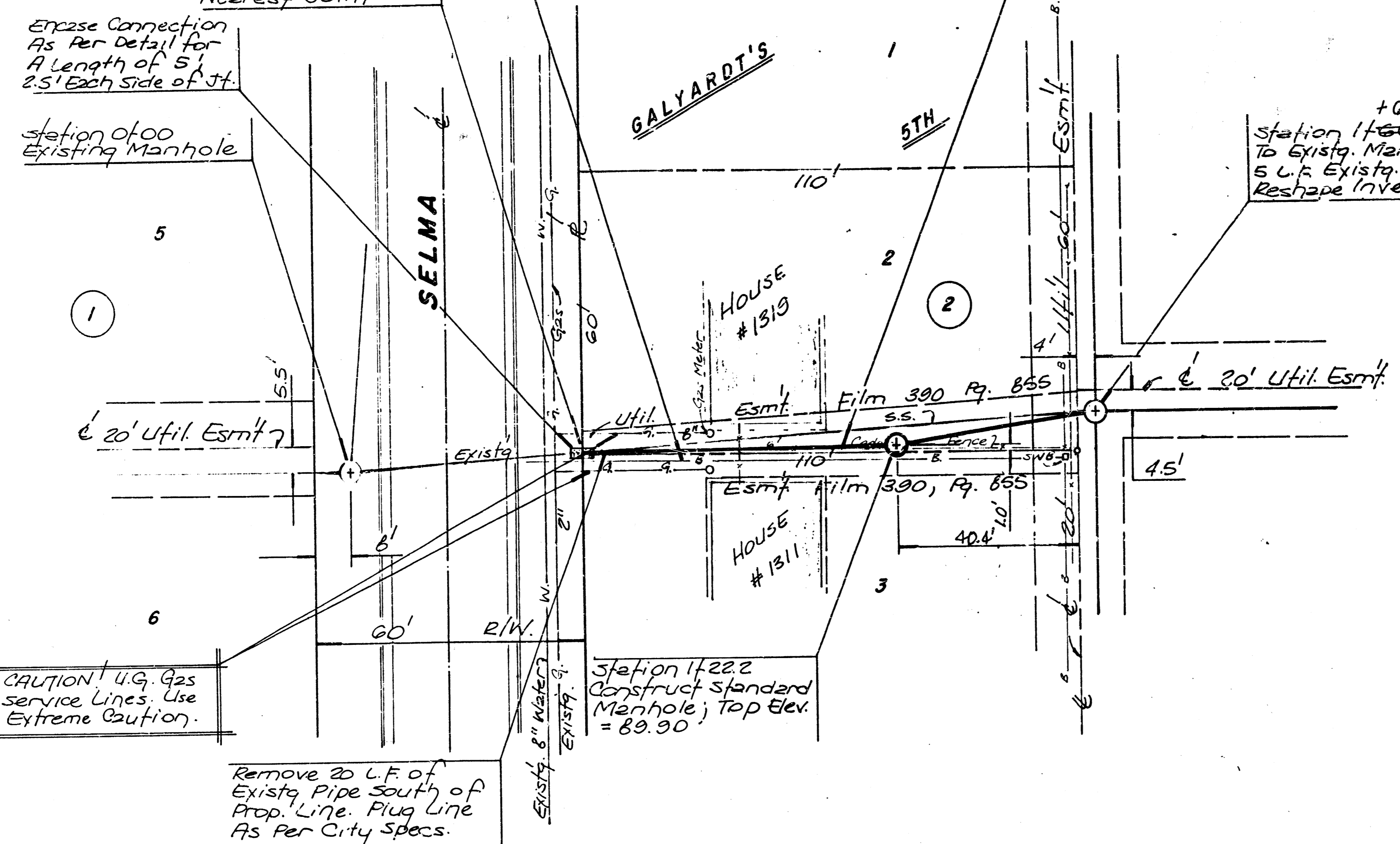

PROJECT SITE

APPROVED AS NOTED  
By CITY ENGINEER OF WICHITA  
Sanitary Sewers 9/25 11/14/88  
Storm Sewers \_\_\_\_\_  
Driveway Approaches \_\_\_\_\_  
Water Mains \_\_\_\_\_  
Paving \_\_\_\_\_

**NOTE TO CONTRACTOR**  
INSPECTION AND TESTING FOR THIS PROJECT IS TO BE PROVIDED BY A LICENSED CONSULTING ENGINEERING FIRM UNDER CONTRACT WITH THE OWNER/DEVELOPER. SAID INSPECTION TO BE IN ACCORDANCE WITH THE CITY OF WICHITA STAMPED CONSTRUCTION INSPECTION REPORT AND CERTIFIED BY A LICENSED PROFESSIONAL ENGINEER. THIS WORK SHALL BE PERFORMED IN ACCORDANCE WITH THE PUBLIC UTILITIES CODE, K.S.A. 48-1001 THROUGH 48-1009. THE CONTRACTOR SHALL BE RESPONSIBLE FOR OBTAINING ALL NECESSARY PERMITS FROM THE CITY OF WICHITA.

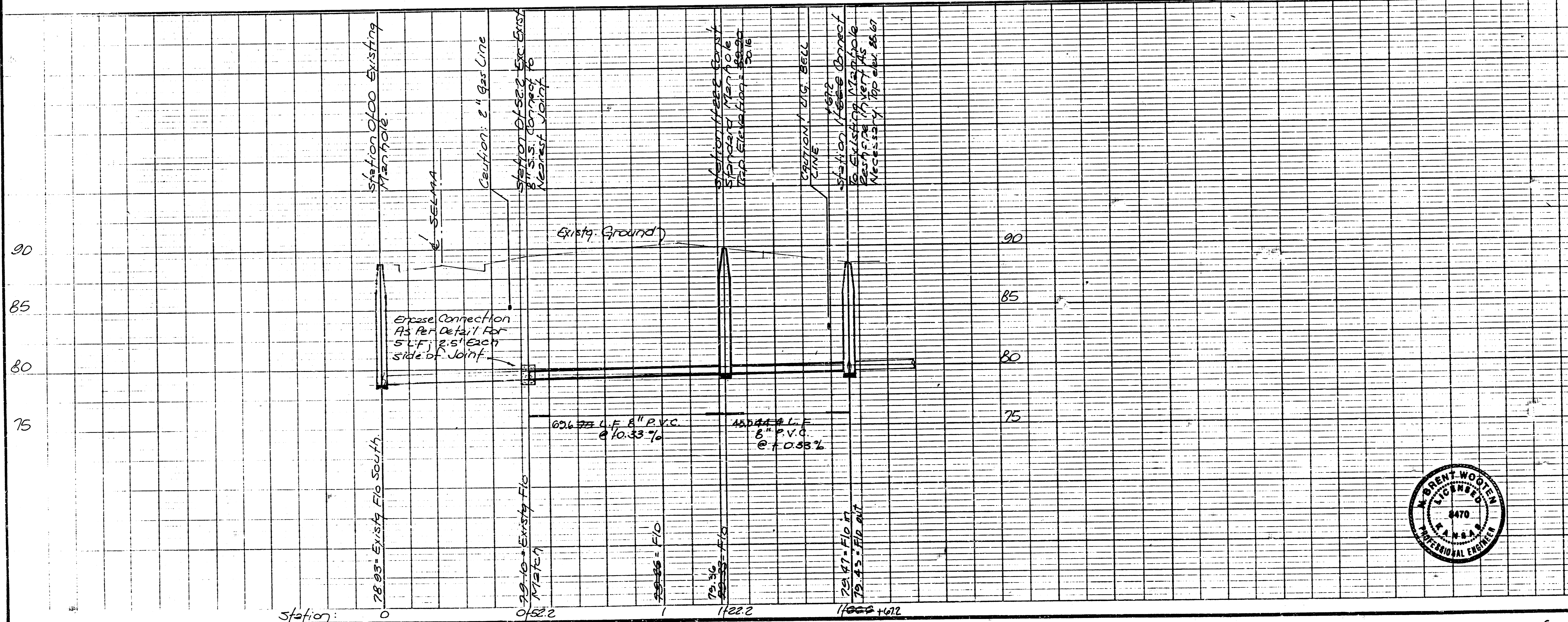

Rev. As-Built 3-23-89 JCR

PRIVATE SANITARY SEWER RELOCATION TO SERVE  
LOT 2, BLOCK 2, GALYARDT'S 5TH ADDITION  
PROJECT NO.  
488-76-245-80000-000-000-187  
CITY OF WICHITA, KS.

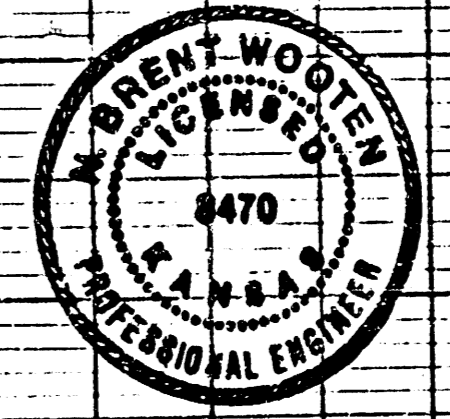

BAUGHMAN COMPANY, P.A.  
SURVEYING & ENGINEERING  
310282-7271 • 315 ELLIS • WICHITA, KANSAS 67211  
Drawn: NBW CB NBW Date: 11/13/88 Scale: Noted

FILMED FROM THE BEST AVAILABLE COPY