

# CITY OF WICHITA, KANSAS

## SANITARY SEWER IMPROVEMENTS TO SERVE PUBLIC SAFETY FACILITY IN HERMAN HILL PARK

**INDEX:**

|       |   |                    |
|-------|---|--------------------|
| SHEET | 1 | TITLE SHEET        |
| SHEET | 2 | PLAN-PROFILE SHEET |

**GENERAL NOTES:**

- UTILITY SERVICE LINES, POLES, VALVE BOXES, METERS AND ETCETERA ARE TO BE ADJUSTED AS NECESSARY BY OTHERS PRIOR TO CONSTRUCTION UNLESS THE PLANS SPECIFICALLY CALL FOR THEIR ADJUSTMENT BY THE CONTRACTOR OR UNLESS THE PLANS SPECIFICALLY IDENTIFY A UTILITY TO BE ADJUSTED BY ITS OWNER DURING CONSTRUCTION. EXISTING UTILITIES AND THEIR LOCATION AS SHOWN ON THE PLANS REPRESENT THE BEST INFORMATION OBTAINABLE FOR DESIGN. THE CONTRACTOR WILL BE REQUIRED TO WORK AROUND EXISTING UTILITIES WITHIN THE RIGHT-OF-WAY WHICH DO NOT CONFLICT WITH PROPOSED CONSTRUCTION.
- THE CONTRACTOR SHALL PROVIDE A MINIMUM OF FORTY-EIGHT (48) HOURS ADVANCE NOTICE TO ALL UTILITY OWNERS PRIOR TO WORK IN ANY AREA WHERE EXISTING UTILITIES WILL BE UNCOVERED TO ALLOW THE UTILITY OWNER TO INSPECT THE UNCOVERING OF THEIR UTILITY. ANY UTILITY CARELESSLY DAMAGED BY HIS CONSTRUCTION OPERATION SHALL BE REPAIRED OR REPLACED AT NO EXTRA COST TO THE CITY. THE CONTRACTOR SHALL COORDINATE WITH CONTRACTORS FOR UTILITY COMPANIES AND OTHER AGENCIES FOR MINIMUM INCONVENIENCE TO GENERAL PUBLIC.
- CONTRACTOR SHALL AVOID UNCOVERING THE EXISTING WATERLINES UNLESS ABSOLUTELY NECESSARY. UNCOVERING SHALL BE DONE ONLY IN THE PRESENCE OF A WATER DEPARTMENT ENGINEER.
- THE CONTRACTOR SHALL COORDINATE THE RELOCATION, TIE-BACK, PROTECTION OF POWER POLES, LIGHT POLES AND APPURTENANCES WITH KGE. TWO WEEKS NOTICE TO KGE IS REQUIRED.
- ALL ADJACENT BUILDINGS, STRUCTURES, PARKING LOTS, DRIVES, STREET PAVEMENTS, UTILITY LINES, UTILITY STRUCTURES AND APPURTENANCES OTHER THAN SHOWN FOR REPLACEMENT SHALL BE PROTECTED FROM DAMAGE DURING CONSTRUCTION OF THE PROJECT. ITEMS DAMAGED BEYOND THE LIMITS SHOWN SHOWN ON THE DRAWINGS SHALL BE REMOVED AND REPLACED BY THE CONTRACTOR AT NO ADDITIONAL COST TO THE OWNER.
- CONTRACTOR SHALL VERIFY GROUND WATER CONDITIONS BEFORE SUBMITTING HIS BID. DEWATERING AS REQUIRED TO ACCOMPLISH CONSTRUCTION WILL BE AT CONTRACTOR'S EXPENSE.
- A SAW CUT OF AT LEAST ONE-HALF THE DEPTH OF EXISTING SURFACE COURSES OR ONE-FOURTH THE DEPTH OF THE EXISTING TOTAL PAVEMENT THICKNESS SHALL BE PROVIDED AT LOCATIONS WHERE PROPOSED CONSTRUCTION ADJUTS AN EXISTING SURFACE COURSE OR PAVEMENT FOR WHICH PARTIAL REMOVAL OF THAT SURFACE OR PAVEMENT IS REQUIRED. SAWED JOINTS TO FACILITATE REMOVAL WITHIN THREE (3) FEET OF EXISTING JOINT WILL NOT BE PERMITTED AND FOR SUCH INSTANCES THE LIMITS OF REMOVAL SHALL EXTEND TO EXISTING JOINT. SUCH SAW CUTS WILL NOT BE PAID FOR DIRECTLY AND THIS COST SHALL BE CONSIDERED SUBSIDIARY TO THE REMOVAL OF THE SURFACE OR PAVEMENT.
- MISCELLANEOUS STRUCTURES AND EXCAVATION WHICH IS TO BE WASTED SHALL BE DISPOSED OF ON SITES TO BE PROVIDED BY THE CONTRACTOR. THESE SITES SHALL BE APPROVED BY THE ENGINEER AS TO SUITABILITY, APPEARANCE AND SITE LOCATION. LOCATIONS THAT, IN THE OPINION OF THE ENGINEER LEAVE AN UNSIGHTLY APPEARANCE WILL NOT BE APPROVED.

- ALL DISPOSAL SITES MUST BE APPROVED BY THE KANSAS DEPARTMENT OF HEALTH AND ENVIRONMENT. MATERIAL EITHER STOCKPILED OR DISPOSED OF IN A FLOOD PLAIN WOULD REQUIRE A KANSAS STATE BOARD OF AGRICULTURE PERMIT. ANY MATERIAL DUMPED IN WATERS OF THE UNITED STATES OR WETLANDS IS SUBJECT TO U.S. CORPS OF ENGINEERS PERMITTING REGULATIONS. ANY MATERIAL BURIED OR STOCKPILED BEYOND APPROVED CONSTRUCTION LIMITS WOULD REQUIRE ADDITIONAL ARCHIEOLOGICAL INVESTIGATIONS UNLESS BURIED IN A PREVIOUSLY APPROVED BORROW LOCATION.
- TREES AND SHRUBS IN PUBLIC RIGHT-OF-WAY WHICH ARE IN STRICT CONFLICT WITH PROPOSED NEW CONSTRUCTION SHALL BE REMOVED BY THE CONTRACTOR WITH ENGINEER'S APPROVAL. TREES AND SHRUBS WHICH ARE NOT IN DIRECT CONFLICT WITH PROPOSED NEW CONSTRUCTION SHALL BE SAVED AND PROTECTED FROM DAMAGE.
  - THE CONTRACTOR SHALL BE RESPONSIBLE FOR PRESERVING PROPERTY IRONS SHOWN ON THE PLANS. THE CONTRACTOR WILL BE REQUIRED TO RE-ESTABLISH ANY SHOWN PROPERTY IRONS WHICH ARE DAMAGED OR DESTROYED BY HIS CONSTRUCTION OPERATIONS. SUCH IRONS SHALL BE RE-ESTABLISHED BY A LICENSED LAND SURVEYOR IN ACCORDANCE WITH STATE LAW. THIS WORK SHALL BE SUBSIDIARY TO OTHER ITEMS IN CONTRACT.
  - ALL SALVAGEABLE DRAINAGE PIPES, HURDLE RINGS AND COVERS AND INLET GRATES SHALL BE CAREFULLY REMOVED AND STOCKPILED AT LOCATIONS WITHIN THE RIGHT-OF-WAY, AS DIRECTED BY THE ENGINEER FOR REMOVAL BY CITY PERSONNEL.
  - THE CONTRACTOR WILL BE REQUIRED TO PROVIDE A MINIMUM ADVANCE NOTICE OF FORTY-EIGHT (48) HOURS TO EACH OF THE FOLLOWING UTILITIES PRIOR TO THE BEGINNING OF CONSTRUCTION AND REQUEST THAT ANY EXISTING LINES BE FLAGGED:
- |   |   |
|---|---|
| ARKLA GAS CO.<br>1630 S. BACHR<br>WICHITA, KANSAS 67209<br>JERRY WATKINS<br>316-948-8350  | SOUTHWESTERN BELL TELEPHONE CO.<br>154 N. BROADWAY<br>WICHITA, KANSAS 67202<br>GREG SHARP<br>316-268-2245   |
| KANSAS GAS & ELECTRIC CO.<br>801 E. 8th<br>WICHITA, KANSAS 67201<br>DON MORGAN<br>316-261-6285                                    | WICHITA SEWER MAINTENANCE DIVISION<br>WATER & WASTE POLLUTION CONTROL DEPT.<br>8TH FLOOR-CITY HALL<br>455 N. MAIN STREET<br>WICHITA, KANSAS 67202<br>SUSAN TURNER<br>316-268-4210 |
| WICHITA WATER DEPARTMENT<br>8TH FLOOR - CITY HALL<br>455 N. MAIN STREET<br>WICHITA, KANSAS 67202<br>CHUCK STEVENS<br>316-268-4552 | MULTIMEDIA CABLEVISION<br>701 EAST DOUGLAS<br>WICHITA, KANSAS 67202<br>DON SHUE<br>252-4670   |
| KANSAS ONE CALL<br>1-800-344-4210   | DIG SAFE<br>687-2470  |

13. CONTRACTOR SHALL MAINTAIN TRAFFIC ON PANNEE AT ALL TIMES DURING CONSTRUCTION IN ACCORDANCE WITH CITY OF WICHITA REQUIREMENTS.

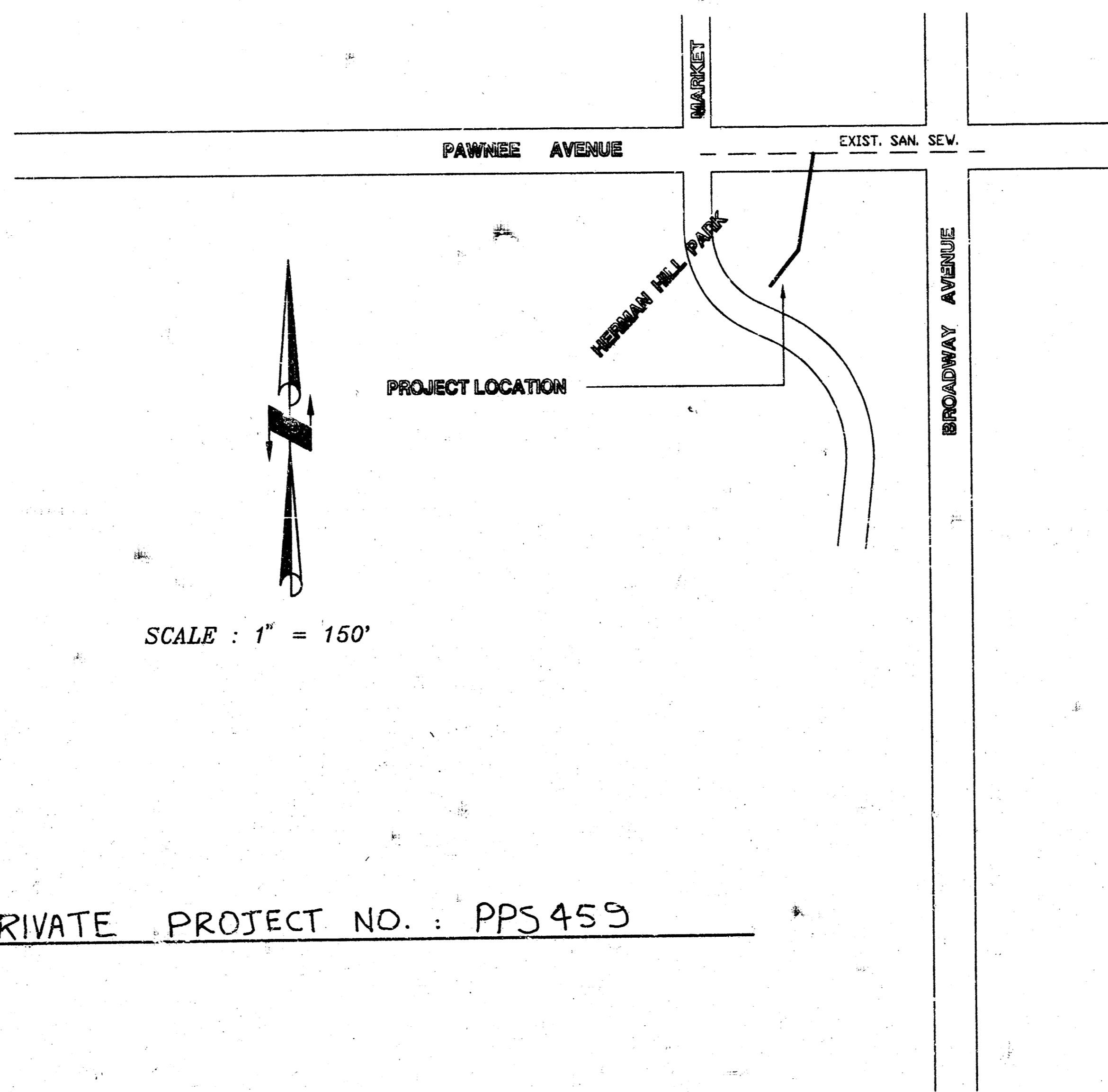

PRIVATE PROJECT NO. : PPS 459

**LOCATION MAP**

**MICHAEL E. LINDEBAK, P.E., CITY ENGINEER**

ALL WORK SHALL BE COMPLETED IN ACCORDANCE WITH CITY OF WICHITA, KANSAS STANDARD SPECIFICATIONS

APPROVED AS NOTED  
By CITY ENGINEER OF WICHITA  
Sanitary Sewers AKB 4/25/94  
Storm Sewers \_\_\_\_\_  
Driveway Approaches \_\_\_\_\_  
Water Mains \_\_\_\_\_

**NOTE TO CONTRACTOR**  
INSPECTION AND TESTING FOR THIS PROJECT IS TO BE PROVIDED BY A LICENSED CONSULTING ENGINEERING FIRM UNDER CONTRACT TO THE OWNER/DEVELOPER. SAID INSPECTION TO BE IN ACCORDANCE WITH THE CITY OF WICHITA STANDARD SPECIFICATIONS. ALL INSPECTIONS AND TESTS SHALL BE CONDUCTED IN ACCORDANCE WITH THE PUBLIC RIGHT-OF-WAY AND SHALL BE CONDUCTED IN THE PRESENCE OF THE CITY ENGINEER. ALL ANY WORK BEING CONDUCTED IN DESIGNATED EASEMENTS OR PUBLIC RIGHT-OF-WAY WITHOUT WRITTEN AUTHORIZATION OF THE CITY ENGINEER.

*Booked 1-12-95  
AKB  
From As Boilts*

**BENCH MARKS:**

PROJECT CONTROL:  
TOP OF MANHOLE @ STA. 0+00, ELEV. = 97.17

AS-BUILT 8-29-94

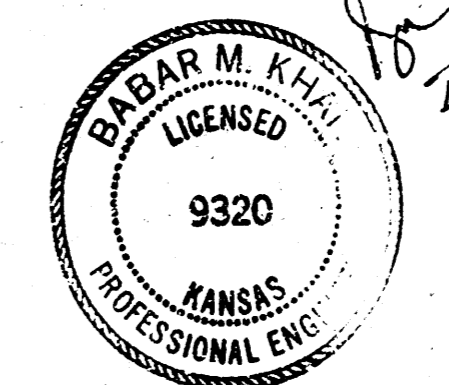

| TITLE SHEET   |           |                  |
|---|-----------|------------------|
| SCALE:  | APPROVED: | DRAWN BY: F.A.   |
| DATE:   |           | CHECKED: B.K.    |
| PROJECT NO.:  |           | SHEET NO. 1 OF 2 |
| <b>MUNICIPAL ENGINEERS</b>                                    |           |                  |
| 254-LAURA, SUITE 201<br>WICHITA, KANSAS 67211<br>316-262-3842 |           |                  |

SCALE:  
 PLAN : 1" = 20'  
 PROFILE : 1" = 20' (H)  
 1" = 5' (V)

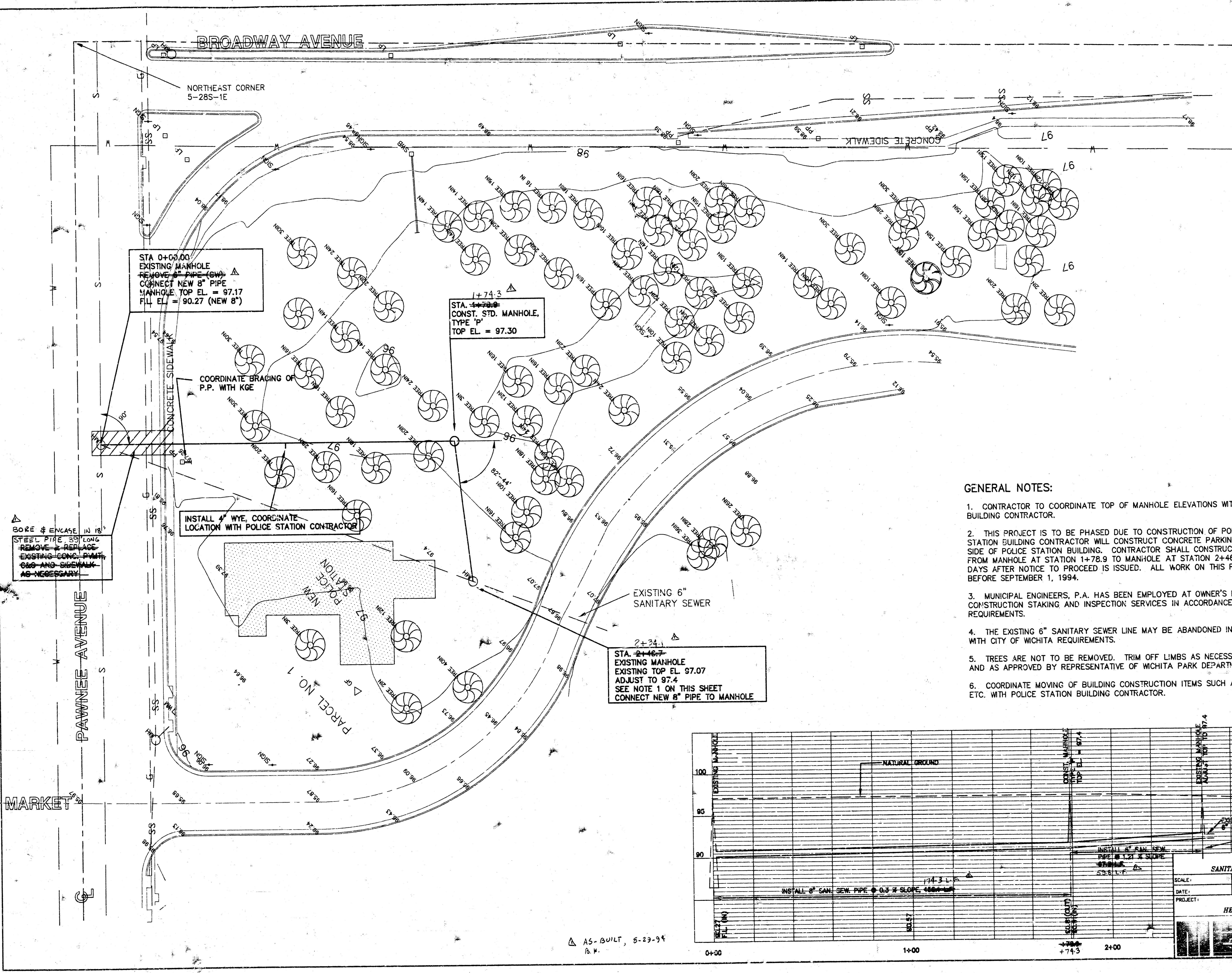

STA 0+00.00  
 EXISTING MANHOLE  
 REMOVE 6" PIPE (G.W.)  
 CONNECT NEW 8" PIPE  
 MANHOLE TOP EL. = 97.17  
 FIL. EL. = 90.27 (NEW 8")

1+74.3  
 STA. 1+74.3  
 CONST. STD. MANHOLE,  
 TYPE "P"  
 TOP EL. = 97.30

INSTALL 4" WYE, COORDINATE  
 LOCATION WITH POLICE STATION CONTRACTOR

2+34.1  
 STA. 2+46.7  
 EXISTING MANHOLE  
 EXISTING TOP EL. 97.07  
 ADJUST TO 97.4  
 SEE NOTE 1 ON THIS SHEET  
 CONNECT NEW 8" PIPE TO MANHOLE

BORE & ENCASE IN 18"  
 STEEL PIPE 20' LONG  
 REMOVE & REPLACE  
 EXISTING CONC. PAVT.  
 6" & SIDEWALK  
 AS NECESSARY

**GENERAL NOTES:**

1. CONTRACTOR TO COORDINATE TOP OF MANHOLE ELEVATIONS WITH POLICE STATION BUILDING CONTRACTOR.
2. THIS PROJECT IS TO BE PHASED DUE TO CONSTRUCTION OF POLICE STATION. POLICE STATION BUILDING CONTRACTOR WILL CONSTRUCT CONCRETE PARKING ALONG THE SOUTH SIDE OF POLICE STATION BUILDING. CONTRACTOR SHALL CONSTRUCT SANITARY SEWER FROM MANHOLE AT STATION 1+78.9 TO MANHOLE AT STATION 2+46.7 WITHIN 15 CALANDER DAYS AFTER NOTICE TO PROCEED IS ISSUED. ALL WORK ON THIS PROJECT IS TO BE COMPLETED BEFORE SEPTEMBER 1, 1994.
3. MUNICIPAL ENGINEERS, P.A. HAS BEEN EMPLOYED AT OWNER'S EXPENSE TO PROVIDE CONSTRUCTION STAKING AND INSPECTION SERVICES IN ACCORDANCE WITH CITY OF WICHITA REQUIREMENTS.
4. THE EXISTING 6" SANITARY SEWER LINE MAY BE ABANDONED IN PLACE IN ACCORDANCE WITH CITY OF WICHITA REQUIREMENTS.
5. TREES ARE NOT TO BE REMOVED. TRIM OFF LIMBS AS NECESSARY FOR CONSTRUCTION AND AS APPROVED BY REPRESENTATIVE OF WICHITA PARK DEPARTMENT.
6. COORDINATE MOVING OF BUILDING CONSTRUCTION ITEMS SUCH AS DIRT PILES, TRAILERS, ETC. WITH POLICE STATION BUILDING CONTRACTOR.

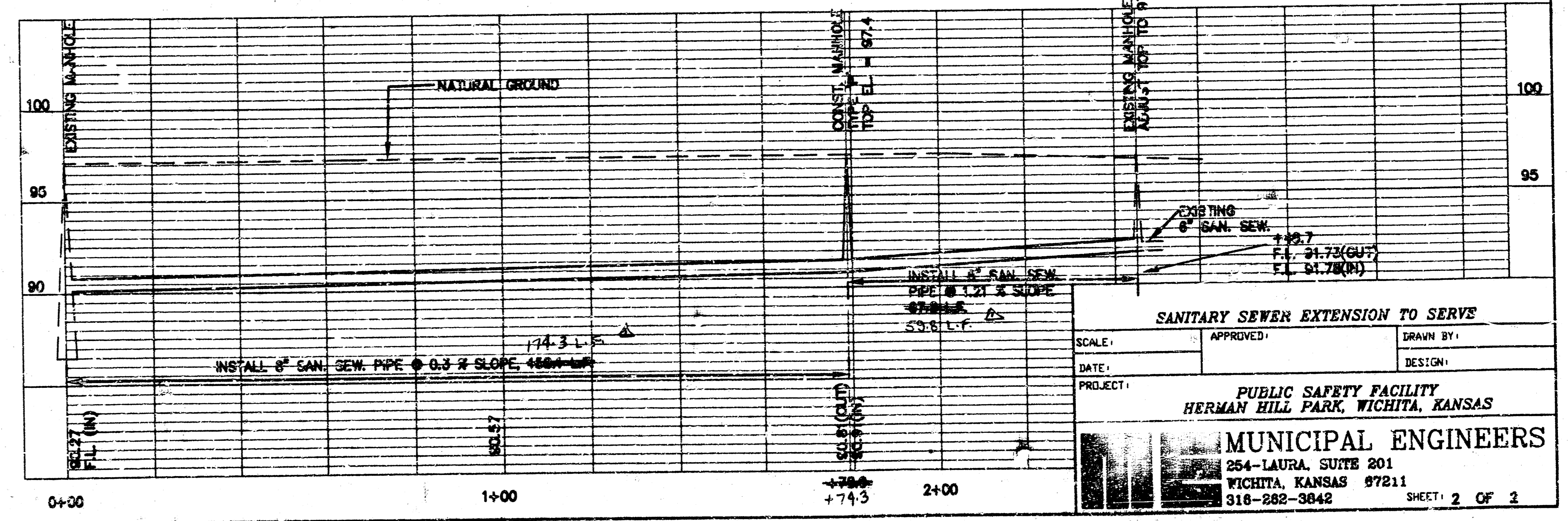

AS-BUILT, 5-29-94  
 P.M.

**SANITARY SEWER EXTENSION TO SERVE**

SCALE: APPROVED: DRAWN BY:  
 DATE: DESIGN:  
 PROJECT: PUBLIC SAFETY FACILITY  
 HERMAN HILL PARK, WICHITA, KANSAS

**MUNICIPAL ENGINEERS**  
 254-LAURA, SUITE 201  
 WICHITA, KANSAS 67211  
 316-282-3842 SHEET 2 OF 2