

PLANS
FOR
SANITARY SEWER SYSTEM
FOR
LAMPLIGHTER MOBILE HOME PARK
PHASE 2
WICHITA, SEDGWICK COUNTY, KANSAS

CITY OF WICHITA PRIVATE PROJECT NO. 468-76-245-80001-000-000-055

1986

Revised AS NOTED
By CITY ENGINEER OF WICHITA
Sanitary Sewers *11.16.86*
Storm Sewers
Driveway Approaches
Water Mains
Paving

NOTE TO CONTRACTOR
This project will be constructed under the supervision of the CITY ENGINEER and conforming to the CITY ORDINANCES of the CITY OF WICHITA. THE CONTRACTOR will pay the City of Wichita for all costs of plan review, inspection and testing on contract.

INDEX OF SHEETS

- SHEET 1 TITLE SHEET
- SHEET 2 LAYOUT MAP
- SHEET 3 UTILITY MAP
- SHEET 4 MAIN 1
- SHEET 5 LATERAL A
- SHEET 6 LATERAL B
- SHEET 7 LATERALS C, C-1, D, B, E
- SHEET 8 LATERALS F, G, H, I, B, J
- SHEET 9 TYPE "A" "B" MANHOLES & CONCRETE ENCASUREMENT
- SHEET 10 SHALLOW MANHOLES, TYPE "A" "B"
- SHEET 11 MANHOLE ADJUSTMENT DETAILS
- SHEET 12 RISER DETAILS
- SHEET 13 MANHOLE DETAIL, TYPE "C"

BM:
RAILROAD SPIKE IN POWER POLE AT THE
SW COR. OF THE PLAT.
ELEV. 85.23
CITY OF WICHITA DATUM

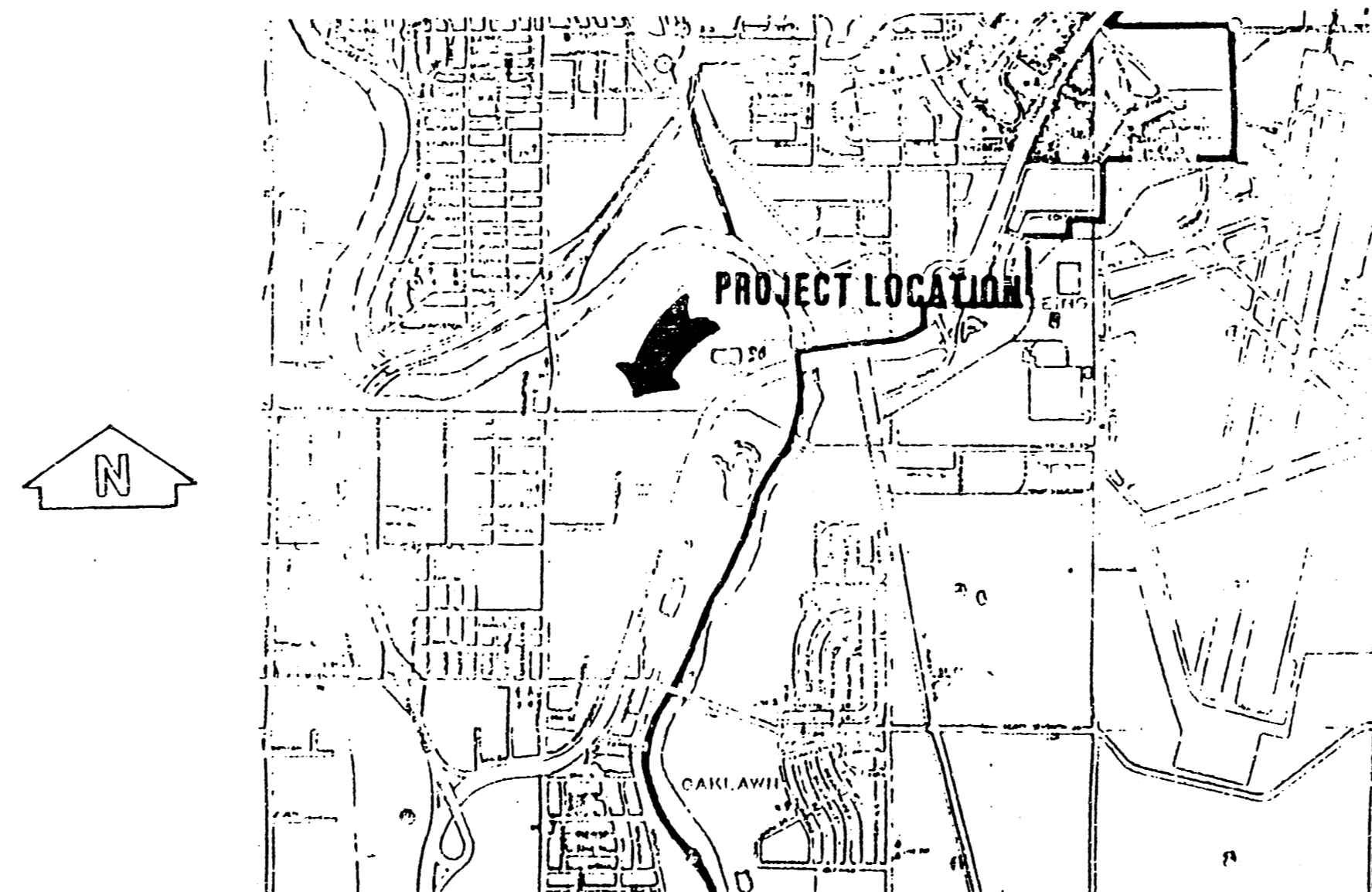

NOTE:
CONTRACTOR HAS THE OPTION OF USING THE TYPE "C" MANHOLE WITH APPROVAL OF THE ENGINEER



Revised as built 7-5-90 (Lat F4G and Main 1, Sta 0+00 (11+12) to 3+19.1 (14+31))

DENNIS & GOODNESS ENGINEERS
2100 WEST 21ST AVENUE
WICHITA, KANSAS 67203
(316) 832-0200

REVISION	DRAWN BY	CHECKED BY	DESIGNED BY	PROJECT	CUSTOMER	SCALE	PROJECT NO. 1/3

NOTE:
CONTRACTOR SHALL PROVIDE 24" MIN COVER
OVER PIPE

★ NO SEWER JOINT WITHIN 10' OF
WATER LINE, OR USE SOLVENT
WELD PIPE, OR 20" CONCRETE
ENCASEMENT

STA. 0+74 MAIN I, END 10"
CLAY TILE SEWER
BEGIN 8" PVC SEWER

STA. 0+59 MAIN I, END EXIST.
10" CLAY TILE STUB,
BEGIN NEW 10" CLAY TILE SEWER

STA. 0+00 MAIN I, EXIST. M.H.
FL. NORTH 74.89
FL. SOUTH 75.14
FL. WEST 74.85
FL. N.E. 75.19

NOTE:
0+74 - END PUBLIC SEWER
BEGIN PRIVATE SEWER

MAIN LINE TRAP DETAIL (3 read)

INSTALL 4-45° ELBOWS & ENCASE
IN 6" THICK CONCRETE AS SHOWN

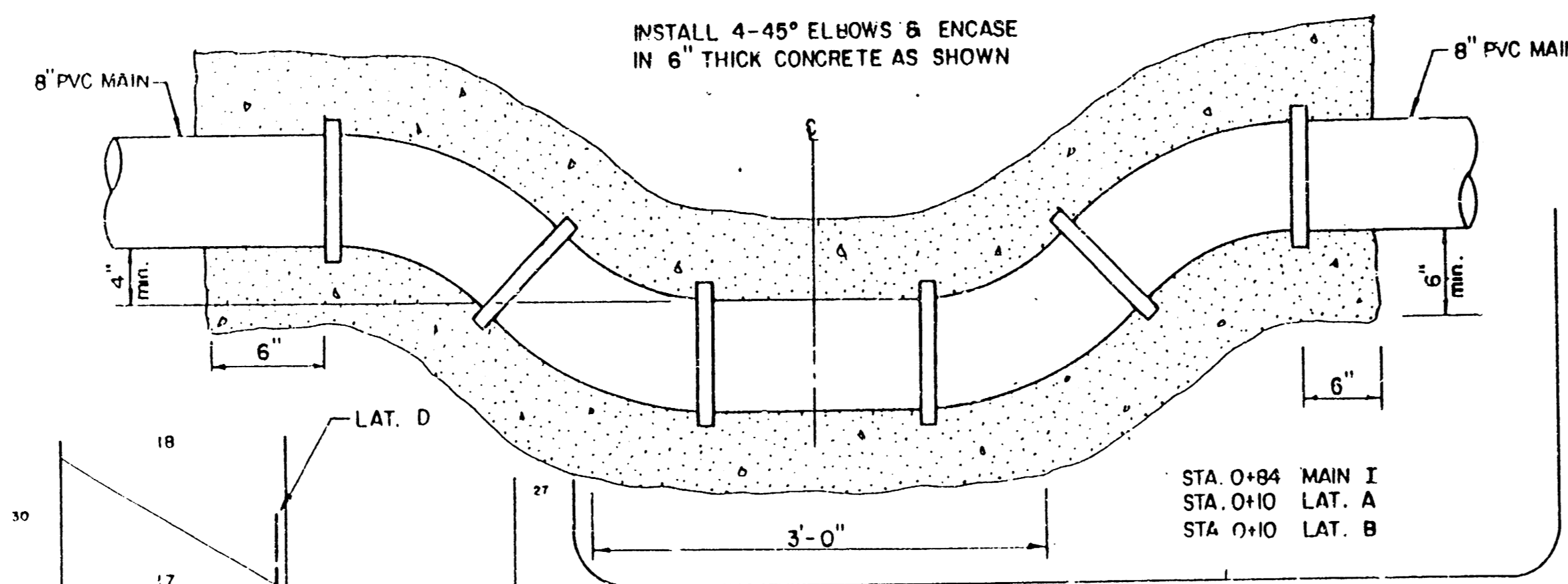

BM
R.R. SPIKE IN PP AT THE SW/C
OF THE PLAT
85.23 CITY OF WICHITA DATUM

ALL MANHOLES SHALL BE TYPE "A",
SHALLOW TYPE "A", OR SPECIAL SHALLOW TYPE "A"
UNLESS NOTED

VERIFY ELEVATION AND GRADE OF EXISTING PIPE
PRIOR TO LAYING ANY NEW PIPE. NOTIFY ENGINEER
OF ANY DISCREPANCIES IMMEDIATELY BETWEEN PLANS
AND FIELD CONDITIONS.

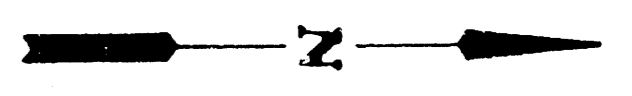

SCALE
PLAN 1" = 60'
PROFILE 1" = 50'
VERT 1" = 5'

ALL PIPE IS 8" PVC UNLESS NOTED

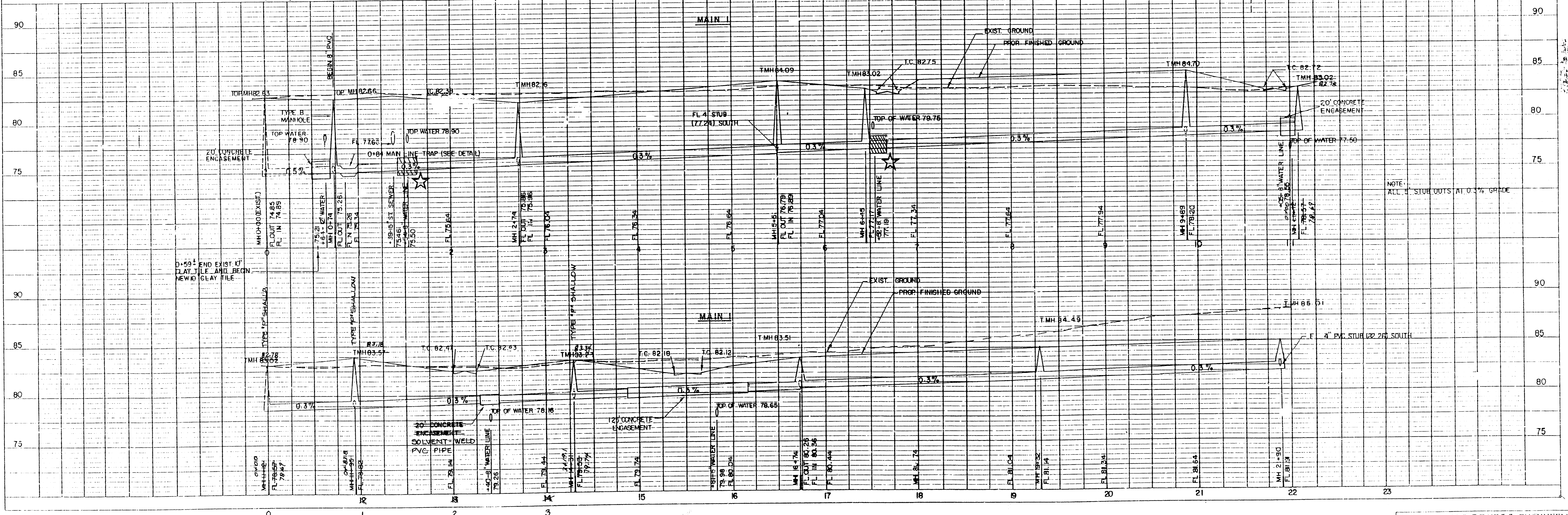

NOTE:
ALL STUB OUTS AT 0.3% GRADE

DEISS & GOODNESS ENGINEERS
2100 W. 21ST STREET
WICHITA, KANSAS 67203
(316) 332-0203

Revised as built 7.5.90 (Lat. F & G and
Main 1, Sta. 0+00 (11+12) to 3+19.1 (14+51))

2/
3

