

**SANITARY SEWER RELOCATION TO SERVE LOTS 1 & 2, McPHERSON ADDITION**  
 CITY OF WICHITA  
 MICHAEL E. LINDEBAK, P.E. : CITY ENGINEER  
 PRIVATE PROJECT NO.: 637PPS (607861)

BOUNDARY SURVEY, TOPOGRAPHIC SURVEY, UTILITY INFORMATION AND SITE IMPROVEMENTS PROVIDED BY:

**AutoZone**  
 STORE DEVELOPMENT PHONE (901) 485-8719  
 60 MADISON AVENUE MEMPHIS, TENNESSEE 38103 FAX (901) 485-8801

BOUNDARY & TOPOGRAPHIC SURVEY PERFORMED BY  
**COOK, FLATT & STROBEL**

LEGAL DESCRIPTION:  
 LOTS 1 AND 2 McPHERSON ADDITION  
 WICHITA, SEDGWICK COUNTY, KANSAS

ELEVATION DATUM SHOWN IS CITY OF WICHITA DATUM.  
 ELEVATIONS SHOWN PLUS 1187.4 = SEA LEVEL DATUM.

**BENCHMARK**  
 SQUARE CUT TOP OF CURB EAST OF THE SE COR. PROPERTY ELEV. 119.89

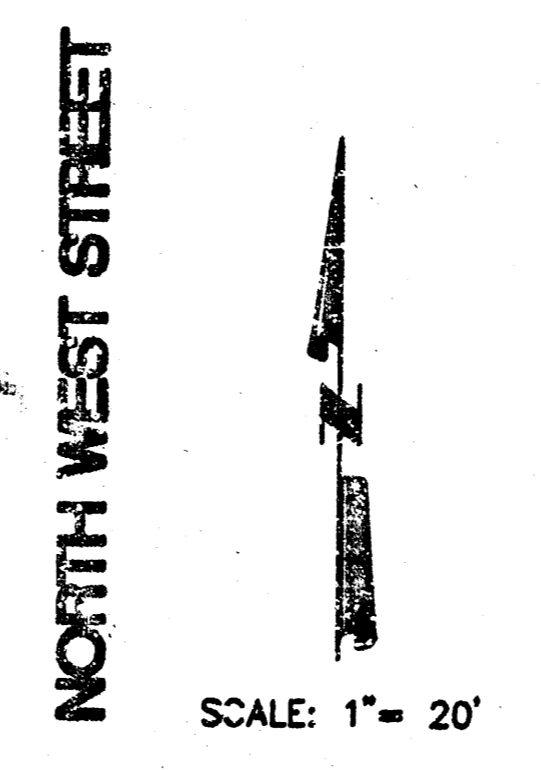

**GENERAL CONSTRUCTION NOTES**

- CONSTRUCTION METHODS, CONSTRUCTION MATERIALS AND TESTING PROCEDURES SHALL CONFORM TO THE CITY OF WICHITA'S TECHNICAL SPECIFICATIONS FOR PUBLIC IMPROVEMENTS.
- THE CONTRACTOR SHALL PROVIDE PERFORMANCE AND MAINTENANCE BONDS AS REQUIRED BY THE CITY OF WICHITA.
- THE CONTRACTOR SHALL SECURE THE SERVICES OF AN ENGINEERING FIRM TO PROVIDE CONSTRUCTION STAKING AND INSPECTION AND VACUUM TESTING OF THE COMPLETED SEWER SYSTEM.
- THE CONTRACTOR SHALL VERIFY LOCATION AND ELEVATION OF THE EXISTING SANITARY SEWER MAIN PRIOR TO BEGINNING CONSTRUCTION.
- THE CONTRACTOR SHALL BE RESPONSIBLE FOR ANY DAMAGE AND SUBSEQUENT REPAIR OF UNDERGROUND UTILITIES OR PERTINENT OBSTRUCTIONS DURING THE COURSE OF HIS OR HER OPERATIONS ON THE CONSTRUCTION SITE OR THE IMMEDIATE AREA. CALL KANSAS ONE-CALL (1-800-344-7233) PRIOR TO BEGINNING CONSTRUCTION.
- ALL DISTURBED AREAS SHALL BE SEEDED AND RESTORED TO EXISTING CONDITION.

APPROVED AS NOTED  
 By CITY ENGINEER OF WICHITA  
 Sanitary Sewers VRH 9/25/96  
 Storm Sewers \_\_\_\_\_  
 Driveway Approaches \_\_\_\_\_  
 Water Mains \_\_\_\_\_  
 Paving \_\_\_\_\_

**NOTE TO CONTRACTOR**  
 INSPECTION AND TESTING FOR THIS PROJECT IS TO BE PROVIDED BY A LICENSED CONSULTING ENGINEERING FIRM UNDER CONTRACT WITH THE OWNER/DEVELOPER. SAID INSPECTION TO BE IN ACCORDANCE WITH THE CITY OF WICHITA STANDARD CONSTRUCTION ENGINEERING PRACTICES AND CERTIFIED BY A LICENSED PROFESSIONAL ENGINEER. NO WORK SHALL BE PERFORMED IN DEDICATED EASEMENTS OR THE PUBLIC RIGHT-OF-WAY BY THE CONTRACTOR WITHOUT SUCH INSPECTION NOR SHALL ANY WORK BE COMMENCED IN DEDICATED EASEMENTS OR PUBLIC RIGHT-OF-WAY WITHOUT WRITTEN AUTHORIZATION BY THE CITY ENGINEER.

ASBUILT RAUGHMAN CO  
 9FB 11/14/96

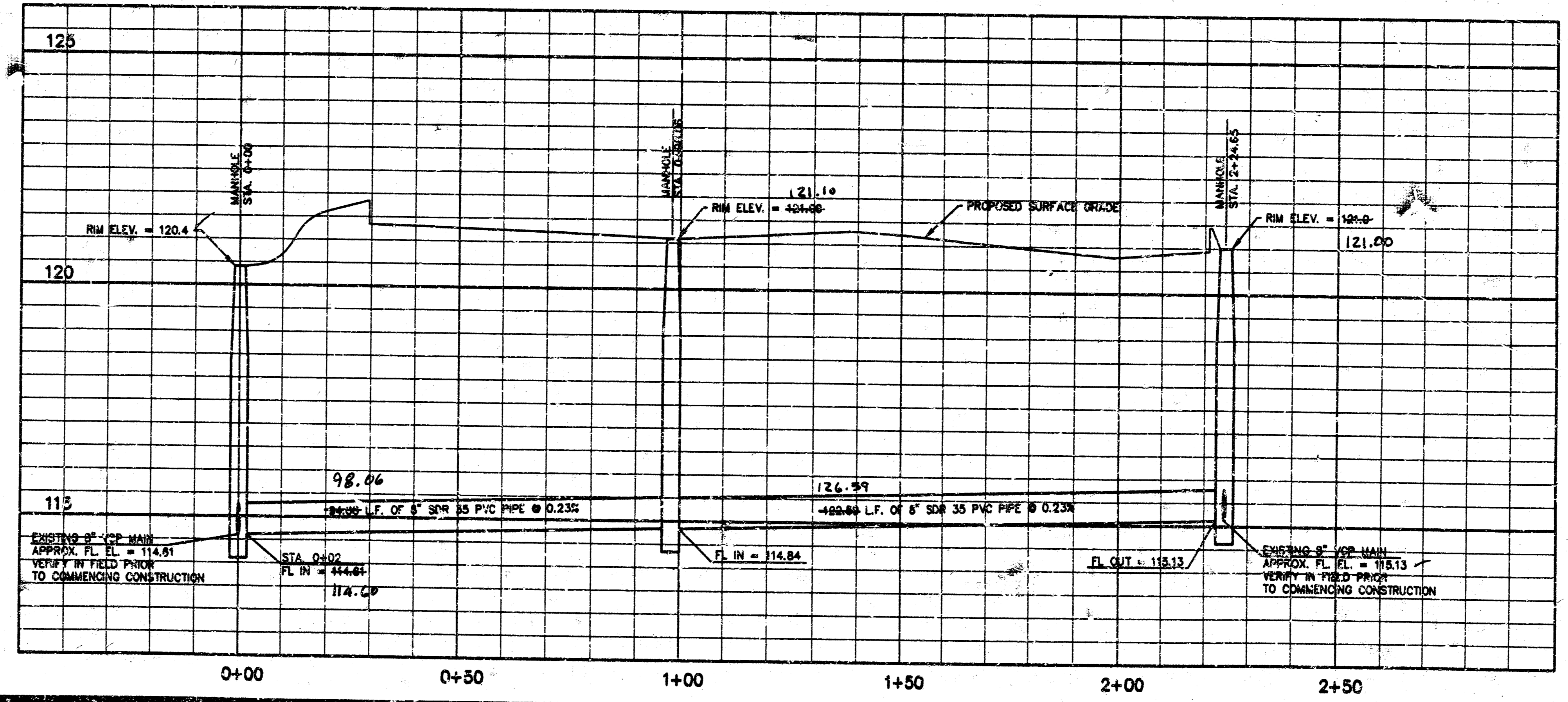
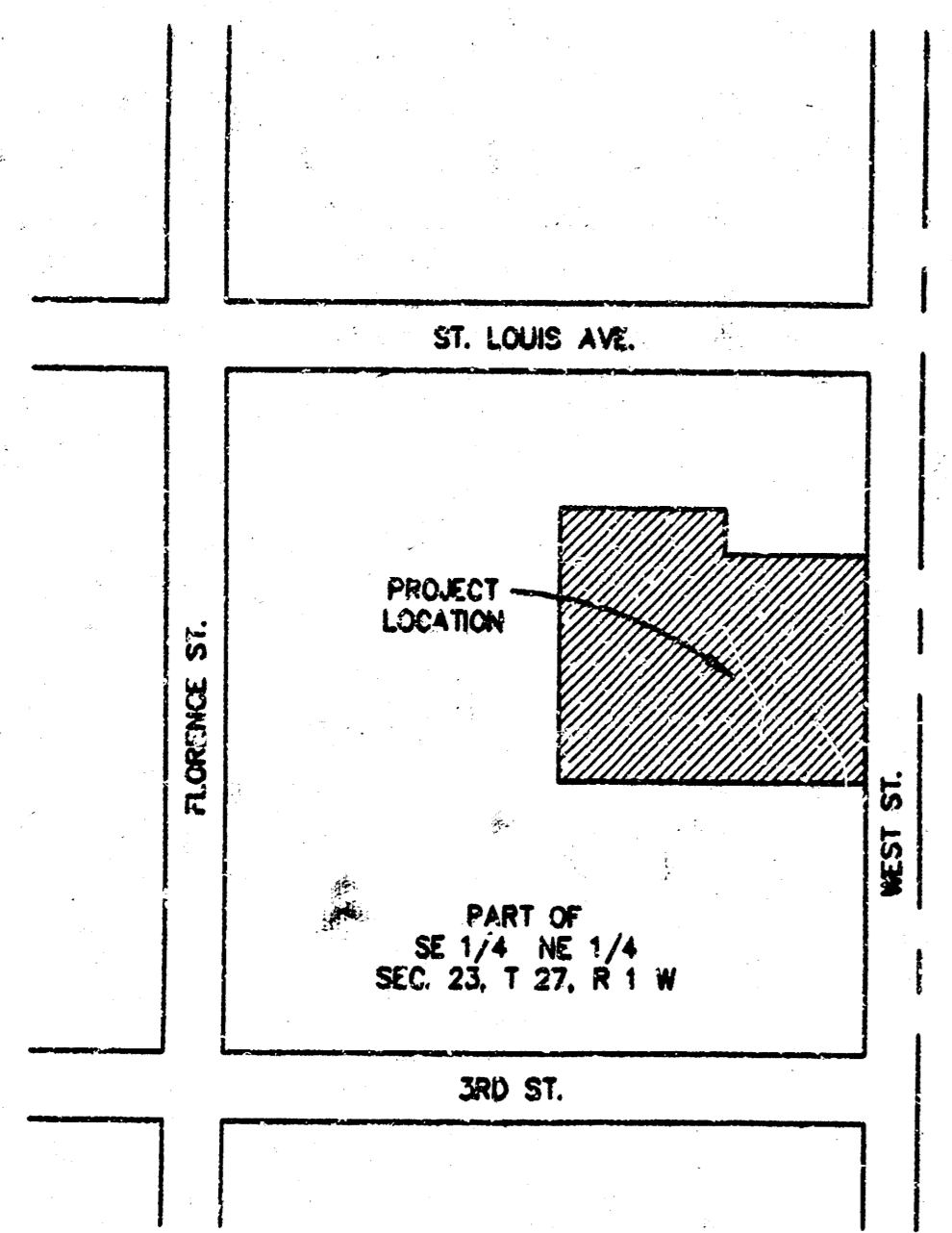

REVISIONS	BY
NO. 1 - 7/24/88	BRP

SITE GRADING & SANITARY SEWER DESIGN FOR  
**AUTOZONE**  
 NORTH WEST STREET  
 WICHITA, KANSAS

**SAN. SEWER PLAN & PROFILE**  
**Palmerton & Parrish, Inc.**  
 2835 - K East Division  
 Springfield, MO 65803  
 (417) 864-8000

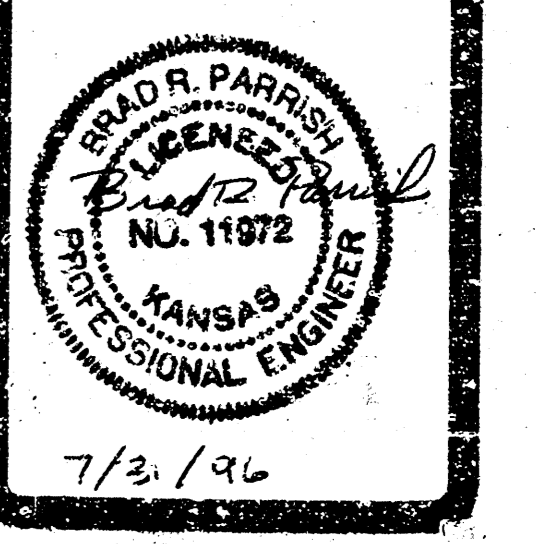

DWG. NO.	DATE
057334	05/24/96
DRAWN BY	CHECKED BY
KRB	BRP
HOR. SCALE	VERT. SCALE
1" = 20'	1" = 2'

DRAWING NO.  
 67334SSW  
**C1.1A**