

BENCH MARK 10' Cut on Top of Curb between Lots 20 & 21 Miles Lakewood Village Second Addition Elev. 122.08 City Datum

RECEIVED MARK Top Rim Manhole located approx. 61' N 6" & 10' S of E. End of Station 0+00. Elev. 125.35 City Datum

PLAN
 DATE: 8/19/85
 BY: [Signature]
 CHECKED: [Signature]
 IN CHARGE: [Signature]

PROFILE
 DATE: 8/19/85
 BY: [Signature]
 CHECKED: [Signature]
 IN CHARGE: [Signature]

Notes: Contractor to verify any underground utility lines within the street R.O.W. prior to beginning construction.
 Asphalt pavement shall be replaced as per City Specs.
 Contractor to properly barricade the street during closing for construction and sign adequately.

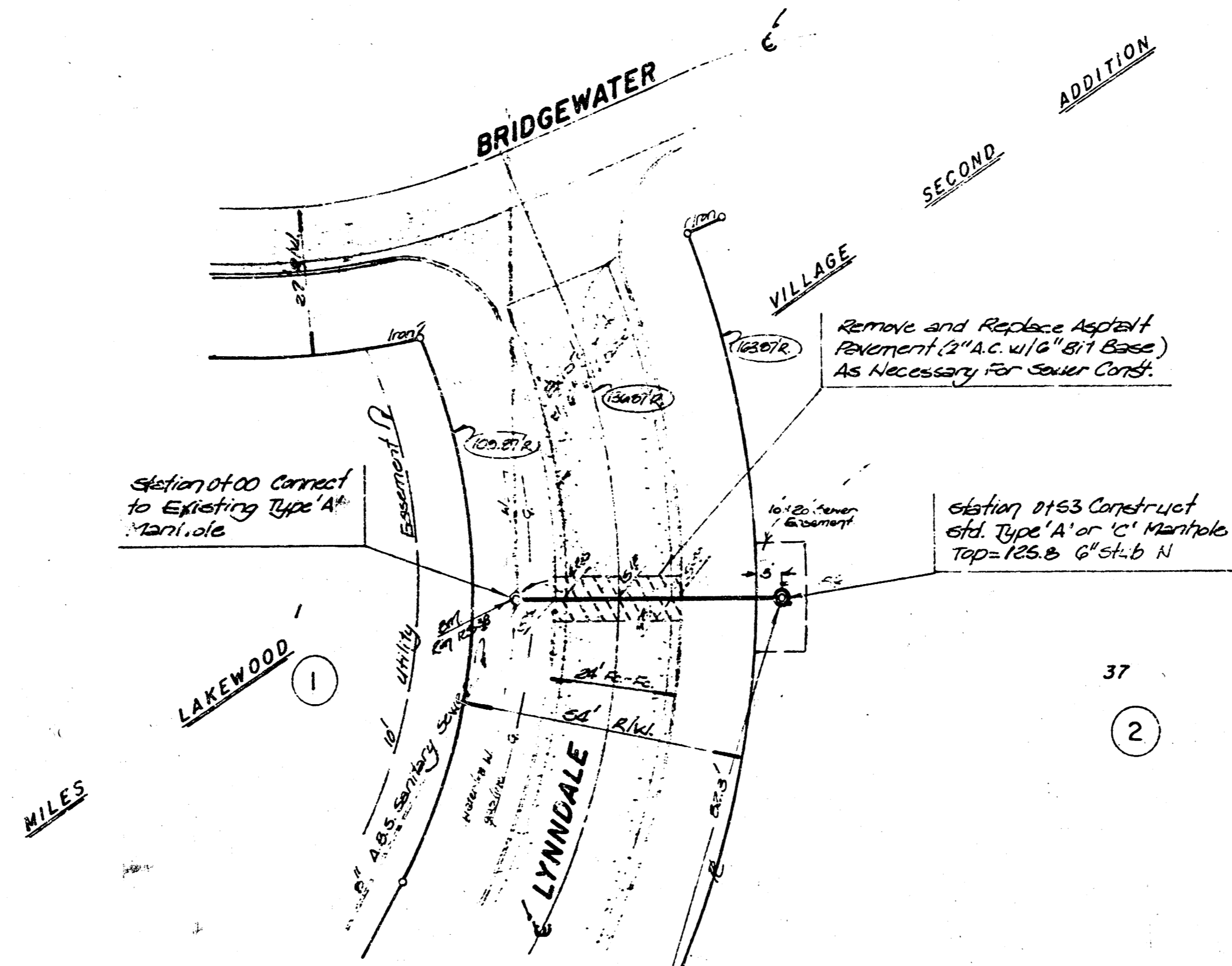

SCALE 1" = 20' PLAN
 1" = 5' PROFILE

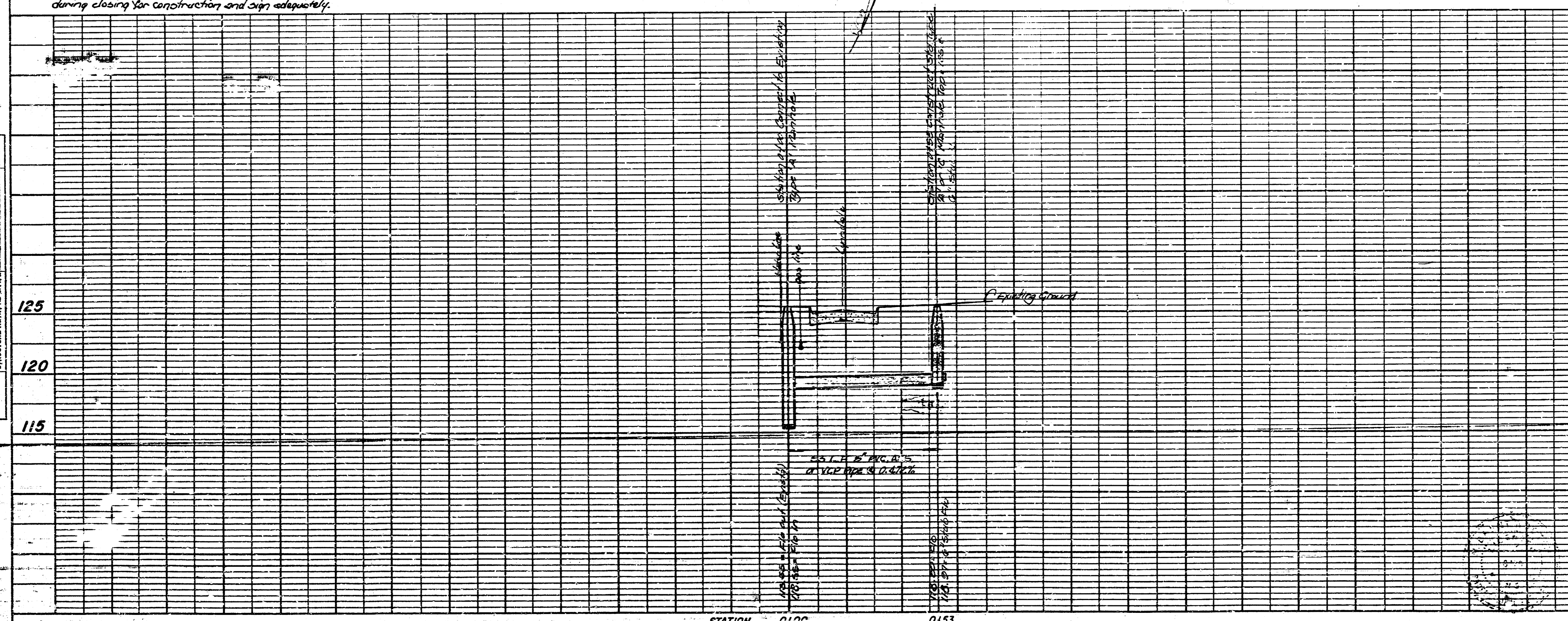
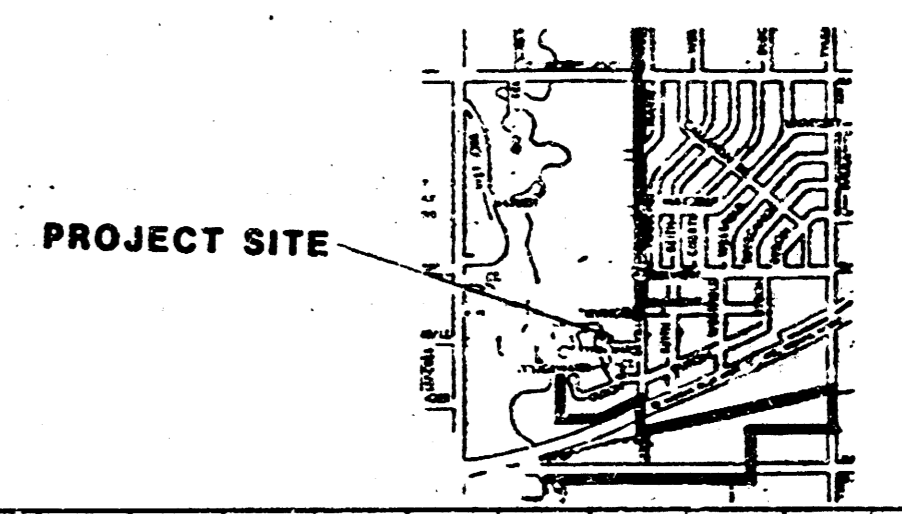

LOCATION MAP

DATE: 8/19/85
 BY: [Signature]
 CHECKED: [Signature]
 IN CHARGE: [Signature]

NOTE TO CONTRACTOR
 This project will be constructed under the supervision of the City Engineer. The contractor shall be responsible for obtaining all necessary permits and for the safety of the public during construction. The contractor shall be responsible for the removal and replacement of any damaged property.

AUGUST 1985

PRIVATE SANITARY SEWER EXTENSION
 TO SERVE PART OF LOT 37, BLK 2,
 MILES LAKEWOOD VILLAGE SECOND ADDITION

CITY OF WICHITA, KS

PROJ. NO. 488-76-245-80001-000-000-032

BAUGHMAN COMPANY, P.A.
 SURVEYING & ENGINEERING
 316 268-7271 • 330 LAURA • WICHITA, KANSAS 67211

PLATE 1 - PLAN, PROFILE, & ALL CLEARANCE PAPER CO., S.F. CAL.

AUG 21 1985

FILMED FROM THE BEST AVAILABLE COPY