

R.M. 102 1/2 CITY STANDARD ME. OUR HILLSIDE & PAWNEE 25' E. GUY POLE 1 25' W. of 'X' on curb.

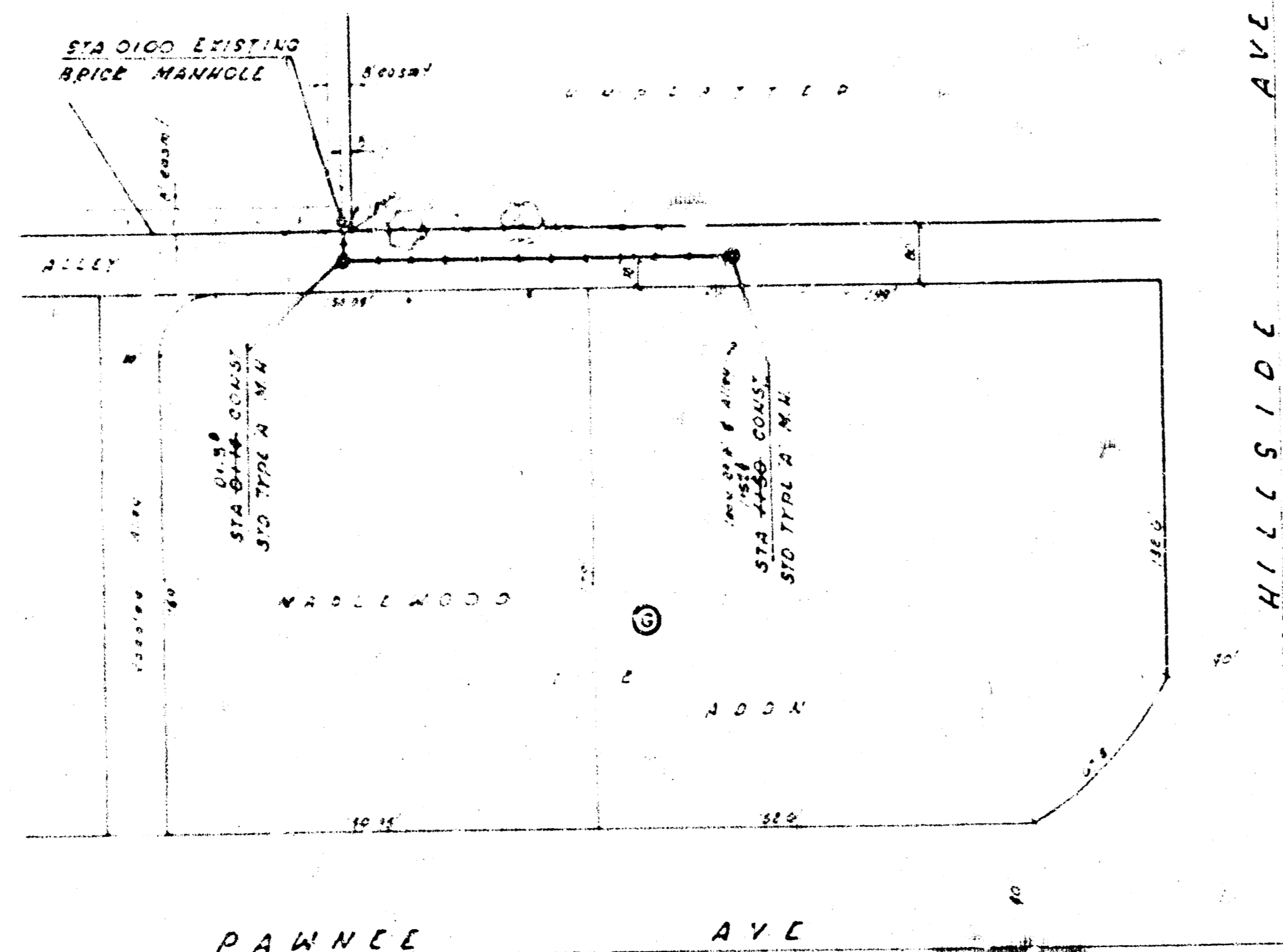

NOTE: Existing private sanitary line to be abandoned, and all service lines connected to private sewer to be reconnected to new sewer construction. All costs for reconnections to be incidental to project.

PLAN SCALE 1" = 40'
 PROFILE 1" = 4' VERT
 1" = 20' HORIZ

NOTE TO CONTRACTOR
 This project will be constructed under the supervision of the CITY ENGINEER and conforming to the SPECIFICATIONS of the CITY OF WICHITA. The CONTRACTOR will reimburse the City of Wichita for all cost of Engineering, Plans, and Inspection.

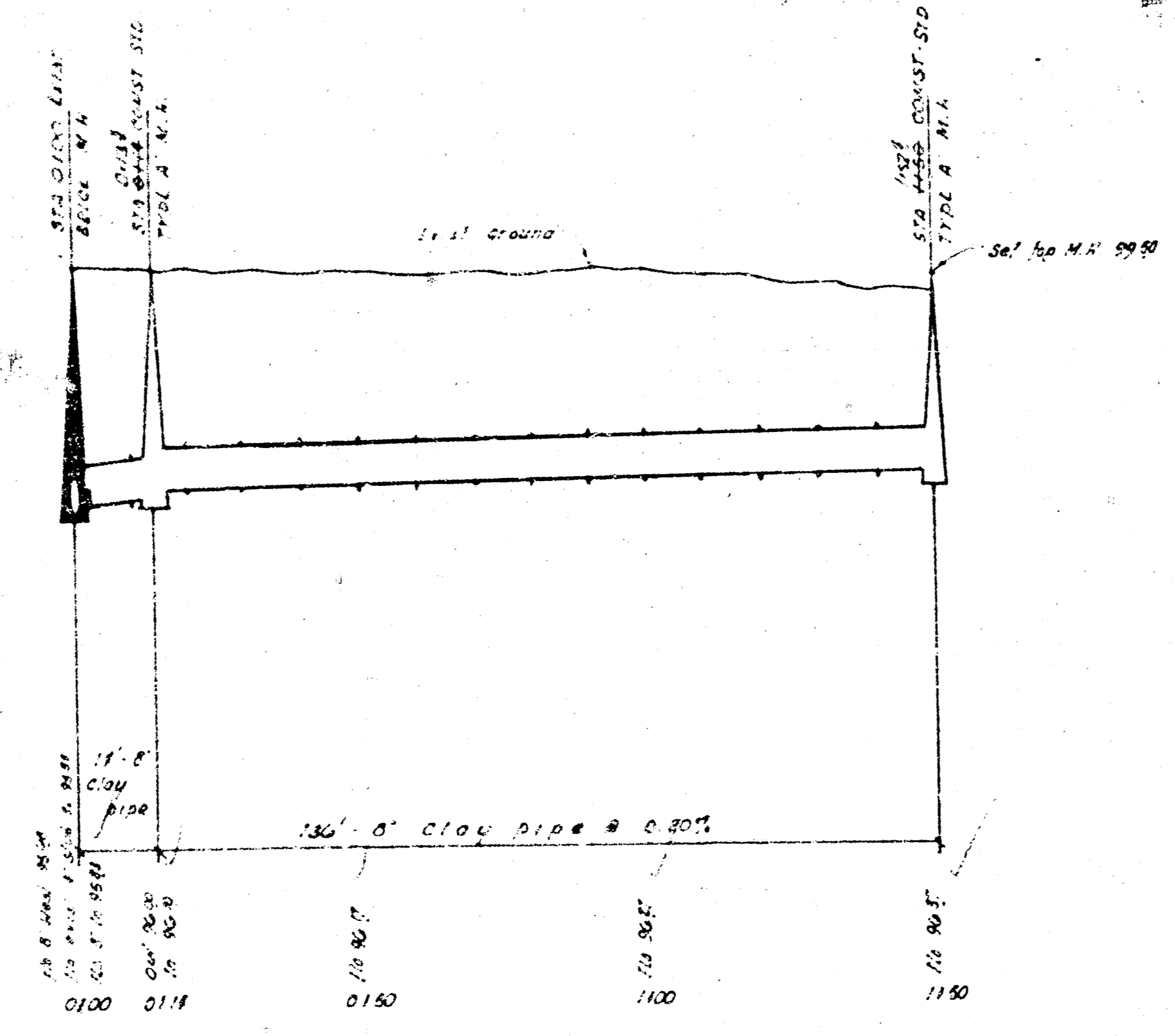

As BUILT 155' x 15\"/>

SANITARY SEWER	
R.M. 102 1/2 HILLSIDE & PAWNEE MOBIL OIL CO. (PRIVATE CONTRACT)	
CITY OF WICHITA, KANSAS	
R.W. LINN CITY ENGINEER	
DATE SEPT. 1932 PROJ. NO. 502036	