

DECIDUOUS TREE PLANTING UPRIGHT STAKES DETAIL
NOT TO SCALE

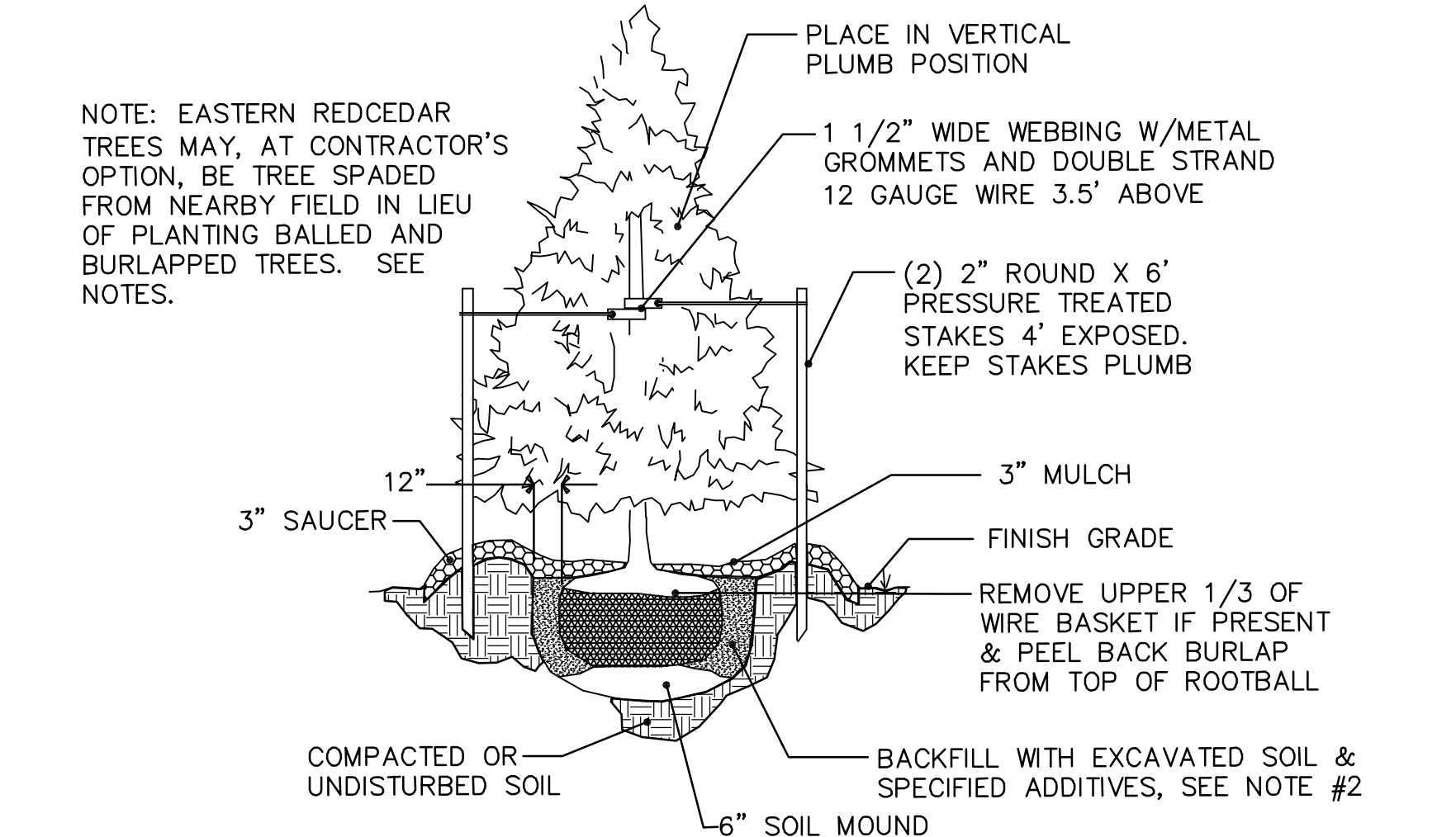

EVERGREEN TREE PLANTING DETAIL
NOT TO SCALE

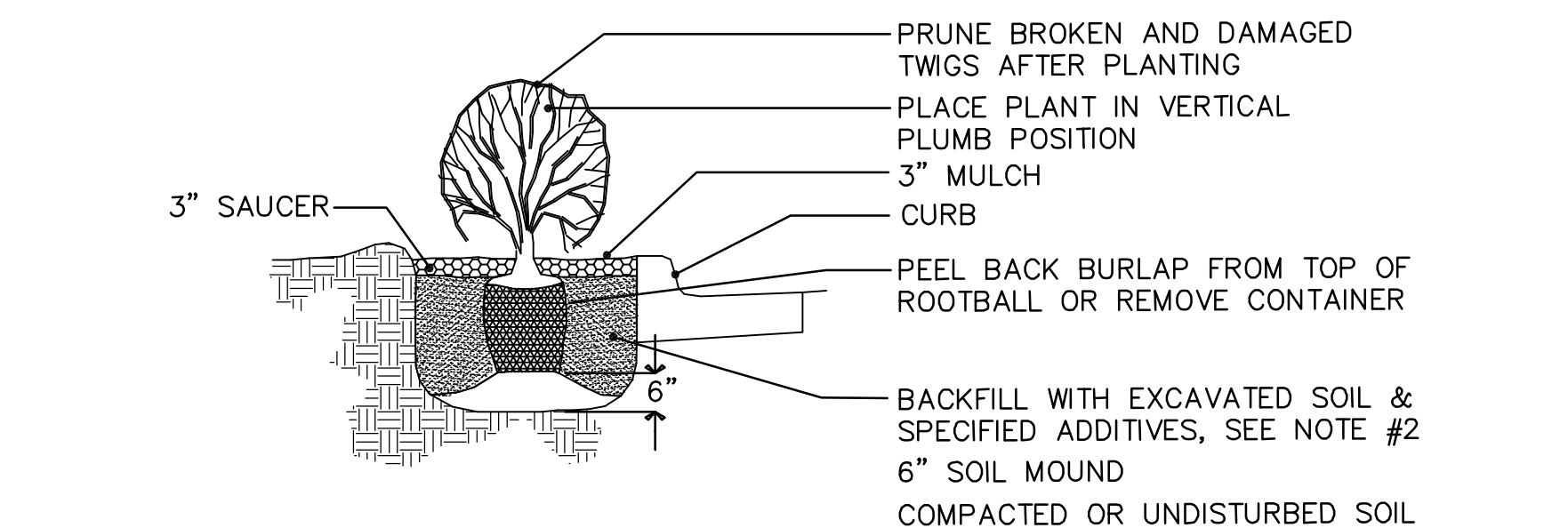

SHRUB PLANTING DETAIL
NOT TO SCALE

NOTE: PROJECT CONTINUES TO SOUTH, (SEE EROSION CONTROL AND SEEDING PLAN)

NOTES:
FOR ALL TREES AND SHRUBS, THE BALL OF THE PLANT NEEDS TO BE KEPT MOIST AND PROTECTED FROM DAMAGE PRIOR TO PLANTING. ADD ROOT STIMULATOR TO SURFACE IMMEDIATELY AFTER PLANTING AS PER THE MANUFACTURER'S RECOMMENDATIONS. PLANTING DEPTH OF ROOTBALL SHALL BE EQUAL TO ITS ORIGINAL PLANTING DEPTH AT NURSERY. DO NOT OVERTIGHTEN GUYS.

TREE WATERING: ALL TREES SHALL BE WATERED THROUGH THE FIRST SUMMER OF ESTABLISHMENT BY USING "IRRI-GATOR" SLOW DRIP IRRIGATION BAGS FILLED WITH WATER A MINIMUM OF ONCE EVERY TWO WEEKS. CONTRACTOR MAY RETAIN OWNERSHIP OF "IRRI-GATOR" BAGS AT END OF WATERING REQUIREMENT PERIOD. COST OF "IRRI-GATOR" BAGS, WATER, AND LABOR SHALL BE SUBSIDIARY TO "TREES" BID ITEM.

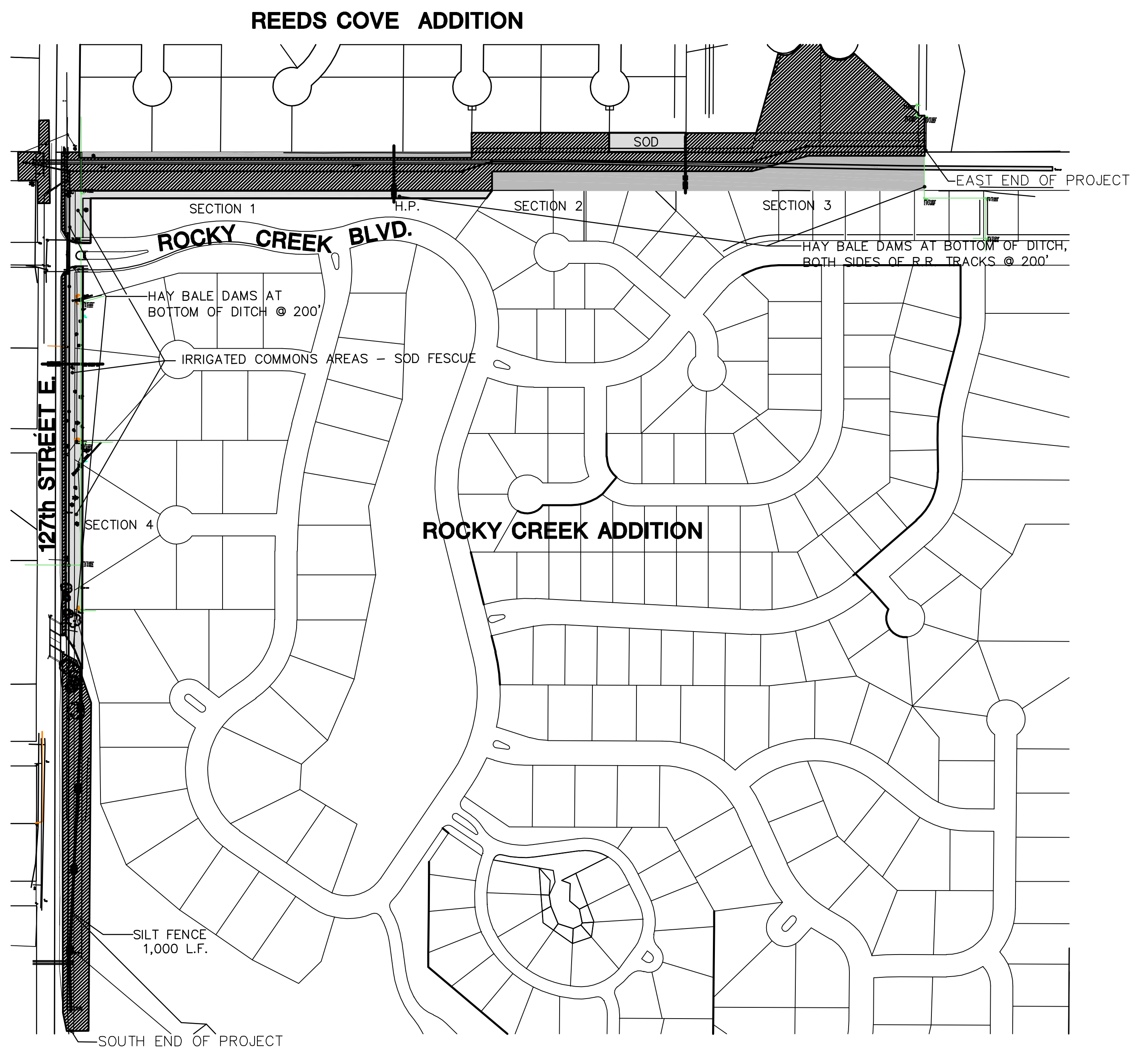
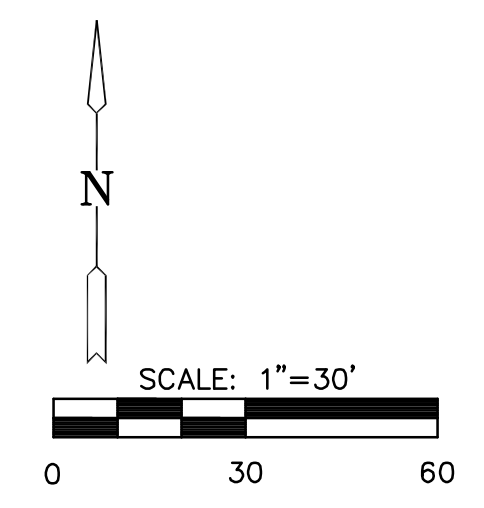

EROSION CONTROL AND SEEDING PLAN
SCALE 1" = 200'

LEGEND

- FESCUE SOD
- BUFFALO/RYEGRASS SEED

- BMP'S**
- = SILT FENCE 1,000 L.F.
 - = HAY BALE DITCH CHECKS - APPROX 20 TOTAL HAY BALE DITCH CHECK INSTALLATIONS (SEE DETAIL)

NOTES

1. MULCH SHALL BE 3" DEPTH SHREDDED HARDWOOD BARK. MULCH 36" DIAMETER RING X 6" DEPTH AROUND EACH TREE PLANTED IN TURF AREA.
2. BACK-TO-EARTH COTTON BUR COMPOST AND MILORGANITE MIXED INTO BACKFILL SOIL PLUS NEW LAWN STARTER FERTILIZER (INCORPORATED INTO THE TOP 1-2" OF BACKFILL SOIL) PLANTING SOIL AMENDMENTS.
3. AT CONTRACTOR'S OPTION, EASTERN REDCEDAR TREES MAY BE PURCHASED FROM OWNER OF NEARBY FIELD AND TREE SPADED IN LIEU OF PLANTING BALLED AND BURLAPPED TREES. SEE NOTES FOR SOURCE. ALL TREE SPADED TREES SHALL HAVE UNBROKEN ROOTBALLS FOLLOWING TRANSPLANTING. SHALL BE THOROUGHLY SANDED-IN AND WATERED-IN, AND SHALL CARRY SAME GUARANTEE AS BALLED AND BURLAPPED TREES.
4. ALL PLANTS SHALL CONFORM TO ANSI Z60.1 FOR SIZE AND QUALITY STANDARDS.
5. ALL DISTURBED AREAS UNDER EXISTING LAWN IRRIGATION SHALL BE SODDED WITH TURF-TYPE TALL FESCUE SOD. ALL DISTURBED AREAS NOT UNDER EXISTING LAWN IRRIGATION SHALL BE SEEDDED WITH BUFFALO/RYEGRASS MIXTURE, SEE NOTES FOR SEEDING RATES.
6. INSTALL AND MAINTAIN EROSION CONTROL BMP'S AT LOCATIONS SHOWN ON PLAN.

PLOTTED: Wednesday, June 04, 2008 @ 03:38PM

J:\CIVIL\06693\DWG\LANDSCAPE\06693_L2.DWG