

GRAPHIC SCALE

( IN FEET )  
1 inch = 20 ft.

**UTILITY LEGEND**

- = Fire Hydrant
- = Water Meter
- = Water Valve
- = Gas Meter
- = Gas Valve
- = Telephone Riser
- = Mailbox
- = Flag Pole
- = SS Manhole
- = SWS Manhole
- = Sign
- = Misc. Post
- = Guy Anchor
- = Power Pole
- = Light Pole
- = Deciduous Tree or Shrub
- = Existing Fence
- = Right of Way Line
- = Underground Telephone
- = Underground Electric
- = Water Line
- = Sanitary Sewer
- = Gas Line
- = Cable TV or Fiber Optic

- = Proposed 5" A.C. Pavement on 5" Crushed Rock Base
- = Proposed Concrete Curb & Gutter
- = Exist. Road Gravel To Be Removed
- = Propose Pavement Removal

- BENCHMARKS:**
- SBM #1 - "0" T/C N. Side St. Louis ±50' E. & ±15' N. of CL Intersection St. Louis Ave. & Baehr St.
  - SBM #2 - 1/2" Capped Rebar w/Savoy Ruggles & Bohm Cap ±0' SW Corner Intersection Newell Ave. & Baehr St.
  - SBM #3 - "0" T/C N. Side Handicap Ramp SW Corner Intersection Central Ave. & Baehr St.

UTILITIES SHOWN REPRESENT THE BEST INFORMATION AVAILABLE FOR DESIGN. ADDITIONAL UTILITIES MAY BE PRESENT ON THIS PROJECT. THE CONTRACTOR SHALL BE RESPONSIBLE FOR DETERMINING THE EXACT LOCATION, DEPTH AND SIZE OF ALL UNDERGROUND UTILITIES PRIOR TO CONSTRUCTION. THE CONTRACTOR SHALL BE LIABLE FOR ANY DAMAGE CAUSED BY THE FAILURE TO DO SO.

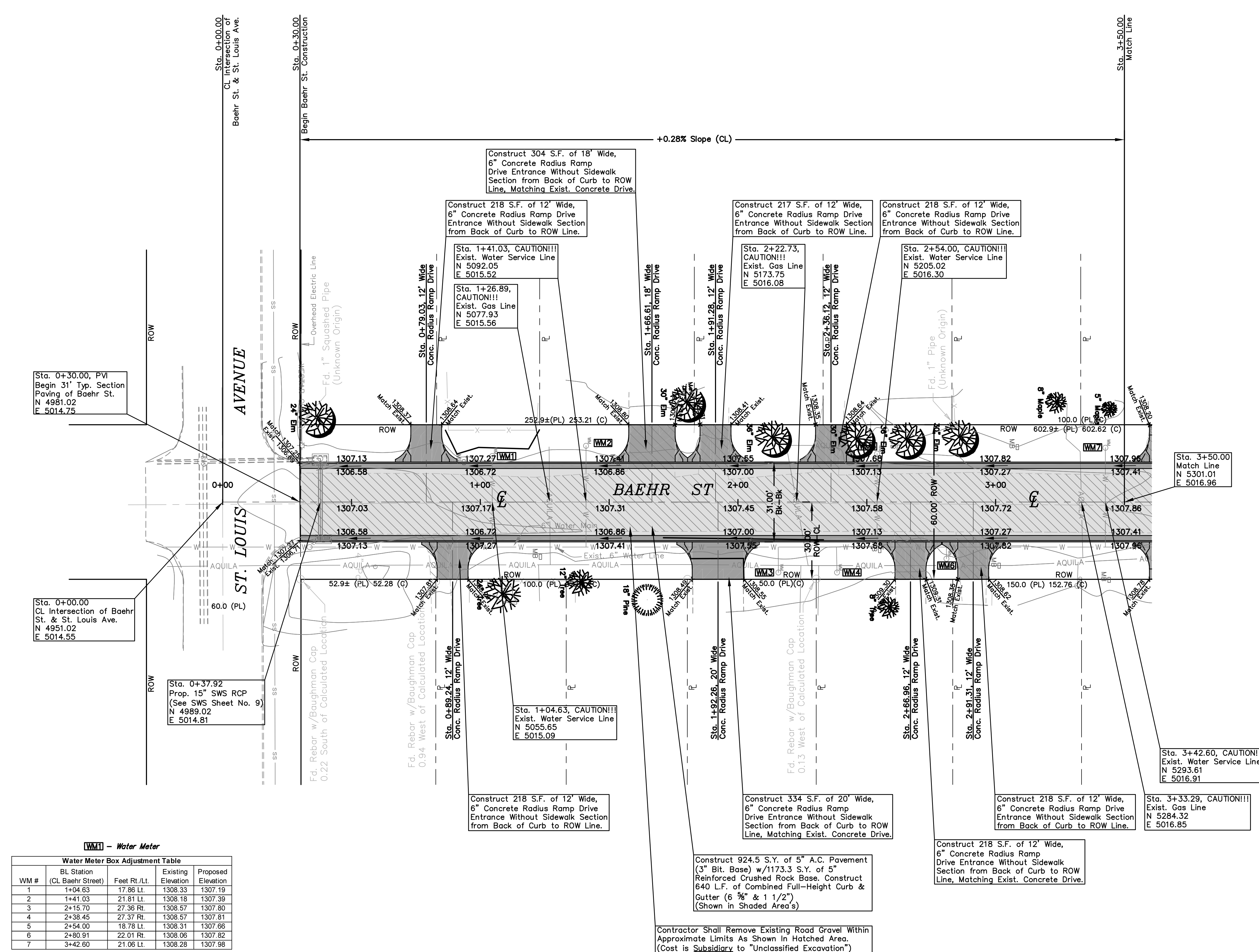

**WM1 - Water Meter**

**Water Meter Box Adjustment Table**

WM #	BL Station (CL Baehr Street)	Feet Rt./Lt.	Existing Elevation	Proposed Elevation
1	1+04.63	17.86 Lt.	1308.33	1307.19
2	1+41.03	21.81 Lt.	1308.18	1307.39
3	2+15.70	27.36 Rt.	1308.57	1307.80
4	2+38.45	27.37 Rt.	1308.57	1307.81
5	2+54.00	18.78 Lt.	1308.31	1307.66
6	2+80.91	22.01 Rt.	1308.06	1307.82
7	3+42.60	21.06 Lt.	1308.28	1307.98

SEE GENERAL NOTE 15 ON TITLE SHEET FOR MAILBOX RELOCATIONS.

**General Note:** The Contractor Shall NOT Remove Any Trees Within Baehr St. ROW Unless Approved By The Engineer. Contractor Shall Exercise Care During Construction of Baehr St. So Not To Damage Any Trees.

PAVING PLAN FOR  
**BAEHR STREET**  
WICHITA, SEDGWICK COUNTY, KANSAS  
CED PROJ. NO.: 20071583

**CERTIFIED ENGINEERING DESIGN, P.A.**  
810 WEST DOUGLAS, SUITE C  
WICHITA, KANSAS 67203  
PH.(316)262-8808 FAX.(316)262-1669

DESIGNED: HDF	SCALE: 1"=20'	SHEET
DRAWN: JDT	DATE: 10-07	5
CHECKED: HDF	CED FILE: Baehr St-Base	TOTAL 24