

FHWA REGION NO.	STATE	PROJECT NO.	FISCAL YEAR	SHEET NO.	TOTAL SHEETS
7	KANSAS	87N-0378-01	2008	18	72

SCALE:  
1" = 20' HORIZONTAL  
1" = 5' VERTICAL

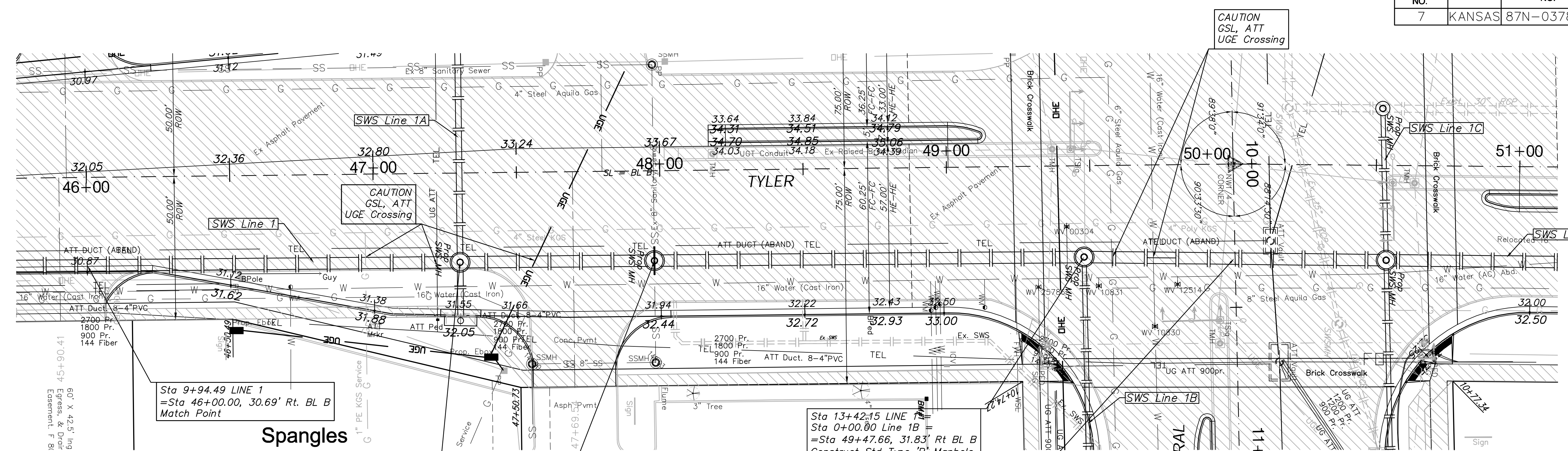

Sta 9+94.49 LINE 1 = Sta 46+00.00, 30.69' Rt. BL B Match Point

**Spangles 612 N Tyler**  
Sta 11+24.51 LINE 1 = Sta 0+00.00 Line 1A = Sta 47+30.02, 31.11' Rt BL B Construct Std Type 'P' Manhole (6' Dia.) Per Dtl Sheet Elev= 1332.01 Rim

Sta 11+92.30, LINE 1 = Sta 47+97.82, 31.34' Rt BL B Construct Std. Type 'P' Manhole (6' Dia.) Over Ex. 8" SS. See Detail, This Sheet. Elev= 1332.57 Rim

Sta 13+42.15 LINE 1 = Sta 0+00.00 Line 1B = Sta 49+47.66, 31.83' Rt BL B Construct Std Type 'P' Manhole (6' Dia.) Per Dtl Sheet Elev= 1333.62 Rim

Sta 13+94.50 LINE 1 = Sta 50+00.00, 33.00' Rt. BL B Match Point

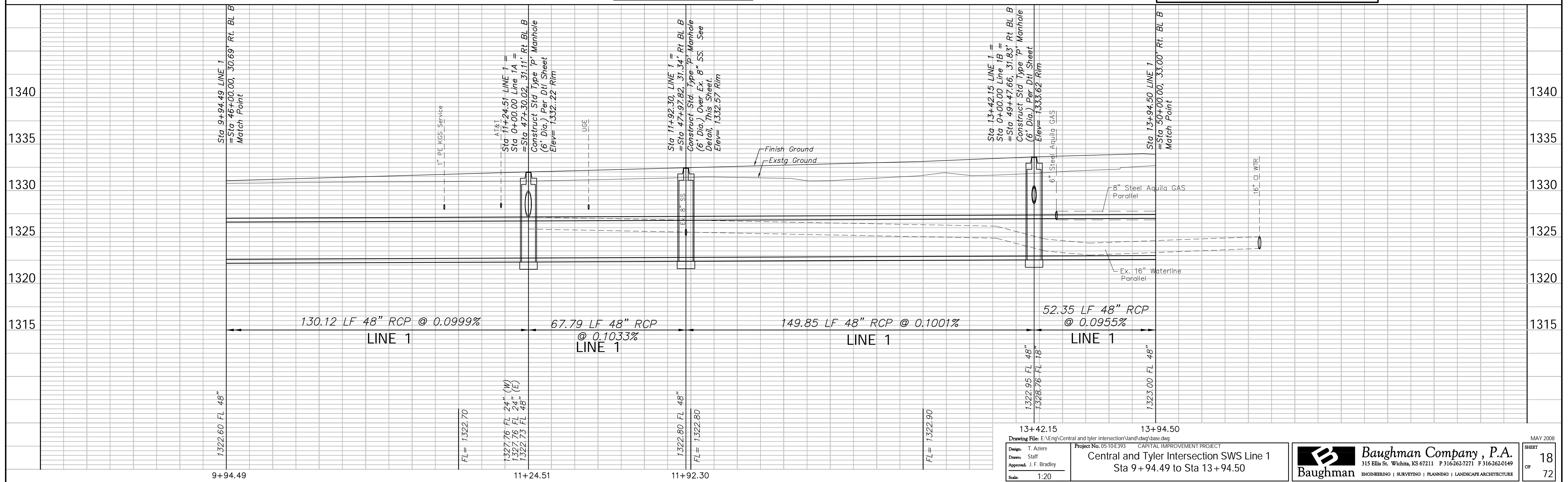
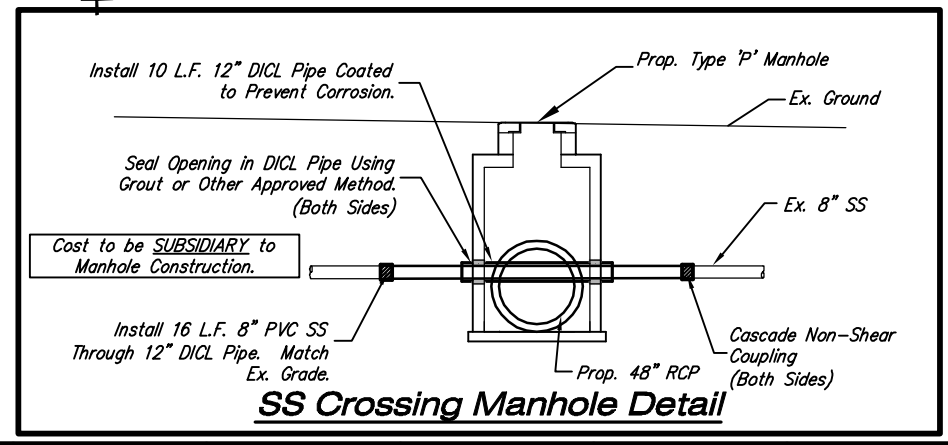

13+42.15  
13+94.50

Drawing File: E:\Eng\Central and tyler intersection\land\dwg\base.dwg  
Design: T. Azire  
Drawn: Staff  
Approved: J. F. Bradley  
Scale: 1:20  
Project No. 05-10E393 CAPITAL IMPROVEMENT PROJECT  
Central and Tyler Intersection SWS Line 1  
Sta 9 + 94.49 to Sta 13 + 94.50

**Baughman Company, P.A.**  
315 Ellis St. Wichita, KS 67211 P 316-262-7271 F 316-262-0149  
ENGINEERING | SURVEYING | PLANNING | LANDSCAPE ARCHITECTURE

MAY 2008  
SHEET 18 OF 72