

FHWA REGION NO.	STATE	PROJECT NO.	FISCAL YEAR	SHEET NO.	TOTAL SHEETS
7	KANSAS	87N-0378-01	2008	23	72

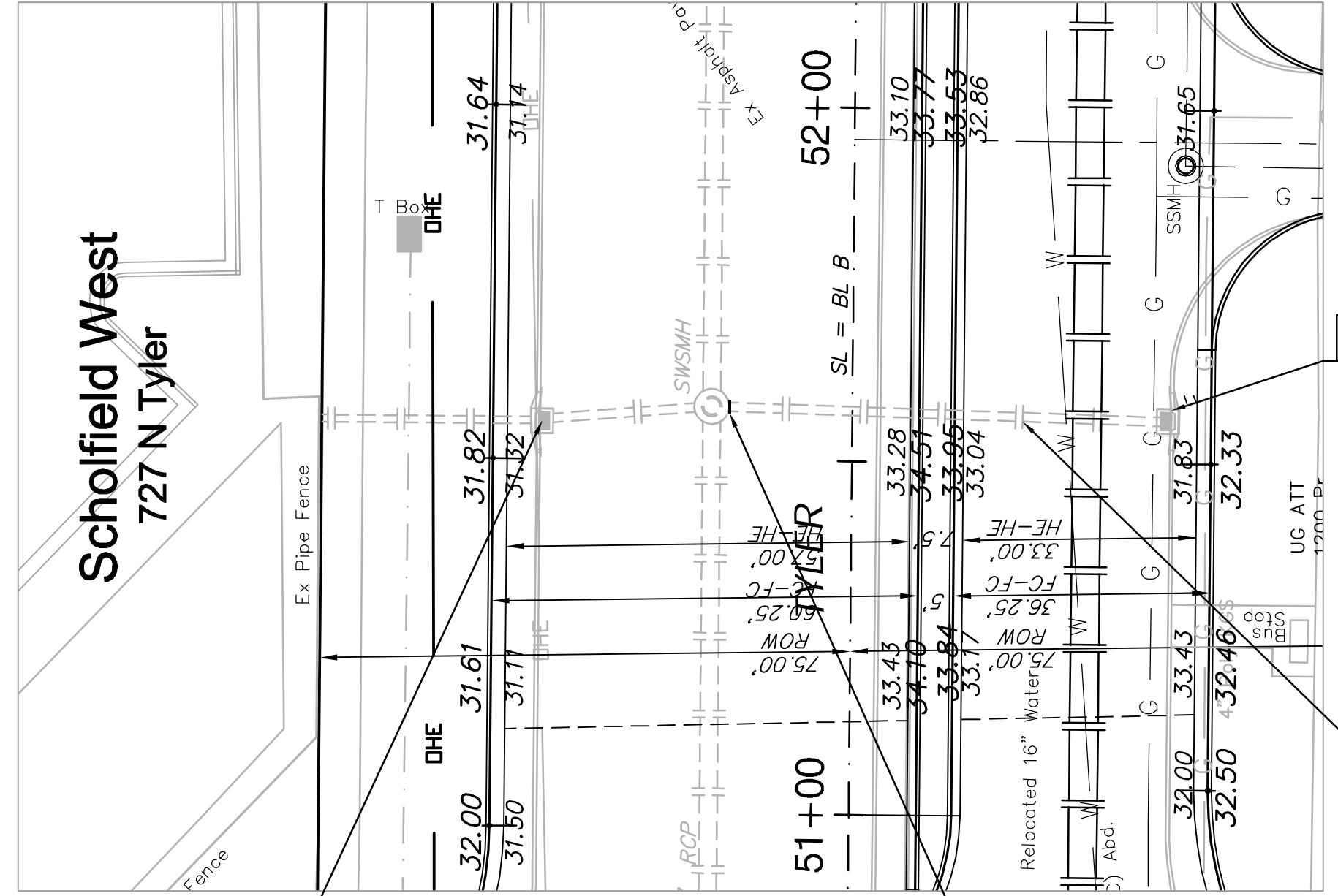

SCALE:
1" = 20' HORIZONTAL
1" = 5' VERTICAL

Remove Inlet & Plug Pipe (W)

Abandon Ex. 15" RCP Per City Standards

Plug 15" Pipe (E)

Sta 51+55.34, 43.84' Lt BL B
Remove Ex. Type II Inlet
Connect Ex. 15" RCP Ends (E&W) to drain.

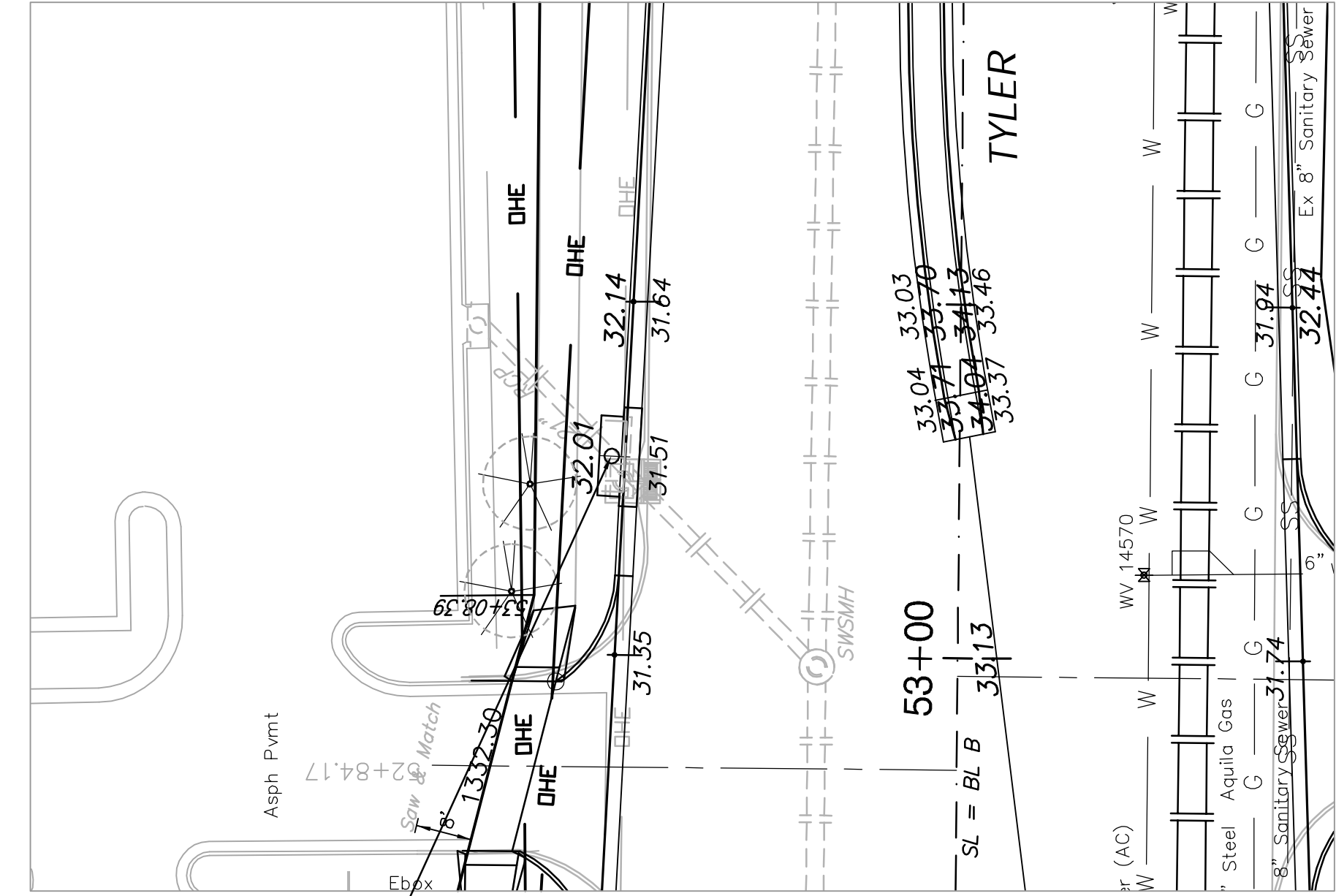

SCALE:
1" = 20' HORIZONTAL
1" = 5' VERTICAL

Sta 53+28.08, 49.17' Lt BL B
Remove Ex. Special Type II Inlet
Construct Type 1 Inlet (Double) (11'4"x 4'4"). Connect to Ex. 21" RCP (E&W). Verify Depth. Elev= 1332.01 Top

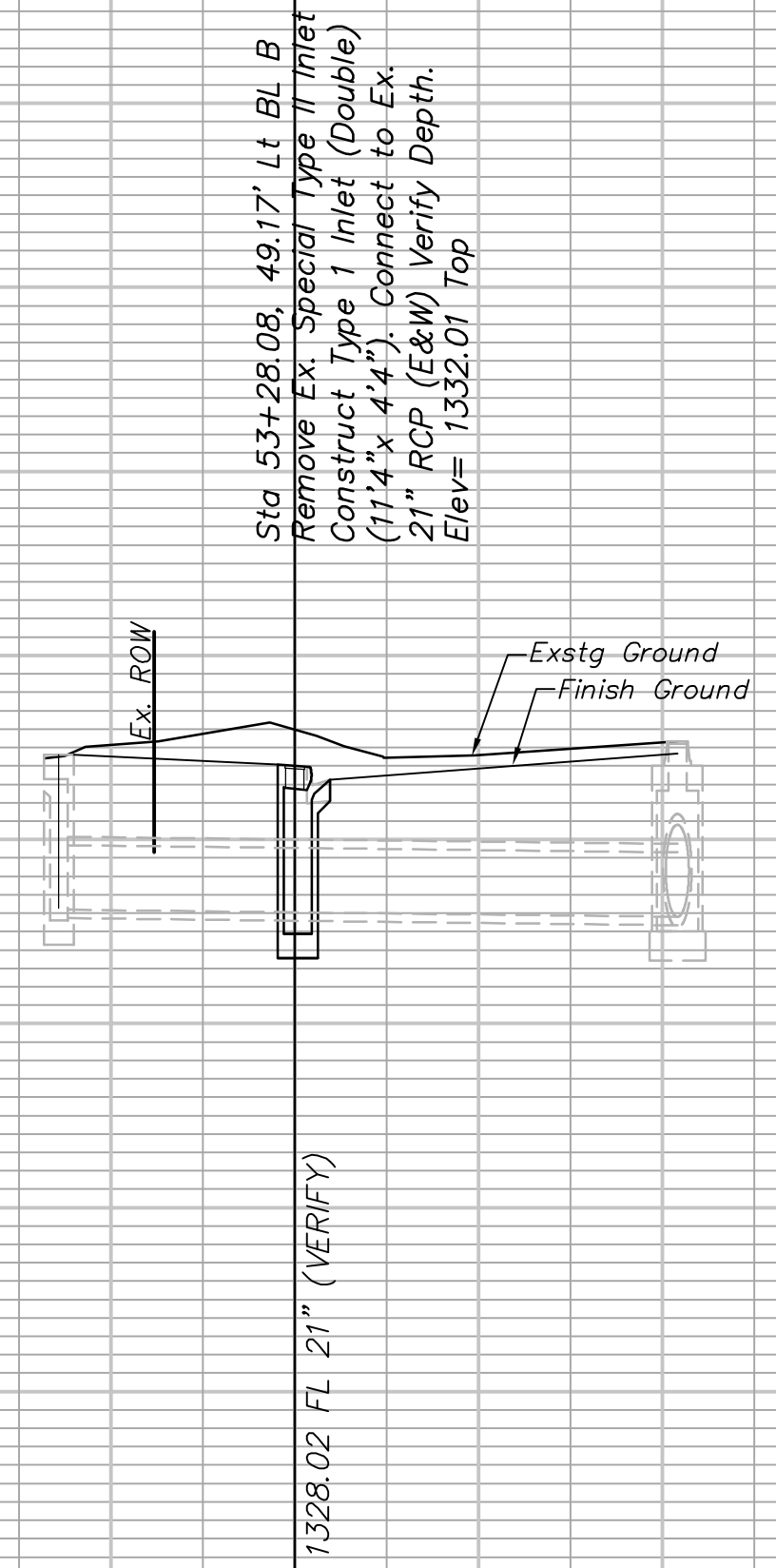
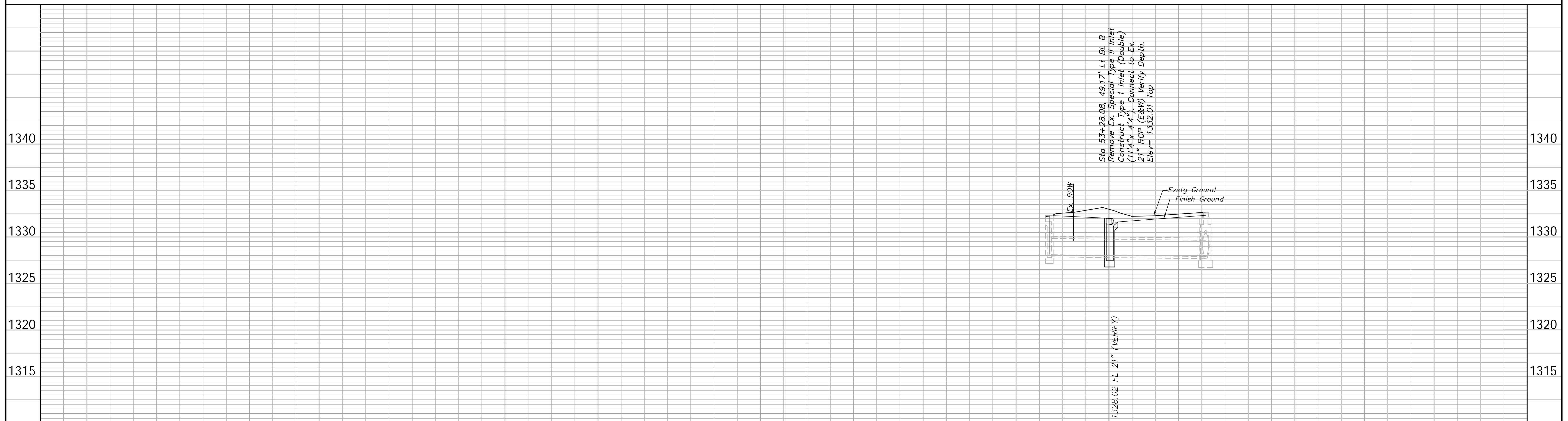

Sta 53+28.08, 49.17' Lt BL B
Remove Ex. Special Type II Inlet
Construct Type 1 Inlet (Double) (11'4"x 4'4"). Connect to Ex. 21" RCP (E&W). Verify Depth. Elev= 1332.01 Top

Drawing File: E:\Eng\Central and tyler intersection\land\dwg\base.dwg
Project No. 05-10-E393 CAPITAL IMPROVEMENT PROJECT
Design: T. Azlere
Drawn: Staff
Approved: J. F. Bradley
Scale: 1:20

Central and Tyler Intersection
SWS Line

Baughman Company, P.A.
315 Ellis St. Wichita, KS 67211 P 316-262-7271 F 316-262-0149
ENGINEERING | SURVEYING | PLANNING | LANDSCAPE ARCHITECTURE

MAY 2008
SHEET 23 OF 72