

FHWA REGION NO.	STATE	PROJECT NO.	FISCAL YEAR	SHEET NO.	TOTAL SHEETS
7	KANSAS	87N-0378-01	2008	44	72



5 0 10 20



SCALE: 1" = 20'

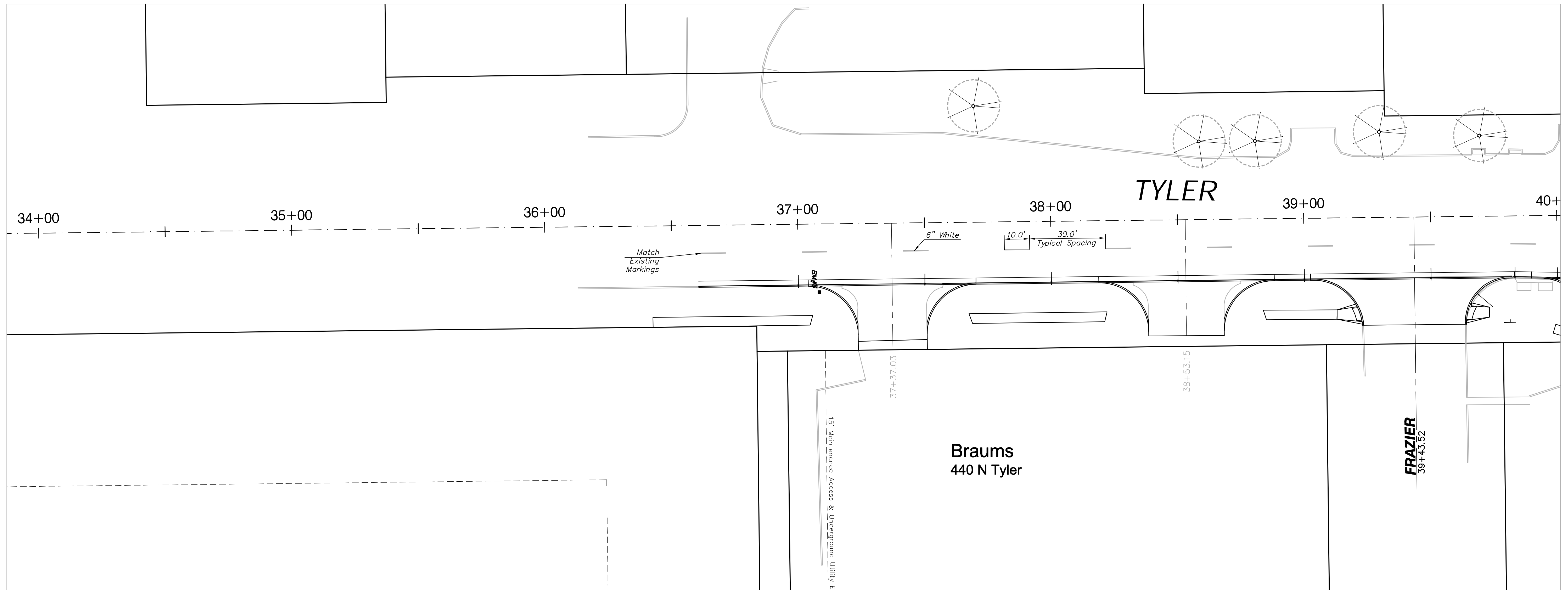

Drawing File: E:\eng\central and tyler intersection\land\base.dwg

Design: T. Azlere  
 Drawn:  
 Approved: J. F. Bradley  
 Scale: 1:20

Project No. 05-10E393 CAPITAL IMPROVEMENT PROJECT

**TYLER SOUTH MARKING**  
**CENTRAL & TYLER INTERSECTION**  
 PAVEMENT, STORM WATER SEWER, TRAFFIC CONTROL IMPROVEMENTS



**Baughman Company, P.A.**  
 315 Ellis St. Wichita, KS 67211 P 316-262-7271 F 316-262-0149  
 ENGINEERING | SURVEYING | PLANNING | LANDSCAPE ARCHITECTURE

MAY 2008

SHEET 44  
 OF 72