

SUMMARY OF QUANTITIES*

Item No.	Description	Quantity	Unit
1	Mobilization	1	L.S.
2	Site Clearing and Preparation	1	L.S.
3	16" Waterline	2,608	L.F.
4	8" Waterline	20	L.F.
5	16"x22-1/2 Degree Bend (DICL)(MJ)	4	Each
6	16"x11-1/4 Degree Bend (DICL)(MJ)	3	Each
7	16"X8" Tee (DICL)(MJ)	2	Each
8	20"X16" Tee (DICL)(MJ)	1	Each
9	20" Long Sleeve (DICL)(MJ)	1	Each
10	16" Anchored Butterfly Valve Assembly	1	Each
11	8" Anchored Gate Valve Assembly	2	Each
12	8" Plug (DICL)(MJ)	2	Each
13	Fire Hydrant Assembly	1	Each
14	Air Release Assembly	1	Each
15	Remove and Replace 6" Asphalt Pavement	34	L.F.
16	Remove and Replace 4" Gravel Surface	315	L.F.
17	Remove and Replace Mailbox	10	Each
18	Erosion Control	1	L.S.
19	Site Restoration (Includes Permanent Sodding)	1	L.S.
20	Traffic Control	1	L.S.

DATE	
BY	
REFERENCE NOTED	
REFERENCE CHECKED	



CITY OF WICHITA PROJECT NO. 448-90218 OCA NO. 633-747 16" Water Main Extension 45th St. North Ironwood Circle to Webb Rd.

Index of Sheets

- 1 TITLE SHEET
- 2 GENERAL NOTES
- 3-7 PLAN & PROFILE SHEET
- 8-10 STANDARD WATER DETAILS
- 11-15 EROSION CONTROL DETAILS
- 16 TRAFFIC CONTROL

* FOR INFORMATION ONLY – Quantities are approximate. Contractor shall be responsible to obtain quantities for bidding & construction purposes based on work shown & implied on the plans regardless of quantities listed in the Summary of Quantities.

Removal & replacement of pavement was calculated using linear foot along the waterline. Area and volume quantities will vary depending on construction methods.

SURVEY LEGEND

- G = GAS MAIN
- W = WATER MAIN
- SS = SANITARY SEWER
- SWS = STORM WATER SEWER
- UGE = UNDER GROUND ELECTRIC
- UGT = UNDER GROUND TELEPHONE
- MKEC 1/2" REBAR W/MKEC CAP (FOUND)
- GARBER 1/2" REBAR W/GARBER CAP (FOUND)
- 1/2" R 1/2" REBAR (FOUND)
- 3/4" IP 3/4" IRON PIPE (FOUND)
- 1" IP/CNC 1" IRON PIPE IN CONCRETE (FOUND)
- 1/2" R/CNC 1/2" REBAR IN CONCRETE (FOUND)
- TELE. PED TELEPHONE PEDESTAL
- F.H. FIRE HYDRANT
- GUY ANCHOR
- G.M. GAS METER
- GUY POLE
- G.V. GAS VALVE
- HIGH LINE POLE
- M.B. MAIL BOX
- PL MKR PIPELINE MARKER
- POST
- POWER POLE
- SIGN
- W.M. WATER METER
- W.V. WATER VALVE
- Y.L. YARD LIGHT
- SS M.H. SANITARY SEWER MANHOLE
- SWS M.H. STORM WATER SEWER MANHOLE

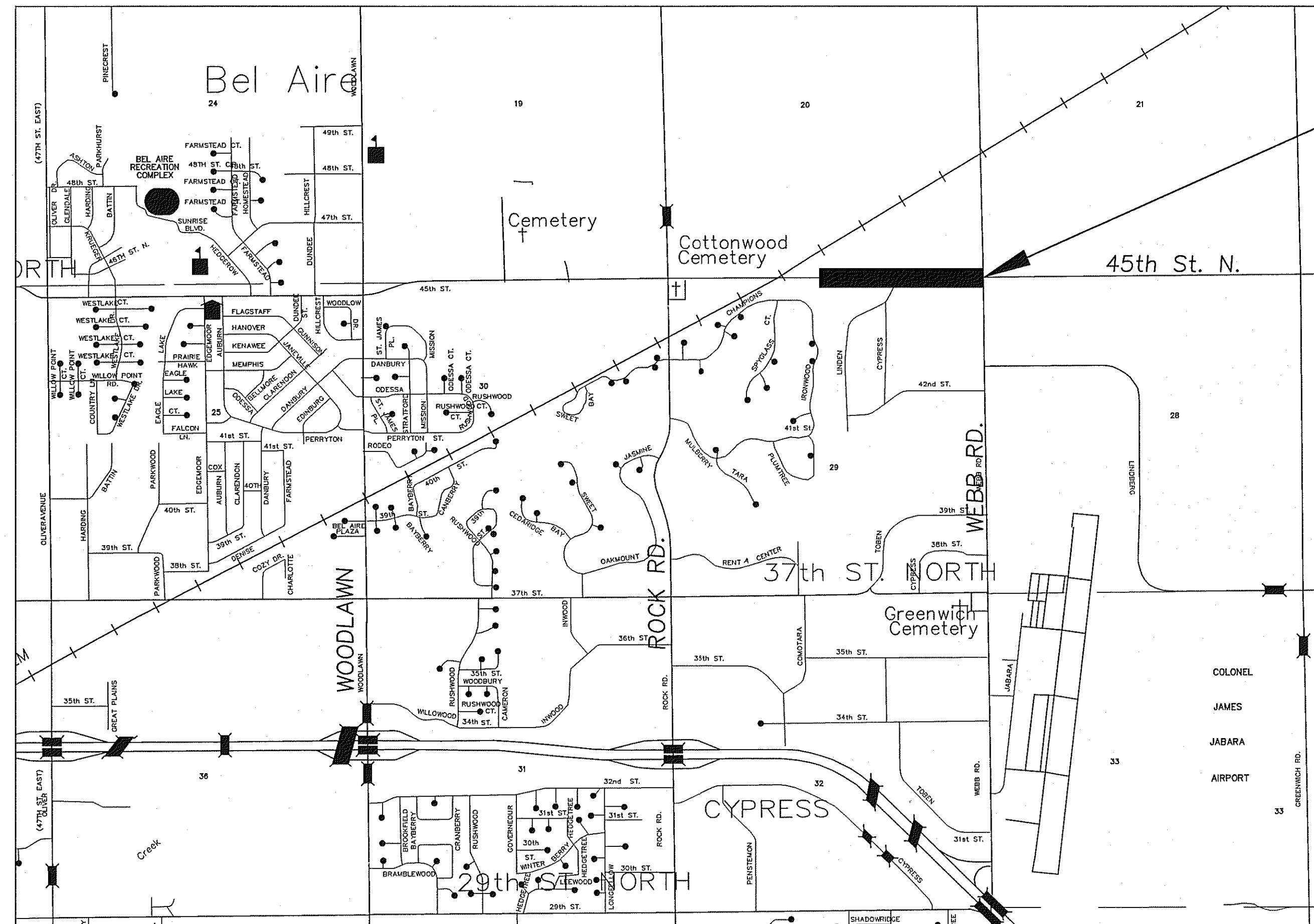

Project Location

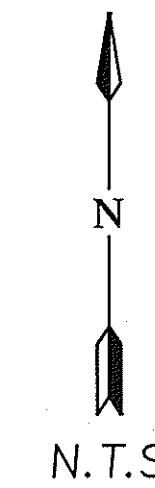

PLANS PREPARED BY:

CFS
 Cook, Flatt & Strobel
 ENGINEERS, P. A.