

BY: \_\_\_\_\_ DATE: \_\_\_\_\_  
 CHECKED: \_\_\_\_\_  
 PLAN

BY: \_\_\_\_\_ DATE: \_\_\_\_\_  
 CHECKED: \_\_\_\_\_  
 PROFILE

Printed: 02-13-2008 3:49:56 PM by MJC  
 Plot Scale: 1"=40'-0" (2008-02-14-2008 7:46:52 AM)  
 J:\SENTOUT\2005\06028\2008-02-13-08 to CIV\1386 PPM\DWG\04-CV3.4-Line03.mxd

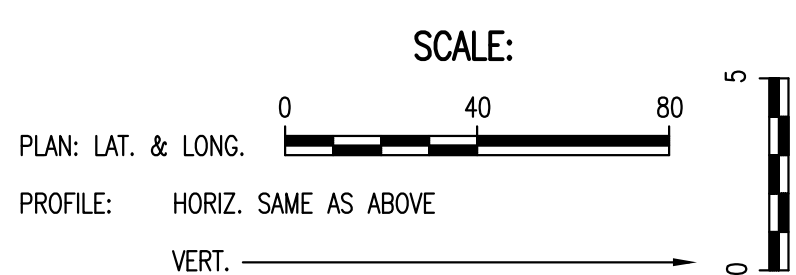
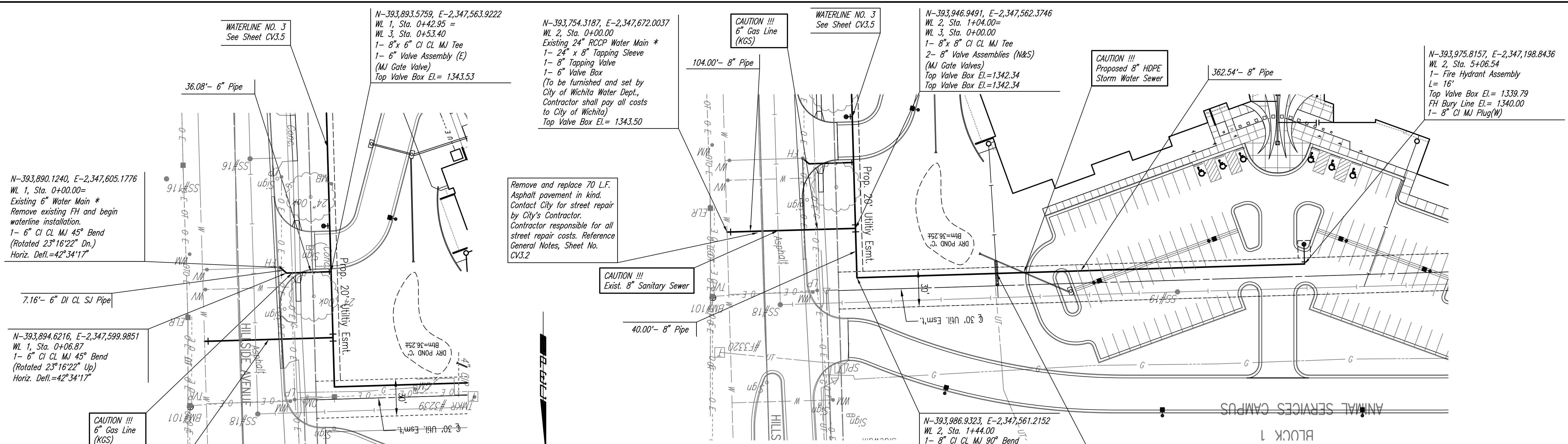

\* PRIOR TO BEGINNING CONSTRUCTION, THE CONTRACTOR SHALL EXCAVATE THE EXISTING 6" WATERLINE AT WL 1, STA. 0+00.00 AND THE EXISTING 24" WATERLINE, AT WL 2, STA. 0+00.00 TO VERIFY PIPE SIZE, TYPE, FITTINGS, AND HORIZONTAL AND VERTICAL LOCATION. THE CONTRACTOR SHALL REPORT HIS FINDINGS TO THE ENGINEER SO THAT ANY NECESSARY PLAN MODIFICATIONS MAY BE MADE. ANY ADDITIONAL LABOR OR MATERIALS NECESSARY TO COMPLETE THE CONNECTION SHALL BE CONSIDERED SUBSIDIARY TO THE PROJECT.

Built As Planned.  
 No Changes Made.

