

BENCHMARK:
 BM #4 - COW Benchmark the North R/W of K-96 Highway and 42.5' West of the Centerline of Hoover Road. B.L. Sta. 228+60.3, 39.9' Lt. Elev. = 1333.14 (MSL)
 BM #1 - COW Benchmark 28.5' East and 14.5' North of the Centerlines of Hoover Road and 45th Street North. B.L. Sta. 249+18.1, 30.2' Rt. Elev. = 1335.29 (MSL)

Reseed 1100 L.F. According to General Note 19 as Measured Along the Force Main from Sta. 64+00 to Sta. 75+00.

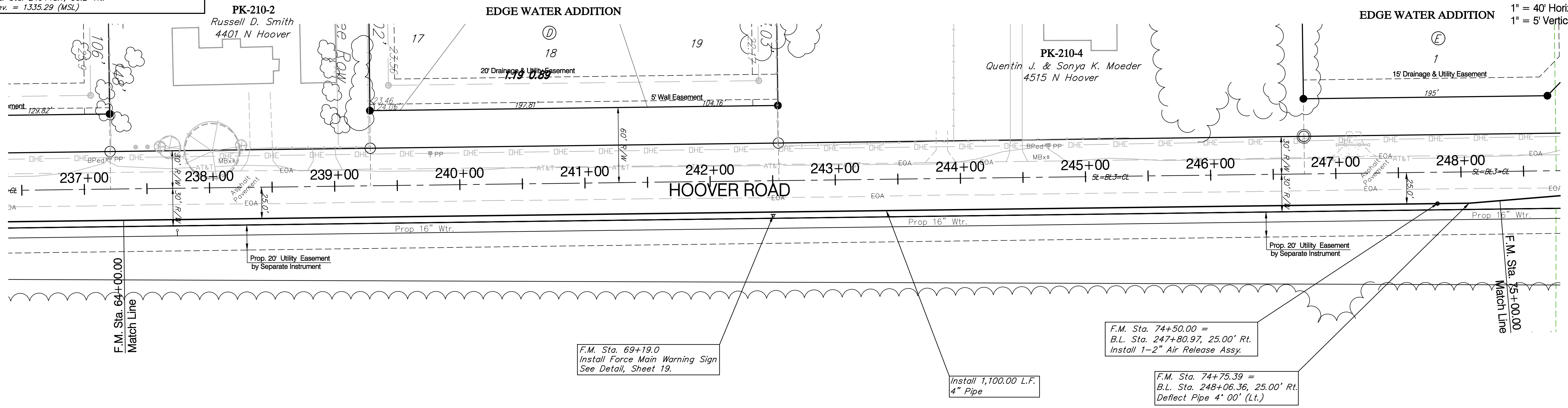
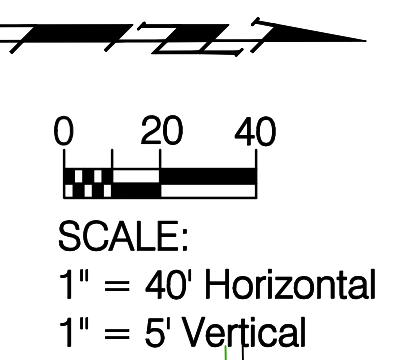

F.M. Sta. 69+19.0
 Install Force Main Warning Sign
 See Detail, Sheet 19.

Install 1,100.00 L.F.
 4" Pipe

F.M. Sta. 74+50.00 =
 B.L. Sta. 247+80.97, 25.00' Rt.
 Install 1-2" Air Release Assy.

F.M. Sta. 74+75.39 =
 B.L. Sta. 248+06.36, 25.00' Rt.
 Deflect Pipe 4' 00" (Lt.)

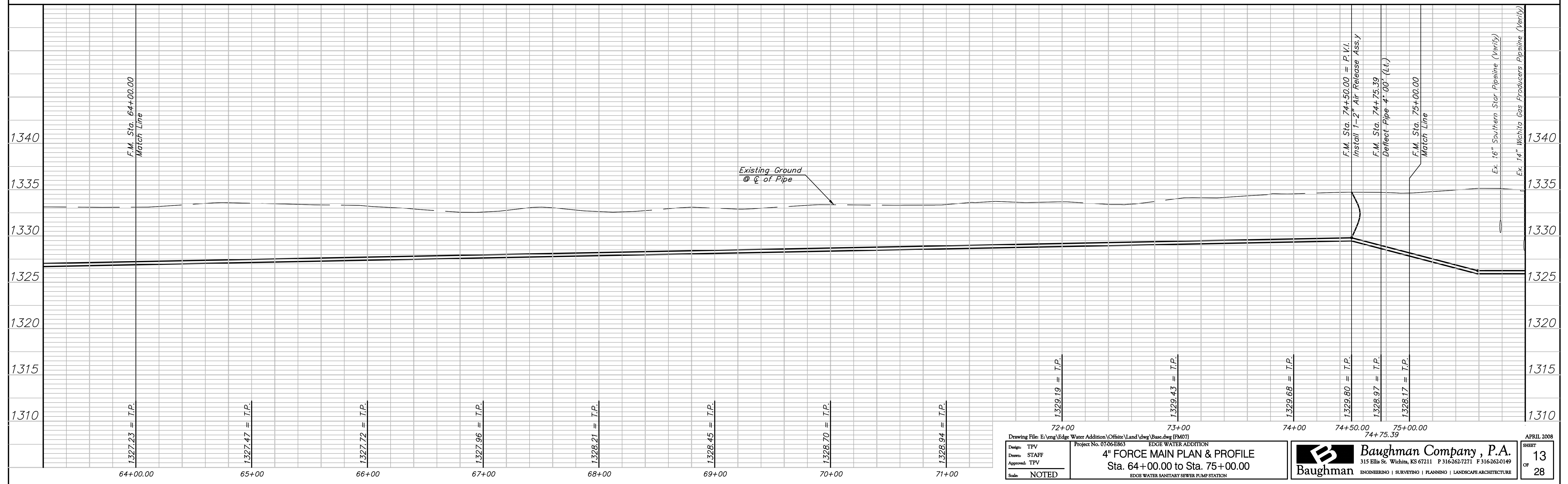

Drawing File: E:\eng\Edge Water Addition\Offsite\Land\dwg\Basc.dwg (FM07) Project No. 07-06-EB63 Design: TPV Drawn: STAFF Approved: TPV Scale: NOTED		EDGE WATER ADDITION 4" FORCE MAIN PLAN & PROFILE Sta. 64+00.00 to Sta. 75+00.00 EDGE WATER SANITARY SEWER PUMP STATION		Baughman Company, P.A. 315 Ellis St. Wichita, KS 67211 P 316-262-7271 F 316-262-0149 ENGINEERING SURVEYING PLANNING LANDSCAPE ARCHITECTURE		APRIL 2008 SHEET 13 OF 28
---	--	--	--	---	--	---