

Benchmarks:  
 Cross cut in north end of concrete valley gutter, Nickelton & Nickelton Ct., adjacent to SW cor. Lot 6, Block C, Silverton Addition  
 Elev. = 1361.49 NGVD 29

Cross cut in concrete [ of curb in front of catch basin, adjacent to SW cor. Lot 6, Block B, Silverton Addition  
 Elev. = 1360.36 NGVD 29

"□" cut in SW cor of curb inlet top adjacent to NW cor Lot 6, Block B, Copper Gate North Addition  
 Elev. = 1361.77 NGVD 29

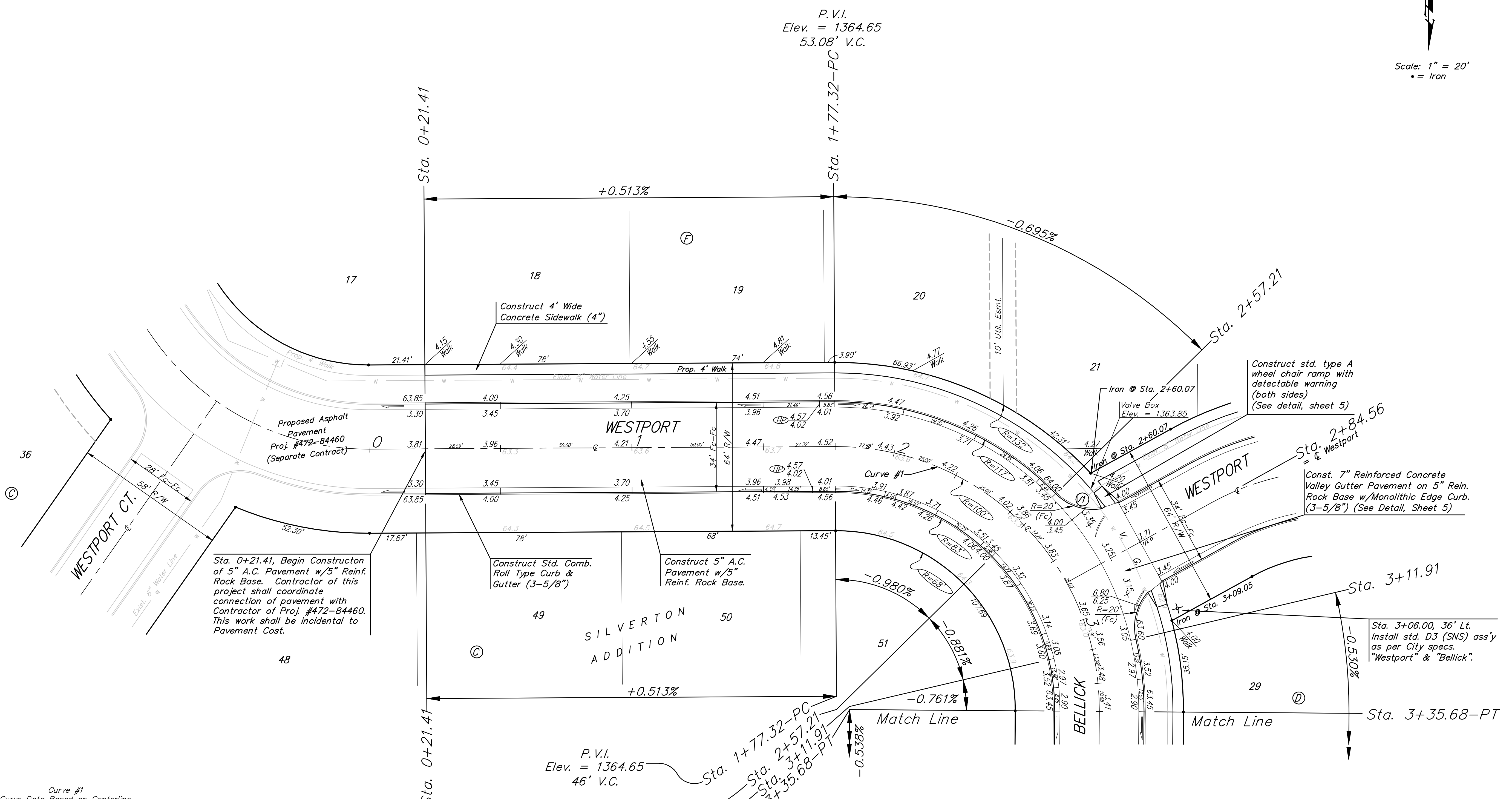
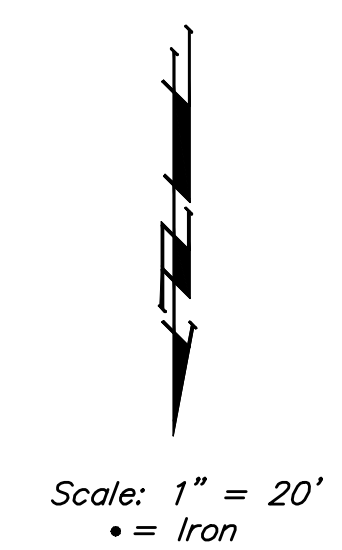

Curve #1  
 Curve Data Based on Centerline  
 Rad. = 100' Delta = 90° 44' 02" Tangent = 101.29'  
 Arc = 158.36' L.C. = 142.32' Def./ft. = 17.18879 Min.

Station	Arc	FACE CHORD LENGTHS		Defl.	T. Defl.
		8' Lt.	8' Rt.		
1+77.32	-	-	-	0'00"00"	0'00"00"
2+00.00	22.68'	28.29'	16.97'	6'29'51"	6'29'51"
2+25.00	25.00'	31.17'	18.70'	7'09'43"	13'39'34"
2+50.00	25.00'	31.17'	18.70'	7'09'43"	20'49'17"
2+57.21	7.21'	9.01'	5.41'	2'03'56"	22'53'13"
2+75.00	17.79'	22.21'	13.32'	5'05'47"	27'59'00"
2+84.56	9.56'	11.95'	7.17'	2'44'20"	30'43'20"
3+00.00	15.44'	19.28'	11.57'	4'25'23"	35'08'43"
3+11.91	11.91'	14.88'	8.93'	3'24'43"	38'33'26"
3+25.00	13.09'	16.35'	9.81'	3'45'00"	42'18'26"
3+35.68	10.68'	13.34'	8.01'	3'03'35"	45'22'01"

P.V.I.  
 Elev. = 1364.65  
 46' V.C.  
 Sta. 1+77.32-PC  
 Sta. 2+57.21  
 Sta. 3+11.91  
 Sta. 3+35.68-PT

P.V.I.  
 Elev. = 1364.00  
 No V.C.

P.V.I.  
 Elev. = 1363.60  
 No V.C.

NOTE: ROLL TYPE CURB & GUTTER TO BE CONSTRUCTED ON THE PAVEMENT SHOWN ON THIS SHEET. TOP OF CURB ELEVATIONS ARE GIVEN FOR FULL HEIGHT CURB.

**Baughman** Engineering, P.A.  
 315 Ellis St. Wichita, KS 67211 P 316-362-7771 F 316-362-0149  
 ENGINEERING | SURVEYING | PLANNING | LANDSCAPE ARCHITECTURE

Silverton Addition - Phase III  
**WESTPORT**  
 STA. 0+21.41 TO STA. 3+35.68

PROJECT NUMBER: 47284461  
 DESIGNER: JAK  
 DRAWN: TMS  
 APPROVED: [Signature]  
 DATE: 7/14/08

SCALE: Noted  
 SHEET: 6 OF 42

Revisions:  
 1. [Blank]

Silverton\Phase3\Sr1 07-10-E958