

Benchmarks:  
 Cross cut in north end of concrete valley gutter, Nickelton & Nickelton Ct., adjacent to SW cor. Lot 6, Block C, Silverton Addition  
 Elev. = 1361.49 NGVD 29

Cross cut in concrete [ of curb in front of catch basin, adjacent to SW cor. Lot 6, Block B, Silverton Addition  
 Elev. = 1360.36 NGVD 29

"□" cut in SW cor of curb inlet top adjacent to NW cor Lot 6, Block B, Copper Gate North Addition  
 Elev. = 1361.77 NGVD 29

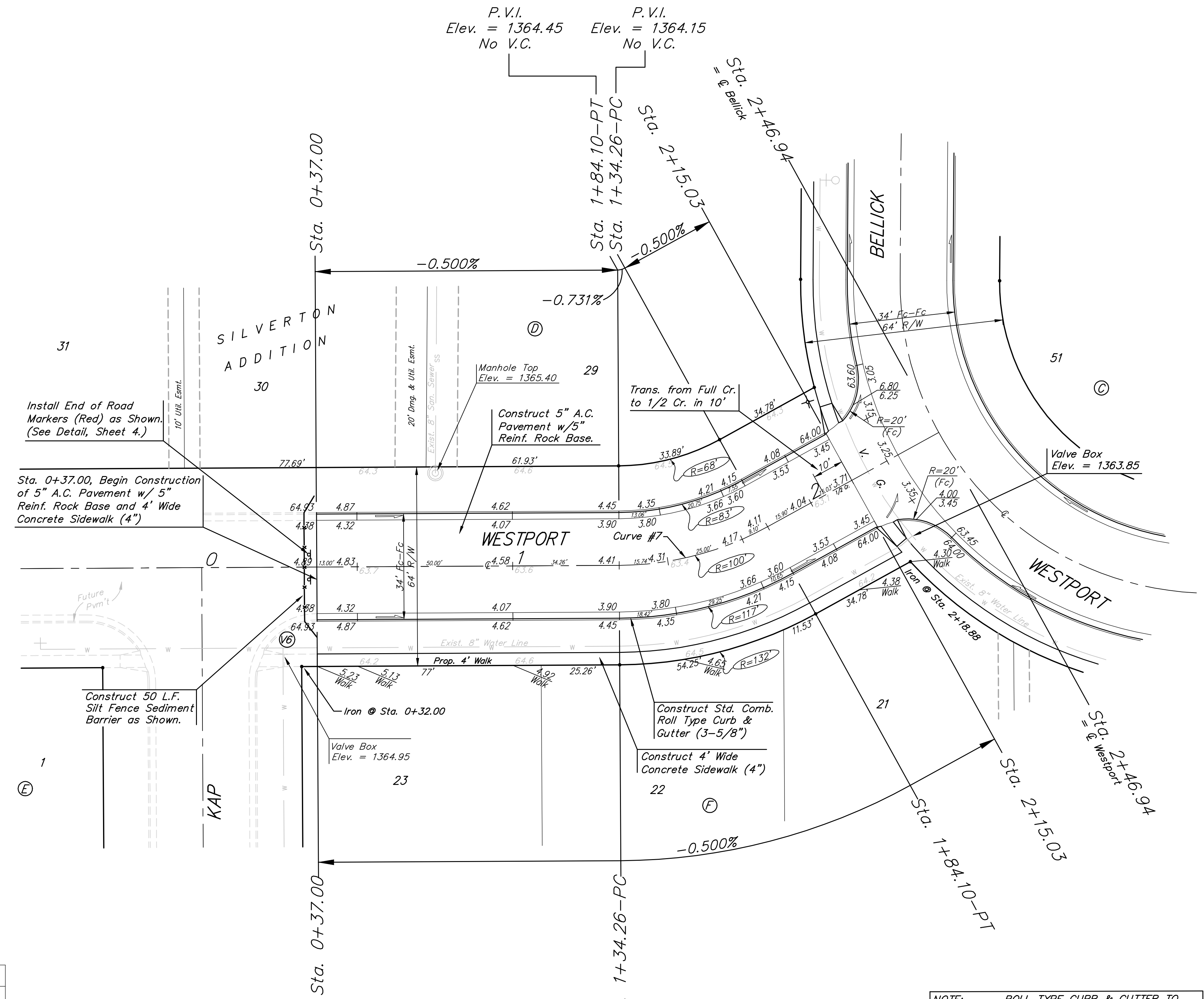
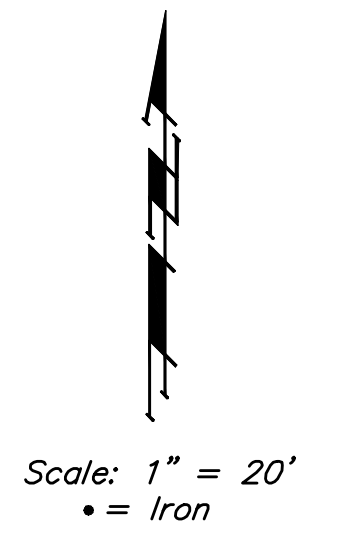

Curve #7  
 Curve Data Based on Centerline  
 Rad. = 100' Delta = 28° 33' 15" Tangent = 25.45'  
 Arc = 49.84' L.C. = 49.32' Def/Ft. = 17.18750 Min.

| Station | Arc    | FACE CHORD LENGTHS |        | Defl.    | T. Defl.  |
|---------|--------|--------------------|--------|----------|-----------|
|         |        | 8' Lt.             | 8' Rt. |          |           |
| 1+34.26 | —      | —                  | —      | 0'00"00" | 0'00"00"  |
| 1+50.00 | 15.74' | 11.79'             | 19.65' | 4'30'32" | 4'30'32"  |
| 1+75.00 | 25.00' | 18.70'             | 31.17' | 7'09'41" | 11'40'13" |
| 1+84.10 | 9.10'  | 6.82'              | 11.37' | 2'36'24" | 14'16'37" |

NOTE: ROLL TYPE CURB & GUTTER TO BE CONSTRUCTED ON THE PAVEMENT SHOWN ON THIS SHEET. TOP OF CURB ELEVATIONS ARE GIVEN FOR FULL HEIGHT CURB.

|  |               |   |                 |
|--|---------------|---|-----------------|
|  |               | Silverton Addition - Phase III                  |                 |
|  |               | <b>WESTPORT</b><br>STA. 0+37.00 TO STA. 2+46.94 |                 |
| <small>Baughman Company, P.A. 315 Ellis St. Wichita, KS 67211 P 316-262-7771 F 316-262-0149<br/>         ENGINEERING   SURVEYING   PLANNING   LANDSCAPE ARCHITECTURE</small> |               |   |                 |
| PROJECT NUMBER<br>47284461   | DESIGN<br>JAK | DRAWN<br>TMS                                    | DATE<br>7/14/08 |
| REVISIONS:   | APPROVED      | SCALE<br>Noted                                  | SHEET           |
|  |               | <b>9 OF 42</b>                                  |                 |
| <small>Silverton\Phase3\Sr4</small>  |               | <small>07-10-E958</small>                       |                 |