

B.M. "M" in Mueller Fire Hydrant NW Cor. Zimmerly & Waverly El. 145.30
 B.M. S Rim of Manhole 23' S Sta. 0+00 El. 137.37
 B.M. N Rim of Manhole 35' S Sta. 0+00 El. 137.66

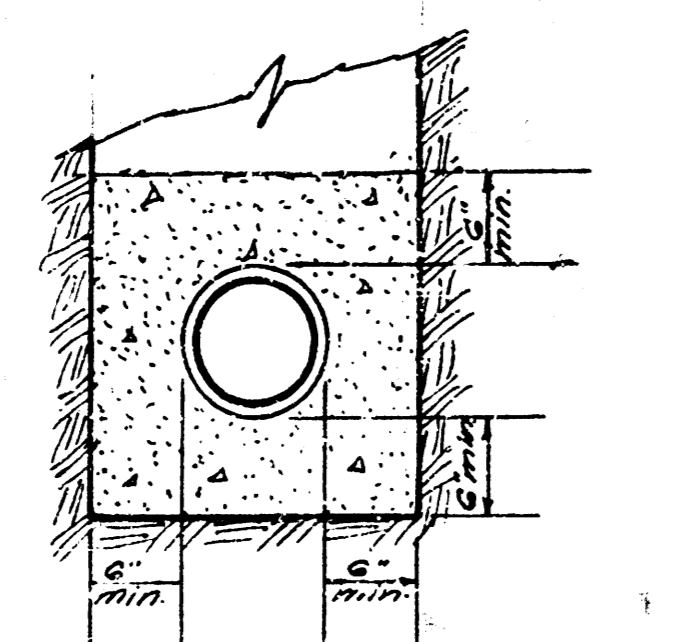

CONC. ENCASEMENT DETAIL

Subm. 3. W.I.S.
 LAT. 5
 CITY OF WICHITA KANSAS
 L.K. WHITE CITY ENGINEER
 Proj. No. C.21-59

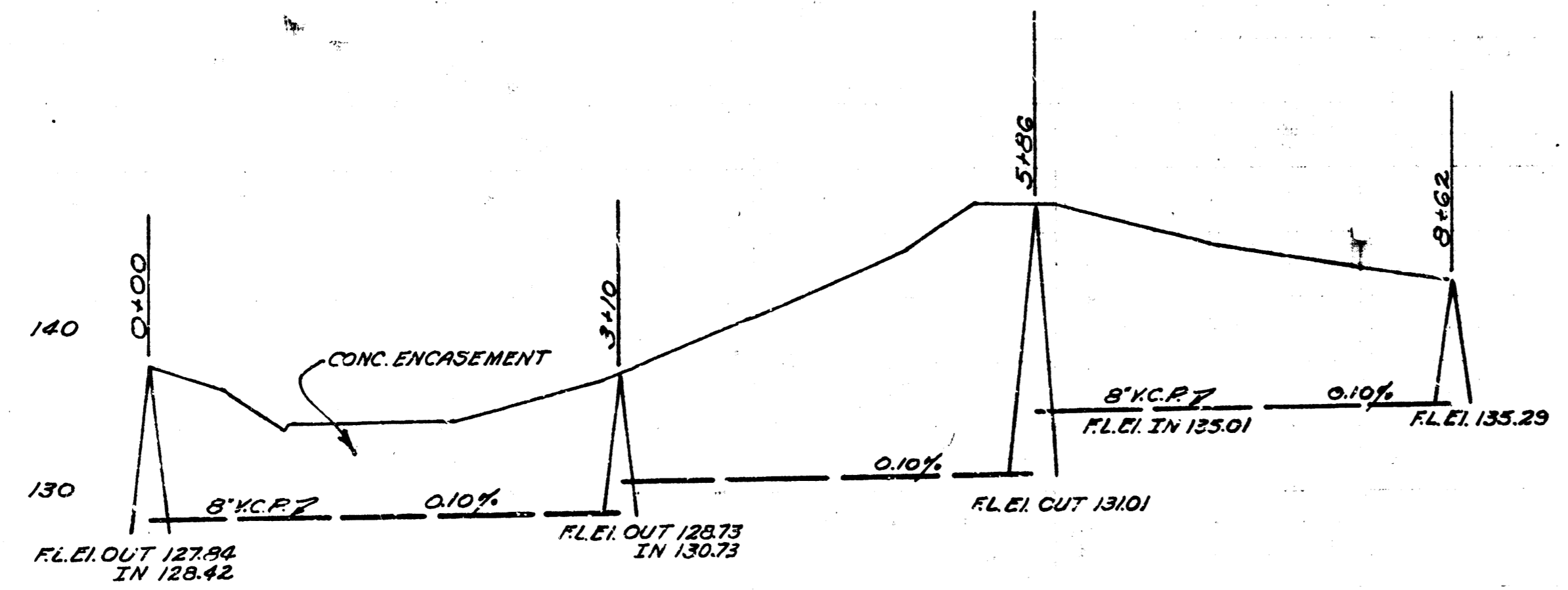
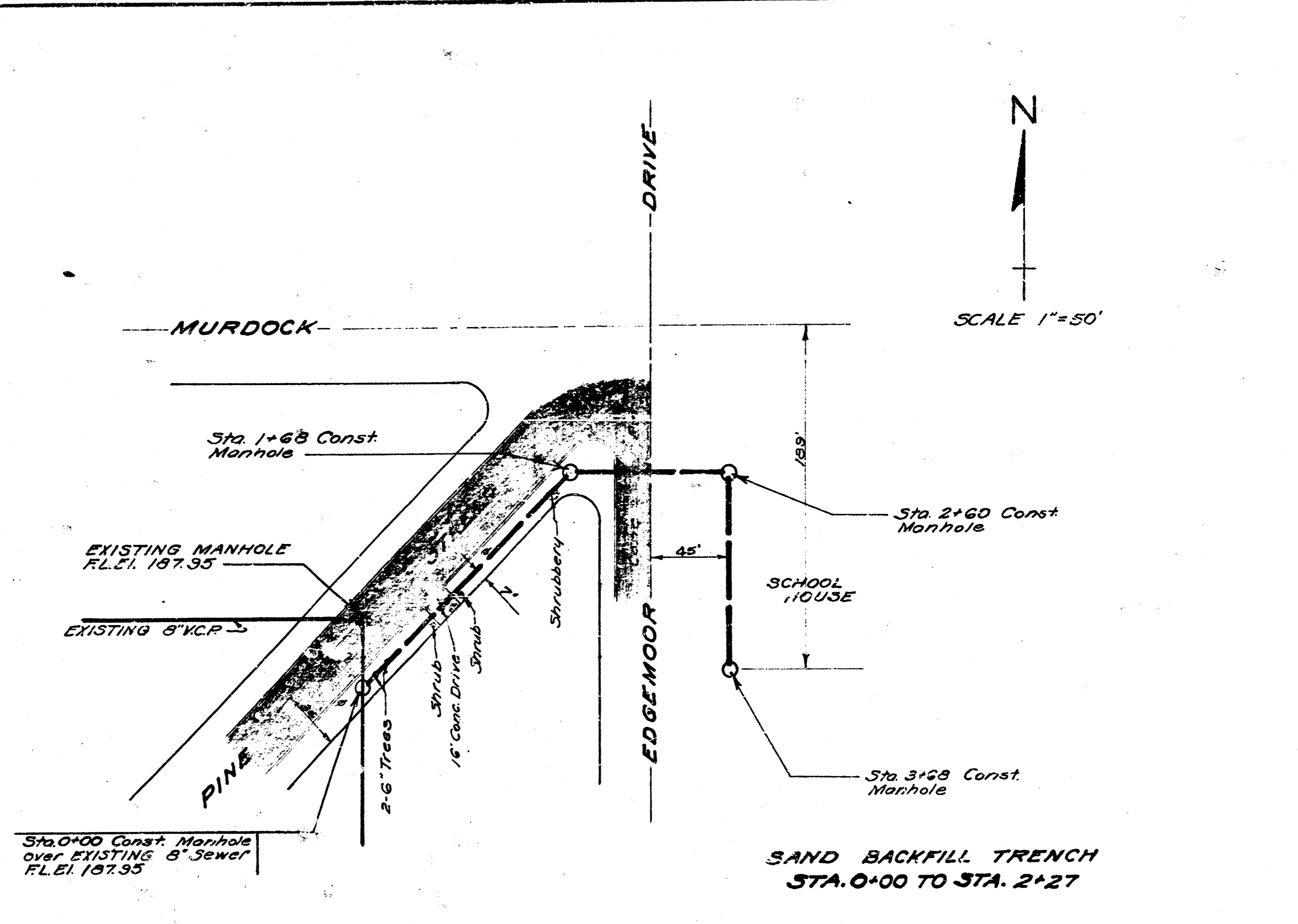
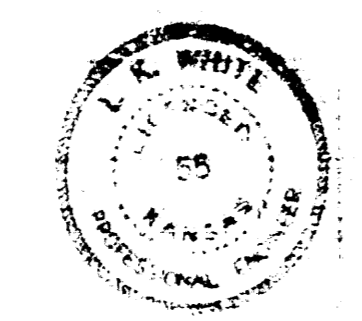

B.M. "G" in Globe SW Corner 8th & Edgemoor 204.42
 B.M. S Rim Manhole 38 N Sta. 0+00 El. 193.53

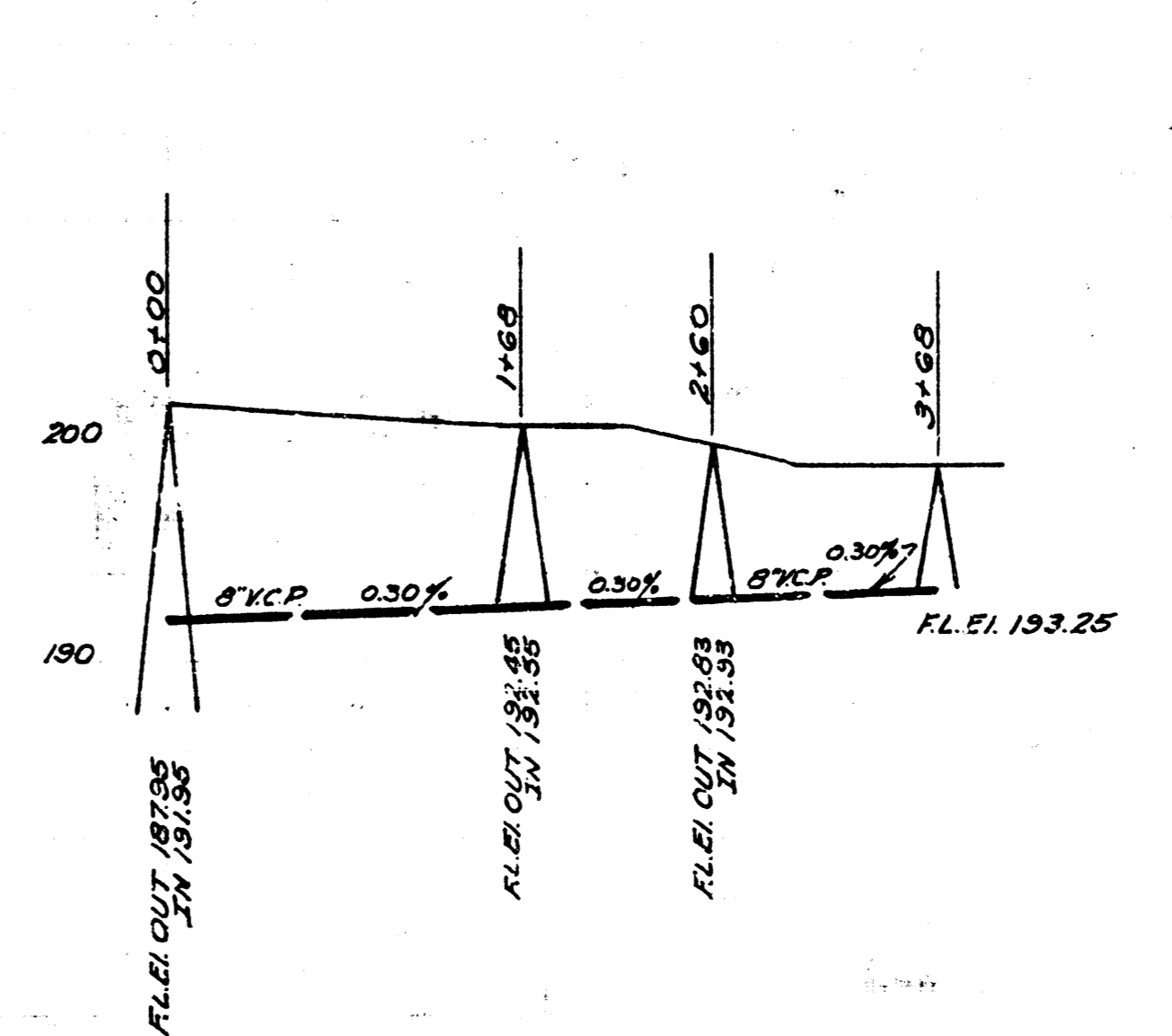

LAT.
 CITY OF WICHITA KANSAS
 L.K. WHITE CITY ENGINEER
 Proj. No. (Private Job)
 11/8/51

Date 10/20/51
 Drawn by J.L.A.
 Checked by
 Mark Egan No. 5-4

SCALE 1" = 80' Horiz.
 1" = 8' Vert.
 NOTE BOOK NO. M-16