

STORM WATER DRAIN NO. 350

TO SERVE

OAK CREEK 3RD AND 4TH ADDITIONS

LOTS 1 AND 2, BLOCK 1, OAK CREEK 4TH ADDITION
LOT 3, BLOCK 2, OAK CREEK 3RD ADDITION

84534

OCA NO. 751479

CITY OF WICHITA PROJECT NO. 468-84534

CITY OF WICHITA, KANSAS

JAMES L. ARMOUR, P.E. - CITY ENGINEER

DEVELOPER CONTACT

MR. DAVE TRIMBLE
SLAWSON COMPANIES
727 N. WACO, SUITE 400
WICHITA, KS 67203
(316) 263-3201

INDEX OF SHEETS

1. TITLE SHEET
2. KEY MAP AND GENERAL NOTES
3. OAK CREEK 2ND PLAT
4. OAK CREEK 3RD PLAT
5. OAK CREEK 4TH PLAT
6. STORM WATER SEWER SITE LAYOUTS
7. PLAN/PROFILE-SWS LINE NO. 1
8. PLAN/PROFILE-SWS LINE NO. 2
9. 18" AND 30" HEADWALL DETAILS
10. PRECAST MANHOLE DETAILS
11. SPECIAL SHALLOW TYPE "A" MANHOLE DETAILS
12. STD. AREA INLET DETAILS
13. MANHOLE FRAME AND COVER
14. RIPRAP DETAILS
15. EROSION CONTROL PLAN
- 16-19. EROSION CONTROL DETAILS

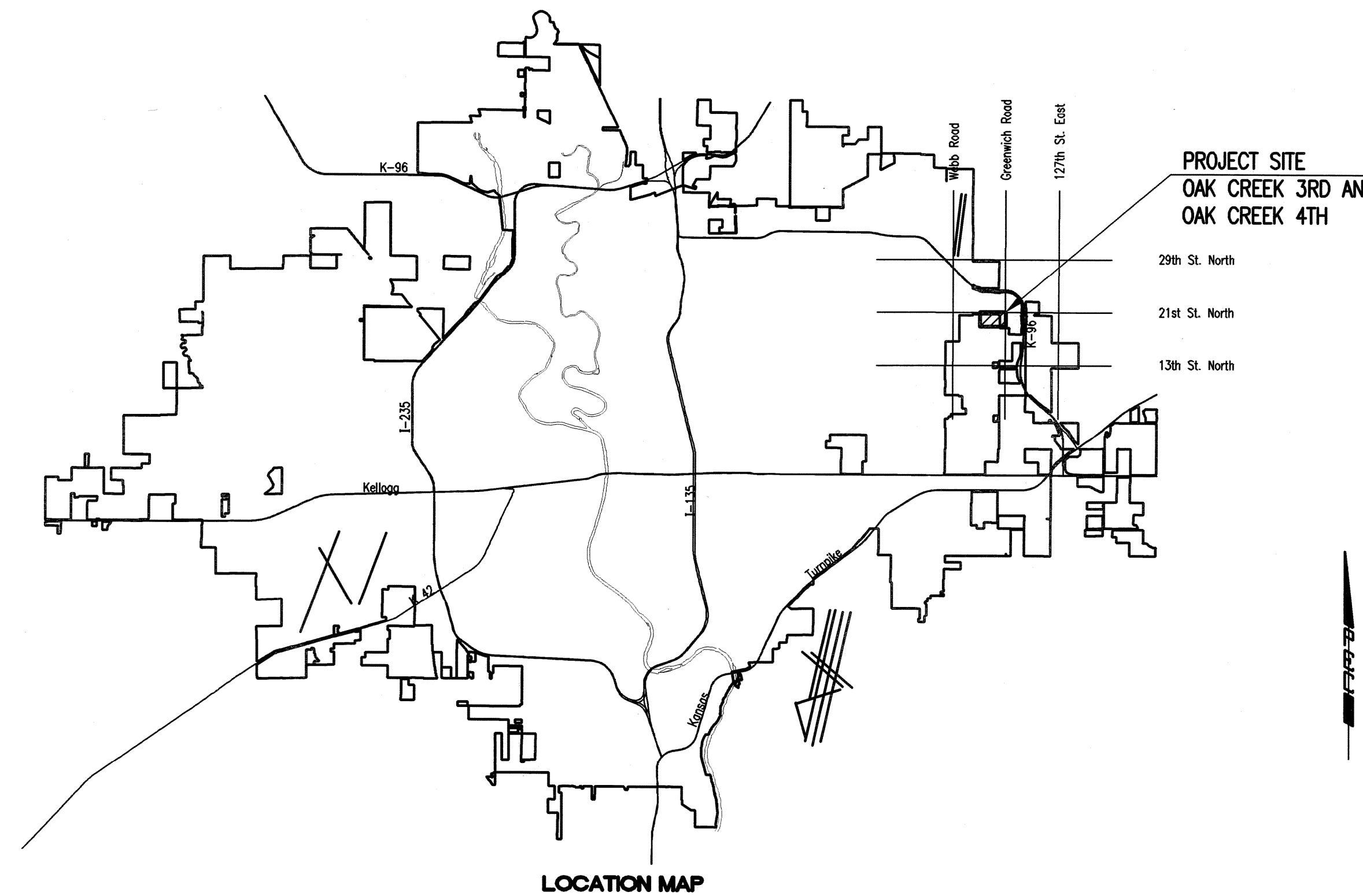

AUGUST 2008

PLANS PREPARED BY
PROFESSIONAL ENGINEERING CONSULTANTS, P.A.
ENGINEERS
WICHITA, KANSAS

